



PATIO AWNINGS

HAROL VZ520

TECHNICAL INFORMATION



1. General

The VZ520 veranda sunblind is specially designed for installation above the existing structure. The advantage of this type of installation is that the rays of the sun which cause excessive heat within the conservatory area, are prevented from striking the glazing. Thanks to a patented bend system, it is possible to shade the front or the vertical side.

The awning is rolled up in a roller box fixed to the side guides. These are attached to the conservatory mullions by means of a two-part system of fixing. There is an air space between the side guides and the awning. This is to ensure adequate ventilation for the area between the awning and the conservatory glazing. The system for attaching the sunblind side guides to the roof mullions is so designed as to enable an minor seating tolerances in the roof sections to be easily taken up. The entire system is made of non-corroding materials.

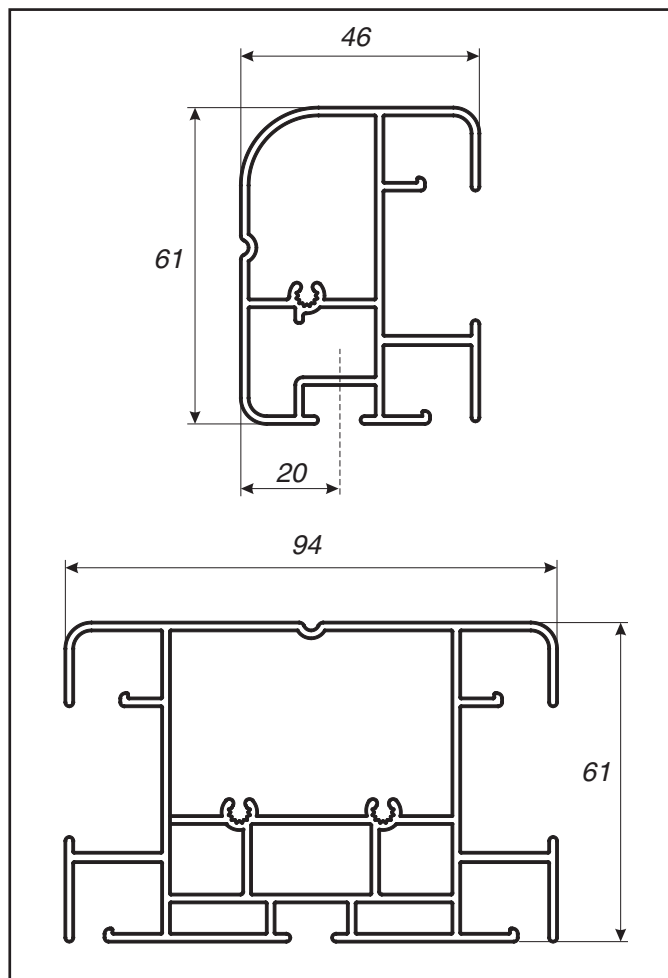

Fig. 1 : Guides

2. The profiles

2.1. Guides

- Material : extruded aluminium, powdercoated
- Colour : the standard colours are white (RAL9016)
- Two types :
 - * End guides : installed on outer sides, with a front rail slot on one side only
 - * Centre guides : installed centrally, with a front rail slot on either side.
- The profiles have a channel into which the bracket support pins fit
- Aluminium extrusions coated to match the frame

2.2. The roller

- Material : a welded tube, formed from a galvanised steel strip, with a groove for attaching the fabric
- Function : rolling the blind fabric up and down.
- Diameters : $\varnothing 78 \times 1$ mm
 $\varnothing 85 \times 1,2$ mm (standard for widths over 4 m).

2.3. The Fabric Clip profile

- Material : consists of extruded PVC clips
- Function : attaching the fabric in the fabric slot without the use of screws, so that the fabric can be removed from the front instead of sliding off sideways
- Diameter of the PVC fabric retainer : $\varnothing 3$ mm
- Advantage : quick and easy fabric changing

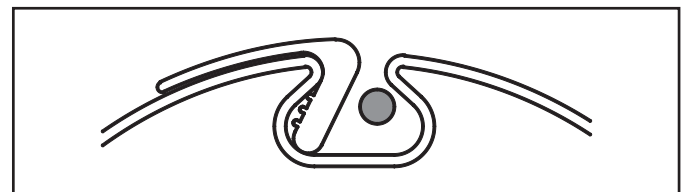
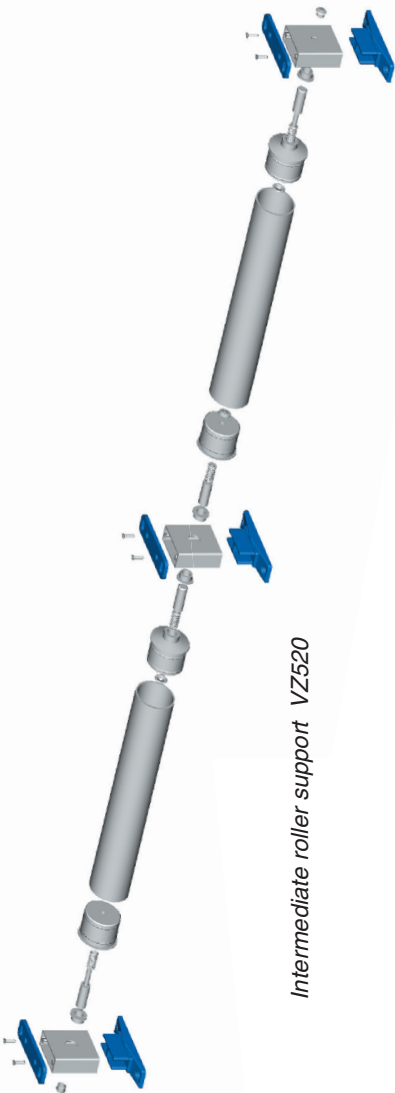

Fig. 2 : "Clip-on clip-off" profile

2.4. The roller box

- Material : press formed from 1,2 mm thick pre-coated aluminium strip, and provided with a protective foil liner
- Colour : as standard coated in white (RAL9016)
- Dimension : 145 mm x 215 mm
- Consists of two sections :
 - * a removable chamfered upper section or cover
 - * a fix lower section
- An extra reinforcement support is fitted in the middle of each section



Intermediate roller support VZ520

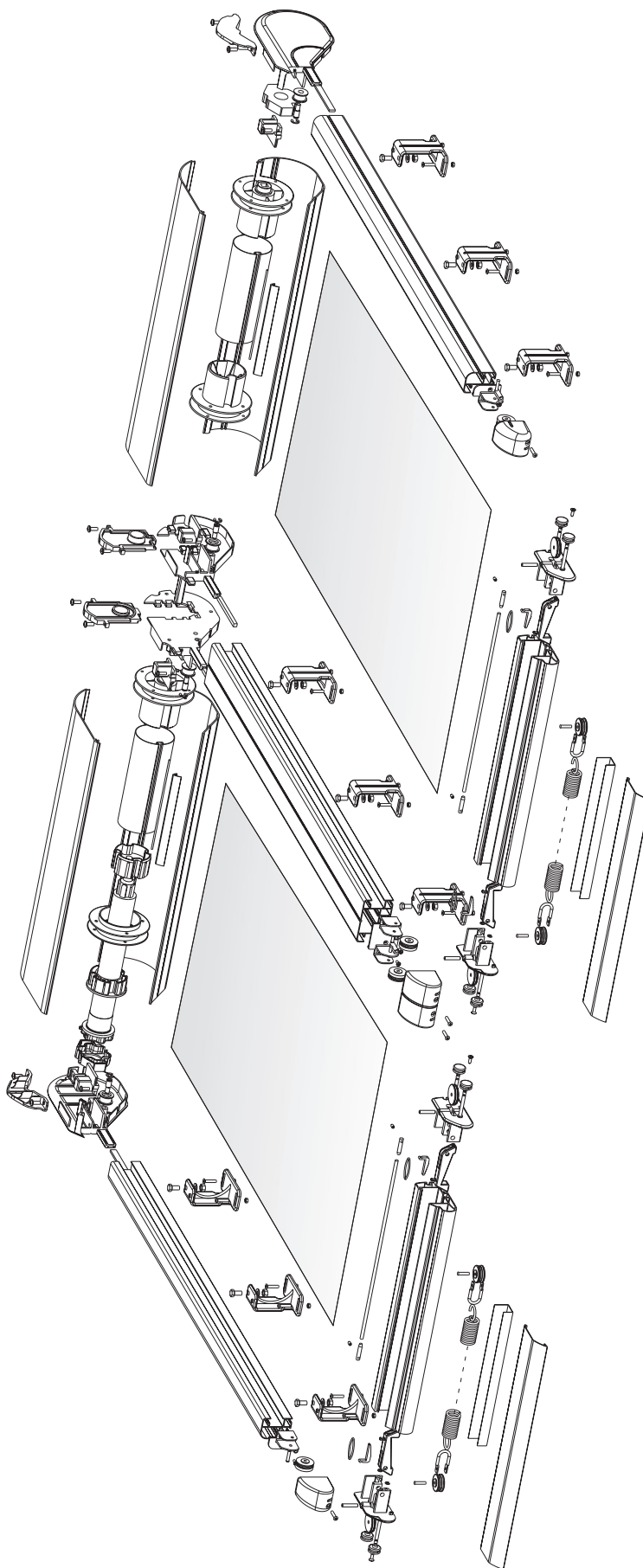
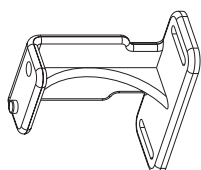

Exploded View
VZ520

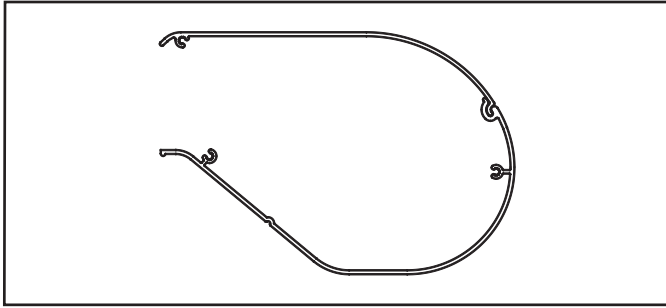

Fig. 3 : Box

2.5. The Front Rail

- Material : extruded aluminium, powdercoated
- Colour : as standard white (RAL9016)

- Function :
 - * The lower section : provided with 2 grooves. The right groove is standard.
 - * The closing section : is clipped to the lower section
 - * This profile runs along the slots in the side guides

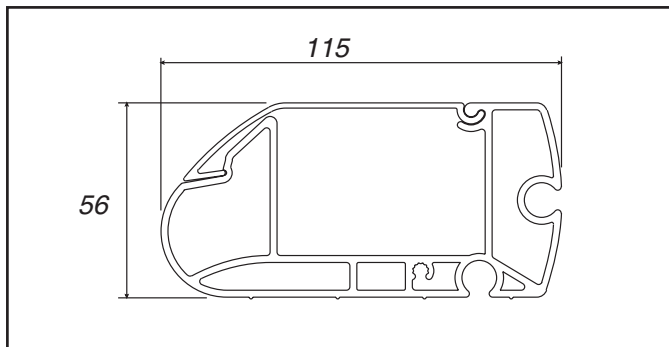

Fig. 4 : Front rail

2.6. The Intermediate Roll(s) for the inclined surface

- Material : extruded aluminium tube $\text{Ø}50 \text{ mm} \times 2 \text{ mm}$ wall-thickness, powdercoated
- Function : Used to support the fabric on longer projections
 - * Over 5001 mm extension :
Included as standard and installed in the middle of the projection
 - * Projection smaller than 5000 mm :
Intermediate roll in option

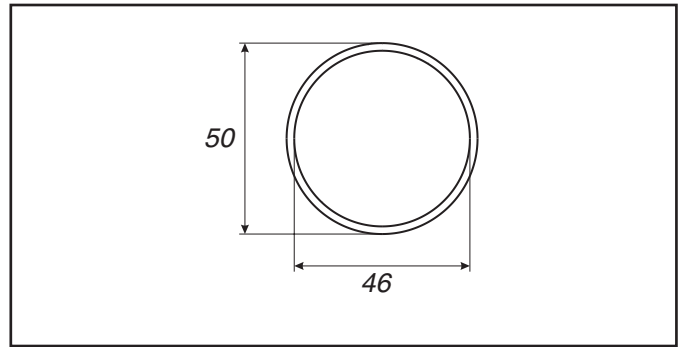

Fig. 5 : Intermediate roll for the inclined surface and the bend

3. Other components

3.1. The Consoles

- Material : hydraulic cast aluminium
- Colour : white (RAL9016)
- Dimensions : 145x215 mm

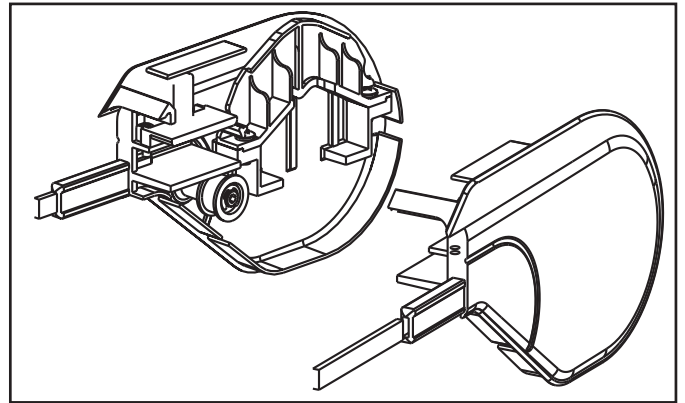

Fig. 6 : End Consoles

3.2. The Carriages

- Material : cast PVC (Luran)
- Colour : as standard black

- Function :
 - * connection of front rail and side guides, fitted with two carriage wheels and 2 fillings which take over the function in the bend
 - * are mounted at the end of the front rail

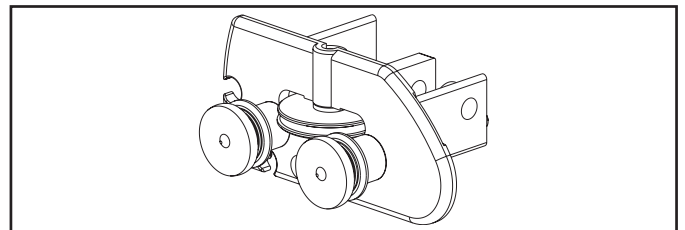

Fig. 7 : Carriage

3.3. The Tensioning System

- Material : the castors, axles, etc. are made of non-corroding materials
- Function : the entire fabric and front rail are kept under constant tension by means of a spring, a rope and a Ø2,5 mm cable
The constant spring tension ensures that the fabric remains taut in any position, to ensure adequate ventilation between the fabric and the glazing

3.4. Guide Fixing Brackets

Standard aluminium support A:

- Material : aluminium
- Colour : coated to match the frame
- Function : used for any type of glass-covered conservatory framework and for all wooden pergolas and veranda systems (for this see fig. 8)
The clearance between the guides and the mullions can be increased by means of extension points (see fig.)

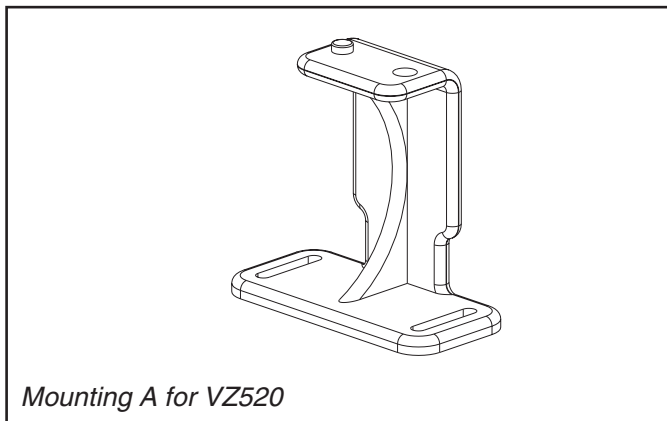

Fig. 8 : Standard aluminium support

Option:

The supports are available in lengths of 120 mm, 200 mm, 300 mm or 400 mm

- * Take into account that the verandaprofiles are under a higher load
- * They can only be used when there is no danger of them twisting
- * The extended support of 120mm is the standard support for the conservatory awning with bend
- * The attachment system is in two parts :
 - The upper part : Slides into the groove below the side and central guides
 - The lower part, exists in two versions :
 - Higher attachment point - low profile A :**
 - For any type of glass-covered aluminium conservatory framework and for all wooden pergolas and veranda systems
 - Is screwed on to the wood or into the groove at the top of the mullions through the capping sec-

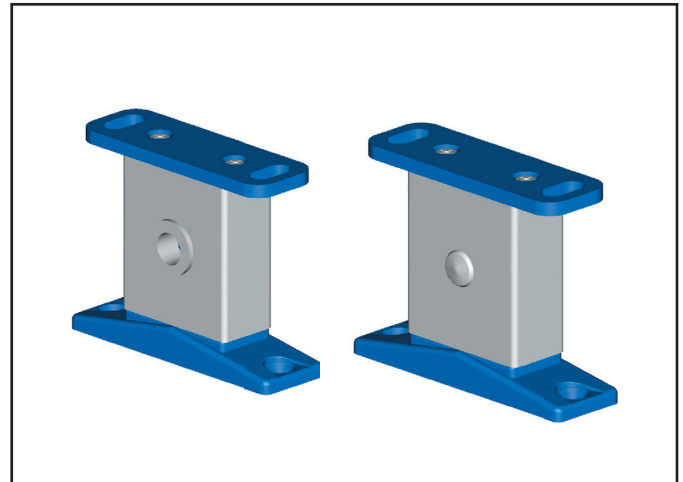

Fig. 9 : Higher attachment point (standard for bend)

tion into which the rubber seal is fitted. (mounting A)

Higher attachment point - high profile B :

- For all types of conservatories with the glass beneath where the mullions have an extended leg above the glazing
- Is fixed to the mullion with two bolts. (mounting B)
- Additional fixing possibilities :
 - * If fixing methods A or B are not possible, an option is to fix against a wall (fig. 10). For this, angled profiles can be used in combination with flat attachment points A
 - * The upper- and lower part fixings are slotted to allow for any minor seating tolerances in the roof sections
 - * The maximum distance between two fixing points along a guide is max. 1600 mm

Remark : In case of an intermediate roll, the awning will be mounted on higher aluminium attachment points of 120 mm.

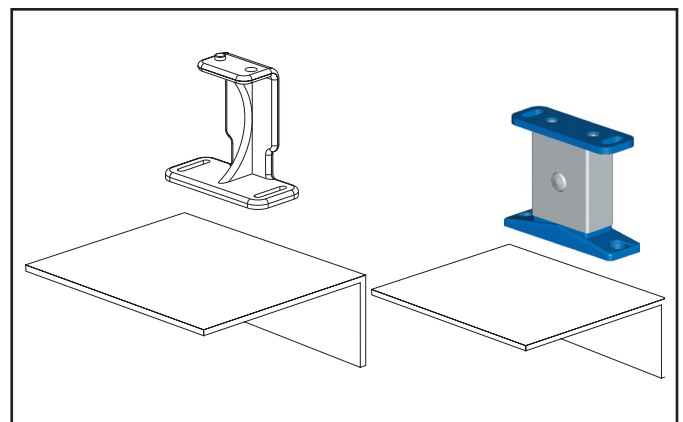

Fig. 10 : Mounting against the wall

Type	Aantal elementen	Maximum width in meters																Maximum surface	Number of elements	Number of motors
		1	2	3	4	5,5	6	7	8	9	10	11	12	13	16,5	22				
Type 1	1 element		1 part															25 m ²	1	1
Type 2	2 elements			2 parts														50 m ²	2	1
Type 3	3 elements				3 parts													75 m ²	3	2
Type 4	4 elements					4 parts												100 m ²	4	2
Type 1 with bend	1 element		1 part															18 m ²	1	1

Table 1 : Technical possibilities

3.5. Coupling Two Side Guides

To connect 2 veranda sunblinds, coupling parts are available

There are two options :

* The coupling plate :

- Material : Aluminium.
- Function :

- * The plate is placed underneath the 2 lateral guides. In the plate there are 4 holes provided for the screws. The screws glide into the groove of the guides (2 per guide) and so the plate is screwed down. In the middle of the plate there are 3 holes provided for the fixation of the attachment point.

- * When the attachment point is directly mounted to the left or right guide, the coupling will be done by mounting the plate behind the attachment

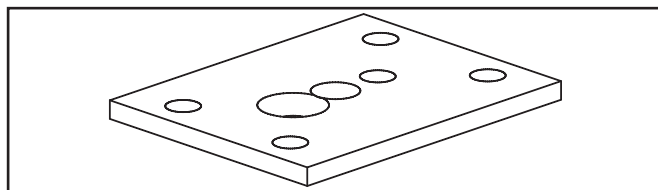

Fig. 11 : Coupling plate

point.

* The angle coupling :

- Material : Aluminium.
- Function :

- * The angle is placed underneath the 2 side guides. The horizontal surface, which is placed underneath the guides, has 2 holes for the screws. The screws slide into the grooves of the guides (1 per guide) and so the angle is screwed down.

- * The vertical surface has 1 hole for fixing the attachment points type A or B

- * Only used when the attachment point is mounted in the middle

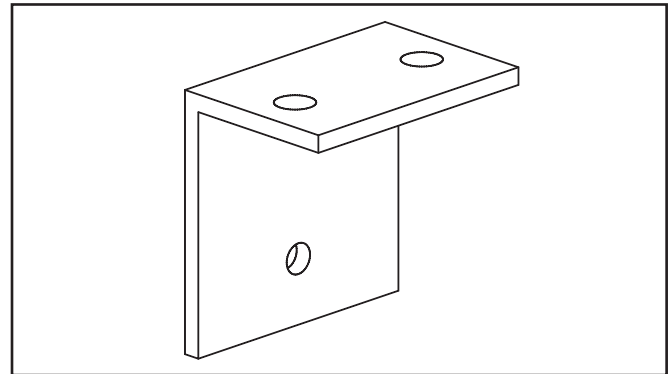

Fig. 12 : Angle coupling

There are 2 different sets, which can be ordered as an option.

* Coupling Plate Set :

- Consists of :
The coupling plate and the attachment means.

- Function :

- * When the attachment point is mounted in the middle

- * When using the extended attachment point, the profile higher attachment point is directly fixed to the coupling plate

- * In that case, the upper part of the attachment point will not be used

* Coupling Duo Set :

- Consists of :
The coupling plate, the angle coupling and the attachment means

- Function :

- * When the standard attachment point is placed in the middle, the upper part should be replaced by the angle coupling

- * When the standard attachment point is placed left or right on the guide, the coupling will be done independently of the attachment point, by mounting the coupling plate behind the attachment points

4. Technical data

- Minimum width per blind : **2 m**
- Maximum width per section : **5 m**
- Maximum projection : **6 m**
- Maximum fabric area : **25 m²**

The different (box) sections are packed separately for connection on site.

Bend only implementable with type 1

5. Weight

The approaching weight = **Width X 18 kg per meter (width)**

6. Operation

6.1. Motor operation

- Drive via tubular motors : 230 Volt (50Hz) :
 - * Fitted with automatic post-regulation, this means the motor slows at approx. 10 cm before the bottom bar closes against the roller box so that it stops without forcibly hitting it
 - * Fitted far left and/or far right as required
- Cable :
 - * As standard 3 m
 - * Optionally 5 or 10 m
 - * The distance can be increased by fitting a junction box
- A single-pole surface-mounted switch and plug are supplied as standard

6.2. Automation

- Accessories :
 - * Relay boxes
 - * Wind-and-Solar control
 - * Time switches
 - * Remote control
 - * ...

7. Fabric cover

Choice between two qualities :

7.1. Acrylic

- Composition : Spun dyed Acrylic fibre coloured in the mass
- Colour : Patterns and colours from the standard collection
- Weight : +/- 290-300 gr./m²
- Thickness : +/- 0,5 mm
- Confection : Patterned in vertical rows of 1200 mm, side hems of 30mm width, double step stitch with polyester thread
- The fabrics are treated for rot and mould, and have waterproof and dirt-repelling qualities

7.2. Soltis

- Composition : Polyester threads, enclosed at both sides with PVC
- Colour : A range of solid colours from the standard collection
- Weight : +/- 330-350 gr./m²
- Thickness : +/- 0,4-0,45 mm
- Confection : Patterned in vertical rows of 885 mm, side hems of 30 mm width, welded
- The fabrics have excellent ventilation qualities, provide an outward view and are very easily cleaned