

STRIPECOIL SMOKE CURTAINS

(ALLOWS OCCUPANTS TO EXIT WHEN DEPOLYED)



Unique and innovative design



General

Stripecoil is a smoke curtain that closes completely to floor level. It has been tested in accordance with EN 12101.1, and has been optimized specifically for the passage of occupants even in the closed position.

This system was developed for the French metro. It provides a method of allowing occupants to reach exit points at opposite ends.

The Stripecoil system incorporates:

- Drop length up to 3.5m
- System width without limitation
- Gravity fail safe system
- Stabilisation and loading of the fabric by elastic chambers being filled with small lead balls at the lower edge of the system
- Robust closing edge bonded with an Aramid-fabric to protect it against damage and vandalism
- Installation and maintenance is easily achieved from below
- Galvanized sheet metal, powder coating in RAL colours as an option

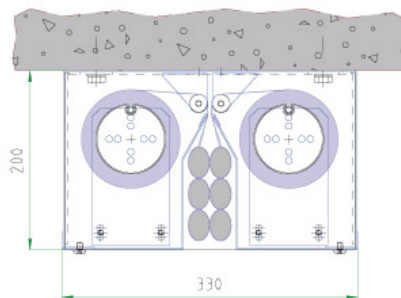

- Allows egress in closed position and complies with disability act.
- Designed to allow 100 people to pass through per minute.
- Designed to be used in conjunction with smoke exhaust or pressurisation system.
- Stainless steel wire can be set at nominated height above finished floor level (eg: 2.1m) to improve smoke baffle performance during occupant egress.

Stripecoil

STRIPECOIL SMOKE CURTAINS

(ALLOWS OCCUPANTS TO EXIT WHEN DEPOLYED)



The complete closing area remains available for passenger traffic and no barriers like beams or posts have to be placed in the opening. No additional bypass (e.g. a fire door) is necessary even when the system is in the closed position.

This is especially advantageous for underground projects.

Designed for the passage of large crowds, including those in buggies, wheelchairs and prams.

The system self-stabilises after the passage of occupants.

Soft, elastic and uninterrupted closing edge to minimize the danger of injuries, protected against damages and vandalism.

Provides unhindered access for fire-fighting and rescue teams.

The system is compact and allowing it to be concealed in smaller ceiling spaces.

Translucent fabric available in 2 shades to give a light-optimized design of the passage area (to reduce the danger of panic and to mark the escape

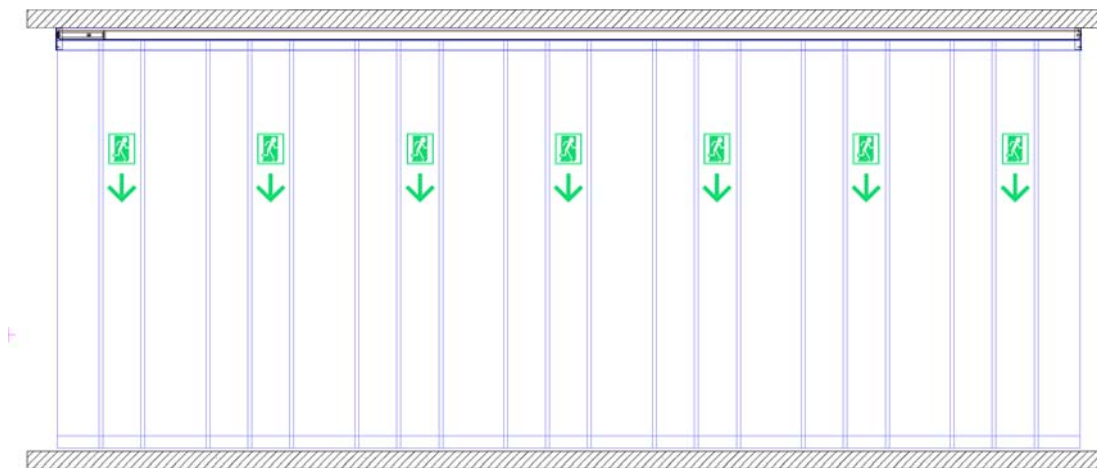

Stripcoil