

# G12

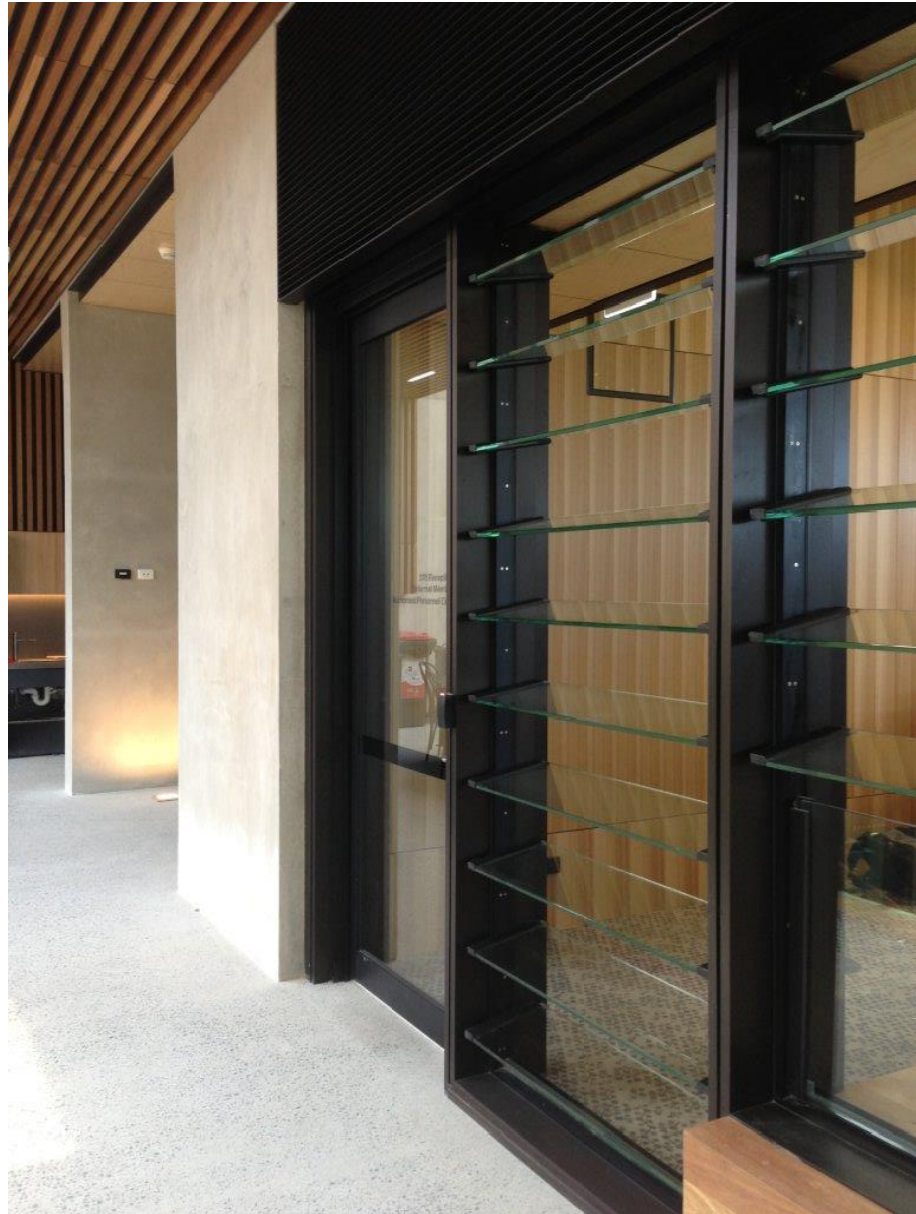

## SPECIFICATION

Construction	Aluminium
Fixing	Glass holder or SS Louvre Bracket
Glazing	Up to 13.52mm***
Width	Up to 1650mm*
Blade Height	150mm up to 300mm*
Opening Angle	Project dependent, up to 80
Operation	Electric drive 24VDC or Manual
Water Penetration (AS2047)	150PA to 500PA** Refer to NATA tests
Air Infiltration (AS2047)	Refer to NATA tests
Ultimate (AS2047)	Refer to NATA tests

### GENERAL INFORMATION:

THE LOUVRE DESIGN CAN BE ALTERED TO SUIT ANY APPLICATION & GREATER VALUES THAN THOSE SHOWN ABOVE MAY BE ACHIEVABLE

\* Depending on wind loading and glazing, greater louvre width & heights could be achieved

\*\* Depending on wind loading and glazing

\*\*\* System dependent

## G12 LOUVRE SERIES



[www.ebsa.com.au](http://www.ebsa.com.au)

# G12 - GLAZING

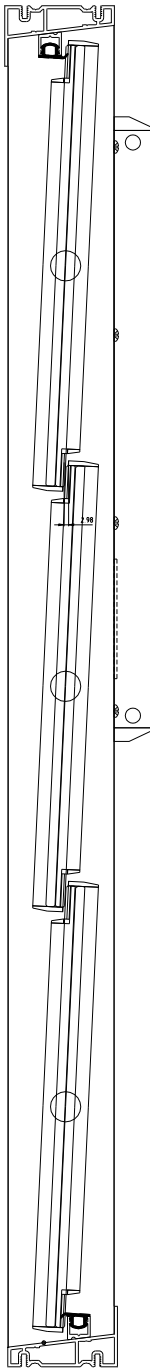

## G12

- OVERLAPPING
- ALUM. BLADE HOLDERS
- GLASS 12mm & 12.76mm

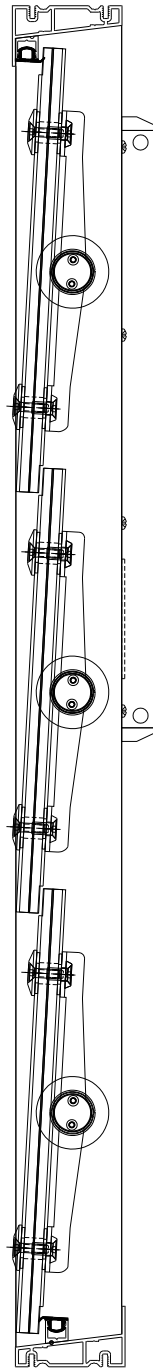

## G12-BS

- OVERLAPPING
- POINT FIXED
- GLASS 11.52mm / 12mm / 13.52mm

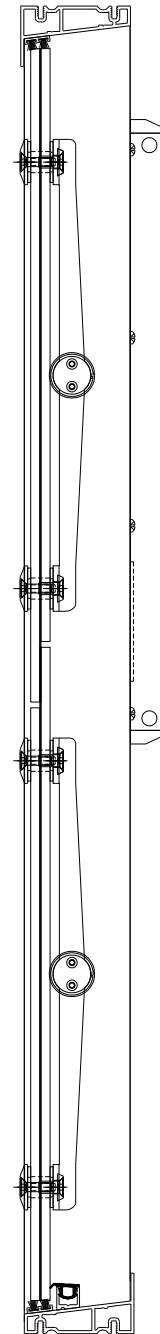

## G12-FS

- FLUSH GLASS\ STEPPED LAM.
- POINT FIXED
- GLASS 10.76mm / 12.76mm

**G12 LOUVRE SERIES**



[www.ebsa.com.au](http://www.ebsa.com.au)

**G12-S**

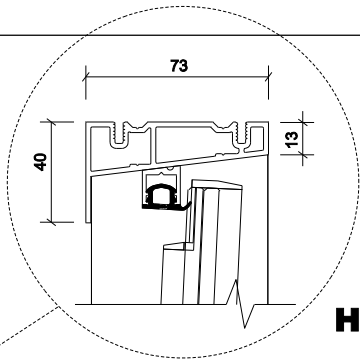

**HEAD**

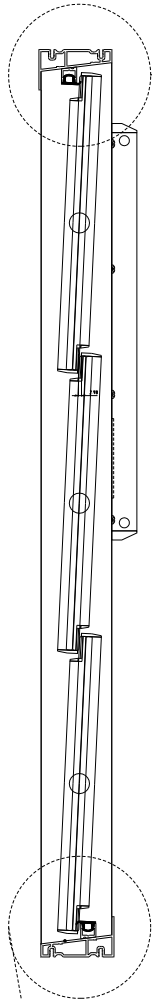

LOUVRE BLADE HEIGHT:  
UP TO 300mm\*

**SECTION**

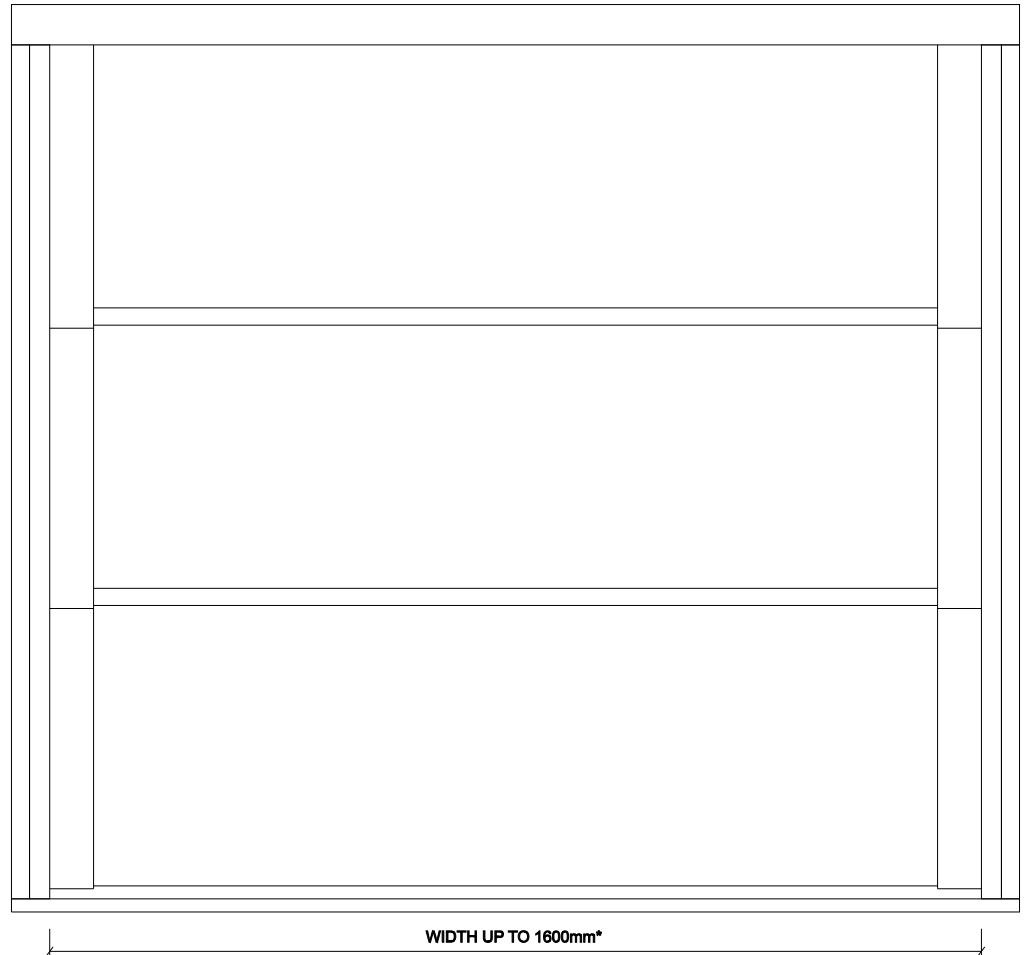

WIDTH UP TO 1600mm\*

**ELEVATION**

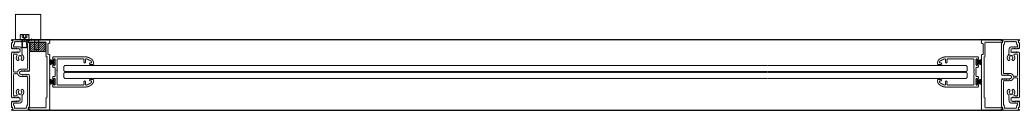

**PLAN**

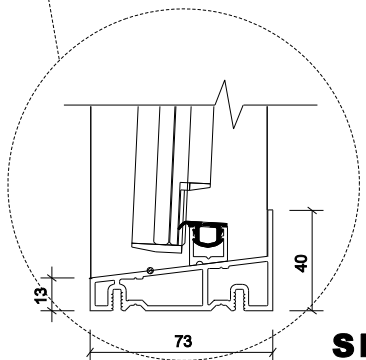

**SILL**

**G12 LOUVRE SYSTEM**



[www.ebsa.com.au](http://www.ebsa.com.au)

# G12-BS

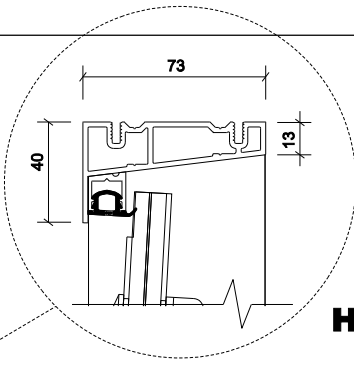

**HEAD**

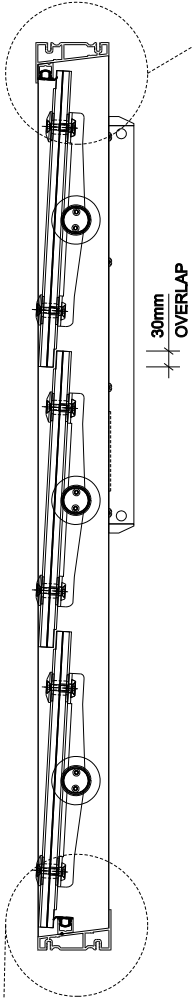

**SECTION**

LOUVRE BLADE HEIGHT:  
UP TO 300mm\*

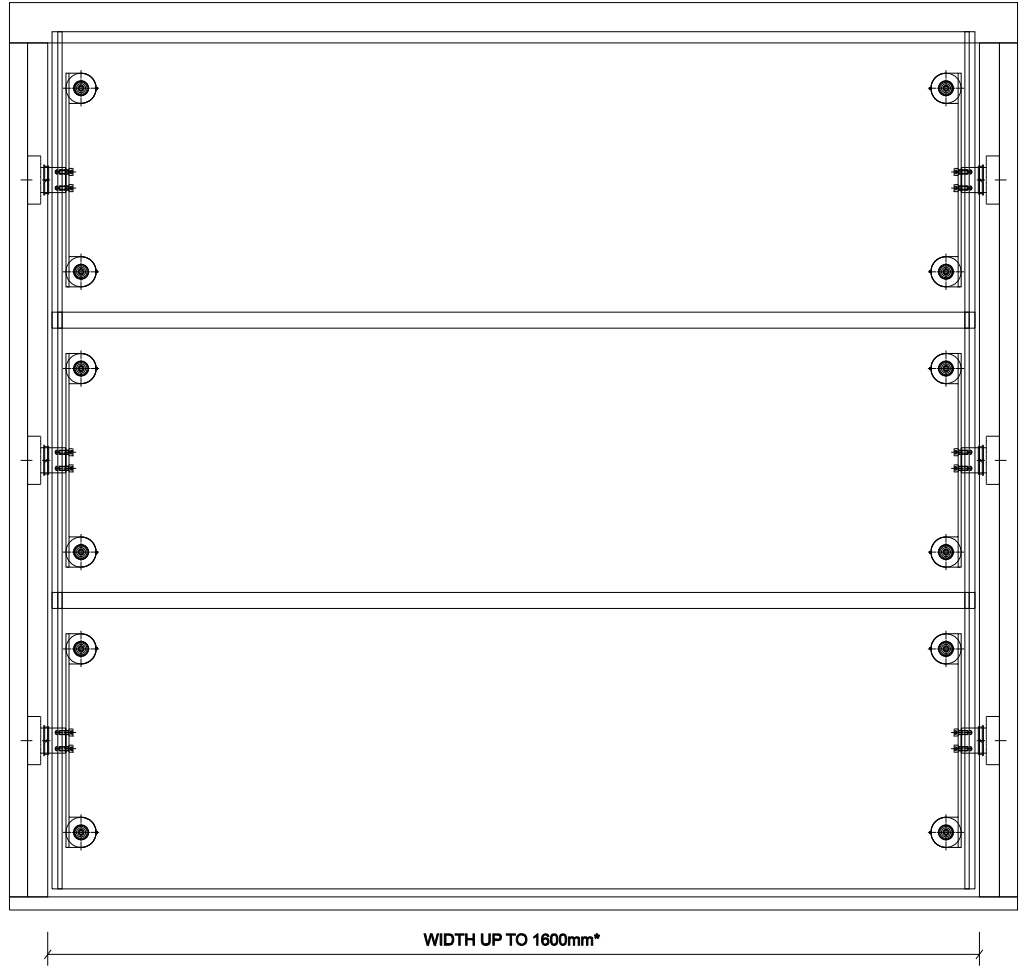

**ELEVATION**

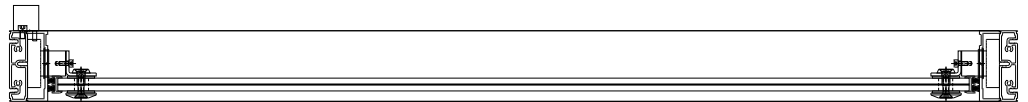

**PLAN**

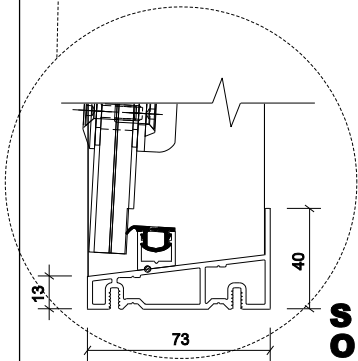

**SILL  
OPTION 01**

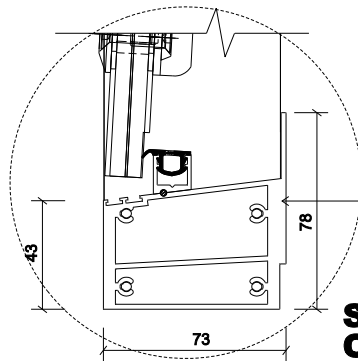

**SILL  
OPTION 02**

DRAINABLE SILL

## G12-BS LOUVRE SYSTEM



[www.ebsa.com.au](http://www.ebsa.com.au)

# G12-FS

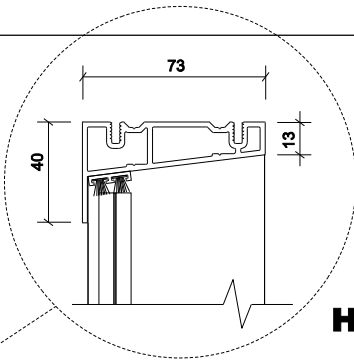

**HEAD**

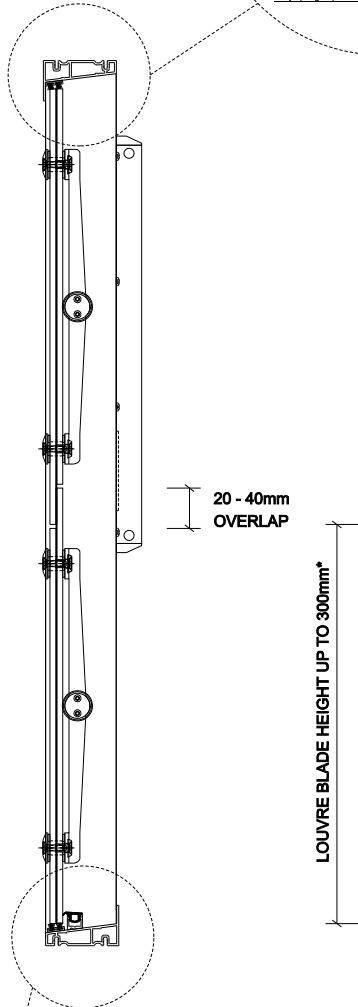

**SECTION**

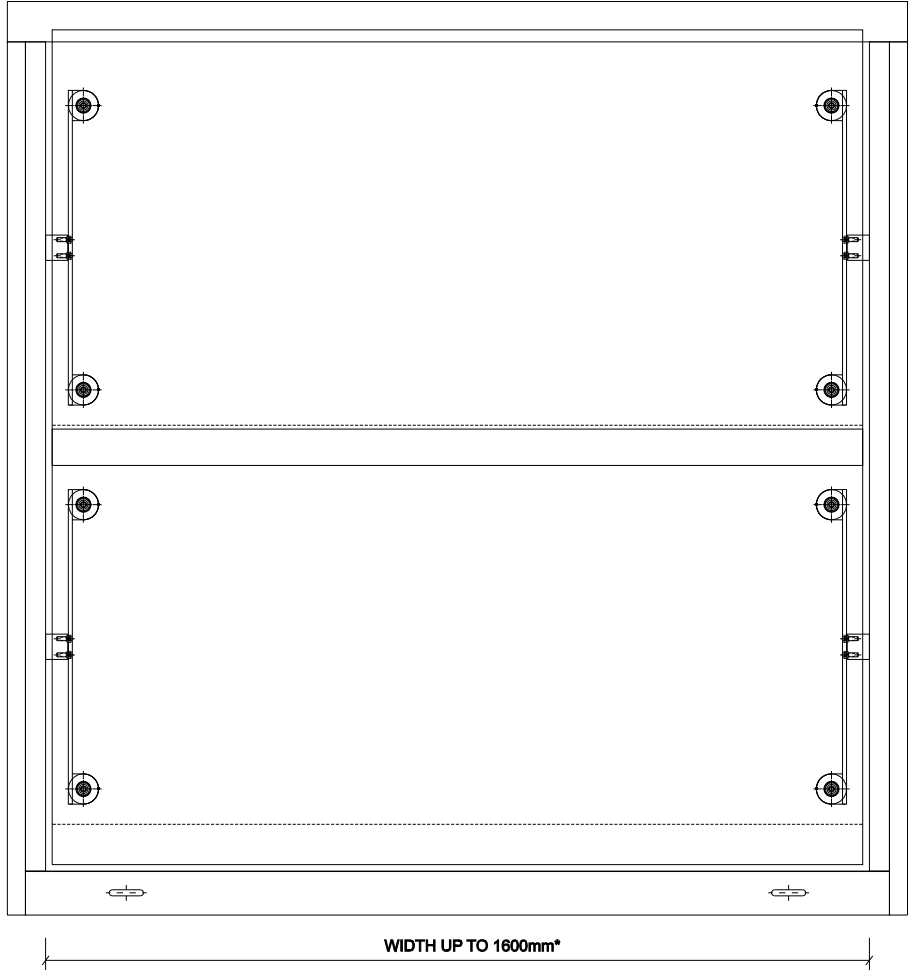

**ELEVATION**

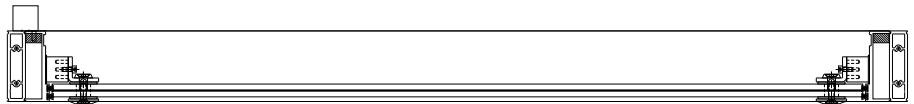

**PLAN**

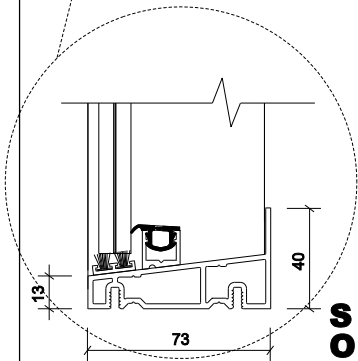

**SILL  
OPTION 01**

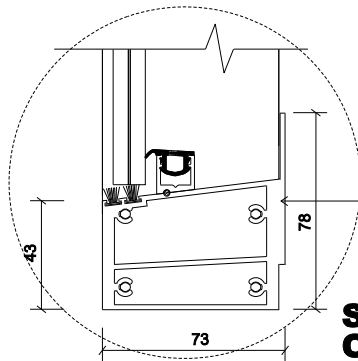

**SILL  
OPTION 02**

## G12-FS LOUVRE SYSTEM



# G12-FS

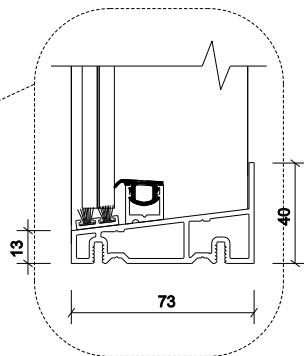
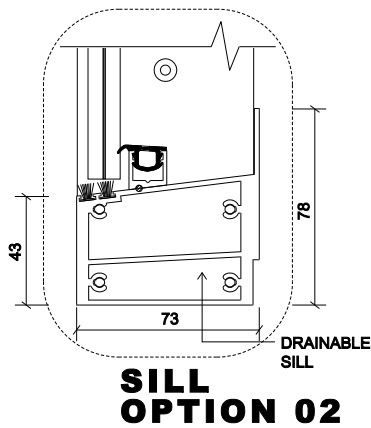
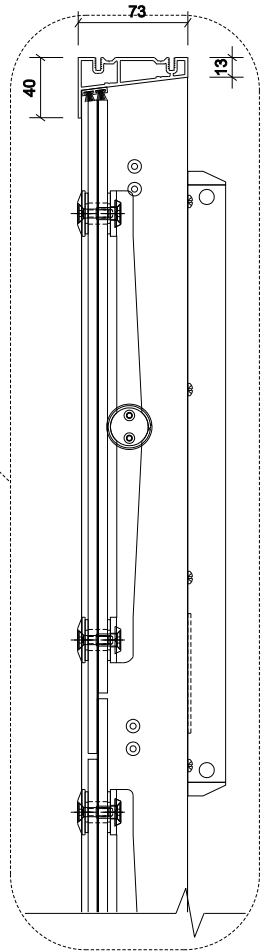
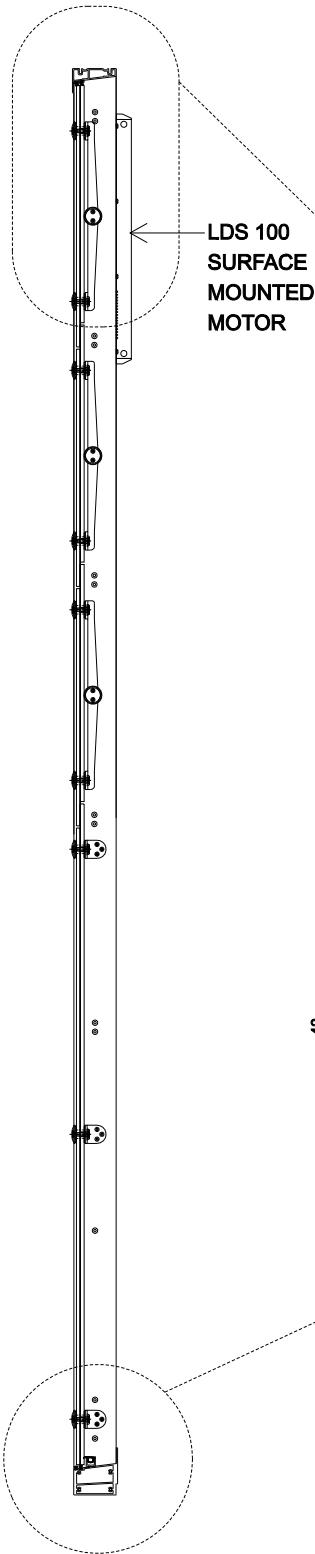

LOUVRE BLADE HEIGHT:  
UP TO 300mm\*

FIXED BALUSTRADE

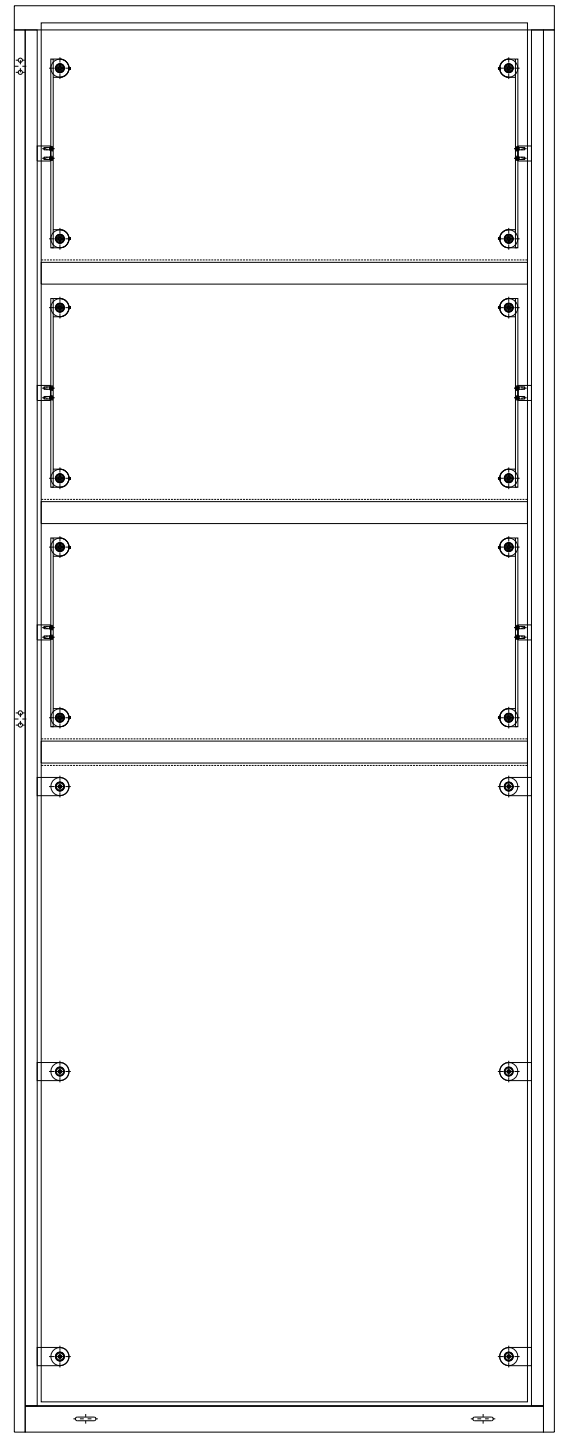

WIDTH UP TO 1600mm\*

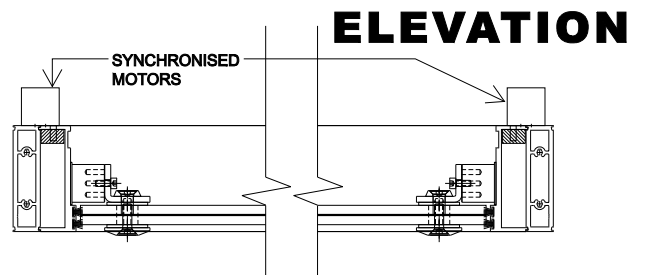

## G12-FS WITH BALUSTRADE



www.ebsa.com.au

**G12**

**- DRIVES - HANDLES - WINDERS**

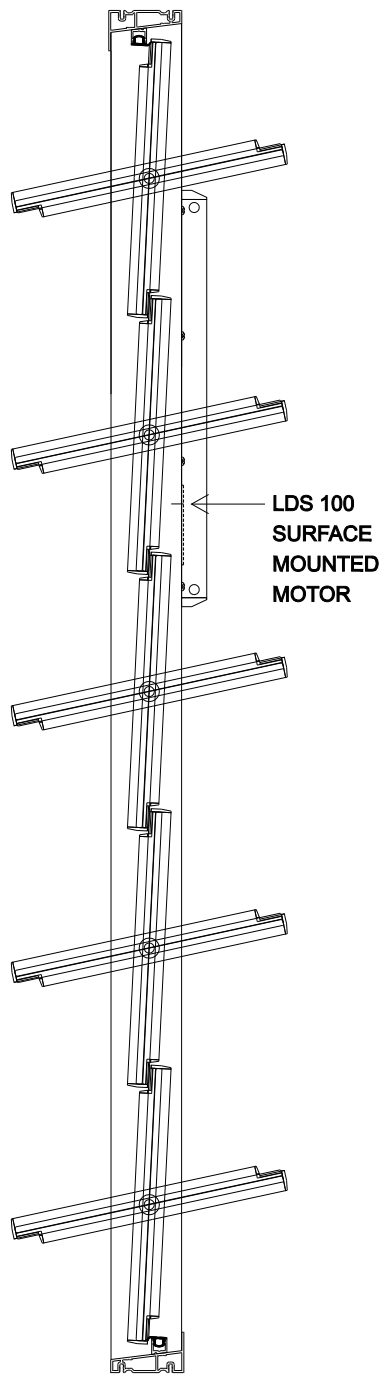

**OPTION 01**

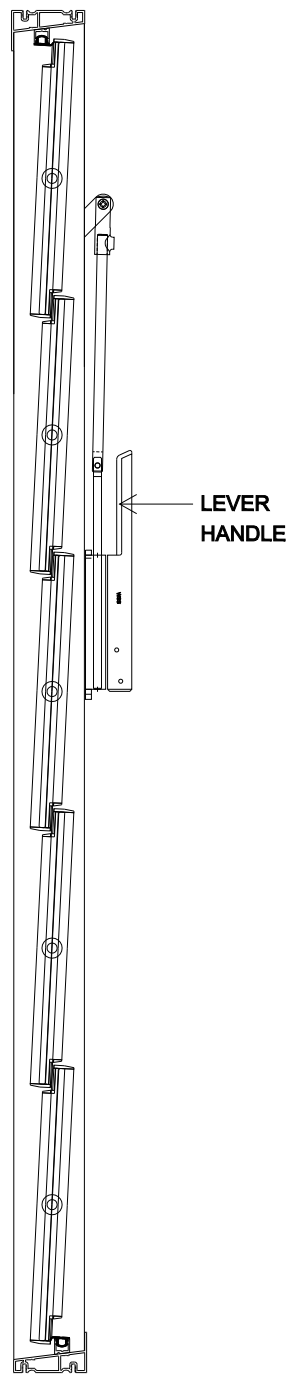

**OPTION 02**

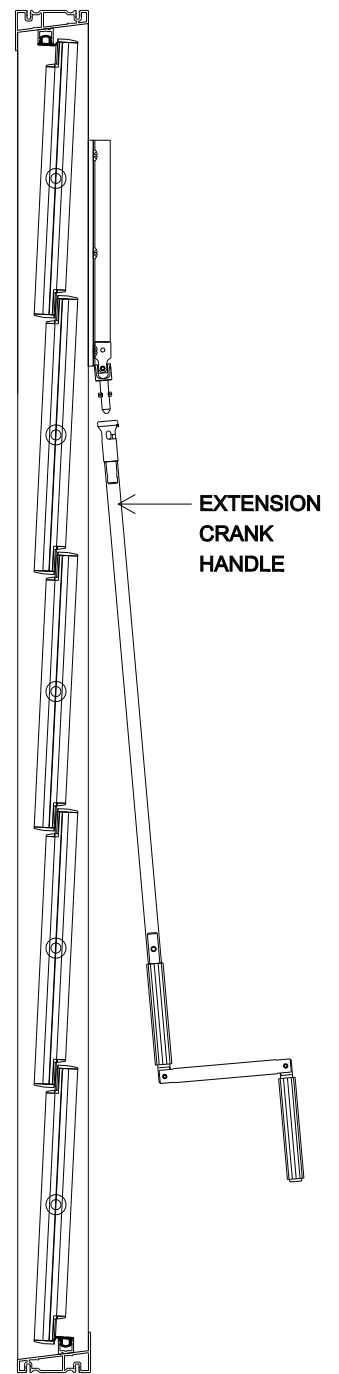

**OPTION 03**

**G12 LOUVRE SERIES**



[www.ebsa.com.au](http://www.ebsa.com.au)

# G12 - INSTALLATION

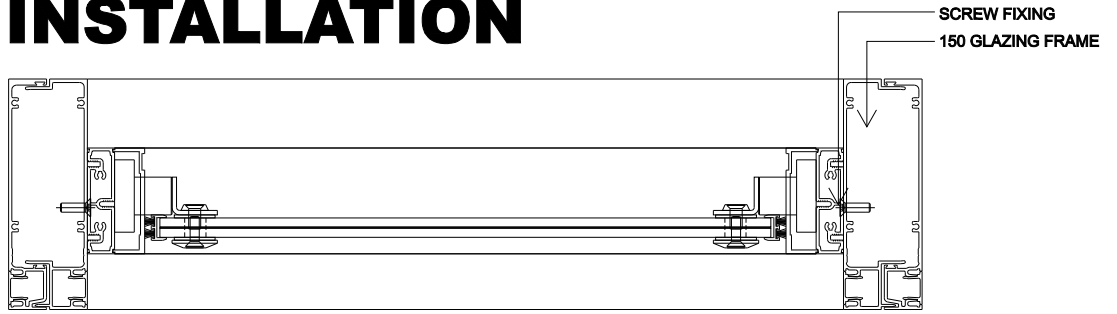

## GLAZING FIXING

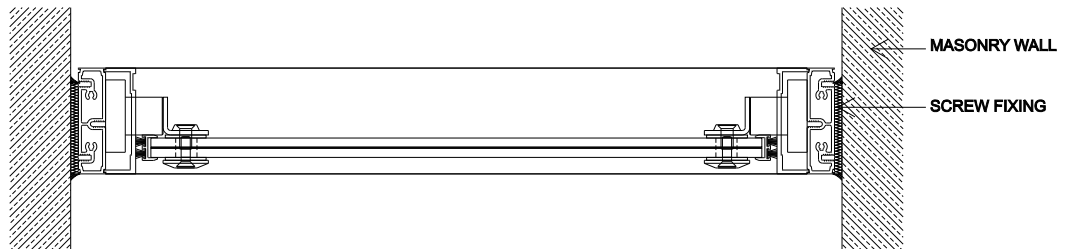

## MASONRY FIXING

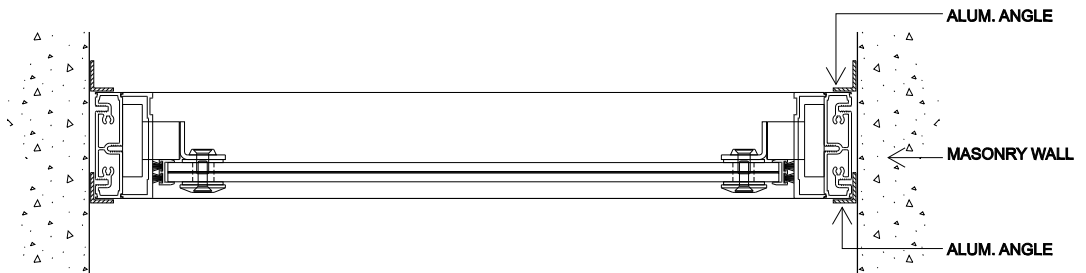

## AL. ANGLE FIXING

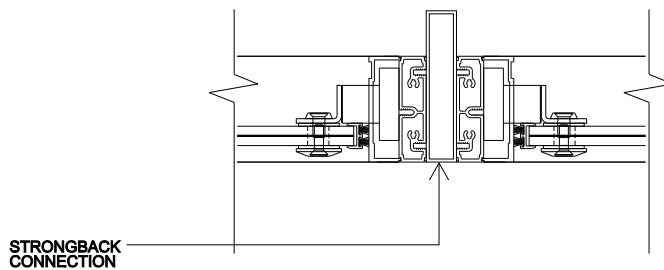

## STRONG BACK

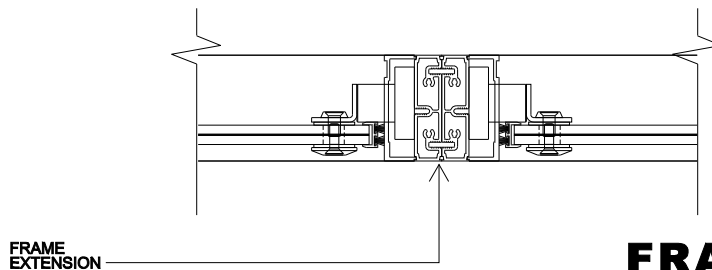

## FRAME EXTENSION

**G12 LOUVRE SERIES**



[www.ebsa.com.au](http://www.ebsa.com.au)