

KEY-ENDURA

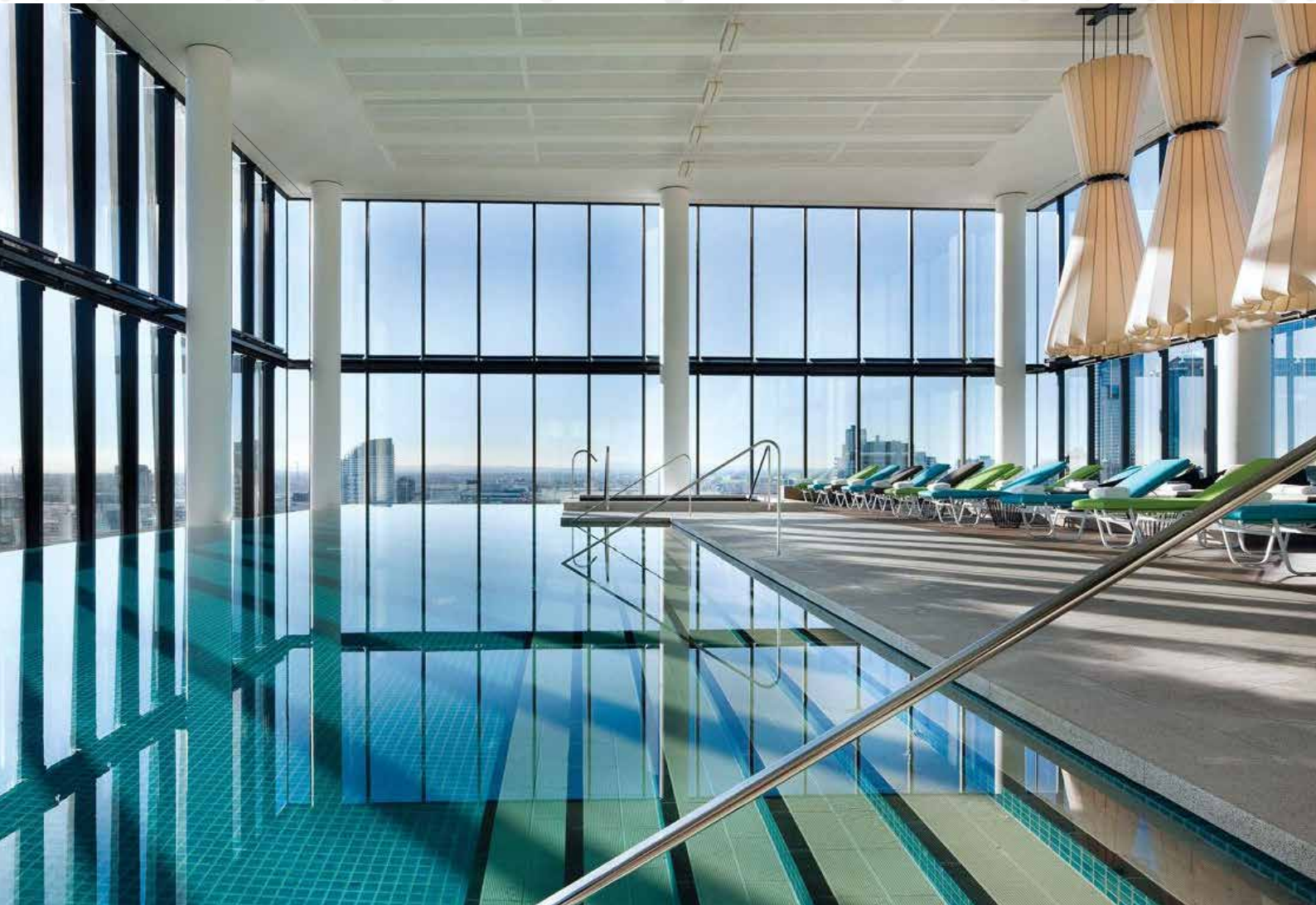

KEYSTONE
LININGS & ACOUSTICS

A graphic element consisting of a grid of blue dots of varying sizes, arranged in a pattern that suggests a circular or semi-circular shape, positioned to the right of the company name.

We bring Architects Imagination to Life

www.KeystoneLinings.com.au



SLOTTED OPTIONS [SE]

Grange Surf Life Saving Club

KEYSTONE LINING offers a range of six standard patterns to choose from to suit your aesthetic and acoustic requirement. Consult the team at [KEYSTONE LINING](http://www.KeystoneLinings.com.au) for further information.

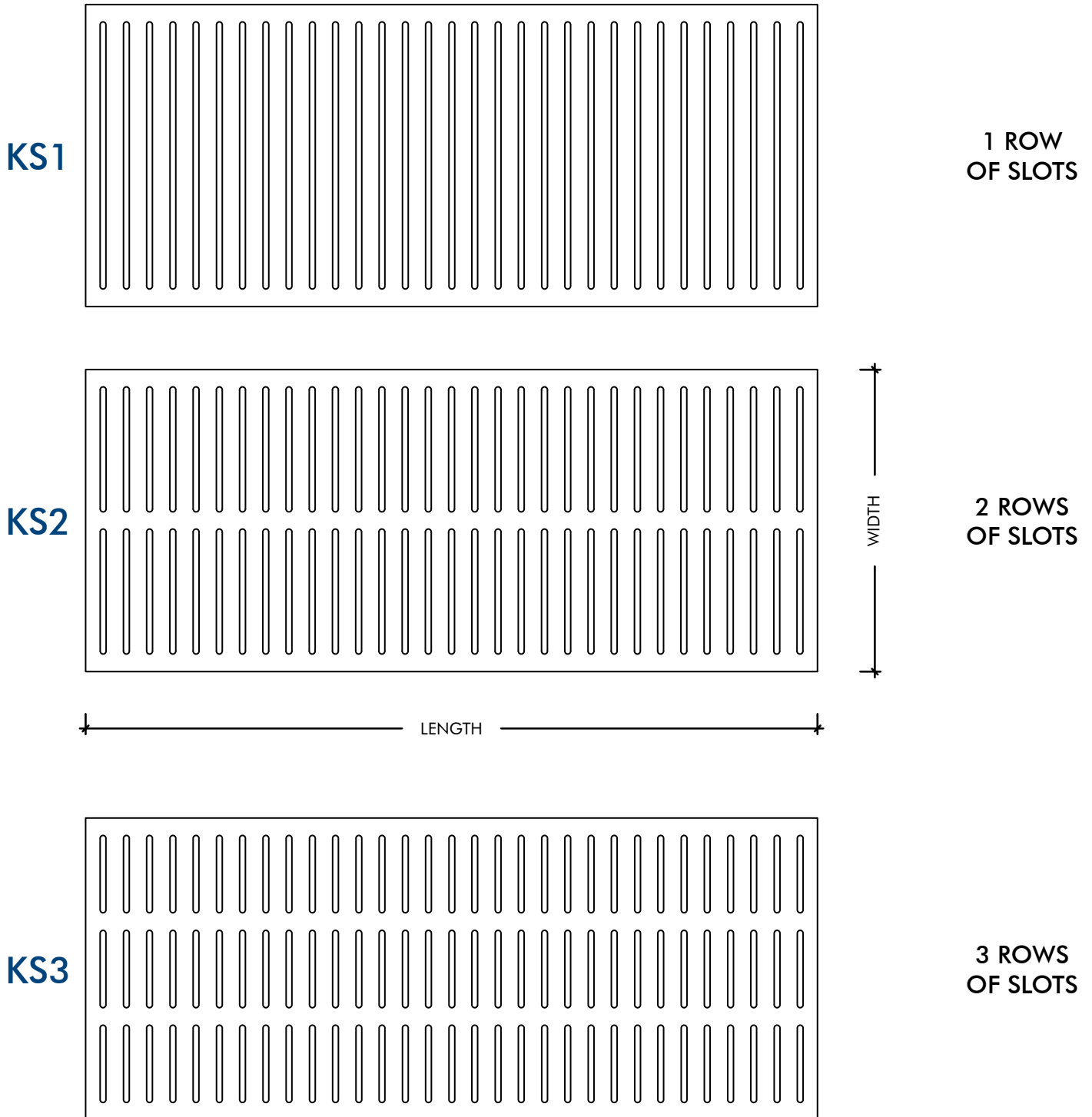

WHERE APPLICABLE GRAIN DIRECTION ALONG THE LENGTH OF PANELS.

KEY-ENDURA [SE]

SLOTTED OPTIONS



KEYSTONE LINING offers a range of six standard patterns to choose from to suit your aesthetic and acoustic requirement. Consult the team at [KEYSTONE LINING](#) for further information.

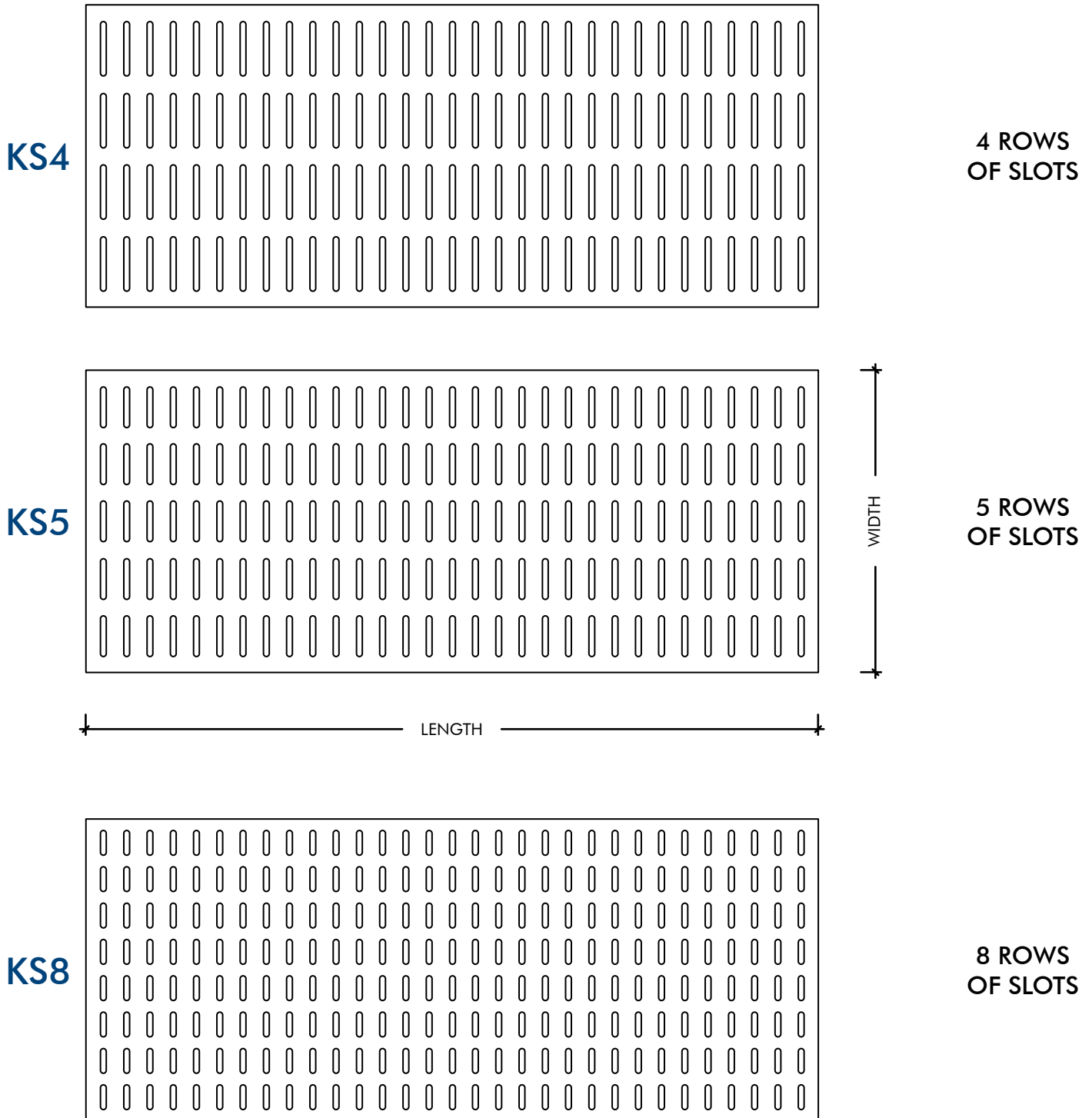

WHERE APPLICABLE GRAIN DIRECTION ALONG THE LENGTH OF PANELS.

KEY-ENDURA [SE]

SLOTTED OPTIONS - KS2/40/G

| LEGEND | |
|--------|-------------------------|
| A | PANEL LENGTH |
| B | PANEL WIDTH |
| C | BORDER IN LENGTH |
| D | BORDER IN WIDTH |
| E | SLOTTING SIZE IN LENGTH |
| F | SLOTTING SIZE IN WIDTH |
| G | SLOTS WIDTH |
| H | WEBB WIDTH |

| KEY INFORMATION | |
|-----------------|--------------|
| PATTERN | KS2 |
| LAYOUT TYPE | 2 ROWS |
| SPACING | 40mm |
| BORDER | 50mm NOMINAL |

| SLOTTING / PERCENTAGE OF OPEN AREA | | | | | | |
|------------------------------------|------|------|------|------|---|---|
| SLOT SIZE (mm) | 9 | 10 | 12 | 13 | - | - |
| OPEN AREA (%) | 21.5 | 23.9 | 28.5 | 30.9 | - | - |

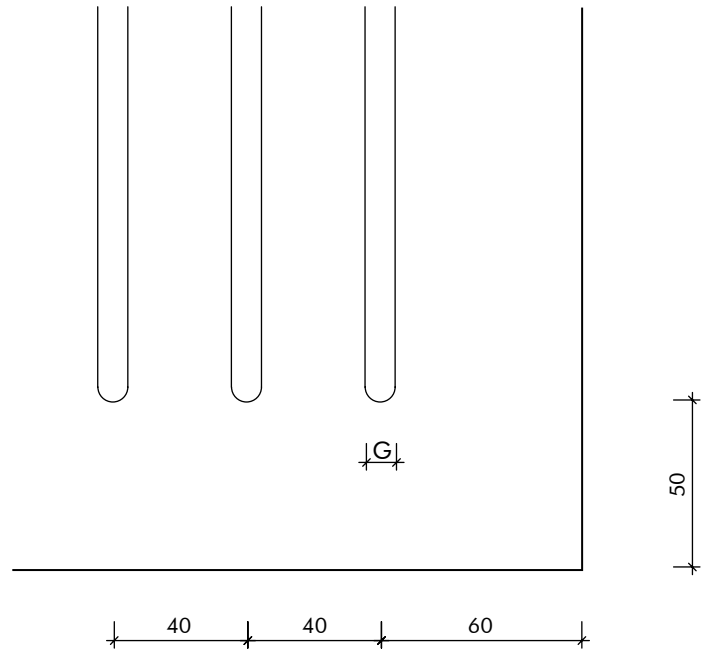

02 SLOTTING DETAIL
Scale - NTS

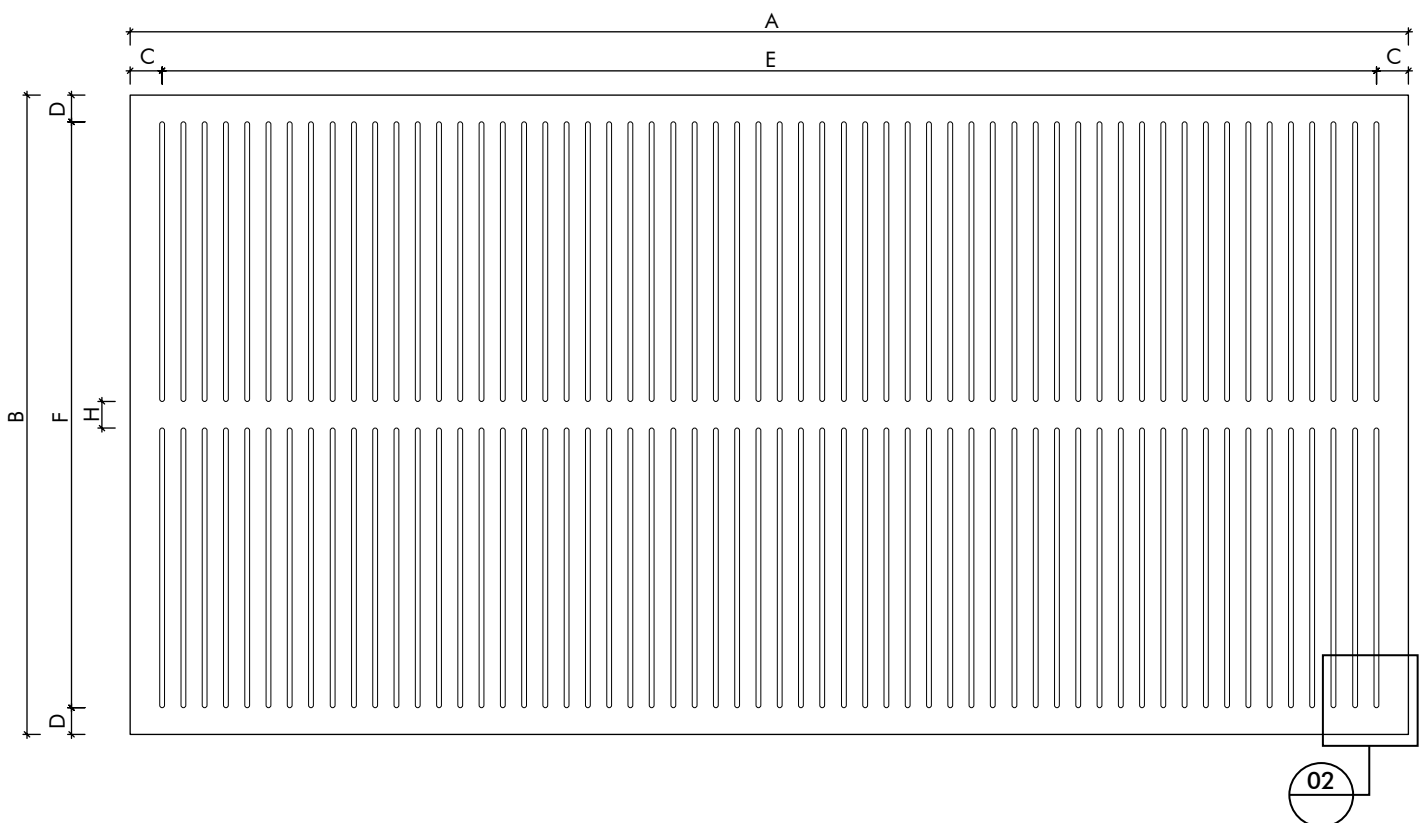

KEY-ENDURA [SE]

SLOTTED OPTIONS - KS3/40/G

| LEGEND | |
|--------|-------------------------|
| A | PANEL LENGTH |
| B | PANEL WIDTH |
| C | BORDER IN LENGTH |
| D | BORDER IN WIDTH |
| E | SLOTTING SIZE IN LENGTH |
| F | SLOTTING SIZE IN WIDTH |
| G | SLOTS WIDTH |
| H | WEBB WIDTH |

| KEY INFORMATION | |
|-----------------|--------------|
| PATTERN | KS3 |
| LAYOUT TYPE | 3 ROWS |
| SPACING | 40mm |
| BORDER | 50mm NOMINAL |

| SLOTTING / PERCENTAGE OF OPEN AREA | | | | | | |
|------------------------------------|------|------|------|------|------|---|
| SLOT SIZE (mm) | 9 | 10 | 12 | 13 | 15 | - |
| OPEN AREA (%) | 20.4 | 22.7 | 27.1 | 29.3 | 33.7 | - |

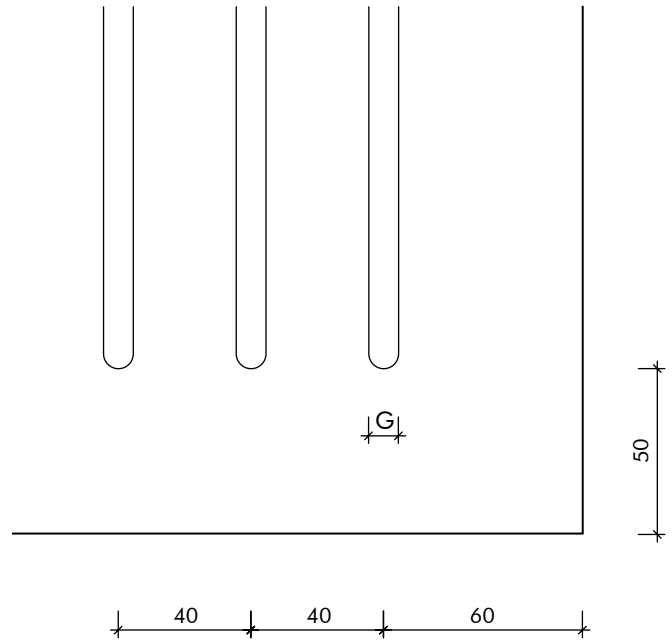

02 SLOTTING DETAIL
Scale - NTS

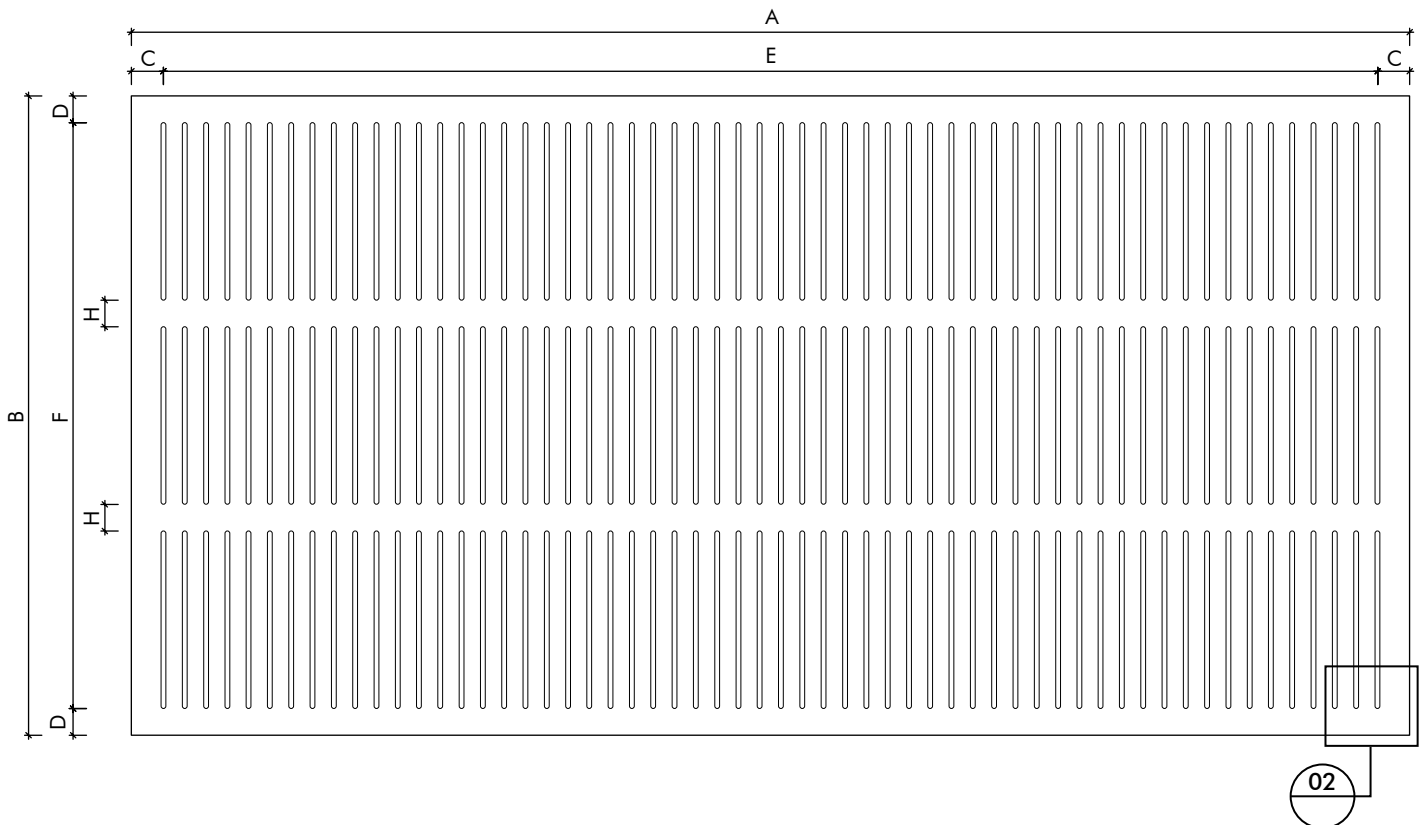

KEY-ENDURA [SE]

SLOTTED OPTIONS - KS4/40/G

| LEGEND | |
|--------|-------------------------|
| A | PANEL LENGTH |
| B | PANEL WIDTH |
| C | BORDER IN LENGTH |
| D | BORDER IN WIDTH |
| E | SLOTTING SIZE IN LENGTH |
| F | SLOTTING SIZE IN WIDTH |
| G | SLOTS WIDTH |
| H | WEBB WIDTH |

| KEY INFORMATION | |
|-----------------|--------------|
| PATTERN | KS4 |
| LAYOUT TYPE | 4 ROWS |
| SPACING | 40mm |
| BORDER | 50mm NOMINAL |

| SLOTTING / PERCENTAGE OF OPEN AREA | | | | | | |
|------------------------------------|------|------|------|------|---|---|
| SLOT SIZE (mm) | 9 | 10 | 13 | 15 | - | - |
| OPEN AREA (%) | 19.4 | 21.5 | 27.7 | 31.9 | - | - |

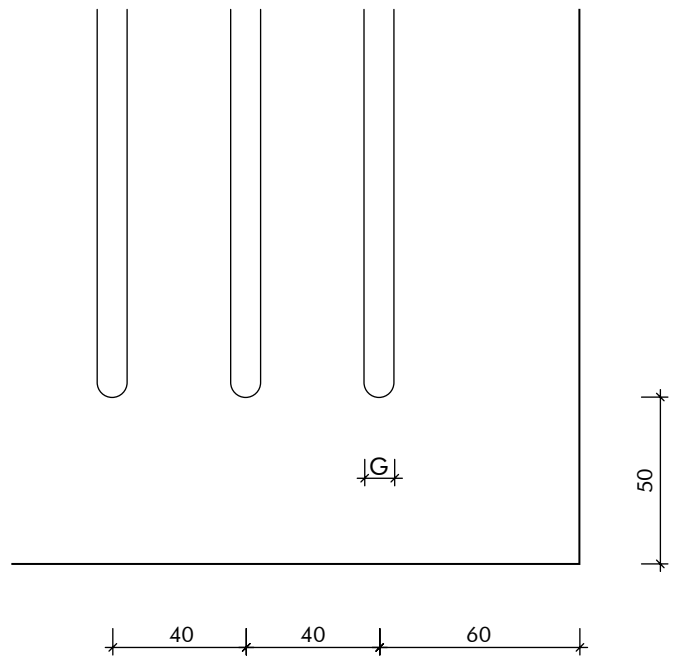

02 SLOTTING DETAIL
Scale - NTS

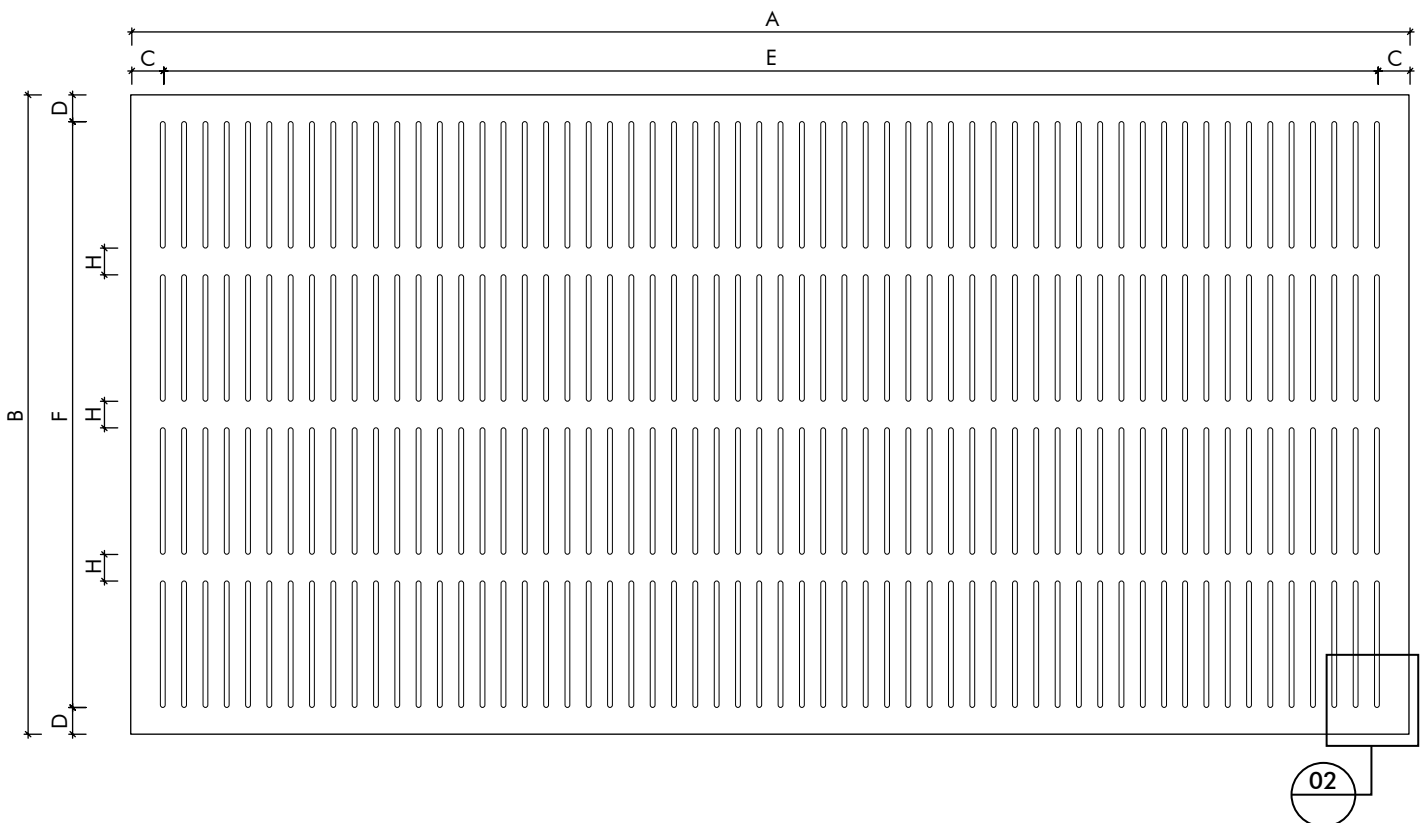

KEY-ENDURA [SE]

SLOTTED OPTIONS - KS5/40/G

| LEGEND | |
|--------|-------------------------|
| A | PANEL LENGTH |
| B | PANEL WIDTH |
| C | BORDER IN LENGTH |
| D | BORDER IN WIDTH |
| E | SLOTTING SIZE IN LENGTH |
| F | SLOTTING SIZE IN WIDTH |
| G | SLOTS WIDTH |
| H | WEBB WIDTH |

| KEY INFORMATION | |
|-----------------|--------------|
| PATTERN | KS5 |
| LAYOUT TYPE | 5 ROWS |
| SPACING | 40mm |
| BORDER | 50mm NOMINAL |

| SLOTTING / PERCENTAGE OF OPEN AREA | | | | | | |
|------------------------------------|------|------|------|---|---|---|
| SLOT SIZE (mm) | 9 | 10 | 13 | - | - | - |
| OPEN AREA (%) | 18.3 | 20.3 | 26.2 | - | - | - |

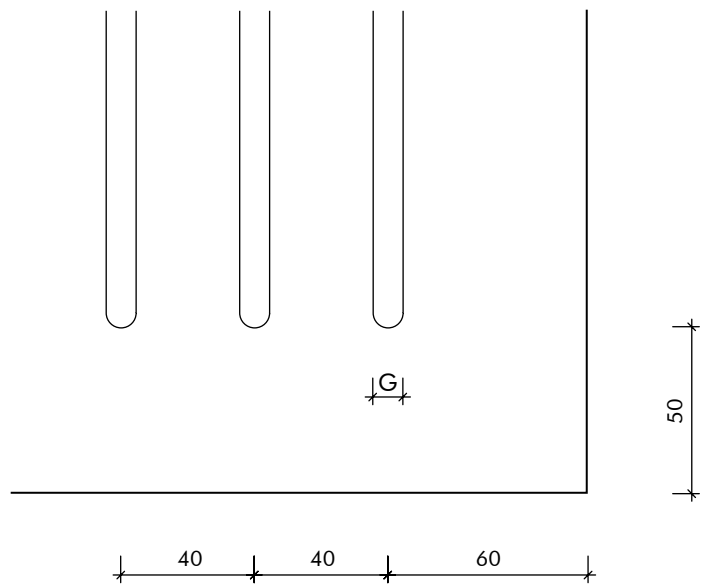

02 SLOTTING DETAIL
Scale - NTS

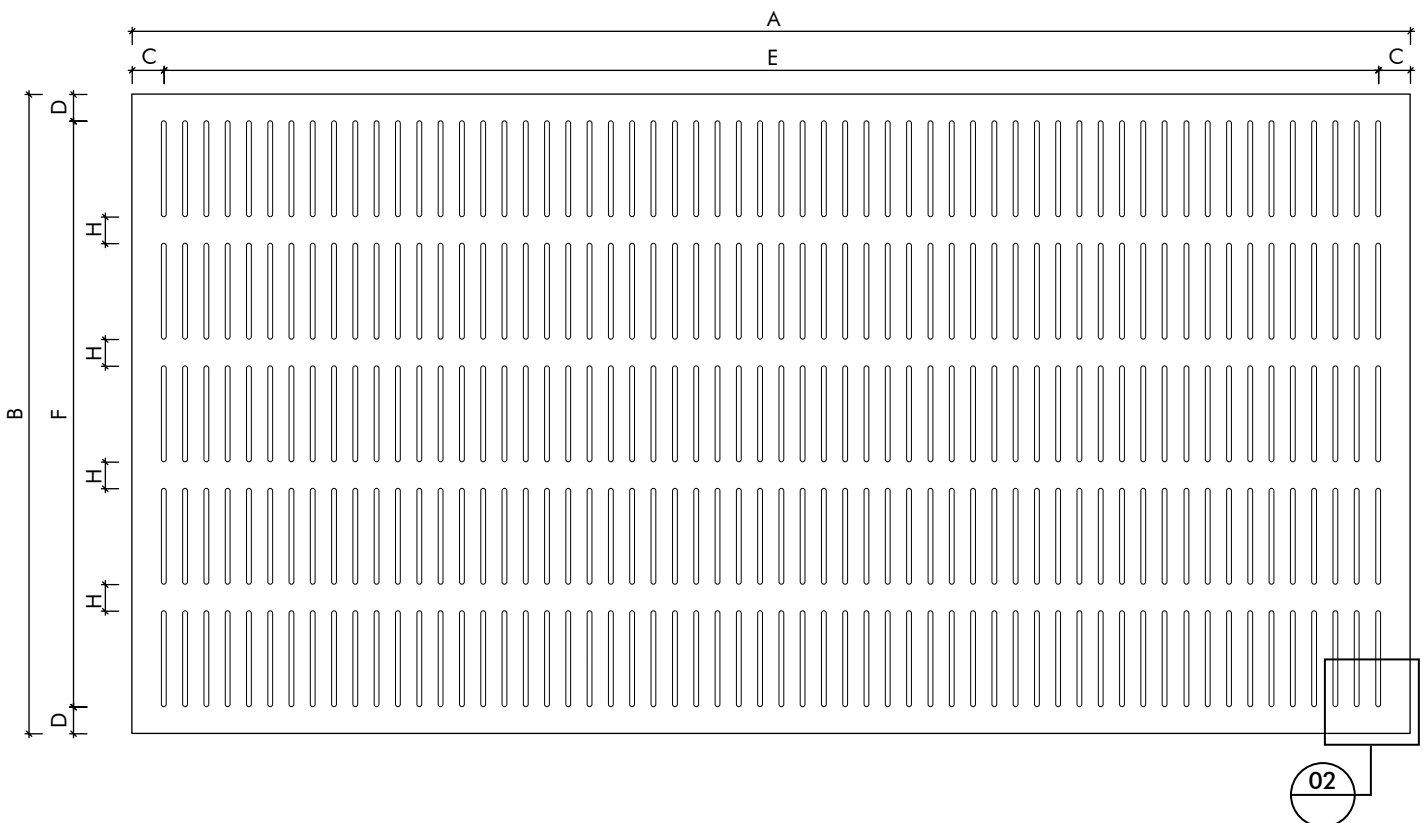

KEY-ENDURA [SE]

SLOTTED OPTIONS - KS8/40/G

| LEGEND | |
|--------|-------------------------|
| A | PANEL LENGTH |
| B | PANEL WIDTH |
| C | BORDER IN LENGTH |
| D | BORDER IN WIDTH |
| E | SLOTTING SIZE IN LENGTH |
| F | SLOTTING SIZE IN WIDTH |
| G | SLOTS WIDTH |
| H | WEBB WIDTH |

| KEY INFORMATION | |
|-----------------|--------------|
| PATTERN | KS8 |
| LAYOUT TYPE | 8 ROWS |
| SPACING | 40mm |
| BORDER | 50mm NOMINAL |

| SLOTTING / PERCENTAGE OF OPEN AREA | | | | | | |
|------------------------------------|------|------|------|------|------|---|
| SLOT SIZE (mm) | 9 | 10 | 13 | 15 | 20 | - |
| OPEN AREA (%) | 15.1 | 16.7 | 21.5 | 24.6 | 32.2 | - |

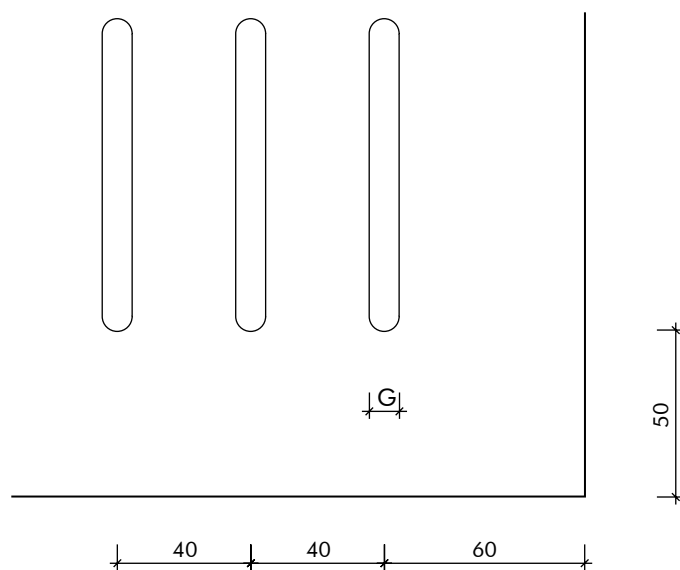

02 SLOTTING DETAIL
Scale - NTS



HOMESTART FINANCE



CROWN METROPOL MELBOURNE



JAMES COOK UNIVERSITY



LIFESTYLE MANOR BONDI





Level 1, 7-8 Davis Road,
Wetherill Park, NSW 2164
02 9604 8813
www.KeystoneLinings.com.au