

“ With the changing demands and design requirements of projects, we need tools to meet the challenges of our current and future built environment. ”

- Fully on line e-book format
- Easy monthly subscription (1st month free)
- Over 1,000 materials and assembly rates
- Direct links to EPD and eco-label listed materials
- Cross references other UK and US respected LCA data points
- ISO and Australian Standards quality

the GreenBook

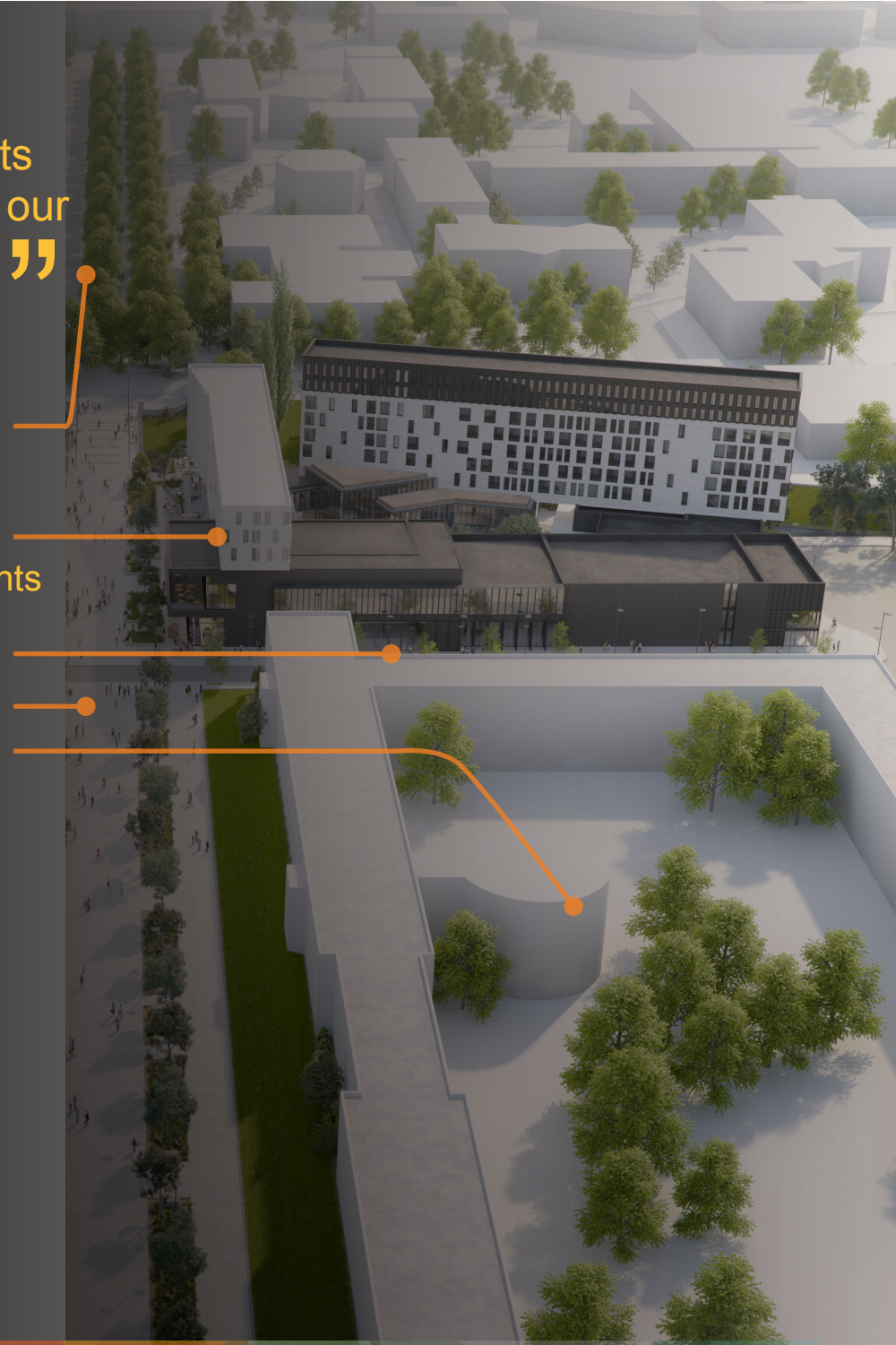

“ Know your impact. Design with The Green Book rates for Carbon and Ecological Footprint. ”

the GreenBook

- Over 1,000 material rates by element - structural systems, walls, finishes, etc.
- Carbon content p/unit, and Ecological Footprint equivalent for all materials
- Available in excel or PDF format
- Rates continually updated and revised
- A 'cost plan' for your ecological budget

900
kg CO₂/m²
double glazed facade

40
kg CO₂/m²
acoustic ceilings

307
kg CO₂/m²
Alpolic on
galvanised framing

142
kg CO₂/m²
cavity brickwork

222
kg CO₂ each
office task chair

34
kg CO₂/m²
nylon carpet



the GreenBook
Inventory of LC Embodied Carbon
for Construction Assemblies

THE FOOTPRINT COMPANY the GreenBook

ELEMENT VARIOUS

| Sub-Element | Material | Description | Unit | Ecological Footprint Gm2/m2a | Embodied Carbon kg CO2 |
|-------------------|---|-------------|------|---------------------------------|---------------------------|
| Insulation | | | | | |
| Aluminium | Foil sarking | | m2 | 12 | 5 |
| Glass | R2.7 glass fibre blanket | | m2 | 48 | 18 |
| | - Ditto above (RECYCLED 95%) | | m2 | 40 | 15 |
| | R2.7 foil faced glass fibre blanket | | m2 | 80 | 23 |
| | - Ditto above (RECYCLED 95%) | | m2 | 50 | 15 |
| Mineral | 125mm Rockwool insulation | | m2 | 80 | 31 |
| Other | 100mm Kingspan insulated steel faced panels | | m2 | 498 | 180 |
| Plastic | 50mm EPS with plastic membrane | | m2 | 189 | 71 |
| | R2.5 polyester batt or blanket | | m2 | 170 | 66 |

THE FOOTPRINT COMPANY the GreenBook

Reinforcement

Fabric

ELEMENT

Sub-Element

Insulation

Roof (other)

Aluminium

Concrete

Plastic

Steel

| Material | Ecological Footprint (Gm2 / m2 Finished area) |
|--------------------------------|---|
| Ortech strawboard wall | 48 |
| 90mm Glavanised steel studwork | 118 |
| 150mm Hebel block (unfinished) | 238 |
| 90mm Timber framing | 370 |
| Mortarless and recycled steel | 550 |

Master Materials Visual Comparison File KP300614

Page 1

Time

- Data on over 1,000 materials all in one place
- Visual guides which quickly show preferred arrangement
- Includes many eco labelled materials (AusEPD, GreenTag etc.)
- Organised by building element for easy use
- Fully searchable
- Automatic updates

Cost

- Save cost associated with time for research - get payback within 1 day
- Minimal set up costs and minimal training required

Quality

- Manage the design process & work-flow
- No need to engage additional consultants to complete LCA assessments
- Increase brand
- Increase service offering
- All data consistent with ISO 14044 and industry peer reviewed

49
Basic Materials

114
Structure

185
Envelope & Facade

220
Interior Walls & Finishes

255
Finishes

147
FF&E

155
Services

25
External Works