

**rogerseller**  
**AMÉLIE**



## MELBOURNE

173-177 Barkly Avenue  
Burnley VIC 3121  
P 03 9429 8888 F 03 9429 6966

## SYDNEY

PYD Building  
197 Young Street  
Waterloo NSW 2017  
P 02 8396 8700 F 02 9690 2804

## BRISBANE

72-78 McLachlan Street  
Fortitude Valley QLD 4006  
P 07 3251 4333 F 07 3257 2155

## PERTH

153 Broadway  
Nedlands WA 6909  
P 08 6389 1366 F 08 6389 1466

## CONCEPT STORES

Southern Innovations  
Canberra ACT  
P 02 6126 1155 F 02 6126 1156  
Albury NSW  
P 02 6049 3355 F 02 6049 3356

## NCP Bathroom Centres

Noosaville QLD  
P 07 5449 7577 F 07 5449 7648  
Maroochydore QLD  
P 07 5443 2522 F 07 5443 5415  
Caloundra QLD  
P 07 5491 4422 F 07 5491 4747

## Vogue Spas & Bathrooms

Southport QLD  
P 07 5528 0077 F 07 5528 0767

## Becks Timber & Hardware

Launceston TAS  
P: 03 6332 6201 F: 03 6332 6299

## Elite Appliances

Hobart TAS  
P 03 6231 6633 F 03 6231 6662

## WC Bath + Shower

Chatswood NSW  
P 02 9413 3999 F 02 9413 9333

## Routleys Plumbing Innovations

Malvern SA  
P 08 8291 3000 F 08 8291 3099

# AMÉLIE

Rogerseller introduces Amélie, a contemporary interpretation of the traditional claw-foot bath. Inspired by a traditional chaise lounge 'the Méridienne', a 19th century French name given to an asymmetrical daybed with higher headrest and lower footrest.

Designed to be a furniture piece, the clean lines and fine edges provide a sense of lightness, while the lounge-like wrap around head support promotes comfort and relaxation. The single piece is manufactured in Lucite acrylic, presenting a seamless contour which tapers into the narrow stainless steel legs.

Amélie designed and manufactured by Rogerseller, is a unique character that will make a modest statement to any bathroom.

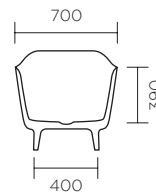
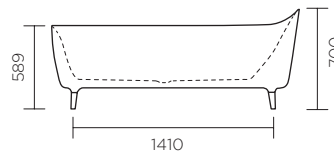
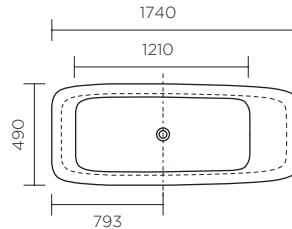

## AMÉLIE FREESTANDING BATH 204010 | White Lucite® Acrylic

- › 1740 x 700 x 700mm
- › High quality, durable 4mm Lucite® Acrylic
- › Polished stainless steel legs
- › Water capacity: 265 litres
- › Weight 63kg, when empty
- › No overflow

 Installation Kit (incl pop up waste and waste cover) included.

 This symbol denotes important installation tips/information.

Dimensions are approximate. Information provided in this brochure is representative of the actual products available at the time of printing. Due to our policy of continuous product development, the designs and specifications depicted are subject to change without notice. Please confirm all particulars with your sales consultant prior to purchase. Each product is covered by a limited warranty. Full terms and conditions are available from your sales consultant.