

INTRIM®

# Intrim 800 Series Shadowline System

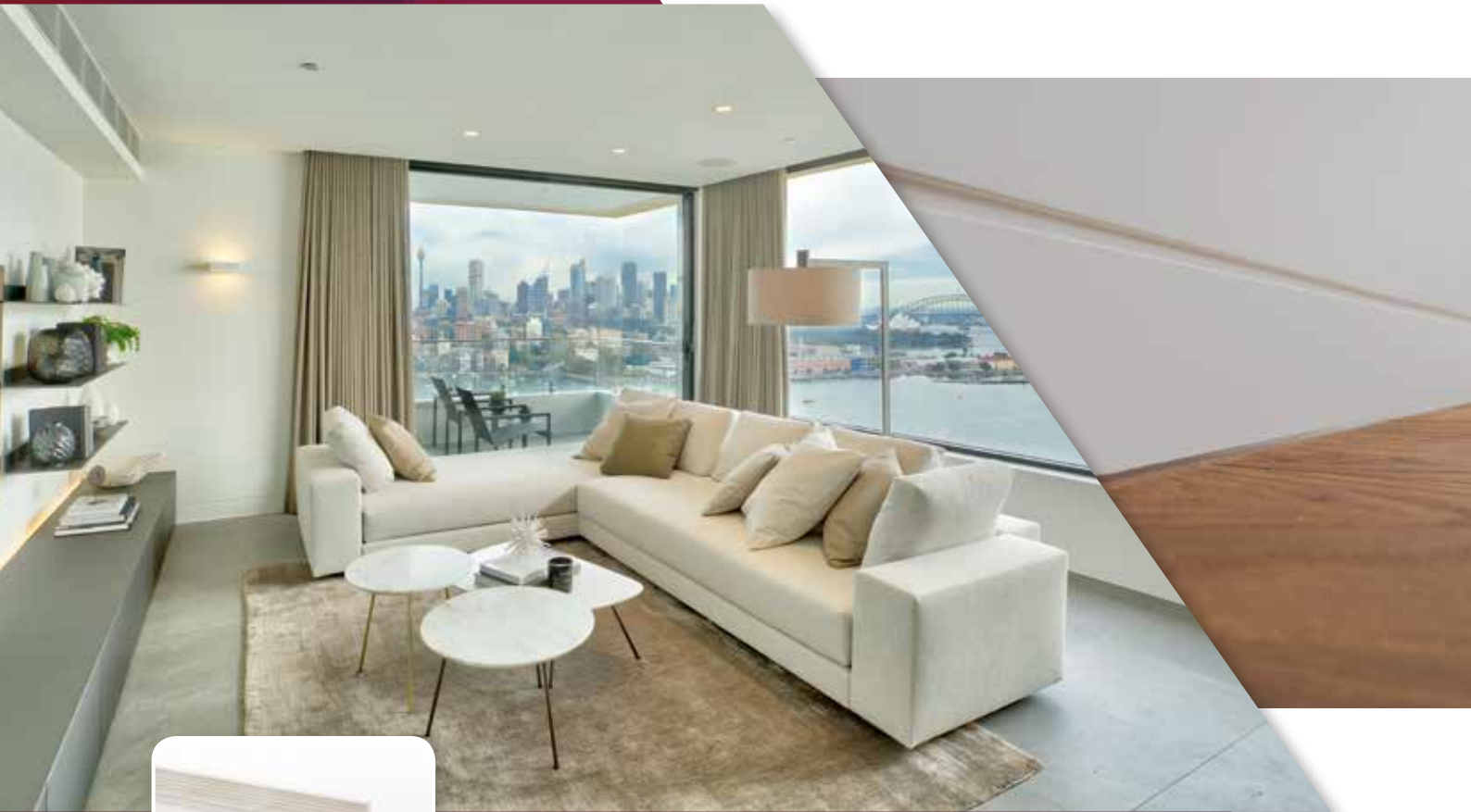

**Create Seamless Shadowline  
the Easy Way!**

— MAKING —  
INTERIORS  
*Spectacular*

# Intrim 800 Series Shadowline System

Eliminate the inconvenience of a traditional shadowline angle and save time with the 800 series skirting and door jamb system.

- DJ800 FJ Pine Shadowline Door Jamb to suit both 70mm and 90mm stud widths and various door rebates. Standard thickness is 40mm and 30mm available upon request.
- SK800 Shadowline Skirting Board to suit 10mm and 13mm plasterboard thickness.

## Profiles



### Intrim SK800 Shadowline Skirting

<b>Overall Height:</b>	90mm, 115mm, 135mm, 185mm, 230mm, 285mm
<b>Thickness:</b>	12mm, 15mm (12mm for 10mm plasterboard, 15mm for 13mm plasterboard)
<b>Shadowline Groove:</b>	10mm high x 6mm deep
<b>Material Options:</b>	FJ Pine Primed, MR MDF Primed
<b>Notes:</b>	Overall height less 25mm is the height to the top of the 10mm Shadowline groove. See diagram 1.



### Intrim SK800FR Fire Rated Shadowline Skirting

<b>Overall Height:</b>	90mm, 115mm, 135mm, 185mm, 230mm, 285mm
<b>Thickness:</b>	18mm
<b>Shadowline Groove:</b>	10mm high x 6mm deep
<b>Material Options:</b>	FR MDF Primed
<b>Notes:</b>	Intrim's Shadowline SK800 Fire Rated Skirting board has been tested and meets AS1530.4-2014 fire rating standards.



### Intrim 2 Piece Shadowline Skirting

<b>Overall Height:</b>	90mm, 115mm, 135mm, 185mm, 230mm, 285mm
<b>Thickness:</b>	SK801-802 12mm, SK803-804 15mm
<b>Shadowline Groove:</b>	10mm high x 6mm deep
<b>Material Options:</b>	FJ Pine Primed, MR MDF Primed
<b>Notes:</b>	For floor finish where skirting is to be installed over floor. Overall height less 42mm is the height to the top of the 10mm Shadowline groove.



### Intrim SK805 Shadowline Skirting

<b>Overall Height:</b>	66mm, 90mm, 115mm, 135mm, 185mm, 230mm, 285mm
<b>Thickness:</b>	12mm, 15mm
<b>Shadowline Groove:</b>	5mm high x 5mm deep
<b>Material Options:</b>	FJ Pine Primed, MR MDF Primed
<b>Notes:</b>	Overall height less 25mm is the height to the top of the 5mm Shadowline groove.



### Shadowline DJ800 Door Jamb

<b>Width:</b>	Manufactured to suit specific wall combination.
<b>Thickness:</b>	30mm, 40mm
<b>Material Options:</b>	FJ Pine, FJ Pine Primed
<b>Notes:</b>	See diagram 3. Various rebate sizes available to suit different door thickness.

**800 SERIES - INTRIM 1 PIECE SHADOWLINE SKIRTING DETAIL**

**DIAGRAM 1**

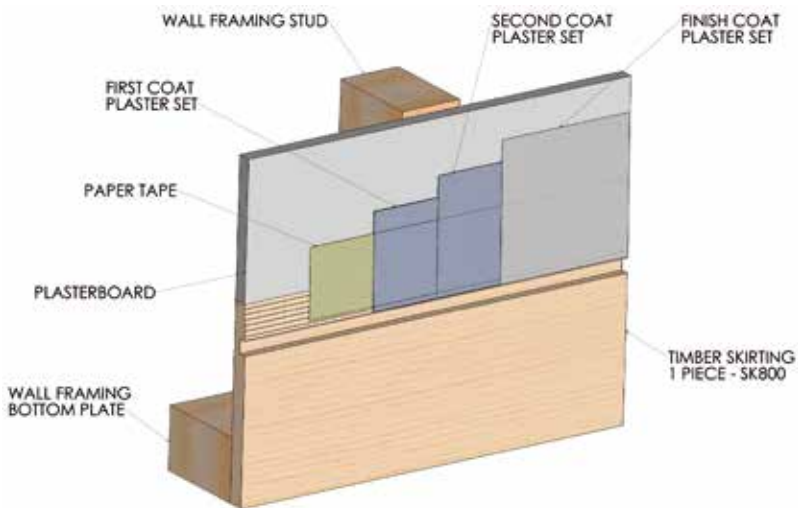

**800 SERIES - INTRIM 2 PIECE SHADOWLINE SYSTEM**

**DIAGRAM 2**

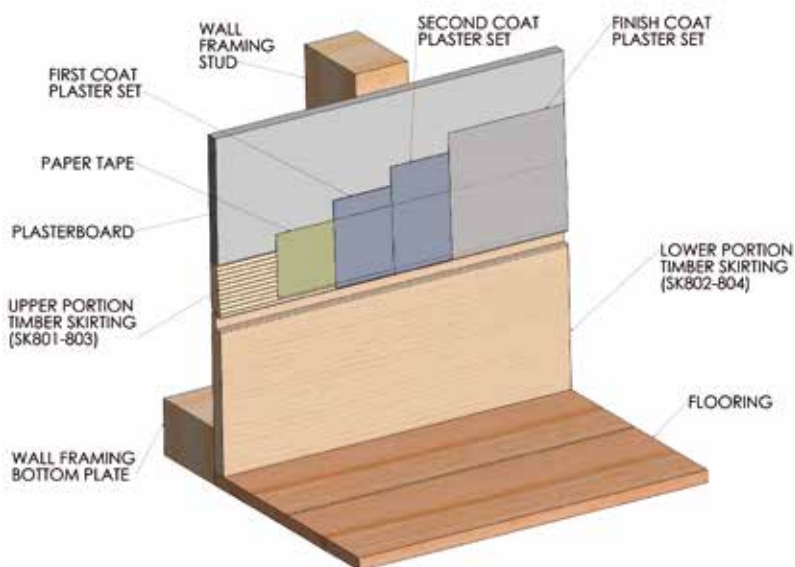

**800 SERIES - INTRIM SHADOWLINE DOOR JAMB DETAIL**

**DIAGRAM 3**

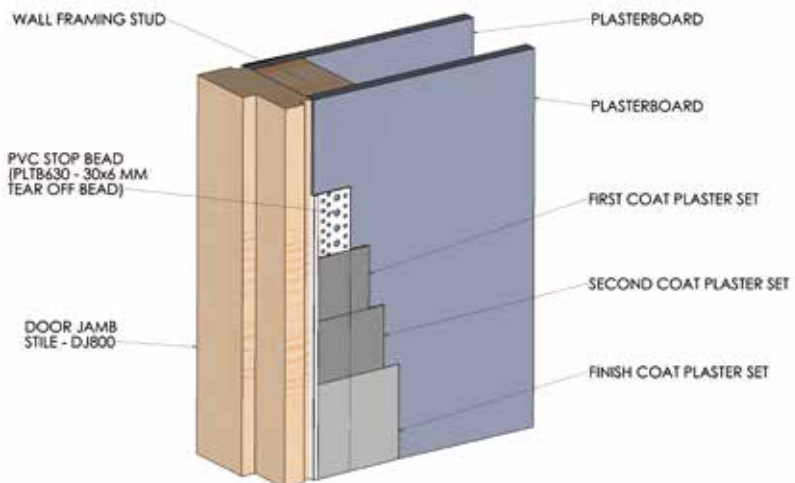

Australian Patent No. AU 2018101091, 2018 and AU 2014100509, 2014

- Create seamless Shadowline skirting & door jambs the easy way
- Fast, neat & eliminates the inconvenience of a metal or PVC 10mm Shadowline bead
- Reduce your building costs & SAVE 30% installation time with Intrim's system
- Available pre-primed in MDF & finger-joined pine



# Benefits



## 1. At what stage of my project is the Intrim 800 Series Shadowline door jamb and skirting installed?

They are both installed prior to the plasterboard installation. Door jambs are assembled by forming mitre joints where the head joins the stiles as opposed to the traditional half joint.

The door jamb is then installed and packed plumb and level. It is critical that the jamb material is centrally located over the framing material and runs parallel with the framing material so that the PVC (PLTB 630) plaster stop bead fits neatly against the door jamb material.

Skirting is installed to fit tightly between the door jambs (see detail).

The plasterboard sheets are then installed tight against the back face of the 800 Series door jamb and on top of 800 Series skirting.

The PVC (PLTB 630) stop bead is then installed to surround the door jambs. All joints between the bottom edge of plasterboard sheeting and top edge of shadowline skirting are to be plaster set and must also include reinforcing joint paper tape when setting. Also plaster set all PVC stop beads surrounding the door jambs.

## 2. What if my flooring needs to be installed after gyprock installed?

Intrim's Two Piece Shadowline SK801-802 and SK803-804 systems have been created to solve this problem! It allows for removal of the bottom piece of skirting so that flooring can be installed and then the Shadowline skirting piece replaced and fixed in place over the top of the flooring.

## 3. Is the Intrim 800 Series Door Jamb available in different section sizes to suit different width wall framing and plasterboard thicknesses?

Yes. We are able to manufacture these to suit any application.

## 4. Is Shadowline 800 Series skirting suitable for carpet and timber flooring applications?

Yes. The one piece SK800 profile is suitable for carpet finish and the 2 piece profile is used in timber or tile flooring applications. Please call 1800 622 081 for details on the two piece skirting for timber flooring or tile applications.

**View installation video at**

[www.intrimmouldings.com.au/shadowline-system](http://www.intrimmouldings.com.au/shadowline-system)

# INTRIM®

Architectural Timber Mouldings & Profiles

P 1800 622 081

E [info@intrimmouldings.com.au](mailto:info@intrimmouldings.com.au)

[intrimmouldings.com.au](http://intrimmouldings.com.au)

EST. 23 YEARS    NATIONWIDE DELIVERY



— MAKING —  
INTERIORS  
*Spectacular*