

KS1100KP Karrier Wall Panel Installation Guide

Horizontally Laid



KS1100KP Karrier Wall Panel

Horizontally Laid

Components

KS1100KP Karrier Wall Panel



Primary fastener
(Carbon Steel)
(Not by Kingspan)



Low profile fasteners
(Carbon Steel)
(Not by Kingspan)



Butyl Nylon Tape
(Applied over recessed washer) (code:SEXT501)



6x4mm butyl tape sealant
(Code: SEXT)



Galvanised ledger angle



Panel clamp



Use panel clamps to ensure full engagement of panel joint when required

Neutral cure gun-grade butyl sealant
(Not by Kingspan)



Recessed Washer
(Galvanised Steel)
(Not by Kingspan)

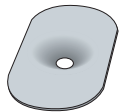

Pre-core panel if using recessed washer



VJ2 EPDM bubble gasket
(Code: VJ2)

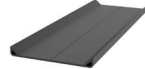

Flat vertical joint flashing



Drip flashing



External corner flashing



Fire rated canister foam
(Not by Kingspan)



This installation guide should be read in conjunction with the 'project specific' design drawings and method statements.

Although this installation guide is deemed to be correct at the time of publication, Kingspan Facades reserve the right to amend the information at any time in the future. Installation Guides are available for the full range of Kingspan Insulated Roof, Wall and Facade Systems.

KS1100KP Karrier Wall Panel

Horizontally Laid

Note:

- Ensure steelwork is suitably lined, levelled and within tolerance.
- All fasteners to be carbon steel, class 4 to maintain panel warranty.
- Neutral cure gun-grade sealant is referred to as gun-grade butyl sealant.
- All sealants to suit project specification requirements.
- Minimum bearing face for vertical joint steelwork is 140mm.
- Minimum bearing face for intermediate support is 50mm. All subject to required number of primary panel fasteners and wind loads.
- Number of fasteners must be calculated based on project spans, wind loads and rainscreen load.
- Panels to be installed with male edge facing up.
- Ensure panel joints are pulled tight to adjacent panels to close any gaps as works progress.
- This installation guide provides generic guidance on installation methods, however, should be read in conjunction with project specific specifications and construction details.
- Install fasteners with recommended screw gun speed selection for type of steel, use correct socket and drive bit, including depth – locating nose piece, unless fastener has feature to prevent overdriving, in line with fastener manufacturers.
- Use panel clamps to ensure full engagement of panel joint when required.
- Protective film to be removed from external weather face of panel & internal liner where applicable prior to installation.
- Clean swarf off panels immediately when created.

Site Applied Weather Seals

Continuous bead (approx. 7mm) is site applied in the female joint on the external face side.

Internal Face

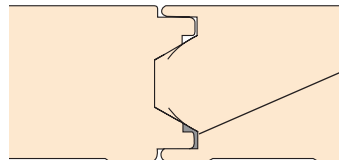

continuous site applied neutral cure gun-grade butyl seal in the external female joint to provide an air and weather seal

External Face

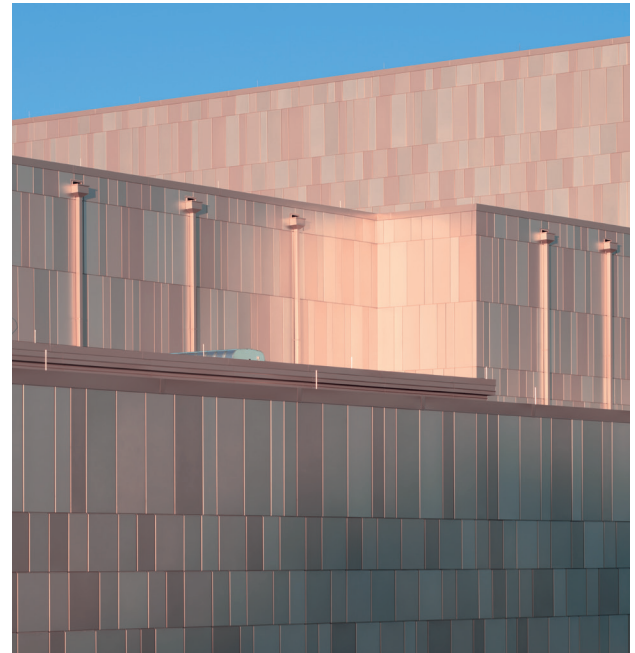

Please contact Kingspan Technical Services Department for guidance:

- Internal air seals
- High humidity & hygiene internal environment
- Project specific advice

KS1100KP Karrier Wall Panel

Horizontally Laid

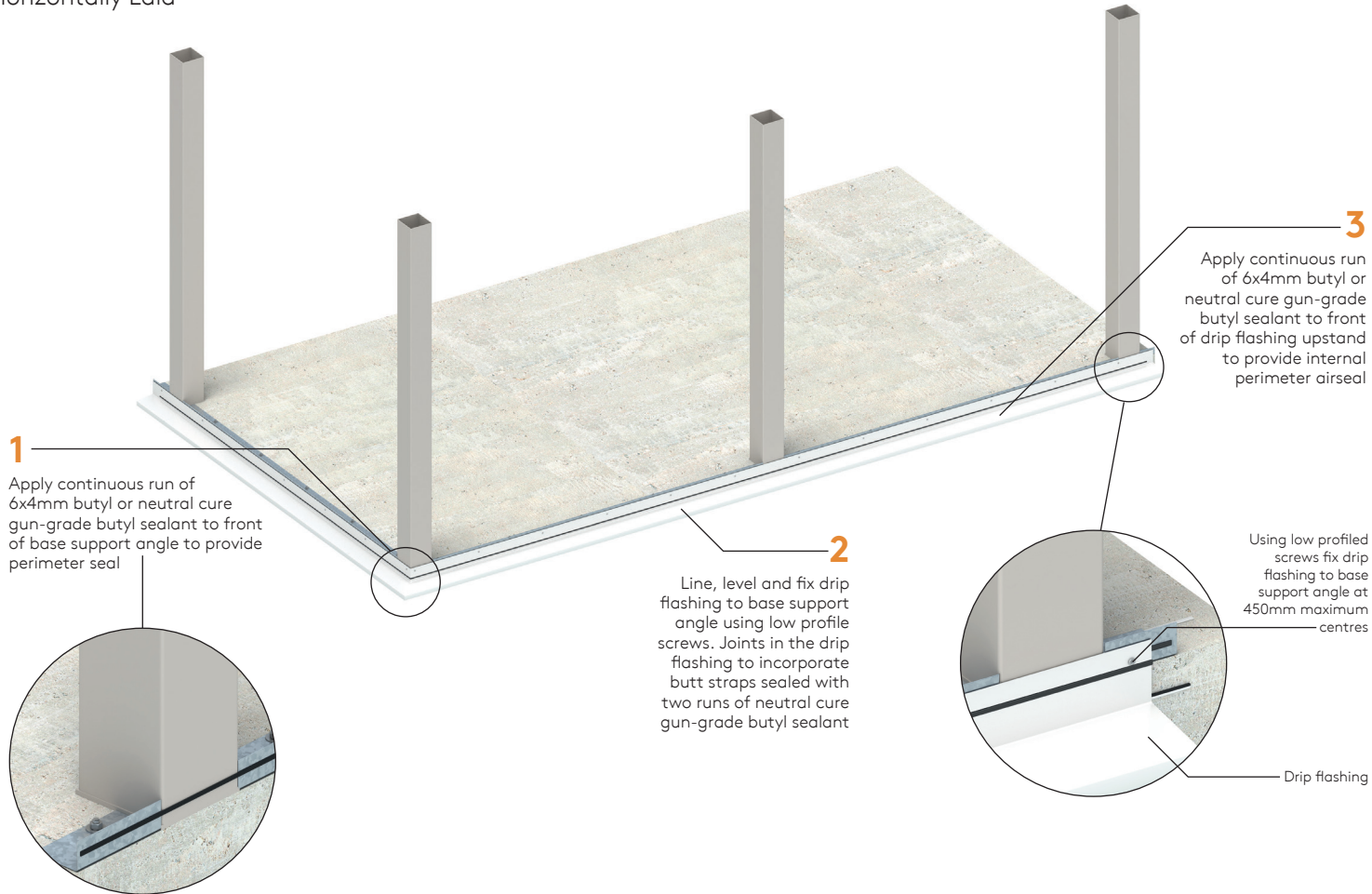

KS1100KP Karrier Wall Panel

Horizontally Laid



KS1100KP Karrier Wall Panel

Horizontally Laid

Note: Due to additional load from facade, panels must be fixed with a minimum of 3 No. fasteners, with recessed washer per panel at each panel end, subject to wind loads.

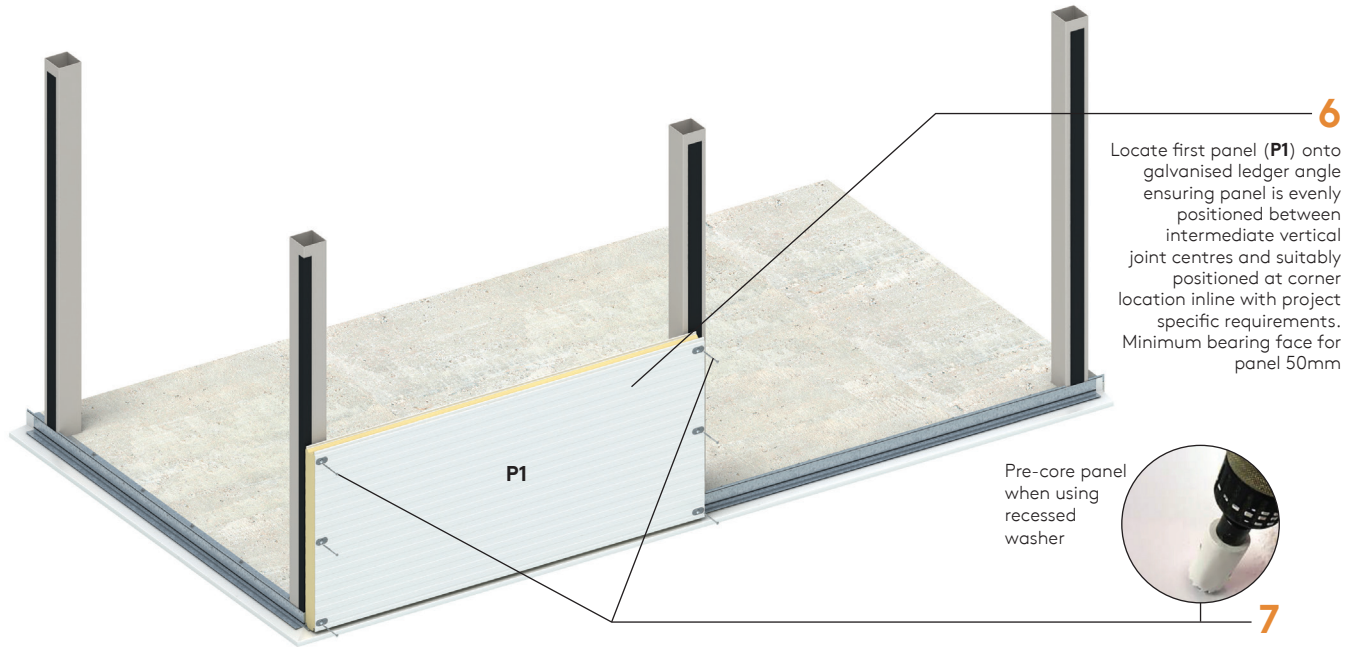

6
Locate first panel (**P1**) onto galvanised ledger angle ensuring panel is evenly positioned between intermediate vertical joint centres and suitably positioned at corner location inline with project specific requirements. Minimum bearing face for panel 50mm

Pre-core panel when using recessed washer

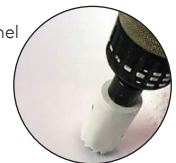

7
Install 3 No. primary fastener with recessed washer, approximately 50mm down from horizontal panel joint to each panel end (minimum).

Apply butyl nylon tape patch over recessed washer



KS1100KP Karrier Wall Panel

Horizontally Laid

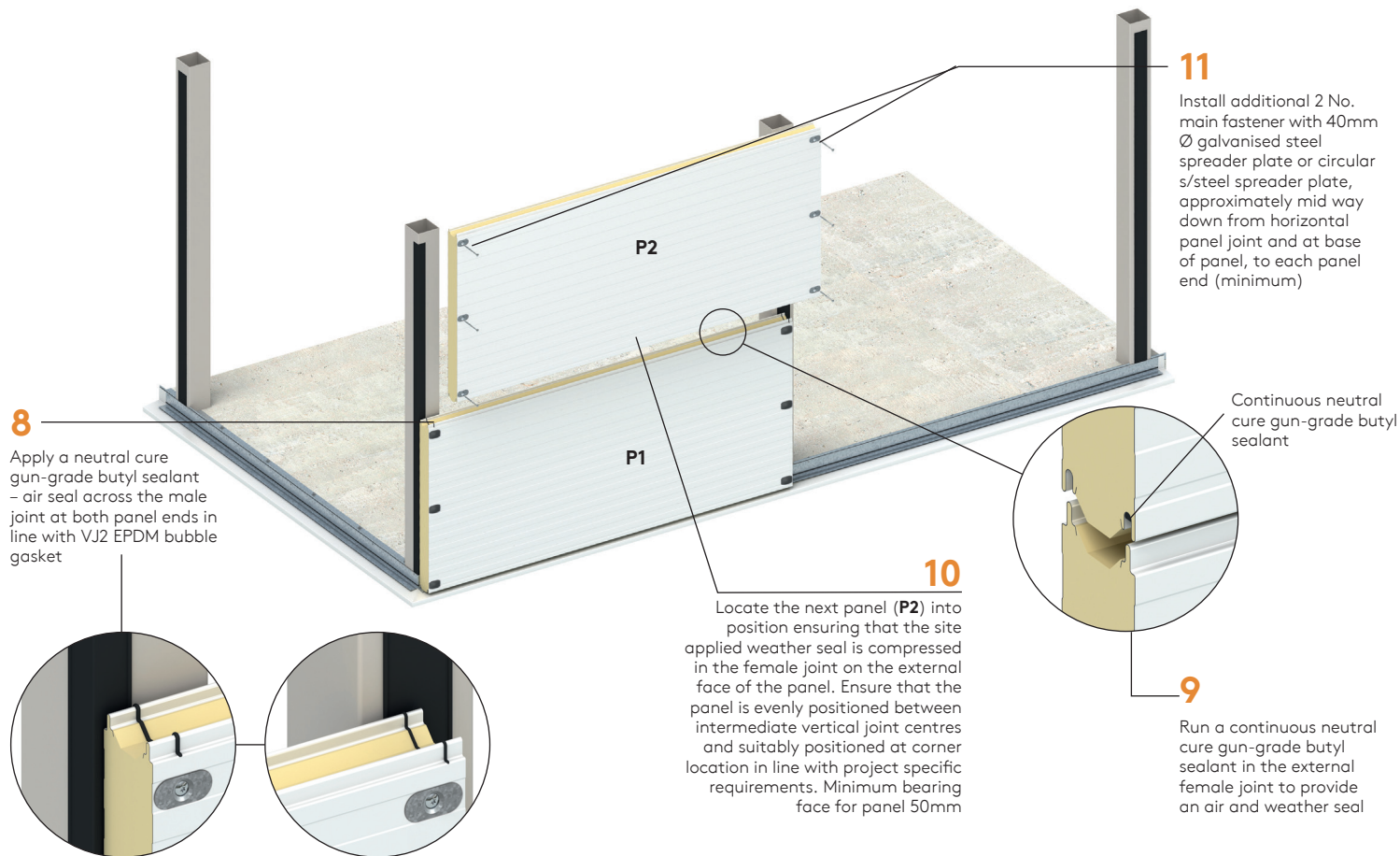

KS1100KP Karrier Wall Panel

Horizontally Laid

14

Apply a neutral cure gun-grade butyl sealant – air seal across the male joint at panel ends in line with VJ2 EPDM bubble gasket.



13

Install 3 No. primary fasteners with recessed washer approximately 50mm down from horizontal panel joint to each panel end (minimum).

12

Locate third panel (**P3**) onto galvanised ledger angle ensuring panel is evenly positioned between intermediate vertical joint centres and suitably positioned at corner location in line with project specific requirements.
Minimum bearing face for panel 50mm

15

Install panel (P4) as per steps 12 to 14

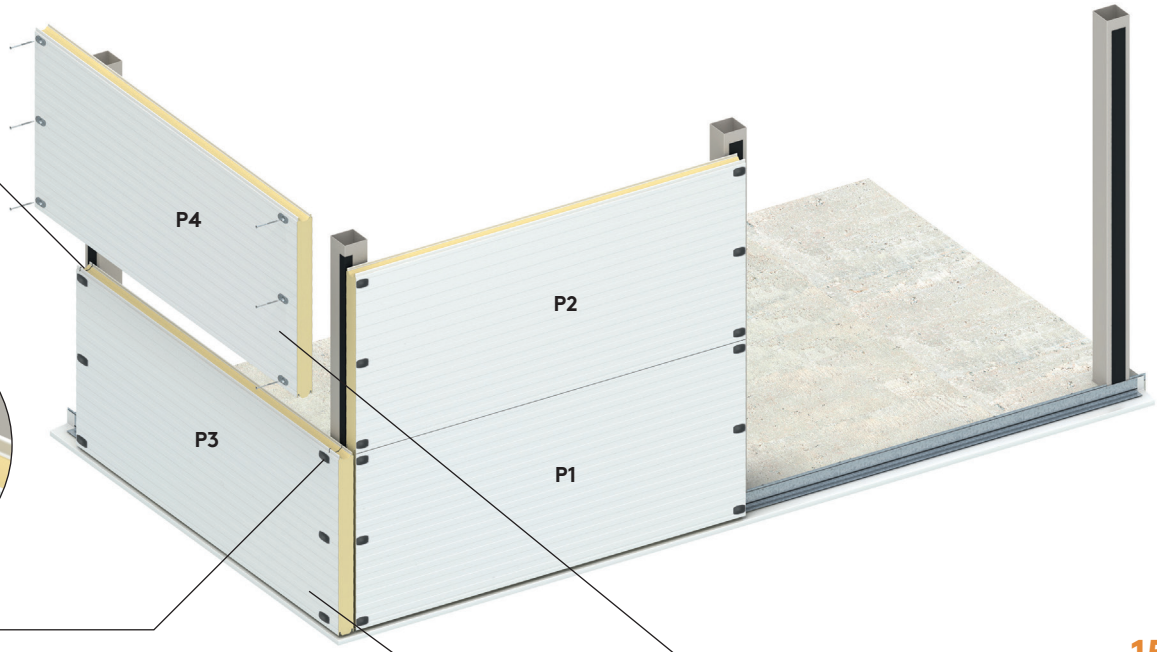

KS1100KP Karrier Wall Panel

Horizontally Laid

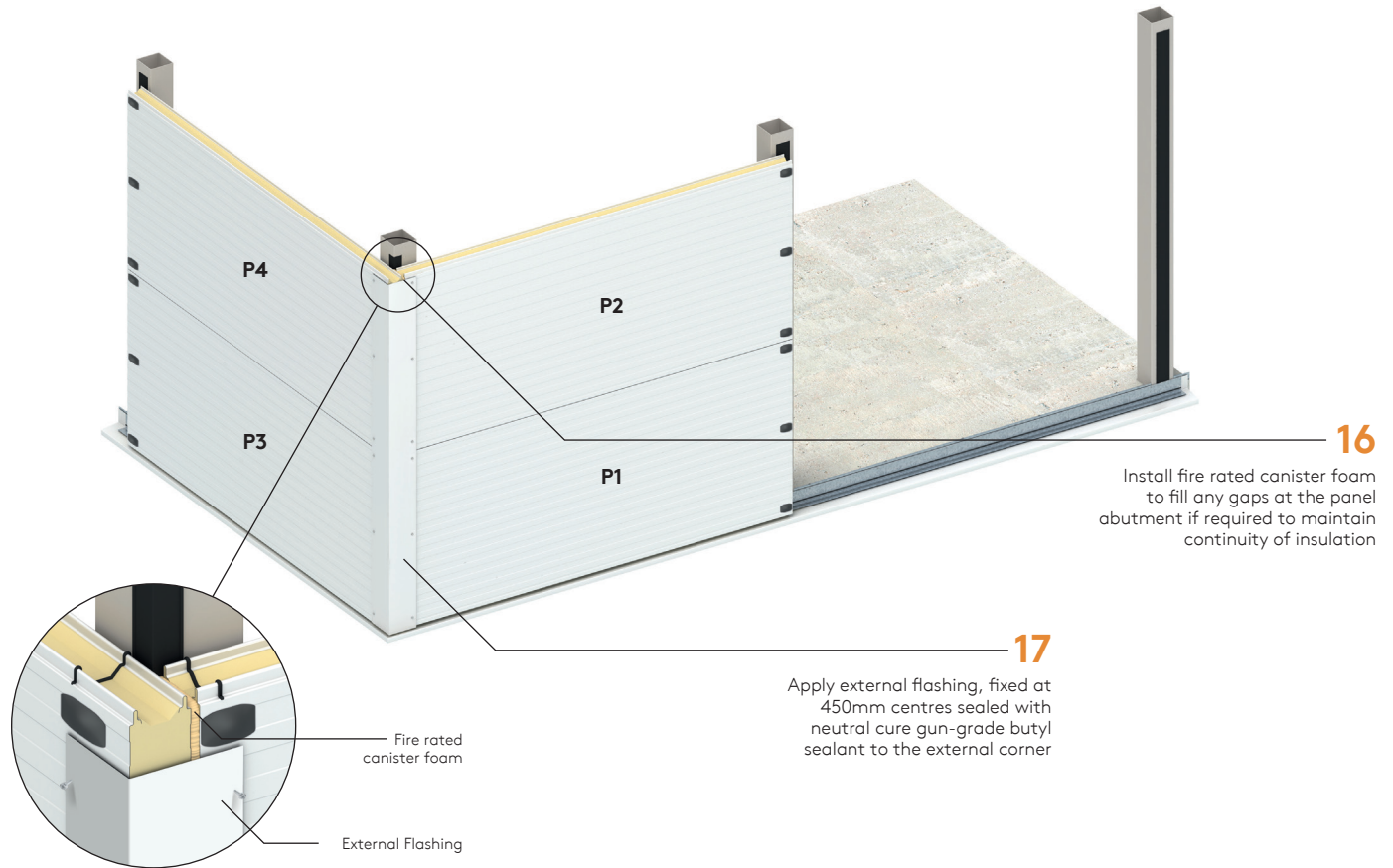

KS1100KP Karrier Wall Panel

Horizontally Laid

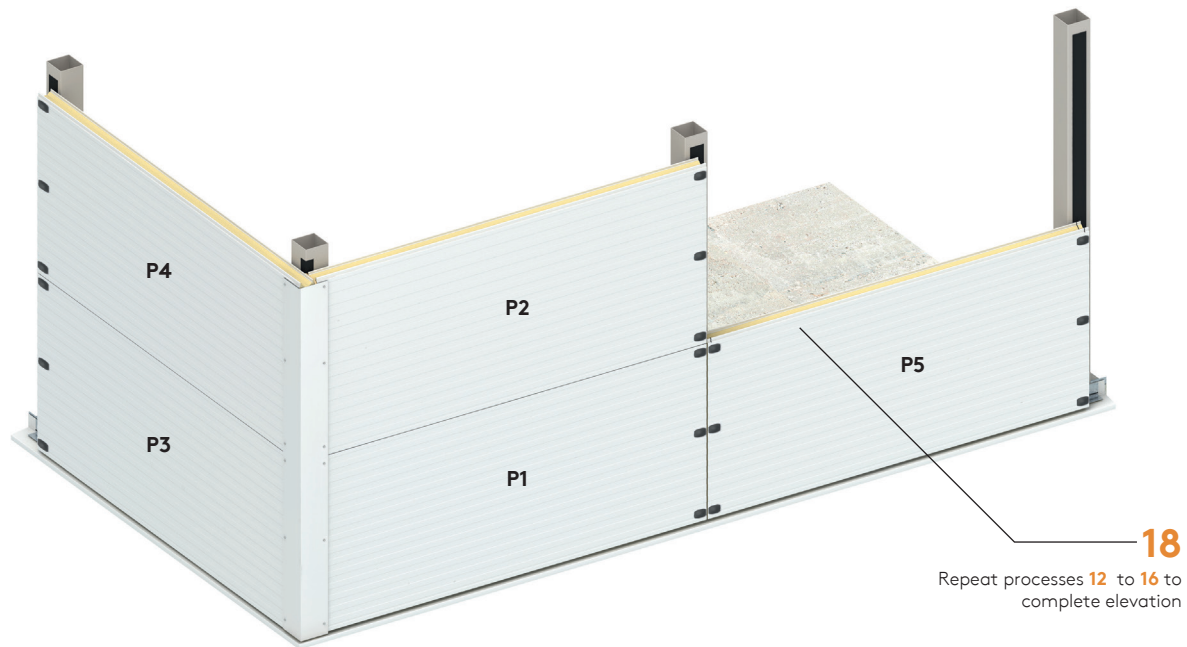

KS1100KP Karrier Wall Panel

Horizontally Laid

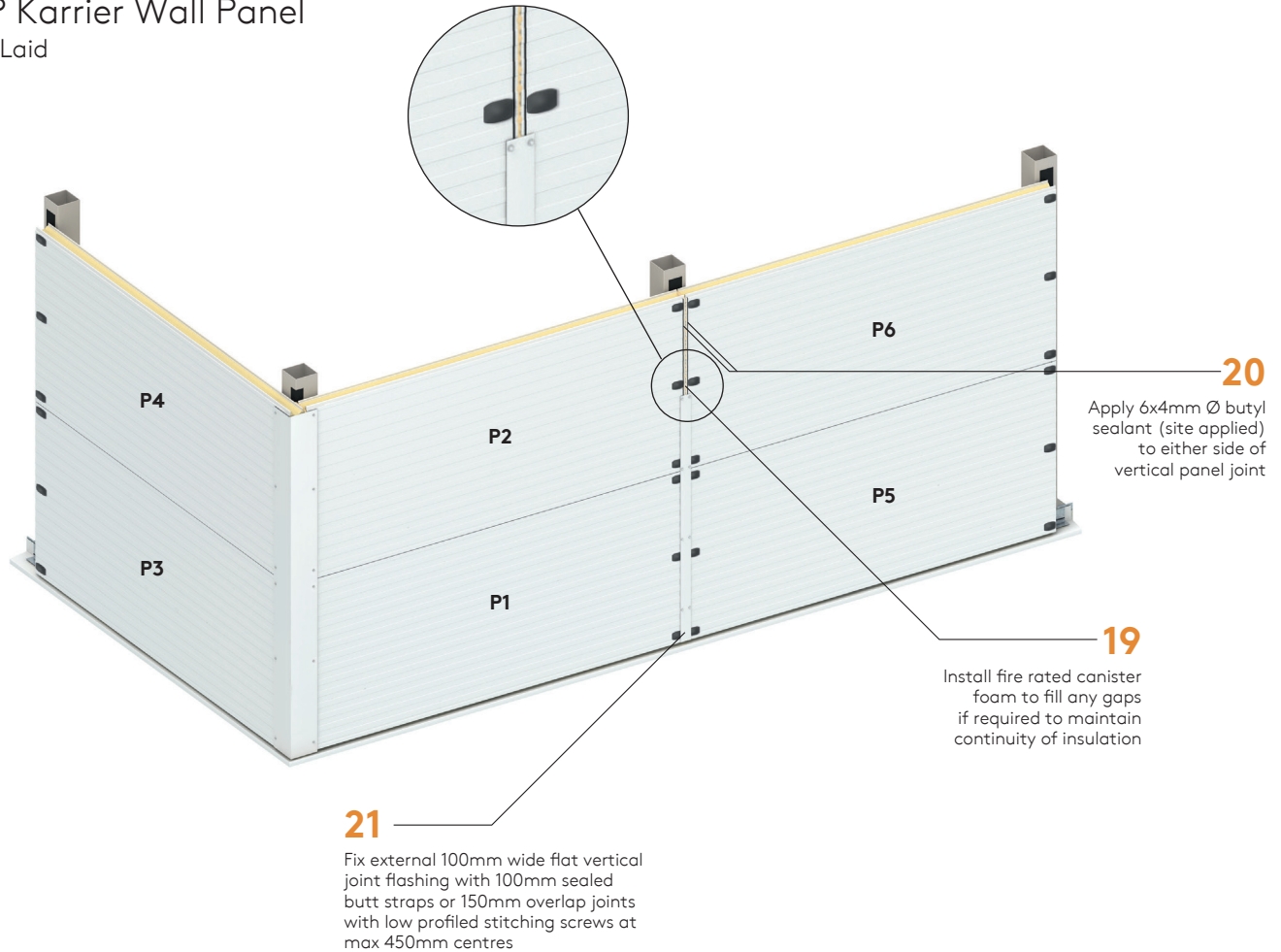

KS1100KP Karrier Wall Panel

Horizontally Laid



Panel Handling

Appropriate personnel protective equipment should always be worn to avoid cuts and abrasions to installers and panels.

Individual panels should always be lifted from a pack and not dragged over others.

The weight of individual panels for lifting can be determined from the information on the packing slip.

For larger panels the contractor would normally arrange to use appropriate material installation equipment to help lift the panels into position.

Protecting Film

When panels are supplied with a plastic protective film this should be removed during site installation.

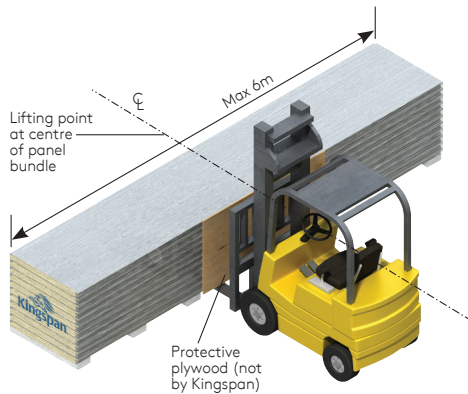

The recommended loading / unloading method for bundles less than or equal to 6m is to use a single forklift with widely spaced forks placed under the centre of the bundle as shown.

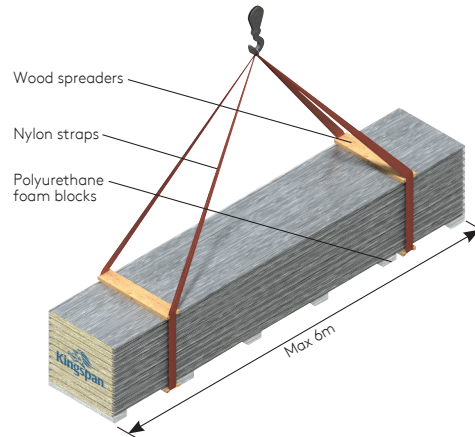

The recommended lifting method for bundles no more than or equal to 6m can be handled with a crane by using nylon straps and wood spreaders as shown.

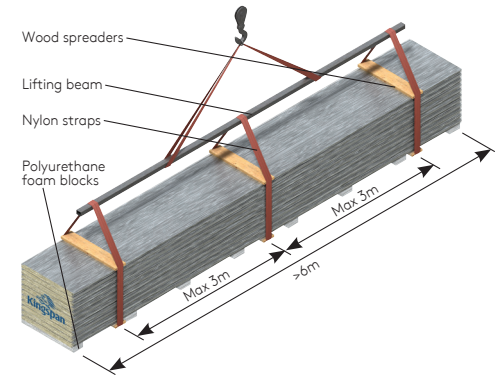

The recommended lifting method for bundles more than 6m, by crane, is by using three points of support. To prevent damage from nylon straps, use wood spreaders at top and bottom at lifting locations as shown.

Panel Handling

Correct and Incorrect Panel Handling

Caution

Individual panels should never be moved in a flat position as excessive flexing may result. Excessive flexing ruptures a panel's core, permanently distorts the facings and may lead to thermal blistering. When moving a panel, it must be turned on its edge first, then supported at each end with as many men as necessary to safely handle.

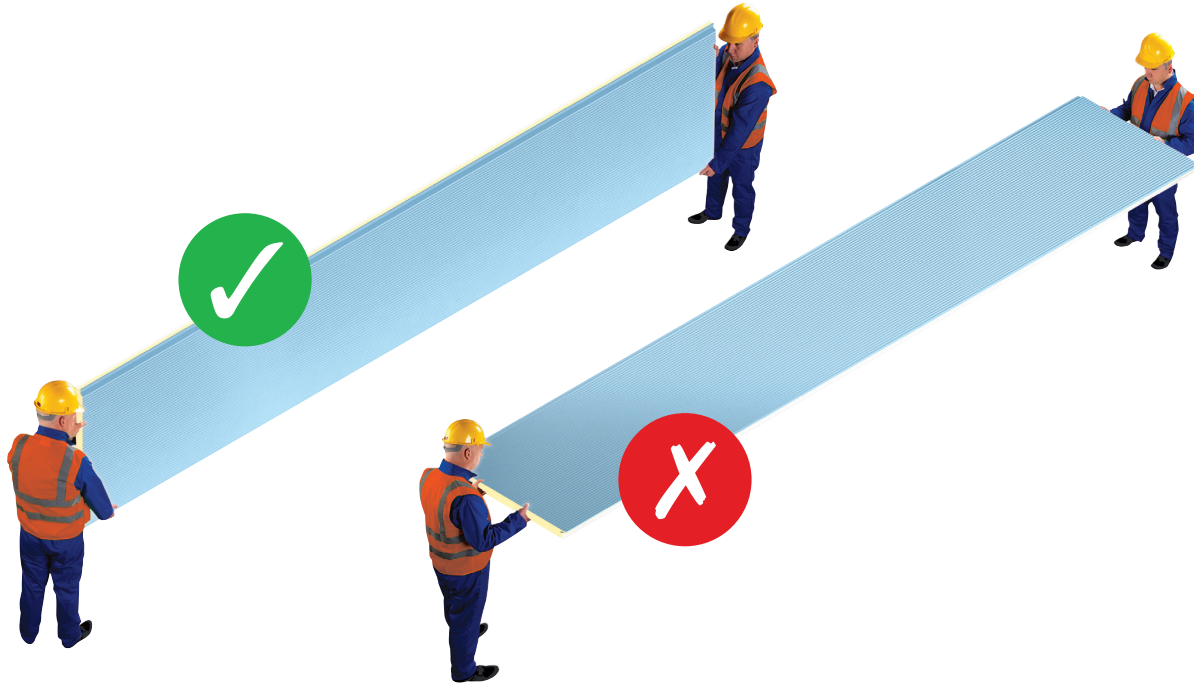

Installation guides are available for most of Kingspan insulated roof and wall panels.
For the most up to date version of this Installation guide please [click here](#) or scan the QR code below. Alternatively, please call Kingspan on:

AUS: +61 2 8889 3000
www.kingspanpanels.com.au



For the product offering in other markets please contact your local sales representative or visit www.kingspanpanels.com

Care has been taken to ensure that the contents of this publication are accurate, but Kingspan Insulated Panels and its subsidiary companies do not accept responsibility for errors or for information that is found to be misleading. Suggestions for, or description of, the end use or application of products or methods of working are for information only and Kingspan Insulated Panels and its subsidiaries accept no liability in respect thereof.

