



Duracube® Lockers are suitable for wet areas

Duracube® Lockers are constructed from Durasafe® 13mm compact laminate making them suitable for wet and dry locations.

Compact laminate is vandal, impact, and water resistant with a low maintenance surface.

Coordinate your locker colours with partitioning system, bench seating and vanities.

Duracube® lockers are ideal for schools, sport and gym change rooms as well as defence and end of trip facilities.

Features & Benefits

- › Durasafe® 13mm compact laminate construction requires no edge strip due to black core edge
- › Locker carcass constructed from either:
 - water resistant white 16mm HMR board or
 - 100% waterproof white 16mm PVC board
- › Black PVC edge tape on carcass to match black core on compact laminate panels and doors
- › Four door colours can be used to create a pattern
- › Shelving and vent options are available
- › Coat rail is a standard inclusion
- › One to four doors are optional per locker tower

Five Lock Options



Applications

- › Schools and Universities
- › End Of Trip (EOT) Facilities
- › Sport and Gym Change Rooms
- › Defence Ablution Blocks

Lockers – Plinth Mounted (LPM)



HOW TO SPECIFY Lockers – Plinth Mounted

Product Name

Duracube® Locker – Plinth Mounted (LPM).

Door and Panel Construction Material

Durasafe® 13mm Compact Laminate.

Internal Carcass Construction Material

Select either:

Dry Area Lockers – White 16mm HMR board.

Wet Area Lockers – White 16mm PVC board.

Lock

Insert lock option here. See page 42.

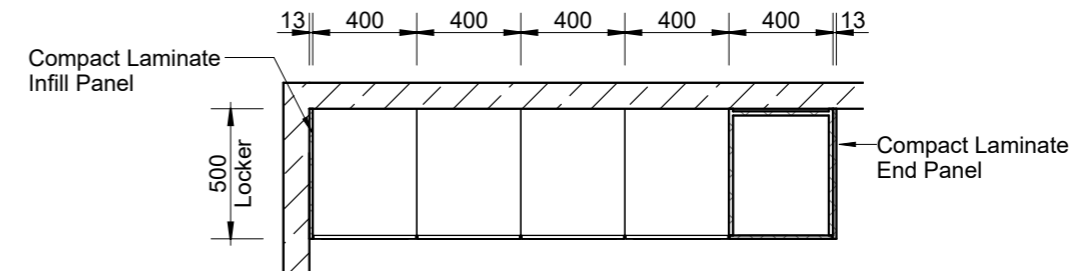

Plan

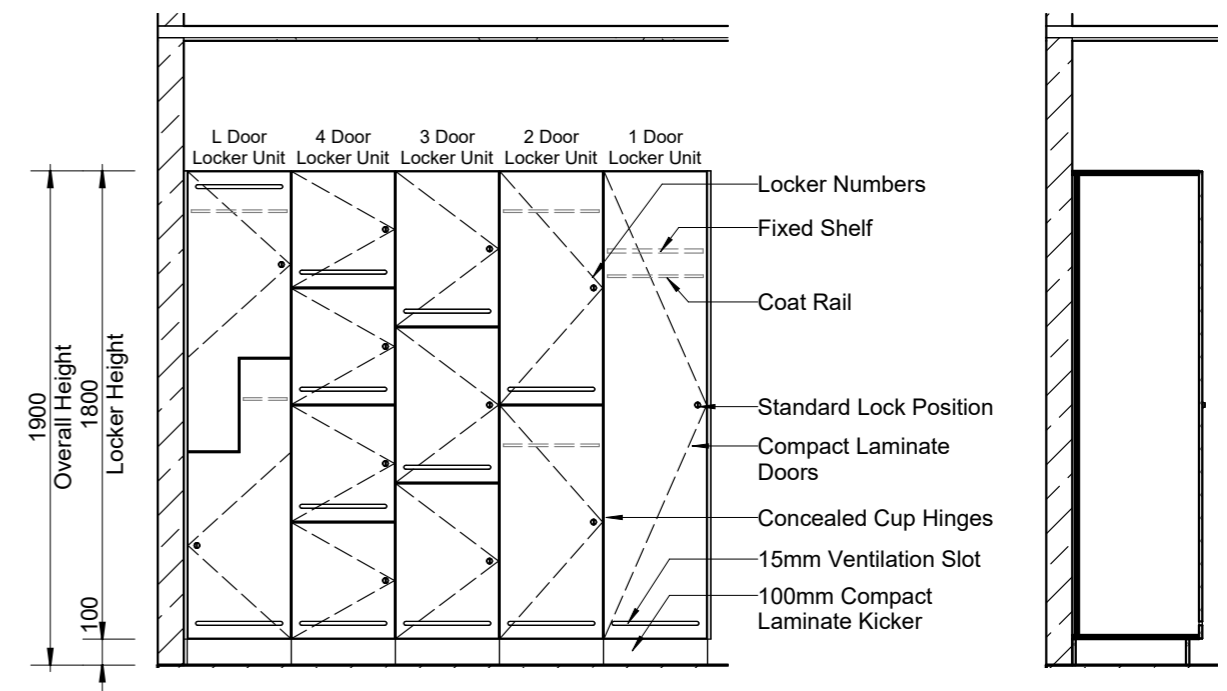

Elevation

Section

Lockers – Wall Mounted (LWM)



HOW TO SPECIFY Lockers – Wall Mounted

Product Name

Duracube® Locker – Wall Mounted (LWM).

Door and Panel Construction Material

Durasafe® 13mm Compact Laminate.

Internal Carcass Construction Material

Select either:

Dry Area Lockers – White 16mm HMR board.

Wet Area Lockers – White 16mm PVC board.

Lock

Insert lock option here. See page 42.

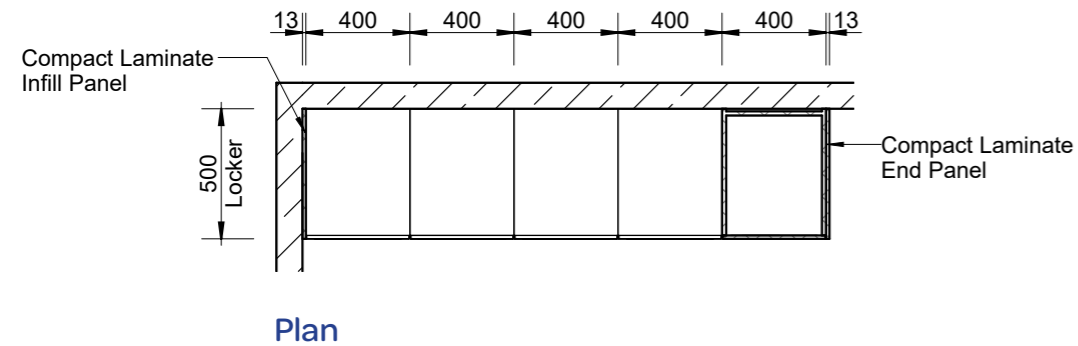

Lockers – Bench Mounted (LBM)



HOW TO SPECIFY Lockers – Bench Mounted

Product Name

Duracube® Locker – Bench Mounted (LBM).

Door and Panel Construction Material

Durasafe® 13mm Compact Laminate.

Internal Carcass Construction Material

Select either:

Dry Area Lockers – White 16mm HMR board.

Wet Area Lockers – White 16mm PVC board.

Lock

Insert lock option here. See page 42.

