

**Barben** BAC-LP5

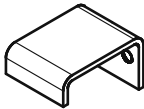

(all dimensions - are in millimetres)

**Cabinet Lip Pulls**



**BAC-LP5/A** Section 35x20x10x2, Proj. 35, Length 25

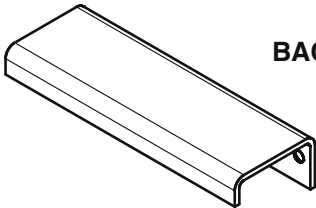

**BAC-LP5/B** Section 35x20x10x2, Proj. 35, Length 100

**BAC-LP5/C** Section 35x20x10x2, Proj. 35, Length 200

**BAC-LP5/D** Section 35x20x10x2, Proj. 35, Length 300

**Note:** PULLS can be Manufactured to Specific Requirements

... NEW PRODUCT 30-06-04 ...

PSS Finish available for Projects Only