

polytec

STECCAWOOD decorative battens

polytec

[www.polytec.com.au](http://www.polytec.com.au)

p 1300 300 547

Create your look



ISSUE: 01d

polytec offer an express sample service.

Visit [www.polytec.com.au](http://www.polytec.com.au) to order your free sample.





## STECCAWOOD

**STECCAWOOD** provides a warm and rich texture appearance for a wide variety of panelling, ideal for wall and ceiling applications in either a vertical or horizontal setout, **STECCAWOOD** prefinished decorative battens create strong directional lines that will add a striking feature to any internal commercial space.

Made from E-Zero MDF and wrapped in decorative overlay **STECCAWOOD** prefinished decorative battens impart the realism, warmth and character of timber, providing a durable and cost effective solution.

### *Availability*

All colours are supplied in a 3600mm length and available in the following dimensions: 17x38mm, 17x65mm, 31x31mm, 31x65mm, 40x100mm, 50x70mm, 50x100mm.

Other sizes also available as Made-to-Order.



STECAWOOD colour range

polytec swatches and samples represent a small area of the overall colour structure. To view the large colour sample, visit [www.polytec.com.au](http://www.polytec.com.au).



Available finishes R = Ravine Wm = Woodmatt

Darker colours will show superficial wear and tear more readily than lighter coloured surfaces and require more care and maintenance.



Available finishes R = Ravine Wm = Woodmatt

Darker colours will show superficial wear and tear more readily than lighter coloured surfaces and require more care and maintenance.

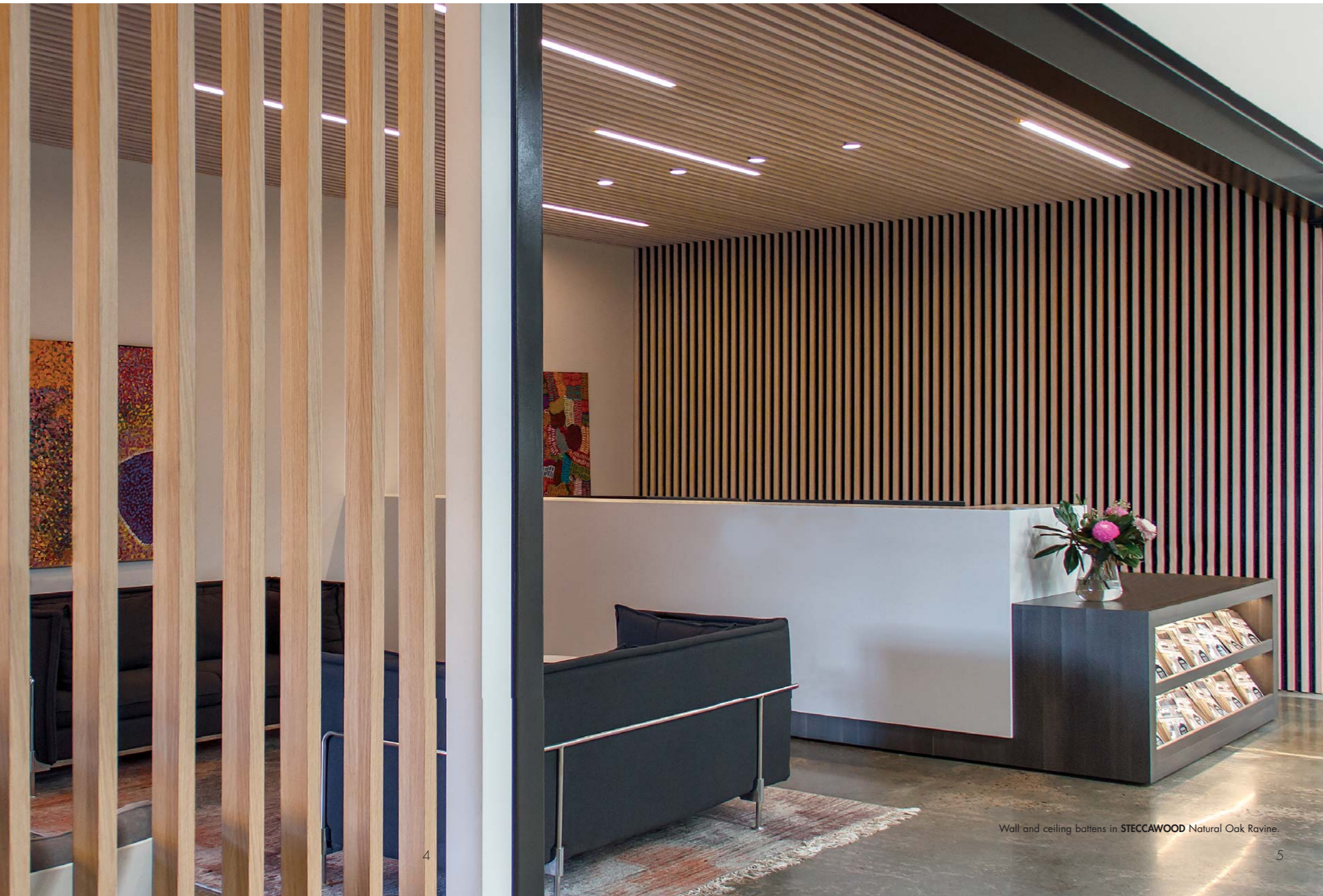

Wall and ceiling battens in STECAWOOD Natural Oak Ravine.

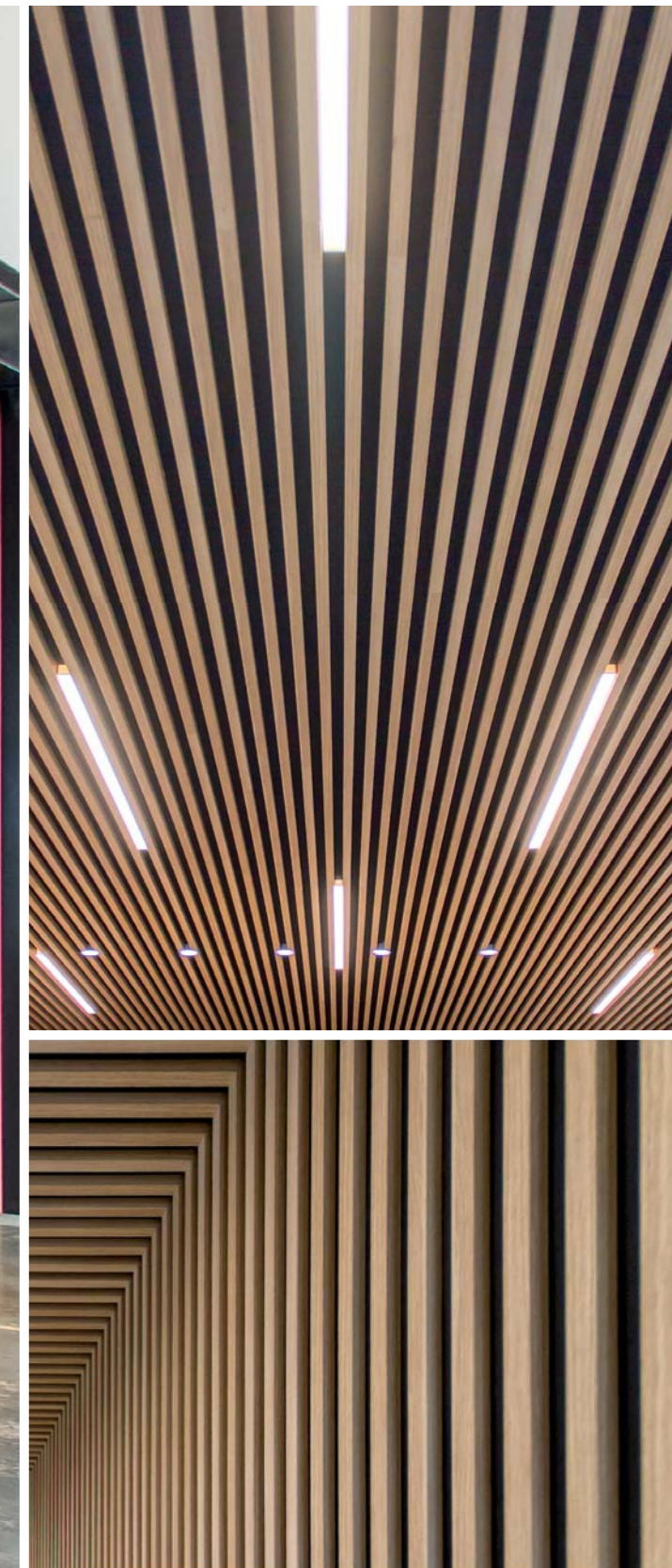





Wall paneling **STECCAWOOD** Black Woodmatt.

Reception counter in **XENOLITH** Calacutta Grey Smooth.

Kick boards in **LAMINATE** Brushed Aluminium.



## GREEN

**polytec** is committed to an eco-friendly and sustainable environment. It is an intrinsic part of the way we do business daily. Our decisions are made so that they have minimum negative impact on the environment.

Our product is manufactured from managed and renewable plantation pine, and on request can be purchased as Responsible Wood chain of custody certified. All **polytec** board products are manufactured from E0 or E1 MDF.

We manage waste responsibly through numerous recycling programs including aluminium and metals, used oils and timber waste is recycled back into energy. We subscribe to local government environmental initiatives and voluntary audits as well as our own internal Energy and Carbon Management Policy (ECM), which aligns with the Australian Government's Energy Efficiency Opportunities (EEO) program.

**polytec** doors and benchtops are Australian Made & Owned.

## CARE

**STECCAWOOD** products are manufactured in Australia using the highest quality materials and designed to provide years of trouble free service. Care should be taken to wipe up spills immediately, ensuring the products are not exposed to high or continuous levels of moisture, steam and humidity.

**STECCAWOOD** prefinished decorative battens should be cleaned by wiping down using a damp soft cloth containing warm, soapy water. For more stubborn stains, use a mild household spray to wipe down the door or panel with a soft cloth taking care not to rub too hard. Dry using a soft cloth so as not to leave any residue on the product. Always ensure that you refer to the recommendations provided by the cleaning product manufacturer before use.

Where products are installed in a kitchen environment use range hoods whenever cooking, to avoid steam and cooking oil vapours from adversely effecting surfaces. Failure to follow the above care instructions may result in damage to your Steccawood product and void your entitlement to any warranty. **polytec's** warranty does not cover wear and tear.

By following these simple steps you should retain beautiful doors for many years to come.

Visit [www.polytec.com.au](http://www.polytec.com.au) for specific care and cleaning information. Darker colours will show superficial wear and tear more readily than lighter coloured surfaces and require more care and maintenance.

The colours and details shown in this brochure are to the highest standards in printing. However, they should only be used as an indication of actual product colour. To order your free colour sample visit [www.polytec.com.au](http://www.polytec.com.au). **polytec** swatches and samples represent a small area of the overall colour structure, to view the large colour sample, visit [www.polytec.com.au](http://www.polytec.com.au)

The use of our current colour samples gives the colour and finish that a customer would expect to receive. **polytec** does not guarantee exact colour matches across product ranges due to colour variation in each product group.

OUTSIDE COVER: Ceiling battens in **STECCAWOOD** Natural Oak Ravine.

Wall panelling in **RAVINE** Soft Walnut.

INSIDE COVER: Ceiling battens in **STECCAWOOD** Natural Oak Ravine.

Wall panelling in **RAVINE** Natural Oak.