

Saniflo  SFA GROUP

Catalogue  
**Shaking  
up water**



A large, dynamic splash of water in shades of blue and white, cascading from the top right towards the bottom left. The water is captured in mid-air, creating a sense of motion and energy. The background is a solid, deep blue.

## Quick Links

- 1 Introduction to Saniflo Video
- 2 How to Select a Pump Video
- 3 Case Studies
- 4 Blogs
- 5 Bimobject for Technical 3D drawings

# What are the questions I need to ask before I specify a pump?

**1. What is the type of application?**

- Domestic or commercial

**2. What fixtures are being attached to the pump?**

This determines whether it is a macerator, grey water pump or lifting station that will be required.

- For kitchen sink, shower, hand basin, bath and laundry refer to Grey Water Pump
- For toilets combined with grey water attachments refer to Macerator
- For toilet suite with macerator refer to Integrated Macerator
- For high-temperature waste, multiple fixtures, or high lift refer to Lifting Stations

**3. If it is a commercial application, is there a commercial dishwasher or glasswasher discharging to the pump?**

- Please specify Sanicom 1 /Sanicom 2

**4. How high does the waste need to be pumped?**

- Refer to the pumping height with the flow chart

**5. How far away does the waste need to travel?**

- Refer to the product sheets with the flow chart

**Specifying a pump can sometimes be a complex process, we often need further information to understand the installation better:**

- How many changes of direction are there along the discharge line?  
**NB: No 90 degree angle bends, only 45 degree angles.**
- Is there any fall at the top of the vertical lift?

---

**PLEASE NOTE: If you cannot achieve the vertical pumping distance and if the installation parameters are outside the guidelines please call our technical department AU 1300 554 779 and NZ 0800 107 264.**

MODEL NO	PRODUCT NAME	POSSIBLE CONNECTIONS	PUMPING HEIGHT	PAGE	APPLICATION		
					COMMERCIAL	DOMESTIC	
<b>GREY WATER PUMP</b>					<b>9</b>		
SA 112/113/114	SANIFLOOR +		3m	10	LIGHT		
SA 94	SANISHOWER +	 	5m	11	LIGHT		
SA 95	SANIVITE +	     	5m	12	N/A		
SA 101	SANISPEED +	     	7m	13	LIGHT		N/A
SA 221	SANIFAST SWH190	     	11m	14			N/A
<b>MACERATOR</b>					<b>15</b>		
SA 80	SANIACCESS 2	 	5m	16	LIGHT		
SA 81	SANIACCESS 3	  	5m	17	LIGHT		
SA 99	SANIPACK PRO UP	  	5m	18	LIGHT		
SA 97	SANITOP	  	5m	19	LIGHT		
SA 98	SANIPLUS	    	5m	20	LIGHT		
SA 96	SANIPRO	   	5m	21	LIGHT		
SA 100	SANIBEST PRO	    	7m	22	HEAVY		N/A
<b>INTEGRATED MACERATOR</b>					<b>24</b>		
SA 106	SANICOMPACT	 	3m	27	N/A		
<b>LIFTING STATION</b>					<b>28</b>		
SA 102	SANICOM 1	     	8m	30	HEAVY		N/A
SA 108	SANICOM 2	     	11m	31	HEAVY		N/A
SA 107	SANICUBIC 1 WP	      	11m	32	LIGHT		
SA 104	SANICUBIC 2 PRO WP	      	11m	34	HEAVY		
SA 111	SANICUBIC 2 VX SINGLE PHASE	      	10m	36	HEAVY		
SA 300	SANICUBIC 1 GR	      	20m	38	HEAVY		
<b>CONDENSATE</b>					<b>40</b>		
SA92	SANICONDENS PRO	 	4.5m	42	✓		✓
SA110	SANICONDENS CLIM MINI S		6m	43	✓		✓
SA91	SANICONDENS BEST FLAT	  	4.5m	44	✓		✓
<b>ADDITIONAL PRODUCTS</b>					<b>45</b>		
ALARM 1	SANIALARM		N/A	46	✓		✓
SANI12661	SANIALARM INTERLOCK		N/A	47	✓		✓
DETAUST	SANIDESCALER		N/A	48	✓		✓
DN100	SANIKNIFE VALVE		N/A	48	✓		✓

 Domestic application  Commercial application Light = Light commercial Heavy = Heavy commercial

# Saniflo a group SFA company. The leaders in pumping technology.



Founded in France in 1958, SFA developed the first ever macerator pump, a product that revolutionised the bathroom renovation market and shaped the company's history.

The macerating toilet pump was an immediate success. It enabled a bathroom to be installed anywhere in the home without the need of direct access to a sewer point. As homes are mostly brick and concrete structures, it was both difficult and costly to relocate or extend sewer pipes.

The SFA macerator filled a demand for extra wet areas in the home, without the cost and inconvenience of moving sewer pipes. It is achieved by finely chopping the incoming waste so that it can be pumped through small diameter pipework.

The benefit of using small diameter pipework is that it can be concealed behind the walls, under floors or in ceiling spaces and eventually connected to the existing sewer line.

After achieving unwavering success in Europe with its macerators, grey water pumps and lifting stations, SFA continues to expand its unique offering around the world. The group established itself with the Saniflo brand in Australia and has never looked back. With growing popularity in basement living, outdoor BBQ kitchens, additional toilet and granny flat extensions, there is an ever increasing demand for cost effective plumbing solutions.

Despite a global presence, Saniflo is dedicated to the same principles that underpinned its initial success: innovation and quality. Products are made to the highest standards by Saniflo's parent company in France, using modern production technology and our team of engineers consistently develop products that meet the requirements of modern decor.

**Saniflo's macerator fills a demand for extra wet areas in the home, without the cost and inconvenience of moving sewer pipes.**





## Install a kitchen or laundry without major plumbing work

Make the most of your living spaces with Saniflo and add a kitchen or laundry anywhere in the home. Install a laundry in the basement or sink in an alfresco area using a Saniflo grey water pump.

Grey water fixtures are connected to top and side inlets of the pump. As waste flows in, the pressure activated micro-switch senses the water level rising and starts the motor. The waste water is pumped out using a powerful 400w motor. The small-bore 25mm discharge pipe can be hidden behind plaster walls, under the floor or in ceiling spaces before it is connected to the existing sewer line.

Saniflo grey water pumps are also ideal in commercial situations where the sewer pipes are in a fixed location. This is common in office fit-outs, hair salons, cafes and restaurants where there are restrictions on altering the building structure. Using a Saniflo grey water pump, waste water can be easily pumped to the existing sewer line over long distances or heights.



**Make the most of your living spaces with Saniflo's simple principle for adding a kitchen or laundry anywhere in the home.**

# Install a bathroom anywhere with a Saniflo maceratorator pump

With a growing family and frequent visitors, you may feel the need for an extra guest toilet or for luxury living you may want to install an ensuite. Saniflo has made that dream achievable with its wide range of macerators.

With Sanipack Pro UP you can now install that beautiful wall hung toilet that you always wanted. With additional inlets for vanity basin and shower, you can have a complete ensuite.

If you have limited space and just need a toilet with vanity basin, Sanicompact toilet suite is the answer. Its' compact design enables a toilet to be added where space is limited making it ideal for a small ensuite or powder room. It is the first toilet suite with 6-star WELS rating and uses 2.2 litres of water on average.



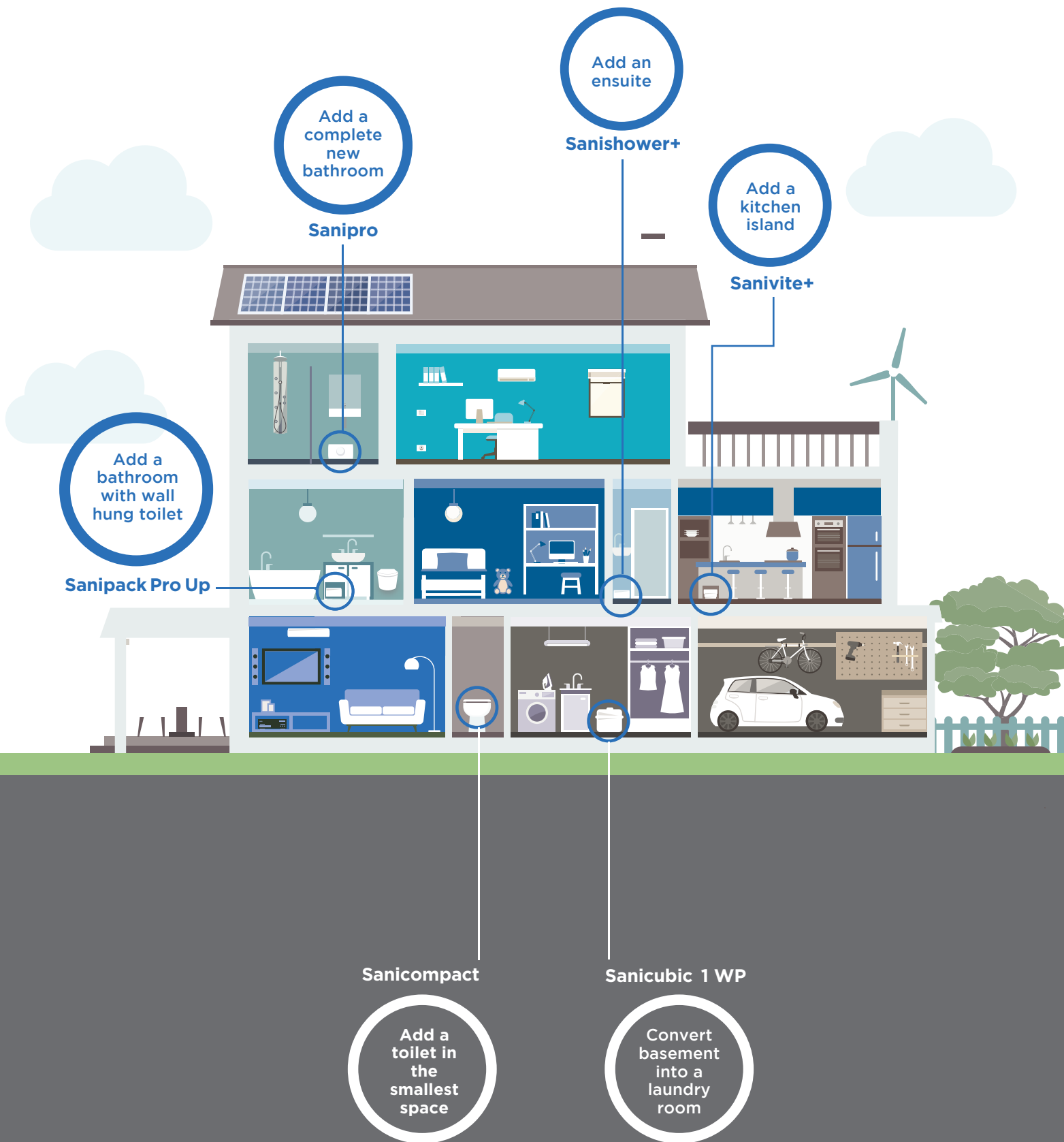





# GREY WATER PUMP

MODEL NO	PRODUCT NAME	POSSIBLE CONNECTIONS	PUMPING HEIGHT	PAGE	APPLICATION	
					COMMERCIAL	DOMESTIC
SA 112/113/114	SANIFLOOR +		3m	8	LIGHT ●	●
SA 94	SANISHOWER +		5m	9	LIGHT ●	●
SA 95	SANIVITE +		5m	10	N/A	●
SA 101	SANISPEED +		7m	11	LIGHT ●	N/A
SA 221	SANIFAST SWH190		11m	12	●	N/A

● Domestic application ● Commercial application Light = Light commercial Heavy = Heavy commercial

## TIPS

- Sanispeed+ is not recommended for commercial applications where excessive fat, grease, citrus based cleaners, waxes, harsh chemicals, ammonia, bleaches, commercial dishwasher and glasswasher are used. (Use Sanicom 1 instead)



WMTS 106:2019  
Certificate No. 23048  
Manufacturer: SFA  
Brand: Saniflo

PRODUCT REFERENCES:  
SA112/SA113/SA114



# Sanifloor®+

Sanifloor®+ allows a shower to be installed easily and economically without major work accessing sewer pipes. The pump sucks the water from the shower gully and discharges back to the existing sewer line. Installing a stylish walk-in shower is easy with a Sanifloor®+.

## WHY CHOOSE THIS PRODUCT?

Suits walk in showers and low level shower trays

Ideal for high flow applications

Pump and waste inlet can be up to 3 m apart horizontally

Dual function - sucks waste up from the gully and pumps waste water away up to 3 m vertically or 30 m horizontally

Pump can be positioned up to 300 mm above the gully

All gully types are 90 mm in diameter

Wireless activation

24mm OD suction pipe

## VERTICAL/HORIZONTAL PERFORMANCE

Increase size of horizontal run by one pipe size after 5m. All horizontal pipework requires a minimum of 1:100 fall.

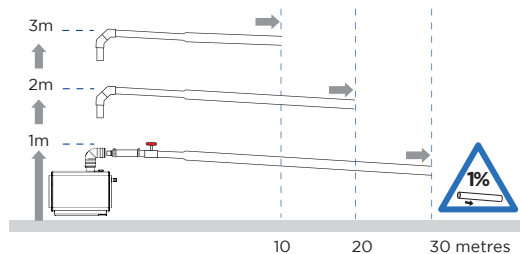

## FLOW RATE PERFORMANCE CHART

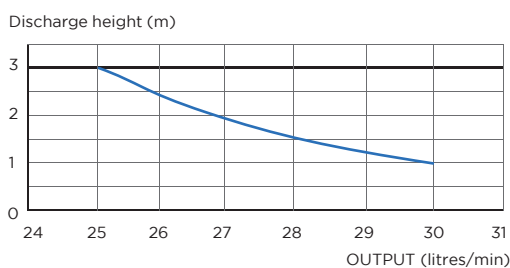

## TECHNICAL CHARACTERISTICS

<b>Discharge Pipework</b>	25 mm
<b>Motor Power</b>	400 Watts
<b>Voltages</b>	220-240 V/50 Hz
<b>Working Waste Water Temp</b>	35°C
<b>Product Weight</b>	7.9 kg
<b>Overall Measurements</b>	295 x 191 x 164 mm
<b>IP Rating</b>	IP44

## GULLY TYPES

**Ref SA112:** With shower waste gully for vinyl floor - Height 68 mm

**Ref SA113:** With shower waste gully for tiled floor - Height 68 mm

**Ref SA114:** With shower waste gully for trays - Height 63 mm

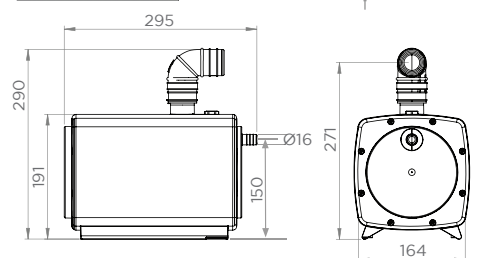
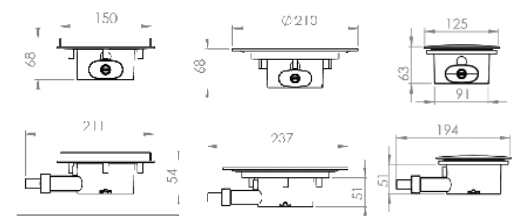

**NOTE:** To maintain radio signal integrity pump must be installed in same room with power cable end facing towards shower waste gully.





GREY WATER PUMP

APPLICATIONS



HAND BASIN



BATH



KITCHEN SINK



WASHING MACHINE



DISH WASHER



WMTS 106:2019  
Certificate No. 23048  
Manufacturer: SFA  
Brand: Saniflo

PRODUCT REFERENCE:  
SA95

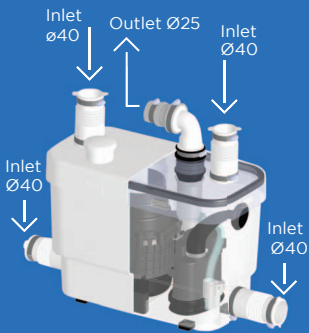

# Sanivite®+

Ideal for kitchen, bath, outdoor BBQ kitchen or laundry. Sanivite®+ has up to four inlet connections making it the ideal solution for installing multiple plumbing fixtures.



## TECHNICAL CHARACTERISTICS

<b>Discharge Pipework</b>	25 mm
<b>Motor Power</b>	400 Watts
<b>Voltages</b>	220-240 V/50 Hz
<b>Working Waste Water Temp</b>	35°C/Max 60°C (intermittent)
<b>Product Weight</b>	6.4 kg
<b>Overall Measurements</b>	367 x 277 x 189 mm
<b>Inlet Pipework</b>	40 mm
<b>IP Rating</b>	IP44

## WHY CHOOSE THIS PRODUCT?

- Only for domestic application
- Powerful, quiet pump
- Low activation level (95 mm)
- Compact for concealed installation
- Carbon filter included to neutralise odours
- Working temperature of 35°C.
- Will handle up to 60°C for short periods (5 minutes)

## VERTICAL/HORIZONTAL PERFORMANCE

Increase size of horizontal run by one pipe size after 5m. All horizontal pipework requires a minimum of 1:100 fall.

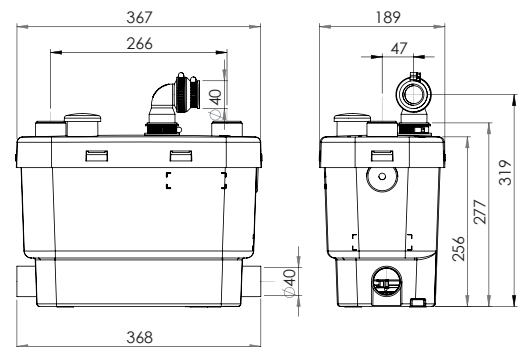
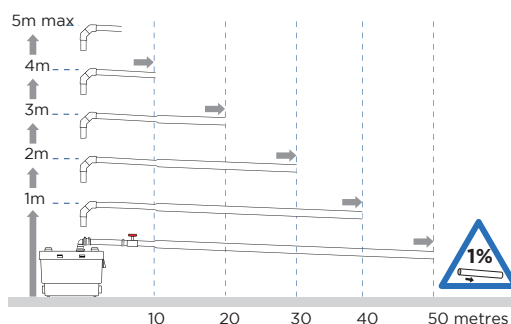

## FLOW RATE PERFORMANCE CHART

Discharge height (m)

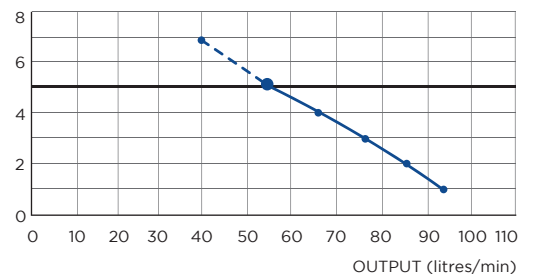

Made in France to the highest standards, needs to be installed by a licensed plumber

Product sheet ↓  
Instruction sheet ↓



# Sanispeed®+

Ideal for light commercial environments such as small shops, cafes, offices, bars, automatic coffee machines and dental surgeries where grey water needs to be disposed of.



## WHY CHOOSE THIS PRODUCT?

Ideal for light commercial applications

Low activation level (95 mm)

Can connect to Alarm or Alarm Interlock

Four inlets - two side entries and two top entries

Working temperature of 35°C

Will handle up to 75°C for short periods (5 minutes)

Carbon filter included to neutralise odours

## VERTICAL/HORIZONTAL PERFORMANCE

Increase size of horizontal run by one pipe size after 5m. All horizontal pipework requires a minimum of 1:100 fall.

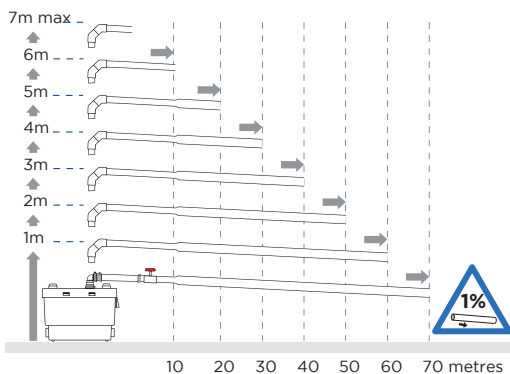

## TECHNICAL CHARACTERISTICS

<b>Discharge Pipework</b>	25 mm
<b>Motor Power</b>	400 Watts
<b>Voltages</b>	220-240 V/50 Hz
<b>Working Waste Water Temp</b>	35°C/Max 75°C (intermittent)
<b>Product Weight</b>	6.4 kg
<b>Overall Measurements</b>	367 x 277 x 189 mm
<b>Inlet Pipework</b>	40 mm
<b>IP Rating</b>	IP44

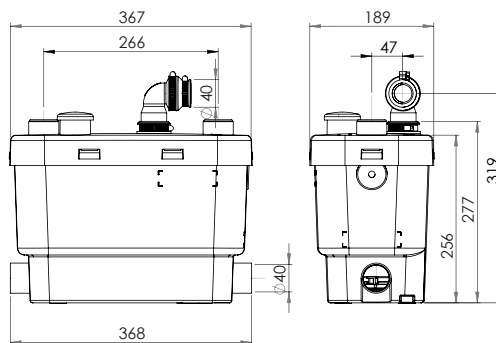

## FLOW RATE PERFORMANCE CHART

Discharge height (m)

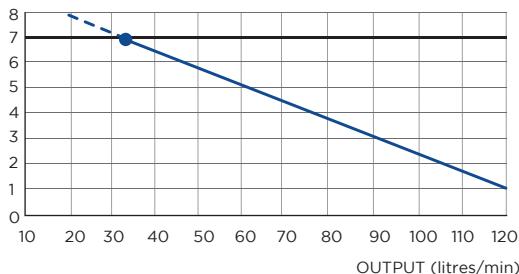

## APPLICATIONS



HAND BASIN



BATH



SHOWER



KITCHEN SINK



WASHING MACHINE



DISH WASHER



WMTS 106:2019  
Certificate No. 23048  
Manufacturer: SFA  
Brand: Saniflo

PRODUCT REFERENCE:  
SA101

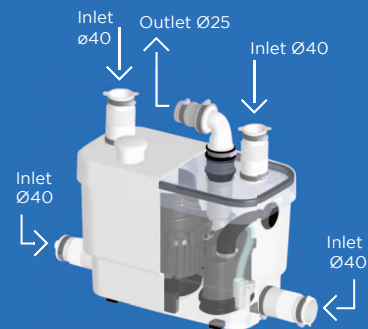

Made in France to the highest standards, needs to be installed by a licensed plumber

APPLICATIONS



HAND BASIN



BATH



SHOWER



WASHING MACHINE



DISH WASHER



KITCHEN SINK



WMTS 106:2019  
Certificate No. 23048  
Manufacturer: SFA  
Brand: Saniflo

PRODUCT REFERENCE:  
SA221

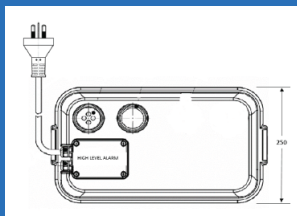

Made in Germany to the highest standards, needs to be installed by a licensed plumber



NEW  
COMING  
SOON

← Back to index

Product sheet

Instruction sheet



# Sanifast®

Sanifast® is a compact easy to service commercial grey water pump designed for medium-heavy commercial use. The unit is designed to receive and pump away waste water from a washing machine dishwasher, sink and is ideal for busy commercial office kitchens.

## WHY CHOOSE THIS PRODUCT?

Ease of service design with no pipework connections on lid to hinder removal

Built in high level alarm

Plug and Play connectivity to optional external Sanialarm Interlock for water and power isolation

Large tank capacity

High pumping performance

Integrated carbon filter and anti flood valve

## TECHNICAL CHARACTERISTICS

<b>Discharge Pipework</b>	25 mm
<b>Motor Power</b>	850 Watts
<b>Voltages</b>	220-240 V/50 Hz
<b>Working Waste Water Temp</b>	40-90°C
<b>Product Weight</b>	7 kg
<b>Overall Measurements</b>	393 x 320 x 250 mm
<b>Inlet Pipework</b>	50 mm
<b>IP Rating</b>	IP44

## VERTICAL/HORIZONTAL PERFORMANCE

Increase size of horizontal run by one pipe size after 5m. All horizontal pipework requires a minimum of 1:100 fall.

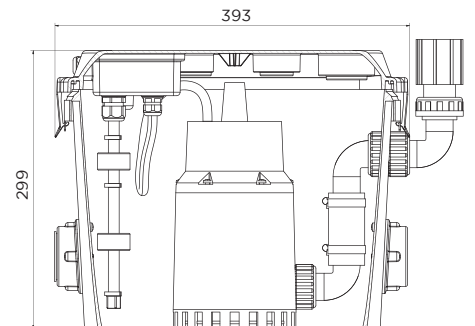
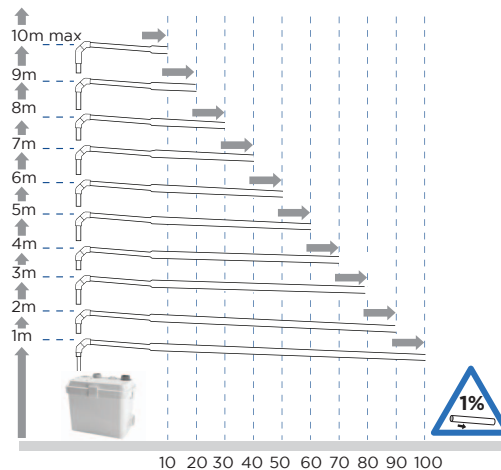



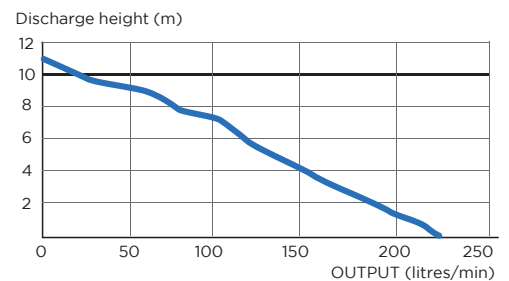



## FLOW RATE PERFORMANCE CHART



# MACERATOR



MODEL NO	PRODUCT NAME	POSSIBLE CONNECTIONS	PUMPING HEIGHT	PAGE	APPLICATION	
					COMMERCIAL	DOMESTIC
SA 80	SANIACCESS 2		5m	15	LIGHT ●	●
SA 81	SANIACCESS 3		5m	16	LIGHT ●	●
SA 99	SANIPACK PRO UP		5m	17	LIGHT ●	●
SA 97	SANITOP		5m	18	LIGHT ●	●
SA 98	SANIPLUS		5m	19	LIGHT ●	●
SA 96	SANIPRO		5m	20	LIGHT ●	●
SA 100	SANIBEST PRO		7m	21	HEAVY	N/A

● Domestic application ● Commercial application Light = Light commercial Heavy = Heavy commercial

## TIPS

- Foreign objects such as pieces of cloth, dental floss, hygiene products, flushable wet wipes etc should not be flushed into the macerator.
- Macerators need minimum 4.5 L of unrestricted flush for optimal function.

APPLICATIONS



TOILET



HAND BASIN



WMTS 106:2019  
Certificate No. 23048  
Manufacturer: SFA  
Brand: Saniflo

PRODUCT REFERENCE:  
SA80



# Saniaccess® 2

Designed to provide easy access for toilet with vanity applications. Convenient access panels allow one to service and maintain the macerator without having to remove it.



Double access:

- A Direct access to the blade if maintenance is required
- B Direct access to electric components



## TECHNICAL CHARACTERISTICS

<b>Discharge Pipework</b>	20 mm
<b>Motor Power</b>	400 Watts
<b>Voltages</b>	220-240 V/50 Hz
<b>Working Waste Water Temp</b>	35°C
<b>Product Weight</b>	5.8 kg
<b>Overall Measurements</b>	490 x 330 x 168 mm
<b>Inlet Pipework</b>	40 mm
<b>IP Rating</b>	IP44

## WHY CHOOSE THIS PRODUCT?

- Easy service access
- Suitable for one toilet and hand basin
- Easy maintenance without removal of unit
- Macerator needs minimum 4.5 L of unrestricted flush for optimal function
- Quiet technology
- Ideal for adding an additional toilet or powder room anywhere

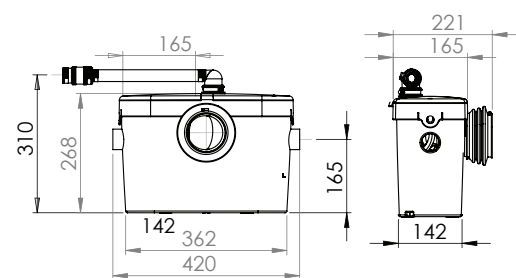

## VERTICAL/HORIZONTAL PERFORMANCE

Increase size of horizontal run by one pipe size after 5m. All horizontal pipework requires a minimum of 1:100 fall.

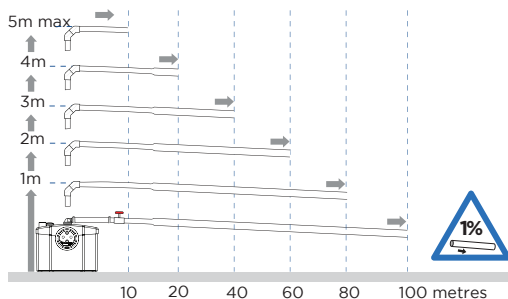

## FLOW RATE PERFORMANCE CHART

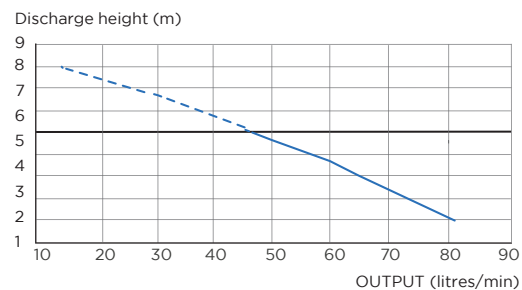

Made in France to the highest standards, needs to be installed by a licensed plumber





# Saniaccess® 3

Designed to provide easy access for en-suite bathroom applications. Convenient access panels allow one to service and maintain the macerator without having to remove it.



## TECHNICAL CHARACTERISTICS

<b>Discharge Pipework</b>	20 mm
<b>Motor Power</b>	400 Watts
<b>Voltages</b>	220-240 V/50 Hz
<b>Working Waste Water Temp</b>	35°C
<b>Product Weight</b>	6.4 kg
<b>Overall Measurements</b>	490 x 330 x 168 mm
<b>Inlet Pipework</b>	40 mm
<b>IP Rating</b>	IP44

## WHY CHOOSE THIS PRODUCT?

- Easy service access
- Suitable for one toilet, basin and shower
- Easy maintenance without removal of unit
- Macerator needs minimum 4.5 L of unrestricted flush for optimal function
- Quiet technology
- Ideal for adding a complete bathroom or en-suite anywhere

## VERTICAL/HORIZONTAL PERFORMANCE

Increase size of horizontal run by one pipe size after 5m. All horizontal pipework requires a minimum of 1:100 fall.

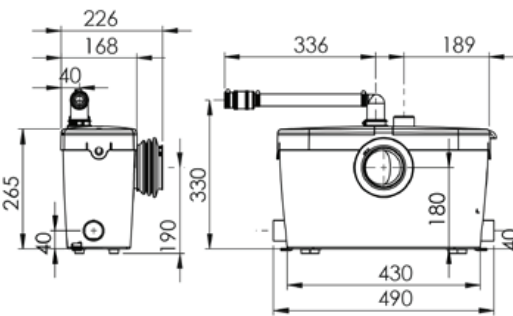
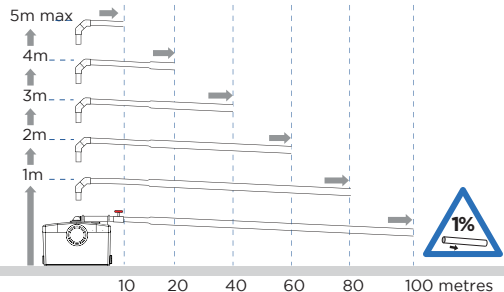

## FLOW RATE PERFORMANCE CHART

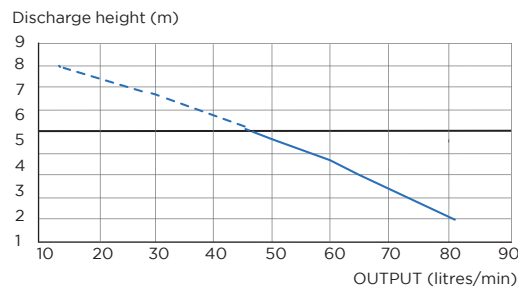

## APPLICATIONS



TOILET



HAND BASIN



SHOWER



WMTS 106:2019  
Certificate No. 23048  
Manufacturer: SFA  
Brand: Saniflo

PRODUCT REFERENCE:  
SA81



Double access:

A Direct access to the blade if maintenance is required

B Direct access to electric components

Made in France to the highest standards, needs to be installed by a licensed plumber

**MACERATOR**

**APPLICATIONS**



**WALL HUNG TOILET**



**HAND BASIN**



**SHOWER**



WMTS 106:2019  
Certificate No. 23048  
Manufacturer: SFA  
Brand: Saniflo

**PRODUCT REFERENCE:**  
SA99



# Sanipack® Pro Up

Designed for discreet wall hung toilet installations, the Sanipack® Pro UP pumps waste from a toilet, basin and shower and has slim dimensions enabling possible concealment.



## TECHNICAL CHARACTERISTICS

<b>Discharge Pipework</b>	20 mm
<b>Motor Power</b>	400 Watts
<b>Voltages</b>	220-240 V/50 Hz
<b>Working Waste Water Temp</b>	35°C
<b>Product Weight</b>	7 kg
<b>Overall Measurements</b>	472 x 303 x 169 mm
<b>Inlet Pipework</b>	40 mm
<b>IP Rating</b>	IP44

## WHY CHOOSE THIS PRODUCT?

- Perfect for wall hung toilet suite
- Ideal solution for a complete en-suite
- Quiet technology
- Slim dimensions
- Access panels for ease of servicing
- Macerator needs minimum 4.5 L of unrestricted flush for optimal function

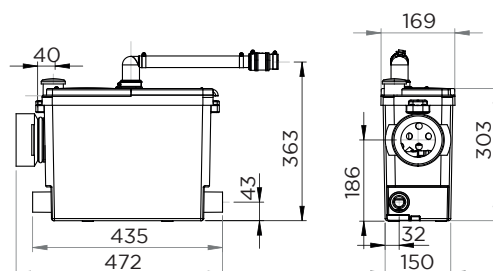

## VERTICAL/HORIZONTAL PERFORMANCE

Increase size of horizontal run by one pipe size after 5m. All horizontal pipework requires a minimum of 1:100 fall.

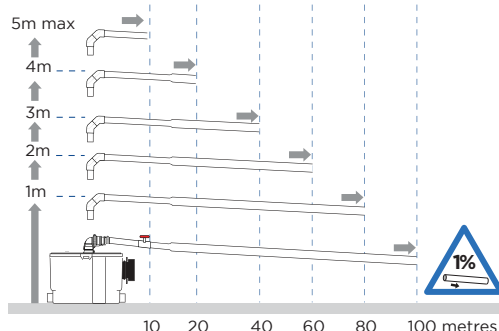

## FLOW RATE PERFORMANCE CHART

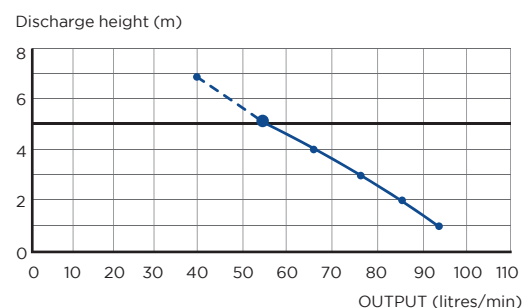

Made in France to the highest standards, needs to be installed by a licensed plumber

Product sheet ↓  
Instruction sheet ↓



APPLICATIONS



TOILET



HAND BASIN

MACERATOR



WMTS 106:2019  
Certificate No. 23048  
Manufacturer: SFA  
Brand: Saniflo

PRODUCT REFERENCE:  
SA97

# Sanitop®

Sanitop® has a powerful macerator that makes it ideal for installing an additional toilet and hand basin where access to the main sewer is impractical.



## TECHNICAL CHARACTERISTICS

<b>Discharge Pipework</b>	20 mm
<b>Motor Power</b>	400 Watts
<b>Voltages</b>	220-240 V/50 Hz
<b>Working Waste Water Temp</b>	35°C
<b>Product Weight</b>	5.8 kg
<b>Overall Measurements</b>	330 x 280 x 161 mm
<b>Inlet Pipework</b>	40 mm
<b>IP Rating</b>	IP44

## WHY CHOOSE THIS PRODUCT?

- Can be equipped with Sanialarm (sold separately)
- Quiet technology
- Macerator needs minimum 4.5 L of unrestricted flush for optimal function

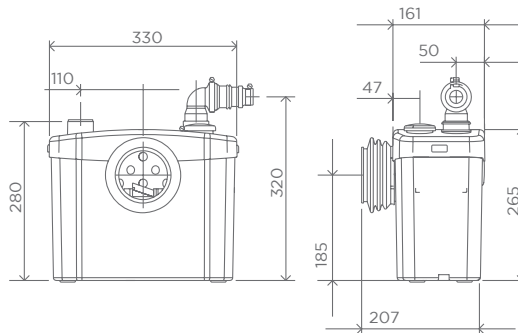

## VERTICAL/HORIZONTAL PERFORMANCE

Increase size of horizontal run by one pipe size after 5m. All horizontal pipework requires a minimum of 1:100 fall.

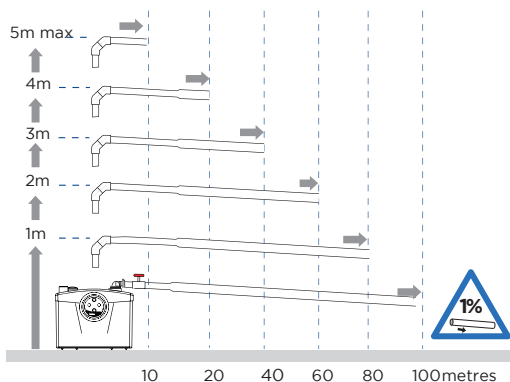

## FLOW RATE PERFORMANCE CHART

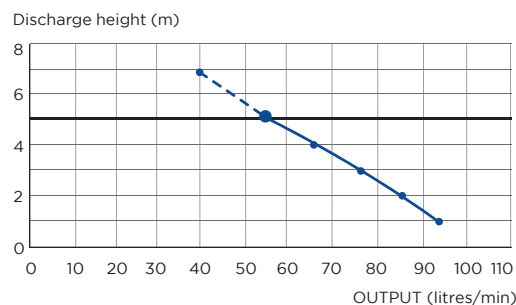

Made in France to the highest standards, needs to be installed by a licensed plumber

APPLICATIONS



TOILET



HAND BASIN



BATH



SHOWER



WMTS 106:2019  
Certificate No. 23048  
Manufacturer: SFA  
Brand: Saniflo

PRODUCT REFERENCE:  
SA98

[← Back to index](#)

[Product sheet](#) ↓  
[Instruction sheet](#) ↓



# Saniplus®

Saniplus® is a high capacity unit that will enable one to install a full bathroom. Its durable motor will enable long term and reliable running.



## TECHNICAL CHARACTERISTICS

<b>Discharge Pipework</b>	20 mm
<b>Motor Power</b>	400 Watts
<b>Voltages</b>	220-240 V/50 Hz
<b>Working Waste Water Temp</b>	35°C
<b>Product Weight</b>	7.4 kg
<b>Overall Measurements</b>	510 x 263 x 178 mm
<b>Inlet Pipework</b>	40 mm
<b>IP Rating</b>	IP44

## WHY CHOOSE THIS PRODUCT?

- Neat and functional design
- Can connect a toilet, basin, shower and bath tub
- Quiet technology
- Large tank capacity
- Macerator needs minimum 4.5 L of unrestricted flush for optimal function
- Can be equipped with Sanialarm (sold separately)

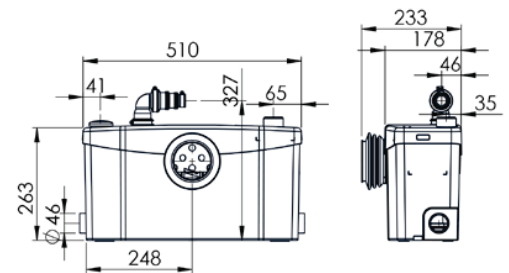

## VERTICAL/HORIZONTAL PERFORMANCE

Increase size of horizontal run by one pipe size after 5m. All horizontal pipework requires a minimum of 1:100 fall.

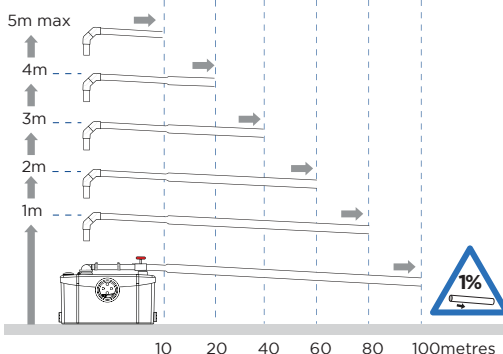

## FLOW RATE PERFORMANCE CHART

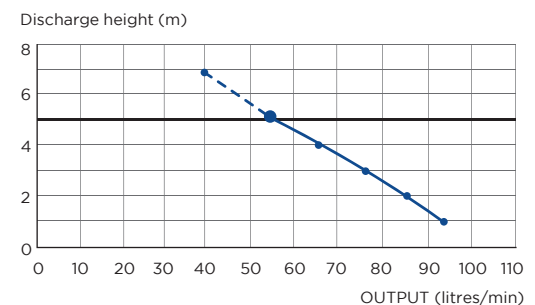

Made in France to the highest standards, needs to be installed by a licensed plumber



APPLICATIONS



TOILET



HAND BASIN



SHOWER



WMTS 106:2019  
Certificate No. 23048  
Manufacturer: SFA  
Brand: Saniflo

PRODUCT REFERENCE:  
SA96

# Sanipro®

Sanipro® is the ideal option for installing a toilet, hand basin and shower.



## TECHNICAL CHARACTERISTICS

<b>Discharge Pipework</b>	20 mm
<b>Motor Power</b>	400 Watts
<b>Voltages</b>	220-240 V/50 Hz
<b>Working Waste Water Temp</b>	35°C
<b>Product Weight</b>	6.4 kg
<b>Overall Measurements</b>	413 x 265 x 179 mm
<b>Inlet Pipework</b>	40 mm
<b>IP Rating</b>	IP44

## WHY CHOOSE THIS PRODUCT?

- Compact neat and unobtrusive
- Capacity for en-suite installation
- Quiet technology
- Macerator needs minimum 4.5 L of unrestricted flush for optimal function
- Can be equipped with Sanialarm (sold separately)

## VERTICAL/HORIZONTAL PERFORMANCE

Increase size of horizontal run by one pipe size after 5m. All horizontal pipework requires a minimum of 1:100 fall.

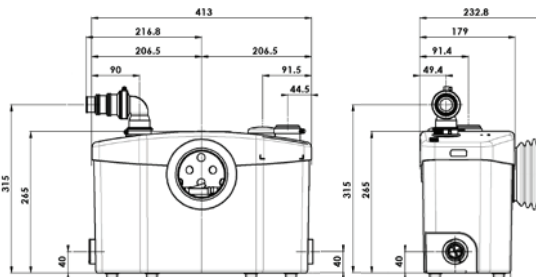
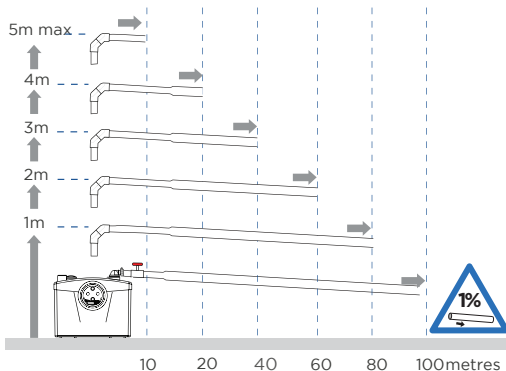

## FLOW RATE PERFORMANCE CHART

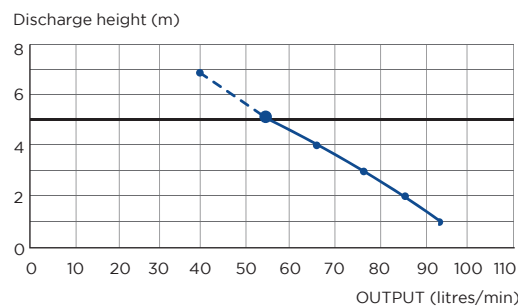

Made in France to the highest standards, needs to be installed by a licensed plumber

MACERATOR

APPLICATIONS



TOILET



HAND BASIN



BATH



SHOWER



WMTS 106:2019  
Certificate No. 23048  
Manufacturer: SFA  
Brand: Saniflo

PRODUCT REFERENCE:  
SA100



# Sanibest® Pro

Sanibest® Pro is a heavy duty Macerator suitable for busy commercial environments.  
Possible connection to a toilet, basin, bath and shower.



Cover allows easy access to electronic components



Robust blade suitable for heavy usage



## TECHNICAL CHARACTERISTICS

<b>Discharge Pipework</b>	20 mm
<b>Motor Power</b>	1100 Watts
<b>Voltages</b>	220-240 V/50 Hz
<b>Working Waste Water Temp</b>	35°C
<b>Product Weight</b>	12 kg
<b>Overall Measurements</b>	507 x 285 x 204 mm
<b>Inlet Pipework</b>	40 mm
<b>IP Rating</b>	IP44

## WHY CHOOSE THIS PRODUCT?

Ideal for heavy usage applications

Robust stainless steel macerator blade for intensive use

Macerator needs minimum 4.5 L of unrestricted flush for optimal function

Can be equipped with Sanialarm (sold separately)

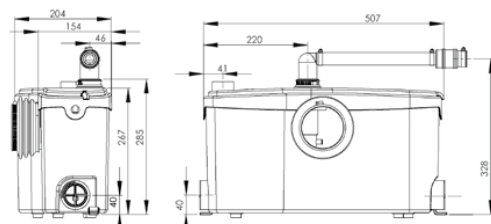

## VERTICAL/HORIZONTAL PERFORMANCE

Increase size of horizontal run by one pipe size after 5m.  
All horizontal pipework requires a minimum of 1:100 fall.

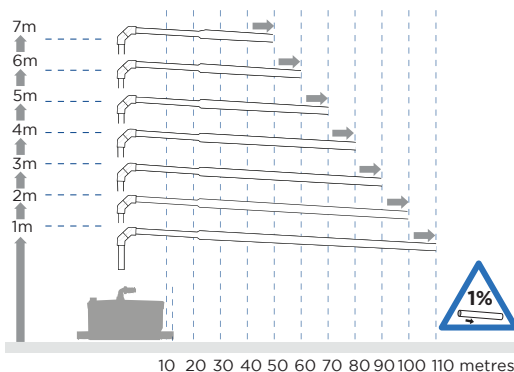

## FLOW RATE PERFORMANCE CHART

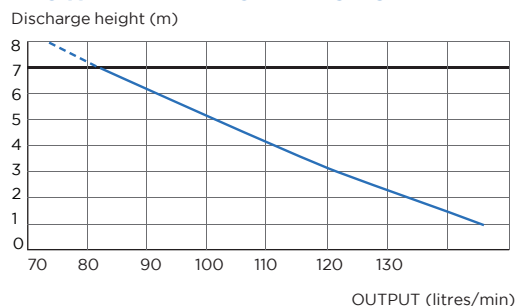

Made in France to the highest standards, needs to be installed by a licensed plumber



An empty office floor converted into **hospital accommodation**



Add an **additional toilet** anywhere





# INTEGRATED MACERATOR

MODEL NO	PRODUCT NAME	POSSIBLE CONNECTIONS	PUMPING HEIGHT	PAGE	APPLICATION	
					COMMERCIAL	DOMESTIC
SA 106	SANICOMPACT		3m	26	N/A	

 Domestic application  Commercial application Light = Light commercial Heavy = Heavy commercial

## TIPS

- To maintain optimum performance use Sanidescaler once every 6 months.

# How does Sanicompact work?



Pushing the flush button allows water into the bowl

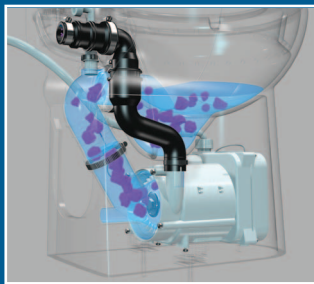

The waste is drawn into the macerator



The finely macerated waste is pumped out to the sewer via 25 mm pipe



Water is replenished in the bowl. It's ready to be used again





APPLICATIONS



TOILET



HAND BASIN



ATS 5200.101  
Certificate No. 23186  
Manufacturer: SFA  
Brand: Saniflo

PRODUCT REFERENCE:  
SA106

INTEGRATED MACERATOR

# Sanicompact®

Sanicompact® is the first all in one macerating toilet suite. Adding a toilet is now as easy as one product. The compact design enables a toilet to be added where space is limited making Sanicompact® ideal for a powder room or laundry addition. It also features a water saving cistern-less flush and the ability to add a basin.

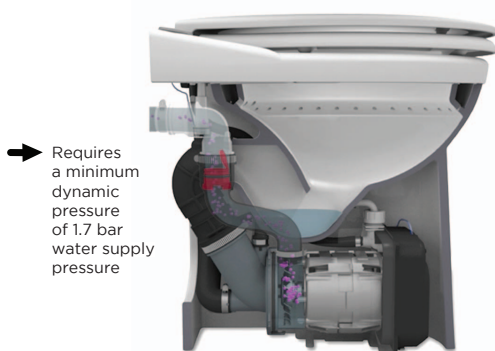

## TECHNICAL CHARACTERISTICS

<b>Discharge Pipework</b>	25 mm
<b>Motor Power</b>	550 Watts
<b>Voltages</b>	220-240 V/50 Hz
<b>Working Waste Water Temp</b>	35°C
<b>Product Weight</b>	23.2 kg
<b>Overall Measurements</b>	440 x 462 x 388 mm
<b>Dual flush</b>	1.8 / 3 L
<b>IP Rating</b>	IP44

## WHY CHOOSE THIS PRODUCT?

- A complete toilet suite with built in macerator
- Cistern-less flush button connected directly to the domestic water supply
- Features a soft-close toilet seat
- Water saving flush system
- Floor mounting kit
- Factory pre-mounted non return valve (supplied)

## VERTICAL/HORIZONTAL PERFORMANCE

Increase size of horizontal run by one pipe size after 5m. All horizontal pipework requires a minimum of 1:100 fall.

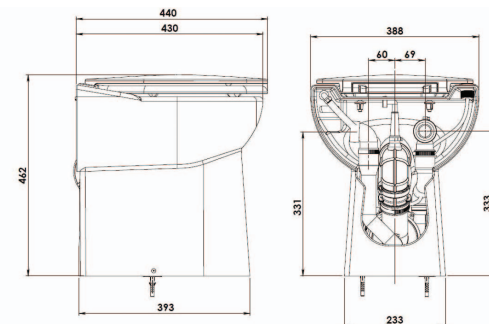
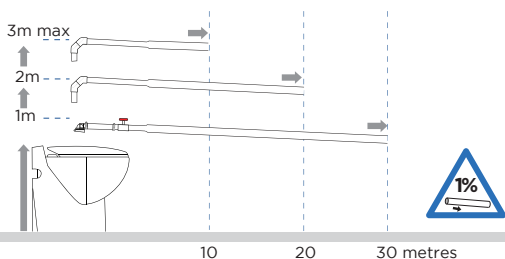

## FLOW RATE PERFORMANCE CHART

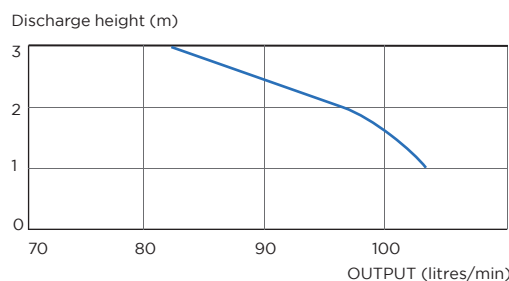

The more stars the more water efficient

**WATER RATING**  
www.waterrating.gov.au

**2.2** litres average flush  
3 L per full flush / 1.8 L per half flush

In accordance with AS/NZS 6400  
**Licence No. 1507**  
Saniflo

Made in France to the highest standards, needs to be installed by a licensed plumber



## Container housing for **mining camp**



# LIFTING STATION

MODEL NO	PRODUCT NAME	POSSIBLE CONNECTIONS	PUMPING HEIGHT	PAGE	APPLICATION	
					COMMERCIAL	DOMESTIC
SA 102	SANICOM 1		8m	29	HEAVY	N/A
SA 108	SANICOM 2		11m	30	HEAVY	N/A
SA 107	SANICUBIC 1 WP		11m	31	LIGHT ●	●
SA 104	SANICUBIC 2 PRO WP		11m	33	HEAVY	●
SA 111	SANICUBIC 2 VX SINGLE PHASE		10m	35	HEAVY	●
SA 300	SANICUBIC 1 GR		22m	37	HEAVY	●

● Domestic application ● Commercial application Light = Light commercial Heavy = Heavy commercial

## TIPS

- Sanicom can handle a maximum of 90°C for a short period (5 minutes) and is recommended for commercial kitchens due to its high temperature and grease handling capabilities (programmed maintenance required).
- For heavier commercial kitchen use, we recommend Sanicom 2 which has two powerful motors and alternates duty cycle making it ideal for trading continuity.
- Sanicubic is the ideal combined black and grey water lifting station. Sanicubic 1 WP is applicable for granny flat extensions and light commercial environments.
- Sanicubic 2 Pro WP is suitable for a whole house or demanding commercial projects with twin heavy duty motors.
- Use Sanicubic 2 VX where uncontrolled usage could cause blockages.



APPLICATIONS



HAND  
BASIN



BATH



SHOWER



WASHING  
MACHINE



DISH  
WASHER



KITCHEN  
SINK



WMTS 106:2019  
Certificate No. 23048  
Manufacturer: SFA  
Brand: Saniflo

PRODUCT REFERENCE:  
SA102



# Sanicom®1

Sanicom®1 is a powerful lifting station for grey water in busy commercial environments. Suitable for multiple connections including a basin, bath, shower, sink, dishwasher and washing machine.

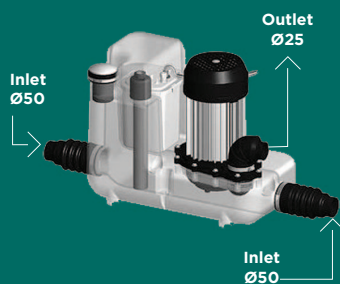

## WHY CHOOSE THIS PRODUCT?

Ideal for commercial applications e.g. cleaning/ catering sinks

Heavy duty, safe, reliable pump

Unit operates automatically

Two 50 mm side entries and air vent/connection to exterior

Working temperature of 35°C

Will handle up to 90°C for short periods (5 minutes)

## TECHNICAL CHARACTERISTICS

<b>Discharge Pipework</b>	25 mm
<b>Motor Power</b>	750 Watts
<b>Voltages</b>	220-240 V/50 Hz
<b>Tank Volume</b>	10 L
<b>Working Waste Water Temp</b>	35°C/Max 90°C (intermittent)
<b>Product Weight</b>	12 kg
<b>Overall Measurements</b>	490 x 330 x 230 mm
<b>Inlet Pipework</b>	50 - 65 mm
<b>IP Rating</b>	IP44

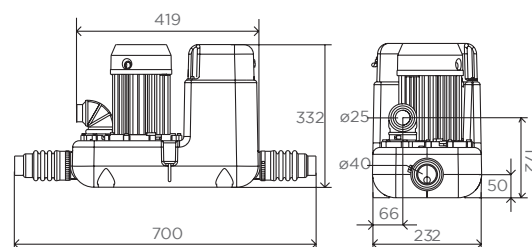

## VERTICAL/HORIZONTAL PERFORMANCE

Increase size of horizontal run by one pipe size after 5m.  
All horizontal pipework requires a minimum of 1:100 fall.

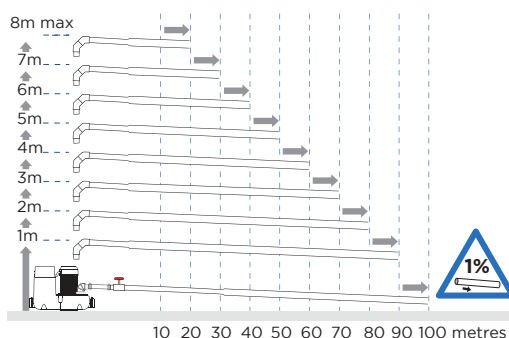

## FLOW RATE PERFORMANCE CHART

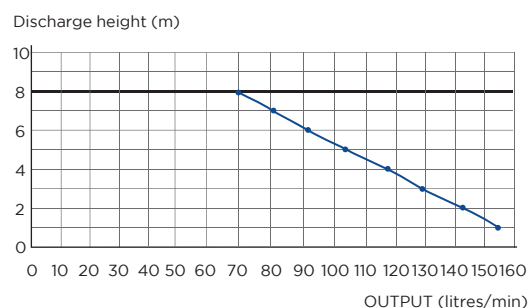

Made in France to the highest standards, needs to be installed by a licensed plumber

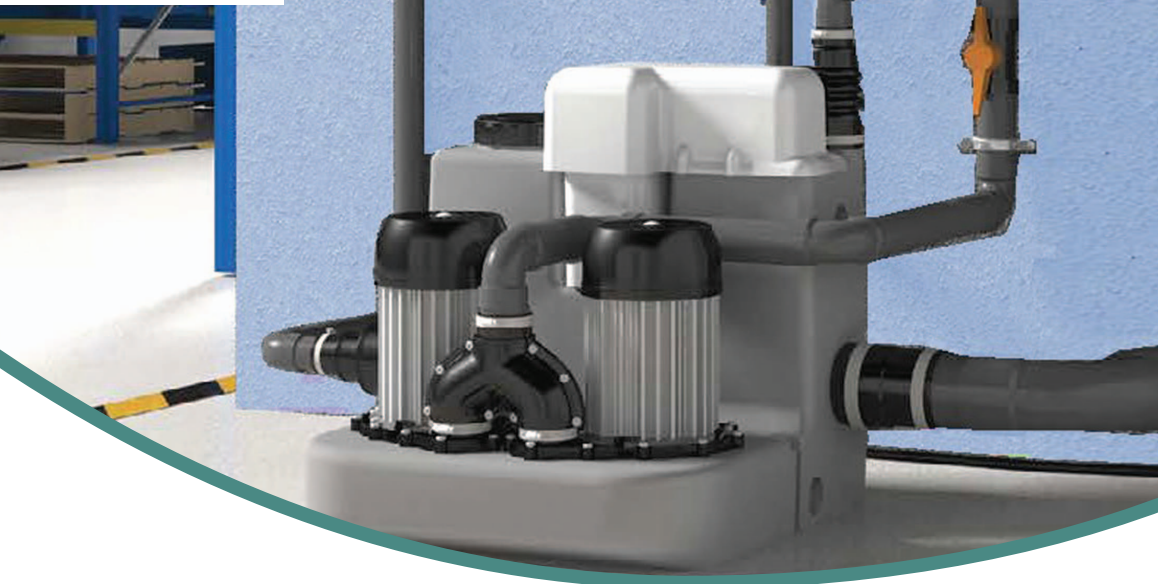

# Sanicom® 2

Sanicom® 2 is a commercial grey water lifting station featuring two powerful motors, ensuring continuity of service for your business.

## WHY CHOOSE THIS PRODUCT?

Ideal for heavy commercial applications

Safe, reliable twin motor pump for continuity of service

Unit operates automatically

1/65 mm rear and two 80 mm side entries and air vent connection for external venting

Working temperature of 35°C

Will handle up to 90°C for short periods (5 minutes)

External hard-wired alarm

Alternates duty cycle

2 x pre mounted non return valves (supplied)

2 m pre wired cable



## VERTICAL/HORIZONTAL PERFORMANCE

Increase size of horizontal run by one pipe size after 5m. All horizontal pipework requires a minimum of 1:100 fall.

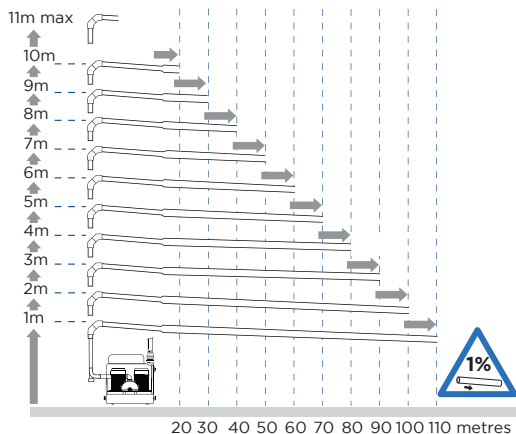

## TECHNICAL CHARACTERISTICS

<b>Discharge Pipework</b>	40/50 mm
<b>Motor Power</b>	1500 Watts x 2
<b>Voltages</b>	220-240 V/50 Hz
<b>Tank Volume</b>	34.5 L
<b>Working Waste Water Temp</b>	35°C/Max 90°C (intermittent)
<b>Product Weight</b>	26 kg
<b>Overall Measurements</b>	582 x 486 x 529 mm
<b>Inlet Pipework</b>	50/65/80 mm
<b>IP Rating</b>	IP44

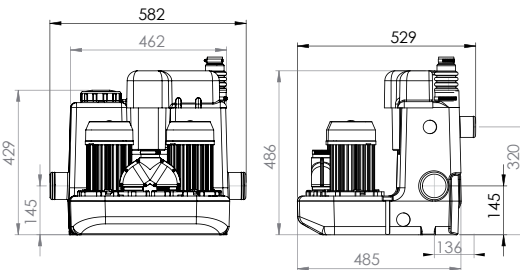

## FLOW RATE PERFORMANCE CHART

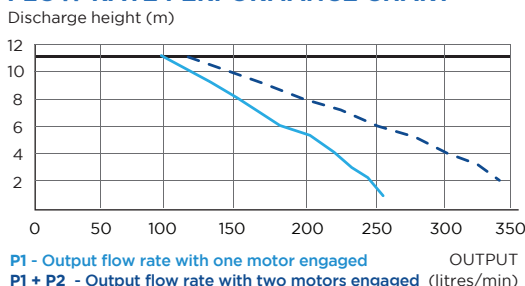

## APPLICATIONS



HAND BASIN



BATH



SHOWER



WASHING MACHINE



DISH WASHER



KITCHEN SINK

LIFTING STATION



WMTS 106:2019  
Certificate No. 23048  
Manufacturer: SFA  
Brand: Saniflo

PRODUCT REFERENCE:  
SA108



Wired alarm panel (optional)



External mounted control box

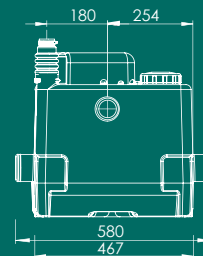

Made in France to the highest standards, needs to be installed by a licensed plumber

APPLICATIONS



TOILET



HAND BASIN



BATH



SHOWER



WASHING MACHINE



DISH WASHER



KITCHEN SINK



WMTS 106:2019  
Certificate No. 23048  
Manufacturer: SFA  
Brand: Saniflo

Product Reference:  
SA107

Made in France to the highest standards, needs to be installed by a licensed plumber



# Sanicubic® 1 WP

Sanicubic® 1 WP is ideal for use in a granny flat addition as it can remove waste water from multiple fixtures. It features a powerful 1500W motor, high flow rate performance, and an IP68 waterproof rating.



Note: Isolation valves should be fitted to the inlet pipework and discharge pipework to isolate the unit for servicing.

## WHY CHOOSE THIS PRODUCT?

Ideal for additional granny flats and studios

Tough, reliable macerating lifting station

New design with easily removable motor for servicing and maintenance

External hard wired audio visual alarm

Features integrated non-return valves

Centre heights of inlets 140 mm

Working temperature of 35°C. Will handle up to 70°C for short periods (5 minutes)

IP68 rated

Base of pump needs to be minimum 275 mm below lowest fixture

Allow 200 mm clearance around pump for maintenance purposes

## VERTICAL/HORIZONTAL PERFORMANCE

Increase size of horizontal run by one pipe size after 5m. All horizontal pipework requires a minimum of 1:100 fall.

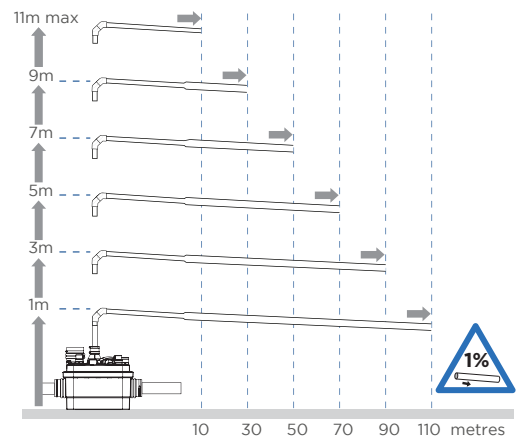





APPLICATIONS



TOILET



HAND BASIN



BATH



SHOWER



WASHING MACHINE



DISH WASHER



KITCHEN SINK



WMTS 106:2019  
Certificate No. 23048  
Manufacturer: SFA  
Brand: Saniflo

PRODUCT REFERENCE:  
SA107



Remote hard wired alarm panel



External mounted control box



Robust blade suitable for heavy usage

Made in France to the highest standards, needs to be installed by a licensed plumber

TECHNICAL CHARACTERISTICS

Discharge Pipework	40 mm
Motor Power	1500 Watts
Flow Rate	13 m <sup>3</sup> /h
Voltages	220-240 V/50 Hz
Tank Volume	32 L
Working Waste Water Temp	35°C/Max 70°C (intermittent)
Product Weight	20 kg
Overall Measurements	570 x 439 x 426 mm
Inlet Pipework	40/50/100/110 mm
IP Rating	IP68
Cable length for Control Panel	4m
Cable length for Wired Alarm Panel	5m

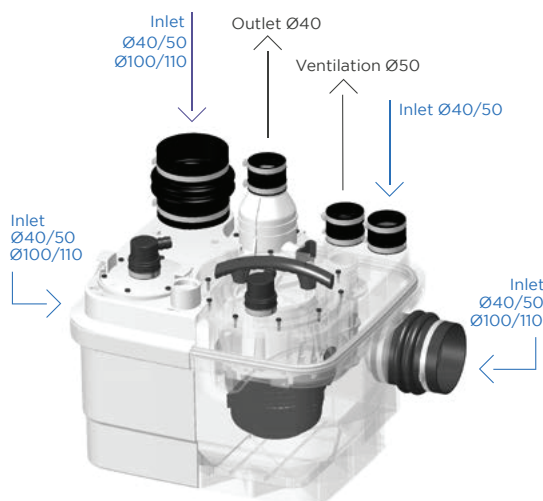
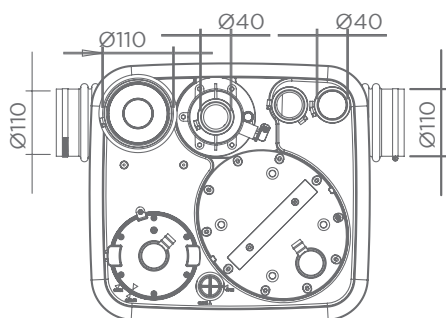
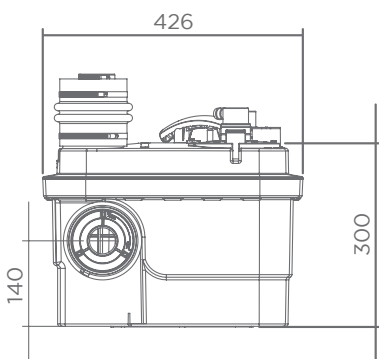
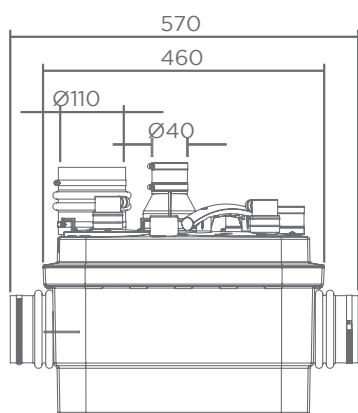

FLOW RATE PERFORMANCE CHART

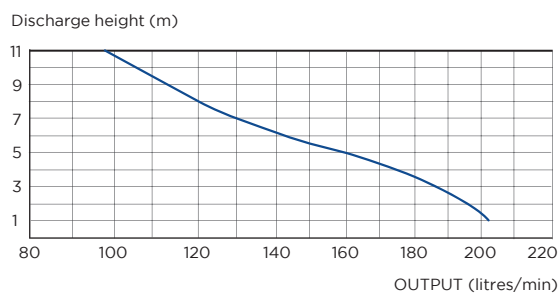

APPLICATIONS



TOILET



HAND BASIN



BATH



SHOWER



WASHING MACHINE



DISH WASHER



KITCHEN SINK



WMTS 106:2019  
Certificate No. 23048  
Manufacturer: SFA  
Brand: Saniflo

Product Reference:  
SA104

Made in France to the highest standards, needs to be installed by a licensed plumber

Product sheet



Instruction sheet



# Sanicubic® 2 Pro WP

The Sanicubic® 2 Pro WP is a high performance macerating lifting station for commercial and intensive residential use. Twin motor load balanced system utilising high performance stainless steel cutter technology and IP68 submersible rating.



Note: Isolation valves should be fitted to the inlet pipework and discharge pipework to isolate the unit for servicing.

## WHY CHOOSE THIS PRODUCT?

Ideal for busy business environments and larger domestic situations

Tough, reliable macerator pump

New design with easily removable motor for servicing and maintenance

Load balanced twin macerator pumps for a failsafe system

Alternate activation ensures even wear of motors

Two alarms for ultimate safety - hard-wired alarm plus remote wireless alarm

Centre heights of inlets 140 mm

Working temperature of 35°C. Will handle up to 70°C for short periods.

IP68 rated

Can be connected to a Building Management System

Base of pump needs to be minimum 275 mm below lowest fixture

Allow 200 mm clearance around pump for maintenance purposes

## VERTICAL/HORIZONTAL PERFORMANCE

Increase size of horizontal run by one pipe size after 5m. All horizontal pipework requires a minimum of 1:100 fall.

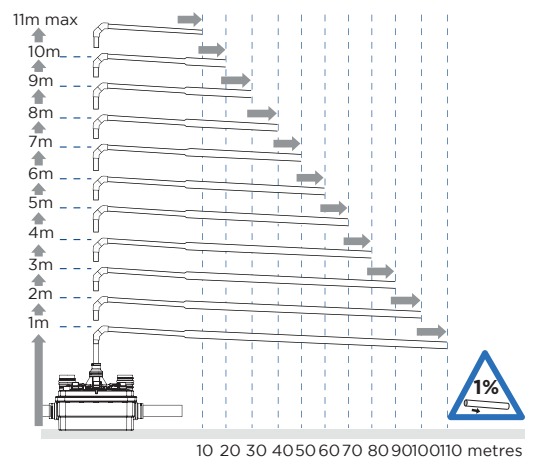

10 20 30 40 50 60 70 80 90 100 110 metres



## APPLICATIONS



TOILET



HAND  
BASIN



BATH



SHOWER



WASHING  
MACHINE



DISH  
WASHER



KITCHEN  
SINK

LIFTING STATION

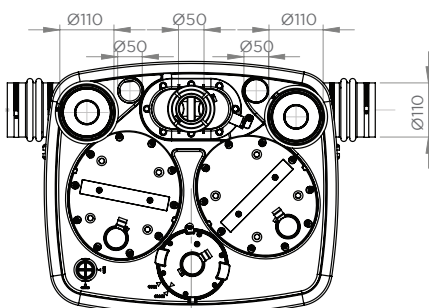
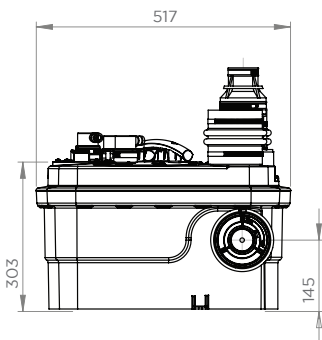
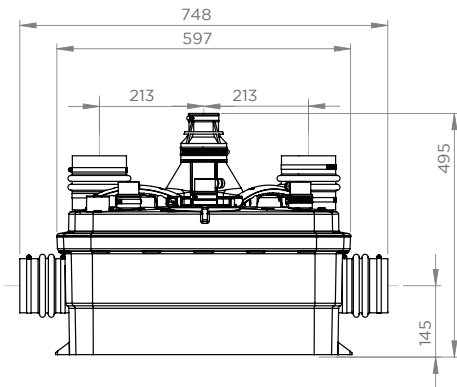

## TECHNICAL CHARACTERISTICS

Discharge Pipework	40 mm
Motor Power	1500 Watts x 2
Flow Rate	13 m <sup>3</sup> /h
Voltages	220-240 V/50 Hz
Tank Volume	45 L
Working Waste Water Temp	35°C/Max 70°C (intermittent)
Product Weight	33 kg
Overall Measurements	597 x 495 x 517 mm
Inlet Pipework	40/50/100/110 mm
IP Rating	IP68
Cable length for Control Panel	4m
Cable length for Wired Alarm Panel	5m

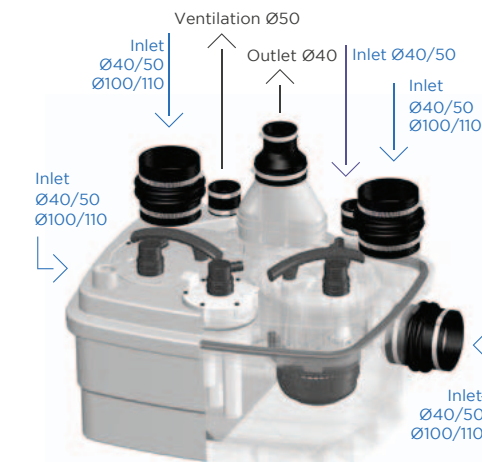

## FLOW RATE PERFORMANCE CHART

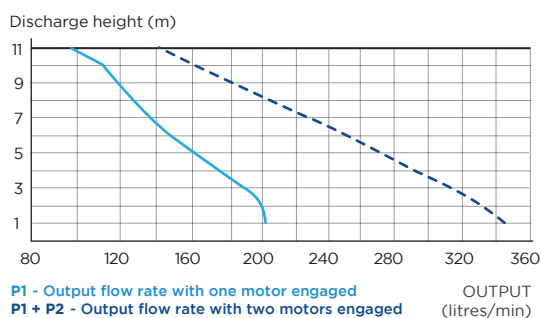

Externally mounted control box

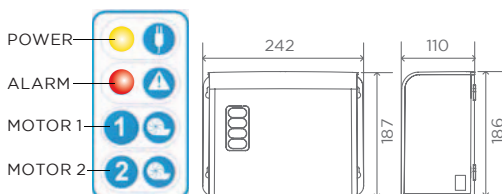

WMTS 106:2019  
Certificate No. 23048  
Manufacturer: SFA  
Brand: Saniflo

PRODUCT REFERENCE:  
SA104



ALARM | POWER  
SIGNAL INDICATOR

Remote wireless alarm



External mounted  
control box



Robust blade suitable  
for heavy usage

Made in France to the  
highest standards,  
needs to be installed  
by a licensed plumber

APPLICATIONS



TOILET



HAND BASIN



BATH



SHOWER



WASHING MACHINE



DISH WASHER



KITCHEN SINK



WMTS 106:2019  
Certificate No. 23048  
Manufacturer: SFA  
Brand: Saniflo

PRODUCT REFERENCE:  
SA111

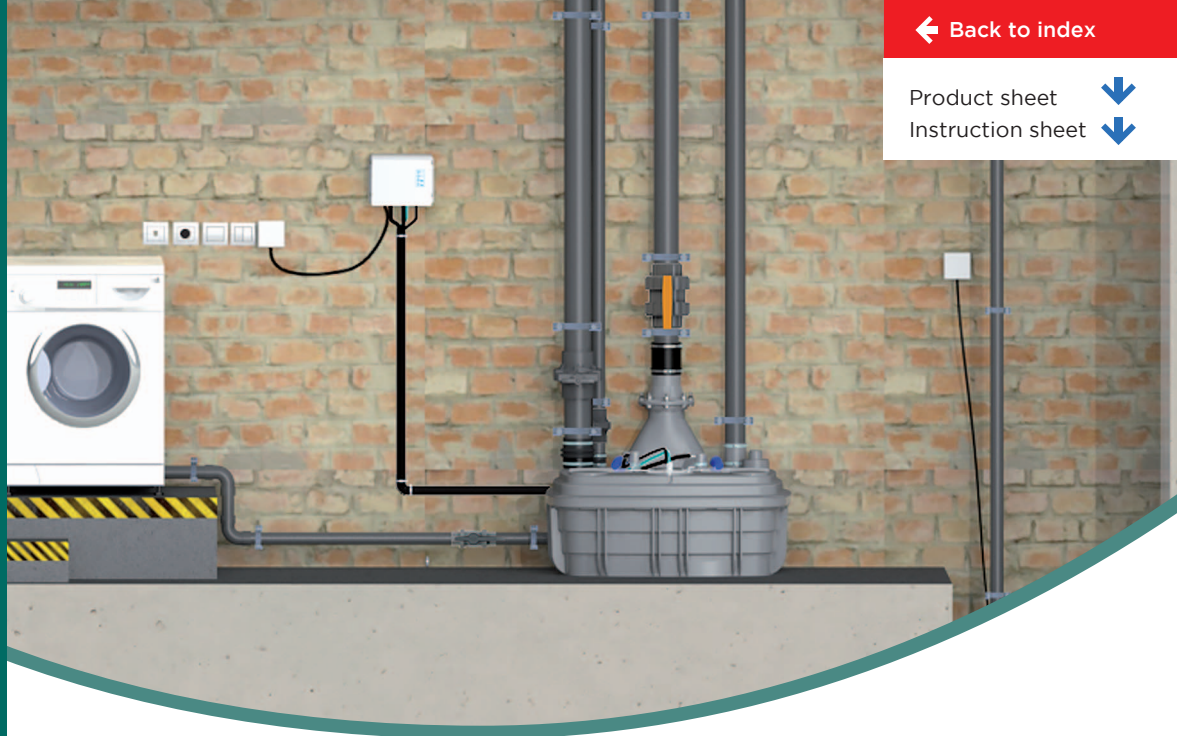

# Sanicubic® 2 VX

## SINGLE PHASE

Sanicubic® 2 VX is a powerful lifting station used for demanding commercial situations. It features twin 2000w motors, vortex blade-less pumping technology which is well suited for applications to eliminate blockages.

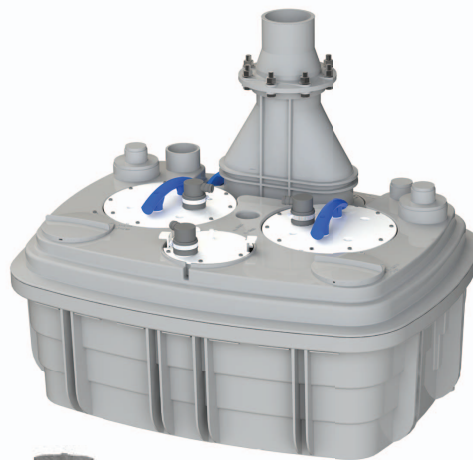

Note: Isolation valves should be fitted to the inlet pipework and discharge pipework to isolate the unit for servicing.

Two integrated non-return valves and four inlets: 40/50/100/110 mm and one inlet 40/50 mm.

Working temperature of 35°C. Will handle up to 70°C for short periods.

Volt free contact for connection to a Building Management System

Control panel has built in alarm, with an additional wired alarm.

Control panel mounted up to 4 m from pump and additional alarm can be mounted up to 5 m from control panel.

Base of pump needs to be minimum 275 mm below lowest fixture

Allow 200 mm clearance around pump for maintenance purposes

### VERTICAL/HORIZONTAL PERFORMANCE

Increase size of horizontal run by one pipe size after 5m. All horizontal pipework requires a minimum of 1:100 fall.

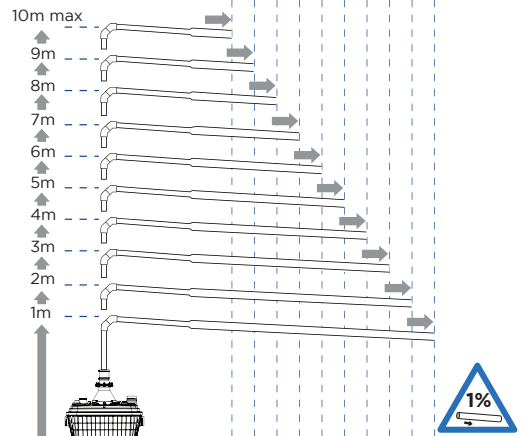

### WHY CHOOSE THIS PRODUCT?

Ideal for large volume commercial situations.

Large bore vortex pump with a 50 mm free passage capable of pumping waste water without the need to macerate.

Easily removable motors for servicing and maintenance.

Large 120 L tank volume.

Easy to install - no need to excavate.

Two alarms for ultimate safety - both hard-wired.

Made in France to the highest standards, needs to be installed by a licensed plumber



## APPLICATIONS



TOILET



HAND BASIN



BATH



SHOWER



WASHING MACHINE



DISH WASHER



KITCHEN SINK

LIFTING STATION

## TECHNICAL CHARACTERISTICS

<b>Discharge Pipework</b>	80 mm pipework. Maximum vertical lift 10 m. 100 mm pipework maximum vertical lift 6 m.
<b>Motor Power</b>	2000 Watts x 2
<b>Flow Rate</b>	40 m <sup>3</sup> /h
<b>Voltages</b>	220-240 V/50 Hz
<b>Tank Volume</b>	120 L
<b>Working Waste Water Temp</b>	35°C/Max 70°C (intermittent)
<b>Product Weight</b>	59 kg
<b>Overall Measurements</b>	952 x 751 x 713 mm
<b>IP Rating</b>	IP68
<b>Cable length for Control Panel</b>	4m
<b>Cable length for Wired Alarm Panel</b>	5m

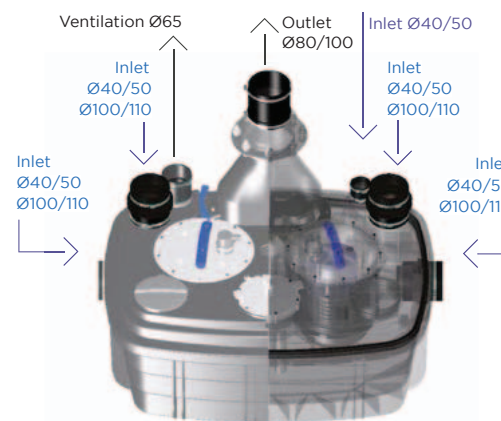
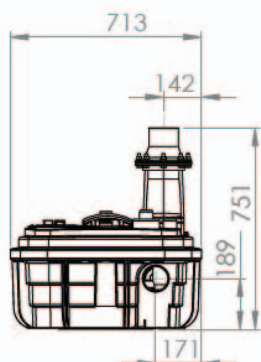
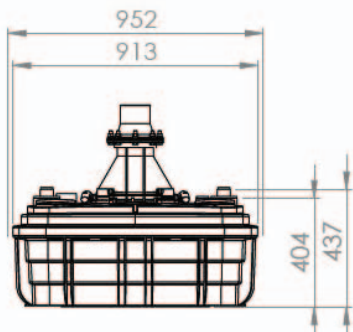
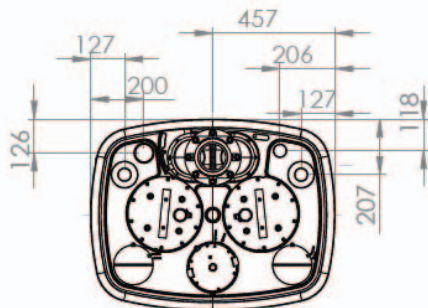

Wired alarm



External mounted control box

Externally mounted control box

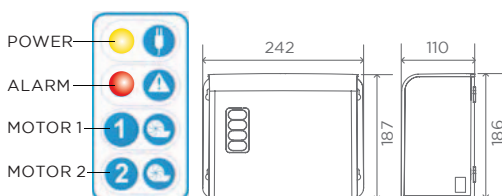

## FLOW RATE PERFORMANCE CHART

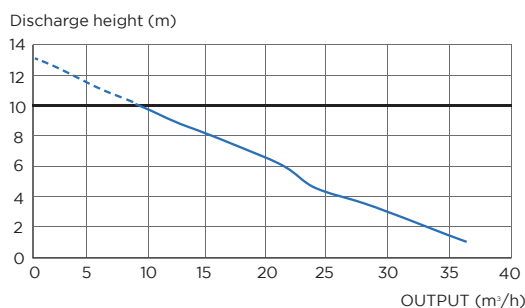

Made in France to the highest standards, needs to be installed by a licensed plumber

APPLICATIONS



TOILET



HAND  
BASIN



BATH



SHOWER



WASHING  
MACHINE



DISH  
WASHER



KITCHEN  
SINK



WMTS 106:2019  
Certificate No. 23048  
Manufacturer: SFA  
Brand: Saniflo

PRODUCT REFERENCE:  
SA300



# Sanicubic® 1 GR

Sanicubic® 1 GR is ideal for sloping waterfront properties where a boathouse could be converted to run amenities or rural properties where main drainage is too far away. It features a powerful 2200W motor, high flow rate performance, and an IP68 waterproof rating.

## WHY CHOOSE THIS PRODUCT?

- Compact dimensions
- Tough, reliable macerating lifting station
- Intelligent level controller
- External hard wired audio visual alarm
- Features integrated non-return valves
- Will handle up to 55°C intermittent
- IP68 rated

## VERTICAL/HORIZONTAL PERFORMANCE

Increase size of horizontal run by one pipe size after 5m. All horizontal pipework requires a minimum of 1:100 fall.

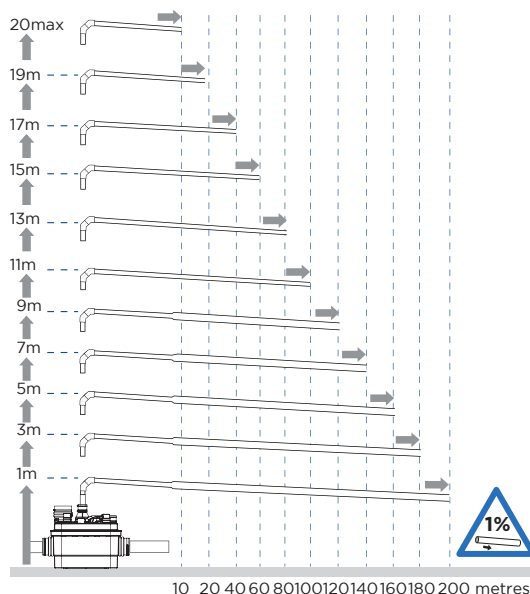

## TECHNICAL CHARACTERISTICS

<b>Discharge Pipework</b>	40 mm
<b>Motor Power</b>	2200 Watts
<b>Flow Rate</b>	17 m <sup>3</sup> /h
<b>Voltages</b>	220-240 V/50 Hz
<b>Tank Volume</b>	55 L
<b>Working Waste Water Temp</b>	55°C Max (intermittent)
<b>Product Weight</b>	64 kg
<b>Overall Measurements</b>	570 x 439 x 460 mm
<b>Inlet Pipework</b>	50/100 mm
<b>IP Rating</b>	IP68

## FLOW RATE PERFORMANCE CHART

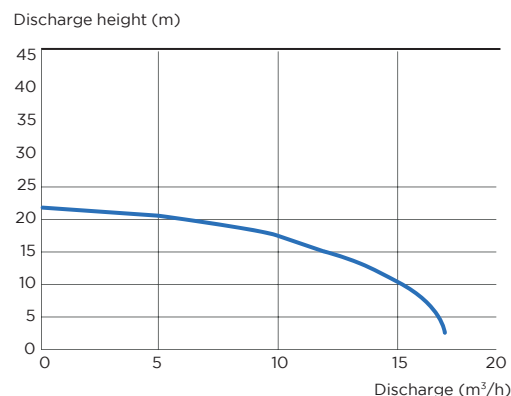



APPLICATIONS



TOILET

HAND BASIN



BATH

SHOWER



WASHING MACHINE

DISH WASHER



KITCHEN SINK

The controller system is operated via program settings which are displayed on the LCD screen. All settings are saved so that they are available when the control system is restarted. The display language can be changed. Besides the actual operational parameters, the controller system also saves the controlling process and records any irregularities which can be displayed on the LCD screen.



WMTS 106:2019  
Certificate No. 23048  
Manufacturer: SFA  
Brand: Saniflo

PRODUCT REFERENCE:  
SA300

CONTROLLER CHARACTERISTICS

Clear LCD display

Internal acoustic alarm

Programmable operation and fault signal

Maintenance interval counter

Recording of the fault protocol

Electronic monitoring of the motor current

Internal pressure sensor

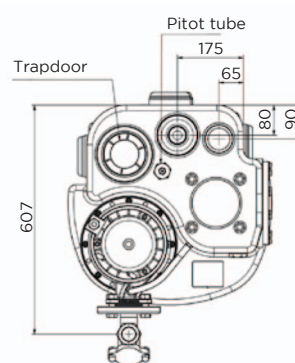
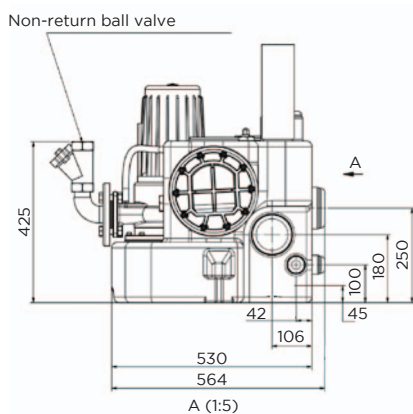

Flexible connection piece DN 65 for vent pipe

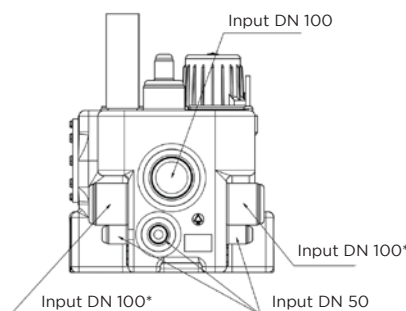
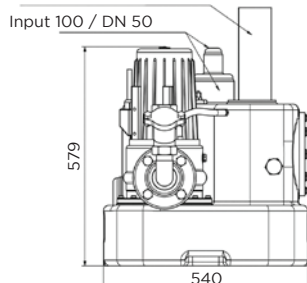

\*This entrance must be directed at a height of 250 mm above the ground level directly after the lifting station.

Made in France to the highest standards, needs to be installed by a licensed plumber

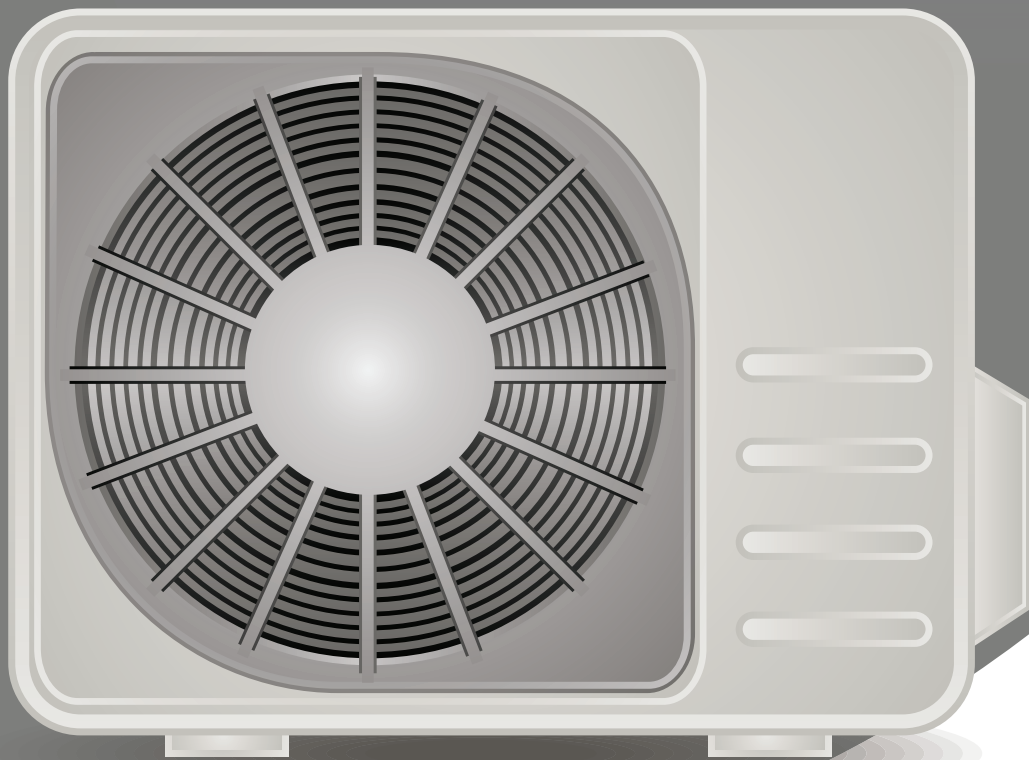







**Air conditioners produce condensate** which needs to be removed by a pump



# CONDENSATE



MODEL NO	PRODUCT NAME	POSSIBLE CONNECTIONS	PUMPING HEIGHT	PAGE	APPLICATION	
					COMMERCIAL	DOMESTIC
SA92	SANICONDENS PRO	 	4.5m	41	✓	✓
SA110	SANICONDENS CLIM MINI S		6m	42	✓	✓
SA91	SANICONDENS BEST FLAT	  	4.5m	43	✓	✓

## APPLICATIONS



REFRIGERATOR



AIRCONDITIONER

PRODUCT REFERENCE:  
SA92[← Back to index](#)[Product sheet](#)[Instruction sheet](#)

# Sanicondens® Pro

The Sanicondens® Pro is specifically designed for disposal of condensate from air conditioning units, refrigeration units, ice machines and dehumidifiers etc. Includes a non-return valve and 6 m flexible discharge pipe.



## TECHNICAL CHARACTERISTICS

<b>Discharge Pipework</b>	8/11 mm
<b>Motor Power</b>	60 Watts
<b>Flow Rate</b>	342 L/h
<b>Voltages</b>	220-240 V/50 Hz
<b>Tank Volume</b>	2 L
<b>Working Waste Water Temp</b>	35°C/Max 80°C (intermittent)
<b>Product Weight</b>	2 kg
<b>Overall Measurements</b>	260 x 169 x 143 mm
<b>Inlet Pipework</b>	25 mm
<b>IP Rating</b>	IP20

## WHY CHOOSE THIS PRODUCT?

2 L tank

Two entry points

Working temperature of 35°C.

Will handle temperatures up to 80°C for short periods (5 minutes)

Supplied with 2 m of electric cable and 6 m of discharge pipe

High level alarm connectivity

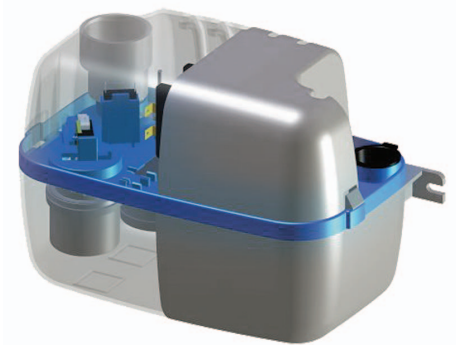

## VERTICAL/HORIZONTAL PERFORMANCE

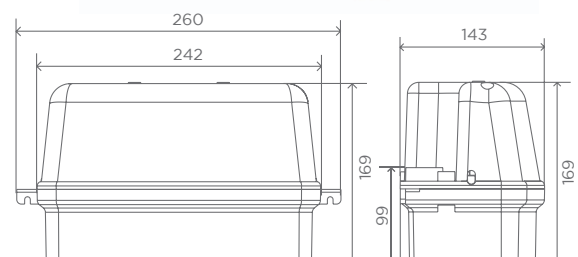

Made in France to the highest standards, needs to be installed by a licensed plumber

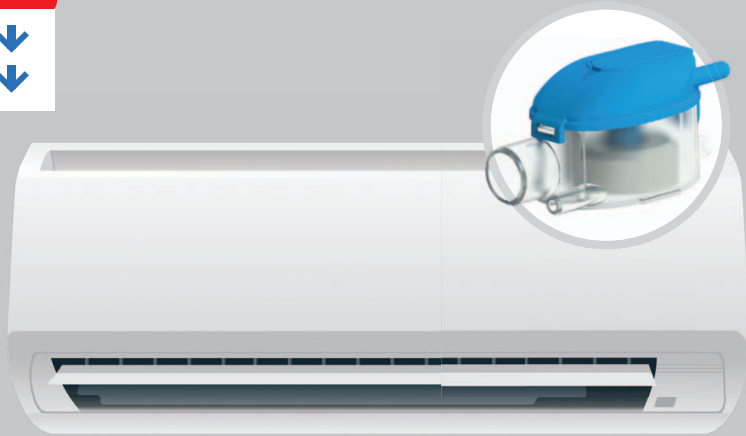

APPLICATIONS



AIRCONDITIONER

PRODUCT REFERENCE:  
SA110

CONDENSATE

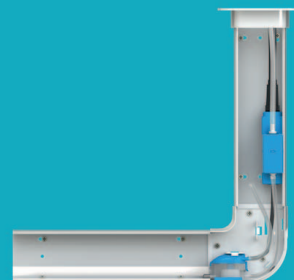

Sanicondens Clim Mini S pack includes a fixing plate

# Sanicondens® Clim Mini S

The new scaled down generation of pump for wall air conditioners, designed to meet market requirements and is now equipped with the best features.

## TECHNICAL CHARACTERISTICS

<b>Low Noise Level</b>	21 dB(A)
<b>Possible Connections</b>	Air conditioners up to 8kW / 27 000 BTU
<b>Ø int. Inlet</b>	16 mm
<b>Ø int. Discharge Pipework</b>	6 mm
<b>Maximum Fflow</b>	9 l/h +/- 15%
<b>Maximum Incoming Water Temperature</b>	35 °C
<b>Maximum Suction Lift (between the detection unit and the pump)</b>	2 m
<b>Voltage</b>	220-240 V
<b>Supply Frequency</b>	50 Hz
<b>Max Power</b>	22 W
<b>IP Rating Index</b>	IP20



## WHY CHOOSE THIS PRODUCT?

Designed for air conditioner split systems

Very quiet operation

A compact pump for hidden installation inside head unit

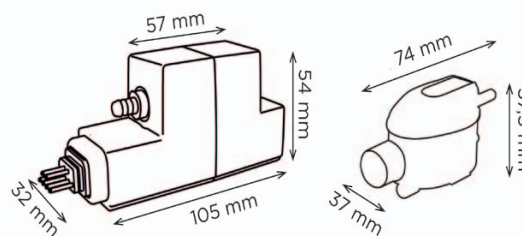

## FLOW RATE PERFORMANCE CHART

Discharge height (m)

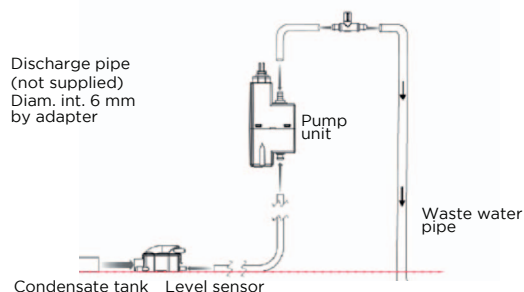
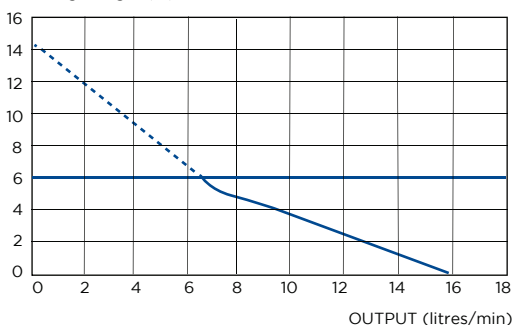

Made in France to the highest standards, needs to be installed by a licensed plumber

## APPLICATIONS



REFRIGERATOR



AIRCONDITIONER



ICE MACHINE

PRODUCT REFERENCE:  
SA91[← Back to index](#)[Product sheet](#)  
[Instruction sheet](#)

# Sanicondens® Best Flat

The Sanicondens® Best Flat is specifically designed for disposal of condensate from air conditioning units, refrigeration units and is ideal for ice machines due to its low profile design.

## TECHNICAL CHARACTERISTICS

<b>Noise Level</b>	45 dB
<b>Motor Power</b>	60 Watts
<b>Flow Rate</b>	342 L/h
<b>Voltages</b>	220-240 V/50 Hz
<b>Tank Volume</b>	3.5 L
<b>Working Waste Water Temp</b>	35°C/Max 80°C (intermittent)
<b>Product Weight</b>	2 kg
<b>Overall Measurements</b>	401 x 170 x 138 mm
<b>Inlet Pipework</b>	25/32 mm
<b>IP Rating</b>	IP20



## WHY CHOOSE THIS PRODUCT?

3.5 L tank

Three entry points

Working temperature of 35°C

Will handle temperatures up to 80°C for short periods (5 minutes)

Supplied with 1.5 m power cable and 5m of discharge pipe

High level alarm connectivity

Low profile inlet connection

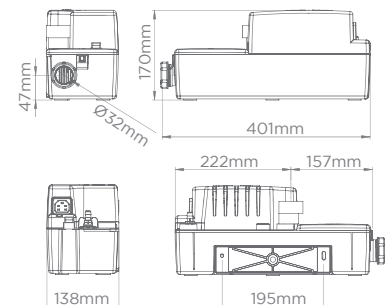

## VERTICAL/HORIZONTAL PERFORMANCE



## FLOW RATE PERFORMANCE CHART

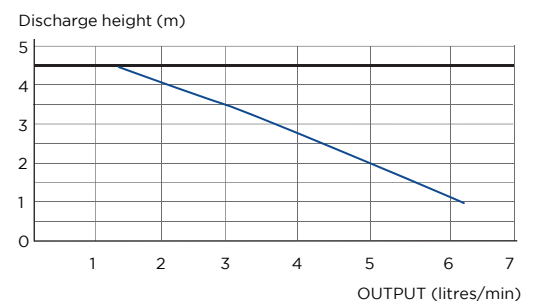

Made in France to the highest standards, needs to be installed by a licensed plumber

# ADDITIONAL PRODUCTS



MODEL NO	PRODUCT NAME	POSSIBLE CONNECTIONS	PAGE	APPLICATION	
				COMMERCIAL	DOMESTIC
ALARM 1	SANIALARM		47	✓	✓
SANI12661	SANIALARM INTERLOCK		48	✓	✓
DETAUST	SANIDESCALER		49	✓	✓
DN100	SANIKNIFE VALVE		49	✓	✓

## TIPS

- Test your batteries once a year in Sanialarm.
- Use 2.5 litres of descaler twice yearly. To do this turn the power off to the Macerator, pour 2.5 litres in the pan let sit for 3 hours then turn the power back on to clean, flush 3-4 times.
- We recommend using a knife valve to isolate the incoming waste line to accommodate servicing.

PRODUCT REFERENCE:  
ALARM1



# Sanialarm®

The Sanialarm® has a level pressure switch that triggers an alarm if the volume of water exceeds the maximum allowed level. The alarm emits a continuous warning sound until it is switched off and the problem rectified.

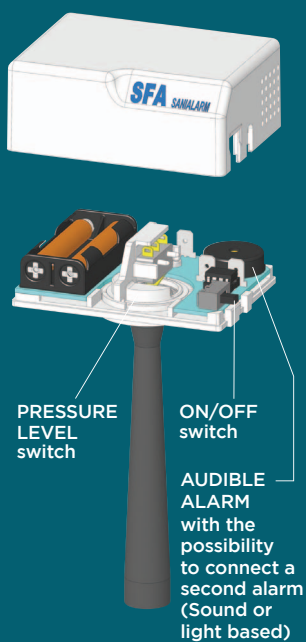

## TECHNICAL CHARACTERISTICS

<b>Power</b>	2 x AAA batteries - 1.5v (not included)
<b>Weight</b>	0.17 kg

## STEP BY STEP INSTALLATION

	Insert 2 x AAA batteries into case (not supplied)
	Drill a 10mm diameter hole into top of pump casing
	Apply silicone sealant onto tube switch before inserting
	Push Sanialarm into the tube opening
	Turn power ON

## WHY CHOOSE THIS PRODUCT?

Helps protect against flooding

80dB buzzer

Added peace of mind

Easy and quick installation onto lid of Saniflo unit

Suitable for new and existing Saniflo installations

Fits most Saniflo products - see product selector for details

Made in France to the highest standards, needs to be installed by a licensed plumber



ATSS200.30  
 Certificate No. W4004



# Sanialarm® Interlock

The Sanialarm Interlock has 3 functions, whereby it sets off an audible alarm in the event of a high level issue and simultaneously shuts off incoming water supply to prevent flooding whilst cutting the power supply to the dishwasher or washing machine.



## WHY CHOOSE THIS PRODUCT?

- Helps protect against flooding
- Audible and visual alarm
- Power interlock for dishwasher or washing machine
- Easy and quick plug and play installation, no electrician required
- Suitable for new and existing Saniflo installations
- Kit comes complete with magnetic float switch and low voltage solenoid with pre wired plugs

## TECHNICAL CHARACTERISTICS

<b>Voltage</b>	220-240 V/50 Hz
<b>Power consumption</b>	5 Watts
<b>Alarm</b>	80dB

**BMS** (Building Management System) connective

**NOTE:** Warranty only applies when the Sanialarm Interlock is used with Saniflo SFA products.

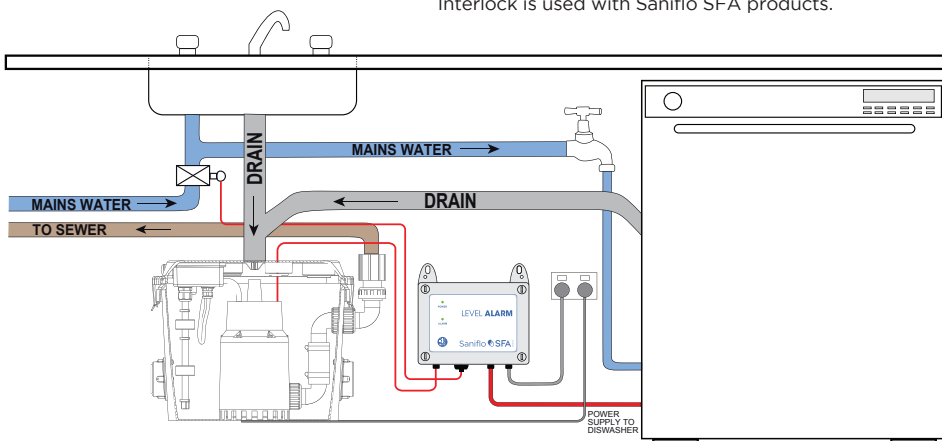

This product is Made in Australia to the highest standards, needs to be installed by a licensed plumber

APPLICATIONS



TOILET

PRODUCT REFERENCE:  
DETAUST



← Back to index

Product sheet



Instruction sheet



## Sanidescaler®

A powerful cleaning agent specially formulated for use with Saniflo products. The concentrated formula is essential for maintaining the efficiency of the pump's internal operation. Periodic use will ensure any waste build up is removed and bad odours are minimised.

\*Compatible with septic tank use.



## Saniknife Valve®

Installing a knife valve is essential for any commercial pump application. It should always be installed on the line coming into the inlets of the pump, so if maintenance is required, the pump can be isolated quickly and easily.

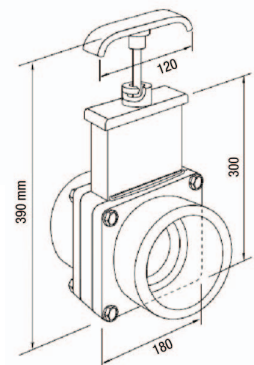

Made in France to the highest standards, needs to be installed by a licensed plumber



# INSTALLATION GUIDE

## 10 golden rules for correct installation

Detailed installation instructions accompany every product. Please provide access for any service requirements.

**1**

All horizontal pipes should have a minimum fall of 1:100. Discharge pipework should be uPVC. **Do not use 'pushfit' pipework/fittings.**

**2**

If a vertical rise is needed, this should be at the start of the run (within 30 cm of the unit) and from the high point there must be a minimum fall of 1:100 (see Rule 1).

**3**

Bends should be smooth/long radius, not tight elbows. Examples of uPVC pressure pipe and fittings shown.

**4**

Waste pipes entering the Saniflo unit should have a gravity fall of 1:40 or 3%.

**5**

Where the pipework falls below floor level increase the pipe size to break siphonage.

**6**

Each Saniflo discharge pipe should run separately to the sewer/vent pipe. If wastes are combined, it can only be to a larger pipe, which is on a gravity fall.

**7**

The unit should be easily accessible and removable in the event of service or maintenance being required. If boxed in, the boxing should be easily removed. Any extension between the WC pan spigot and wall should not exceed 200 mm and have a 1:40 fall.

**8**

As close coupled cistern dimensions vary it may be necessary with certain designs to use a spacer between cistern and wall.

**9**

Position the Saniflo unit directly behind the toilet pan, not underneath it.

**10** **ELECTRICAL CLASS 1 PRODUCT**

























Connect to power according AS 3000 Electrical Regulation as rules apply depending on location.

For technical support in AUS: 1300 554 779 or [technical@saniflo.com.au](mailto:technical@saniflo.com.au)  
For technical support in NZ: 0800107264 or [technical@saniflo.co.nz](mailto:technical@saniflo.co.nz)

With more than 60 years experience delivering innovative plumbing solutions Saniflo will guide you through the process. Contact our friendly team today to find out about our network of professional installers and suppliers.

**AU 1300 554 779 / NZ 0800 107 264**



- |   |   |
|---|---|
|  Groupe SFA International, France |  SFA SANIBROY, Germany       |
|  SANIFLO AB, Sweden               |  SFA BENELUX BV, Netherlands |
|  SANIFLO, England                 |  SFA SANIRISH, Ireland       |
|  SFA, Poland                      |  SFA SANIFLO INC., USA       |
|  SFA, Russia                      |  SFA SANIFLO INC., Canada    |
|  SFA SANIBROYEUR, Belgium         |  SFA SANITRIT, Italy         |
|   |  SFA SANIBROY, Slovenia      |
|   |   |
|  SFA GRUPO, Spain                 |  SANIFLO, Australia          |
|  SFA, Portugal                    |  SANIFLO, New Zealand        |
|  SFA SANIFLO SRL, Romania         |  SFASANIHYDRO, Turkey        |
|  SANIFLO, Austria                 |  SFA, Japan                  |
|  SFA SANIBROY, Czech Republic     |  SFA, China                  |
|  SFA SANIBROY, Switzerland        |   |

**ABOUT SANIFLO**

Saniflo is a brand created and owned by the French owned SFA Group . For over 60 years the SFA Group's goal has been to allow one to easily install toilets, showers, sinks, kitchens, baths and hand basins literally anywhere. From its early beginnings as the inventor of the domestic macerating system, the SFA Group is today amongst the main companies providing pump solutions worldwide. Synonymous with quality and technical expertise, Saniflo's made in France products comply with the strictest quality requirements and consistently meet customer expectations. Saniflo products all have Australian Watermark approval and their pumps are intended to be installed by licensed plumbers.

**SANIFLO'S DESIGN SERVICE**

Saniflo offers project consultancy and assists architects and hydraulic consultants by reviewing plans, assisting with design layouts and recommending the correct pumps and their ideal location. We even work with the plumber onsite during installation to ensure that everything goes as planned. Saniflo has a wide selection of products for domestic and commercial application to provide design flexibility.



Shaking up water



WMTS 106:2019  
Certificate No. 23048  
Manufacturer: SFA  
Brand: Saniflo

**SANIFLO AUSTRALASIA**

Tel: 1300 554 779  
General enquiries: [info@saniflo.com.au](mailto:info@saniflo.com.au)  
Technical & project support: [technical@saniflo.com.au](mailto:technical@saniflo.com.au)  
[WWW.SANIFLO.COM.AU](http://WWW.SANIFLO.COM.AU)

**SANIFLO NEW ZEALAND**

Tel: 0800107264  
General enquiries: [info@saniflo.co.nz](mailto:info@saniflo.co.nz)  
Technical & project support: [technical@saniflo.com.au](mailto:technical@saniflo.com.au)  
[WWW.SANIFLO.CO.NZ](http://WWW.SANIFLO.CO.NZ)