

**Ceilings**

# STRATOPANEL

WITH CLEANEO TECHNOLOGY

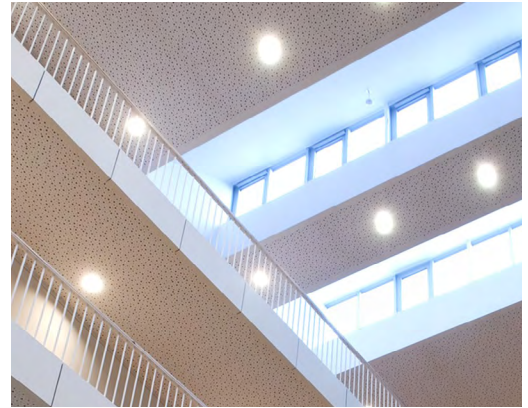

**Description**

**Stratopanel** is the ideal solution for noise absorption treatment and is available in a number of stylish designs for creative freedom. The perfect balance of functional and aesthetics, allowing Architects to design with flexibility and confidence, creating monolithic and seamless internal spaces.

Stratopanel has been engineered with Cleaneo air purifying technology, reducing the impact of internal in-air pollutants.

**Board Specification**

Feature	Description
Thickness	12.5mm
Patterns	Circular 8/18 R Circular 12/25 R Square 12/25 Q Alternating Circular 12/20/66 R Random Plus 8/15/20 R Random Rectangular RE
Edge Profile	UFF edge
Sheet Size	Refer to Table 1
Open Area	Circular 8/18 R - 15.5% Circular 12/25 R - 18.1% Square 12/25 Q - 23% Alternating Circular 12/20/66 R - 19.6% Random Plus 8/15/20 R - 9.9% Random Rectangular RE - 13.6%
Mass	9.2kg/m <sup>2</sup> - 10.5kg/m <sup>2</sup> nominal
Fire Hazard Properties	Group 1 – in accordance with NCC Specification C1.10 Fire Hazard Properties – Floors, Walls and Ceilings.
VOC	Less than 0.500mg/m <sup>2</sup> /hr TVOC

**Advantages**

- Monolithic, seamless look or express joint look
- No visible joints after finishing
- Improve indoor climate with Cleaneo air purifying Technology
- Repaintable without the loss of acoustic performance
- Demountable/reusable when using screw cap system with expressed UFF edge profile
- Fast installation

**Application**

- Noise absorption treatment for ceilings spaces of commercial projects such as educational institutions, hospitals, retail, offices, conference halls and hospitality.



## Performance Details

### Acoustic

Stratopanel ceiling system has been designed to reduce noise reverberation in the internal space. The acoustic performance of the space can be fine tuned by the choice of Stratopanel perforation patterns, adjusting depth of ceiling cavity and cavity insulation. Stratopanel perforated plasterboard offers acoustic performances of up to NRC 0.80.

### Cleaneo Technology

Cleaneo is derived from a natural volcanic rock called zeolite. When plasterboard containing dehydrated zeolite is perforated, it purifies air as it streams through the perforations, removing unpleasant pollutants and leaving the air cleaner. Independent air-pollutant tests have been undertaken in accordance with VDI (Association of German Engineers) guidelines over a testing period of 28 days.

## Acoustic Standard Perforation



Product Name	Perforation	Open Area	Thickness (w x l) mm	Weight (kg/m <sup>2</sup> )	Ceiling Cavity Depth (mm)	Without Insulation				With Insulation (50G14 or 75G11)			
						$\alpha_w$	NRC	SAA	Class	$\alpha_w$	NRC	SAA	Class
Circular 8/18 R		15.5%	12.5 (1188x1998)	9.2	65	0.60	0.60	0.57	C	0.70	0.65	0.66	C
					200	0.60	0.60	0.61	C	0.65	0.65	0.65	C
					400	0.60(L)	0.60	0.60	C	0.60	0.65	0.63	C
Circular 12/25 R		18.1%	12.5 (1200x2000)	9.9	65	0.60	0.60	0.60	C	0.75	0.70	0.70	C
					200	0.65	0.65	0.65	C	0.70	0.70	0.70	C
					400	0.65(L)	0.60	0.64	C	0.70	0.65	0.69	C
Square 12/25 Q		23.0%	12.5 (1200x2000)	9.6	65	0.60	0.65	0.62	C	0.80	0.80	0.77	B
					200	0.70	0.70	0.70	C	0.80	0.75	0.77	B
					400	0.70(L)	0.65	0.68	C	0.75	0.75	0.75	C
Alternating Circular 12/20/66 R		19.6%	12.5 (1188x1980)	9.4	65	0.60	0.60	0.57	C	0.70	0.75	0.72	C
					200	0.60(L)	0.65	0.66	C	0.70	0.70	0.71	C
					400	0.65(L)	0.60	0.64	C	0.70	0.70	0.70	C
Random Plus 8/15/20 R		9.9%	12.5 (1200x2000)	10.5	65	0.50	0.45	0.46	D	0.50	0.50	0.51	D
					200	0.50	0.50	0.48	D	0.50	0.50	0.49	D
					400	0.50	0.45	0.47	D	0.50	0.50	0.49	D
Random Rectangular RE		13.6%	12.5 (1199x1999)	9.3	65	0.50	0.50	0.51	D	0.55	0.55	0.57	D
					200	0.50	0.55	0.54	D	0.55	0.55	0.57	D
					400	0.55	0.50	0.53	D	0.55	0.55	0.56	D

Table 1 : Product specification and acoustic performance

## Edge Profile

### UFF Edge

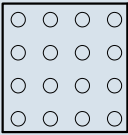
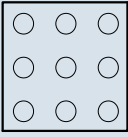
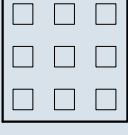
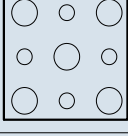
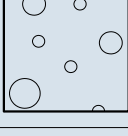
The unique edge profile ensures that panels are installed straight, in alignment and the continuous perforations patterns are in perfect alignment.

The UFF edge profile and Uniflott jointing compound when professionally installed by contractors forms a tapeless joint that appears seamless.

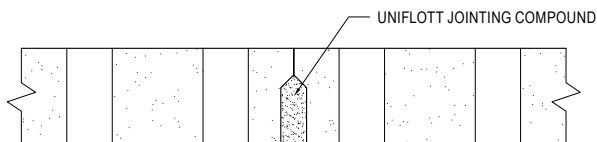

## Installation

Stratopanel must be installed with a Rondo KEY-LOCK suspended ceiling system, using a screw fix only fastening system. For UFF edges, Uniflott jointing compound must be used in conjunction with a suitable Knauf topping compound. Refer to Stratopanel installation brochure for details.

## Safe Use Instruction

Refer Safety Data Sheet. Stratopanel is not classified as hazardous according to the criteria of the NOHSC.

## Sustainability

Knauf products are manufactured from a combination of natural gypsum and liner paper. Lightweight plasterboard construction offers the benefits of low embodied energy, non-toxic materials and enhance indoor air quality through Stratopanel's engineered Cleaneo air purifying technology within the gypsum core.

When installed with expressed UFF edge profile and cap screw system, the panels are demountable and can be repurposed avoiding landfill.

## Indoor Environment Quality

Knauf plasterboard products have been independently tested to confirm compliance with Green Star specification limits for VOCs and formaldehyde, refer to report CETEC V2111.

## References

Refer to [knaufapac.com/au/stratopanel](https://www.knaufapac.com/au/stratopanel) for Material Safety Data Sheet, Volatile Organic Compound Emission details and other additional information.