



# The Mark of Reliability

(Est. 1930)

GE Commercial Floor Drains, Wastes & Cleanouts



**GALVIN ENGINEERING**

[www.galvinengineering.com.au](http://www.galvinengineering.com.au)





## INDEX

### INTRODUCTION

General Information .....	2
Ordering & Specification Details .....	3 - 4
Our Customer Service Policy .....	4

### GRATE & CLEANOUT ASSEMBLIES

Round Floor Drain Grate Assemblies and Slip-Safe Bolted Cleanout .....	5
Prison Floor Drain Grate Assemblies .....	5
Vinyl Floor Drain Grate Assemblies and Slip-Safe Bolted Cleanouts .....	6
Square Floor Drain Grate Assemblies .....	7
Planter Box Floor Drain Assemblies .....	7

### BODY ASSEMBLIES

Standard CI Floor Drain Body Assemblies .....	8
Deep CI Floor Drain Body Assemblies .....	8
Horizontal CI Floor Drain Body Assemblies .....	9
Balcony CI Floor Drain Body Assemblies .....	9
Economy uPVC Floor Drain Couplings .....	10

### ACCESSORIES

Accessories, S/S Strainer Baskets and Sediment Buckets .....	10
--	----

### COMBINATIONS

Vertical Combinations .....	11
Horizontal Combinations .....	12
Bucket Trap Combinations .....	13
Industrial Trap Combinations .....	14
Planter Box Combinations .....	15

### MISCELLANEOUS

Special Application Units .....	15
---------------------------------	----

## GENERAL INFORMATION

This brochure illustrates GE's range of floor drains, wastes & cleanouts designed and manufactured in Australia for the collection and dispersal of surface water, and for the provision of inspection points. It provides technical data on water flow capacities, loadings, dimensions and materials, plus ordering and specification details. A second brochure is also available that illustrates the range of GE Roof Outlets that are suited for flat roof drainage systems.

The products in this brochure provide a high quality floor drainage and inspection point system for a variety of applications in commercial and industrial environments. Units are available for the drainage of finished and unfinished floors, such as screeded, tiled and flexible sheet flooring, in both interior and exterior applications.

All units have been designed and developed in Australia in our workshop using CAD. All grate assemblies and cleanouts have been load tested to class D of AS3996 by a NATA approved testing facility. All grate assemblies have been water flow tested by the Water Corporation of Western Australia.

An extensive range of grate assembly and cleanout sizes and designs are available. The threaded versions can be used with a full selection of main body assemblies. The grate assemblies and cleanouts feature a fully machined face for an extra smooth surface finish. Grate assemblies and cleanouts come in different outlet styles, including slip-in to uPVC, copper or HDPE, and also BSP thread.

Our unique Variable Height Floor Drain design features height adjustment using industry compatible BSP parallel threads on grate assemblies and clamp rings. This means that all BSP style grate assemblies are interchangeable in the main body assemblies, or they can be connected directly to the pipework using standard plumbing fittings.

The main body assembly's reversible clamp ring ensures that the unit can accommodate a wide range of screed thicknesses and it also provides a fine degree of tolerance in height adjustment during installation. This enables the level of the grate to be precisely set in relation to the floor thickness. The clamp ring also ensures a watertight seal on the membrane for sub-surface drainage, whilst the sloping sides and the smooth finish ensure good surface drainage and effective self cleaning for maximum hygiene.

The main body assemblies are available in female BSP threaded and slip-on to uPVC, or copper or HDPE, using purpose built rubber ring seals. The various pipe connection options are all standard in the industry to ensure a strong and hassle free choice of connections.

Customised products can be manufactured on request, and a full range of accessories such as strainers, sediment buckets and extension pieces, are readily available.

Galvin Engineering Pty Ltd is an Australian owned and operated ISO9001, quality endorsed company which has been manufacturing for the plumbing industry since 1930. We have been manufacturing roof drainage products for the local market for over 25 years. At Galvin Engineering, we pride ourselves at being able to offer superior quality products at competitive prices, supported by fast delivery, friendly service and technical back-up.



## Ordering & Specification Details

### 1. Flow Capacity

The size and quantity of GE Floor Drain Grate Assemblies required can be decided with the assistance of the Flow Capacity Chart below. The flow capacity of each grate assembly is given as determined during tests conducted by the Water Corporation of Western Australia.

These flow capacity figures are based on the grate assembly only, draining to atmosphere with no restrictions. The actual flow capacity will be reduced due to numerous possible restrictions, such as main body size and design, drain pipe size, strainers, sediment buckets, debris, etc...

**FLOW CAPACITY CHART (litres/sec):**

Grate Type	Pressure Head mm of water		
	20mm	30mm	40mm
Round 100 Dia.	0.9	1.2	1.5
Round 150 Dia.	2.1	2.8	3.5
Round 200 Dia.	3.7	4.8	6.7
Round 300 Dia.	4.7	9.1	12.2
Square 100 x 100	1.1	1.4	1.5
Square 150 x 150	3.1	3.7	4.1
Square 200 x 200	3.9	6.4	7.4
Square 300 x 300	4.7	9.1	13.9
Vinyl 100 Dia.	0.9	1.2	1.5
Vinyl 150 Dia.	2.1	2.8	3.5
Vinyl 200 Dia.	3.7	4.8	6.7

### 2. Load Rating

Floor loadings should always be considered, however, with GE Floor Drain Grate Assemblies & Cleanouts the selection of the class of grate or cleanout is made simple.

All floor drain grate assemblies and cleanouts supplied by Galvin Engineering have been designed and tested to withstand heavy duty loads. All grate assemblies and cleanouts have been classified as class D during tests conducted by a NATA approved testing facility to the requirements of AS3996 (BS497 Part 1). Details are given below:

Class 'D' - may be either:

- (i) units for unrestricted use in the carriage ways of arterial and other roads which may carry fast moving heavy vehicles where wheel loads will not exceed 5.2 tonne; or
- (ii) units for restricted use in areas trafficked by slow moving heavy vehicles (generating no impact loading) where wheel loads will not exceed 10.5 tonne.

### 3. Grate Assembly & Cleanout - Design and Materials

Once the size has been determined, the grate assembly or cleanout design and material can be selected. The designs are available in round, square (sizes 150mm and over are hinged), and round with a vinyl clamp. Planter box assemblies are also available.

Grate assemblies and cleanouts come standard in nickel bronze. The following paragraph is an abstract taken for "Casting Copper Bases Alloys", American Foundry Society, 1984, CH13, p171:

*"The nickel silver alloys are characterised by a pleasing white appearance. These alloys are commonly used in corrosion-resisting application such as dairy and food machinery parts, restaurant kitchen equipment, steam fittings, hardware for marine and building applications, etc.,"*

Galvin Engineering uses a commercially available alloy known as Nickel-Bronze. This alloy contains between 2.5 to 3.5% lead, 32.0 to 34.0% zinc, 9.5 to 10.5% nickel, with the remainder being copper.

Grate assemblies and cleanouts are also available non-standard in the following metals:

<b>Non-Standard:</b>	Brass	AS1565/C85210	(BS1400/SCB1)
	Grey Cast Iron	AS1830/T180	(BS1452/Grade 180)
	SG Iron	AS1831/500-7	(BS2789/Grade 500-7)
	Aluminium	AS1874/AA601	(BS1490/LM25)
	Stainless Steel		

GE Wastes carry the Standards Mark AS1589 (licence #2448).







## 4. Main Body Assembly - Design and Materials

The main body assembly, which includes the clamp ring, is available in vertical standard, vertical deep body, horizontal or balcony style.

In the case of unfinished floors where a membrane is not used and sub-surface drainage is not critical, a main body assembly may not be required. In this situation the various grate assemblies can be connected directly to the drain pipe or a purpose built uPVC coupling can be used to substitute for the main body assembly.

Main body assemblies are supplied standard in enamel coated Grey Cast Iron to the Australian Standard AS1830/T180 (BS1452/Grade180).

Other non-standard metals can be used on request.

Galvanising can be arranged if required and is performed to the requirements of AS1650 (BS729).

## 5. Compatibility (Grate Assembly & Main Body)

Not all grate assemblies can be used with all main body assemblies. In some cases the restriction may be too great or the configuration may be physically impractical.

The compatibility chart below should be referred to, to ensure that your selected combination is available.

Main Body Size (mm) (Dimension E)	Grate Assembly Size (mm) (Dimension A)			
	100	150	200	300
Ø 50	Yes	Yes	No	No
Ø 80	Yes	Yes	No	No
Ø 100	Yes	Yes	Yes	Yes
Ø 150	No	Yes	Yes	Yes

## 6. Accessories and Options

Finally, any accessories and options such as strainers should be considered. The accessories and options are illustrated on the following pages. Strainers and sediment buckets are made from 316 stainless steel (ASTM A240M-316). Remember, custom built design and variations are our specialty, and are available on request if feasible.

## 7. Ordering & Specification Notes

Items can be ordered or specified by quoting the item #'s as shown on the following pages. For common combinations (e.g. for bucket traps - a floor grate assembly, plus a floor drain main body assembly, plus a strainer), special combination item's are also listed to make ordering and specifying easier.

## 8. GE 'Slip-Safe' Bolted Cleanouts

In conjunction with the WA Health Department and several hydraulic consultants working on a number of WA hospitals, GE modified its old style of commercial cleanouts to be slip-resistant. The unique design of the GE 'Slip-Safe' Bolted Cleanout significantly reduces the likelihood of a serious accident occurring from a person slipping on a smooth surface. With a serious fall potentially resulting in critical physical injuries and thousands of dollars in legal claims, the use of the GE 'Slip-Safe' Bolted Cleanouts makes good commercial sense.

If required, GE's 'Slip-Safe' Bolted Cleanouts can be manufactured with the option of a gas tight lid.

### OUR NEW BILL OF RIGHTS

As Australia's most reliable supplier of customised commercial water control products, and machined casting services, we believe if you are not directly serving a customer, you better be serving someone who is!

We also believe our customers have the right to expect:

- That all promises and commitments will be kept.
- Dedicated service, expert knowledge and professional back-up support.
- To be told the truth, and to be treated with dignity and respect.
- Quality, satisfaction and value from our products and services.
- To have calls, faxes and emails returned promptly, especially when they involve a complaint or problem.
- That orders are delivered intact, on time, every time.



## ROUND Floor Drain Grate Assemblies and Slip-Safe Bolted Cleanouts

Ideal for use in:

- Apartments
- Hotels
- Offices
- Shopping Centres
- Universities
- Car Parks
- Schools
- Factories

Material	A(Nom)	B	C	D	Drain Item #	Cleanout Item #
	Top	Outlet	Depth	Height		
<b>Threaded BSP</b>						
NI-BZ	100	50	40	61	302315	-
ST/ST	100	50	40	61	302315SS	-
NI-BZ	100	80	40	58	302323	67678
NI-BZ	150	80	40	71	302331	-
NI-BZ	150	100	40	63	302349	67686
ST/ST	150	100	40	63	302349SS	-
NI-BZ	200	100	40	76	302356	-
NI-BZ	200	150	40	66	302359	67687
NI-BZ	300	100	40	100	302364	-
NI-BZ	300	150	40	84	302372	-
<b>Slip-In to PVC</b>						
NI-BZ	100	50	25	53	302376	-
NI-BZ	100	65	25	43	-	67706
NI-BZ	100	80	25	43	302380	67710
NI-BZ	150	100	25	53	302385	67717
ST/ST	150	100	25	53	302385SS	67717SS
<b>Slip-In to CU</b>						
NI-BZ	100	65	25	43	-	67691
NI-BZ	100	80	25	43	302398	67694
NI-BZ	150	100	25	53	302402	67698
<b>Slip-In to HDPE</b>						
NI-BZ	100	65	25	43	-	67728
NI-BZ	100	80	25	43	302406	67732
NI-BZ	150	100	25	53	602410	67736
ST/ST	150	100	25	53	302410SS	67736SS
<b>EXTRAS</b>						
					303107	67660
					-	67668

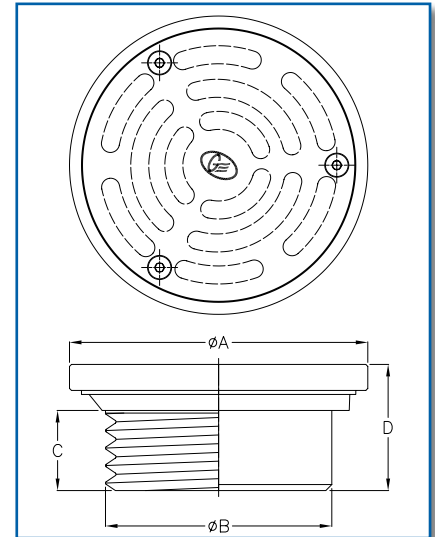
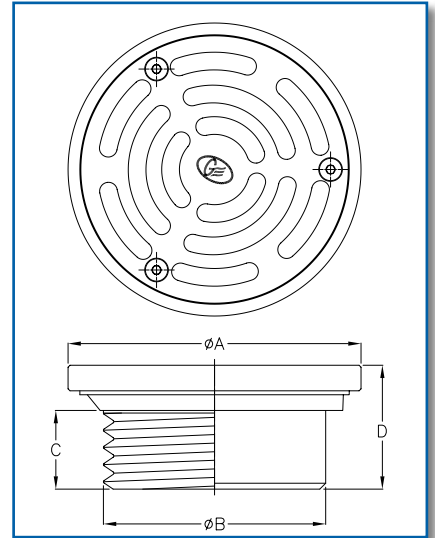

## PRISON Safe Cell® Floor Drain Grate Assemblies

Ideal for use in:

- Prisons
- Institutions
- Safe-Cell® Lockups
- Public Utilities

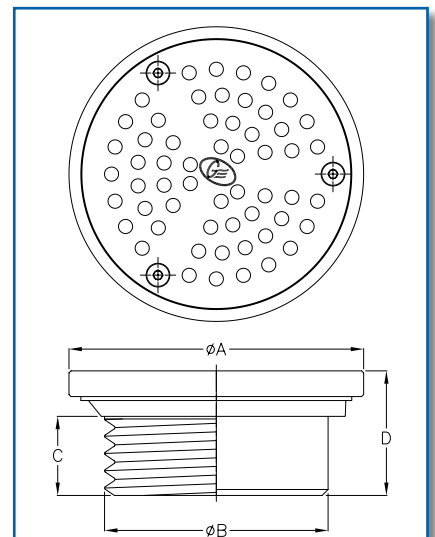

Material	A (Nom)	B	C	D	Drain Item#
	Top	Outlet	Depth	Height	
<b>Threaded BSP</b>					
NI-BZ	100	80	46	50	302992
NI-BZ	150	100	40	63	303016

## VINYL

## Floor Drain Grate Assemblies and Slip-Safe Bolted Cleanouts

Ideal for use in:

- Hospitals
- Universities
- Supermarkets
- Commercial Kitchens
- Aged Care Homes
- Laboratories

Material	A(Nom)	B	C	D	Drain	Cleanout
	Top	Outlet	Depth	Height	Item #	Item #
<b>Threaded BSP</b>						
NI-BZ	100	50	40	75	303115	-
CP/BS	100	50	40	75	303354	-
NI-BZ	100	80	40	63	303123	69401
CP/BS	100	80	40	63	303358	-
NI-BZ	150	80	40	87	303131	-
CP/BS	150	80	40	87	303362	-
NI-BZ	150	100	40	73	303149	69408
CP/BS	150	100	40	73	303367	-
NI-BZ	200	100	40	102	303156	-
CP/BS	200	100	40	102	303370	-
NI-BZ	200	150	40	77	303164	-
CP/BS	200	150	40	77	303374	-
<b>Slip-In to PVC</b>						
NI-BZ	100	50	25	68	303172	-
CP/BS	100	50	25	68	303388	-
NI-BZ	100	65	25	52	-	69450
NI-BZ	100	80	25	53	303176	69457
CP/BS	100	80	25	53	303392	-
NI-BZ	150	80	25	76	303180	-
CP/BS	150	80	25	76	303396	-
NI-BZ	150	100	25	64	303198	69468
CP/BS	150	100	25	64	303400	-
<b>Slip-In to CU</b>						
NI-BZ	100	50	25	68	303201	-
CP/BS	100	50	25	68	303409	-
NI-BZ	100	65	25	52	-	69427
NI-BZ	100	80	25	53	303203	69431
CP/BS	100	80	25	53	303412	-
NI-BZ	150	80	25	76	303206	-
CP/BS	150	80	25	76	303416	-
NI-BZ	150	100	25	64	303210	69435
CP/BS	150	100	25	64	303420	-
<b>Slip-In to HDPE</b>						
NI-BZ	100	50	25	68	304105	-
CP/BS	100	50	25	68	304006	-
NI-BZ	100	65	25	52	-	69484
NI-BZ	100	80	25	53	304113	69487
CP/BS	100	80	25	53	304014	-
NI-BZ	150	80	25	76	304139	-
CP/BS	150	80	25	76	304030	-
NI-BZ	150	100	25	64	304147	69492
CP/BS	150	100	25	64	304048	-
<b>EXTRAS</b>						
Extra for chrome plating					303107	67660
Extra for gas-tight lid					-	67668

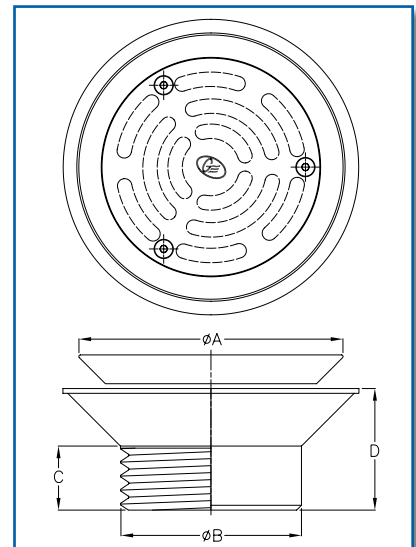
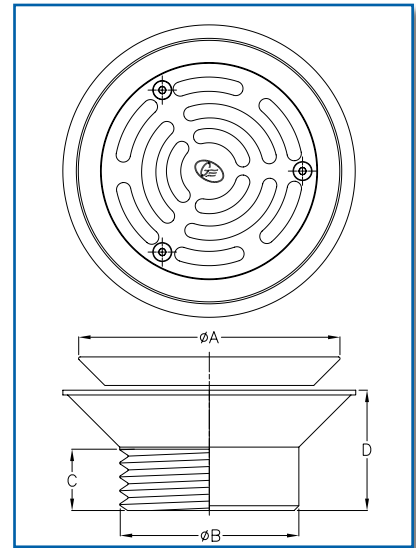

## SQUARE Floor Drain Grate Assemblies

Ideal for use in:

- Apartments
- Commercial Kitchens
- Offices
- Shopping Centres
- Hotels

Material	A(Nom)		C	D	Drain Item #
	Top	B			
<b>Threaded BSP</b>					
NI-BZ	100	50	40	60	302711
ST/ST	100	50	40	60	302711SS
NI-BZ	100	80	40	60	302729
NI-BZ	150	80	40	70	302737
NI-BZ	150	100	40	66	302745
ST/ST	150	100	40	66	302745SS
NI-BZ	200	100	40	76	302752
ST/ST	200	100	40	76	302752SS
NI-BZ	200	150	40	69	302756
NI-BZ	300	100	40	103	302760
NI-BZ	300	150	40	84	302778
<b>Slip-In to PVC</b>					
NI-BZ	150	100	25	57	302794P
<b>Slip-In to CU</b>					
NI-BZ	150	100	25	57	302794C
<b>EXTRAS</b>					
Extra for chrome plating					303107

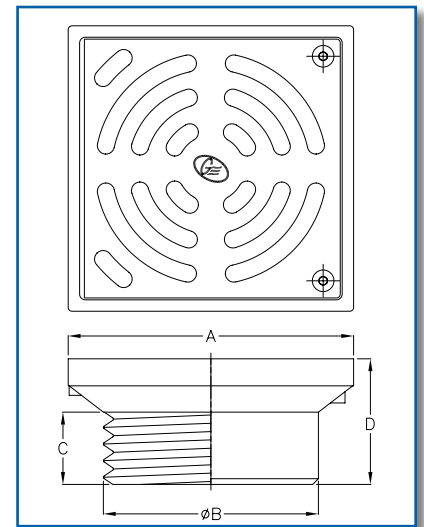

## PLANTER BOX Planter Box Assembly

Ideal for use in:

- Planter Boxes
- Suspended Soil Floors

Material	A(Nom)		C	D	Drain Item #
	Top	B			
<b>Threaded BSP</b>					
PVC	80	80	35	1200	303430
PVC	100	100	25	1200	303446

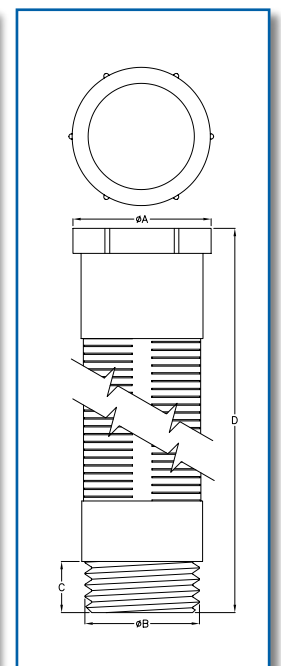
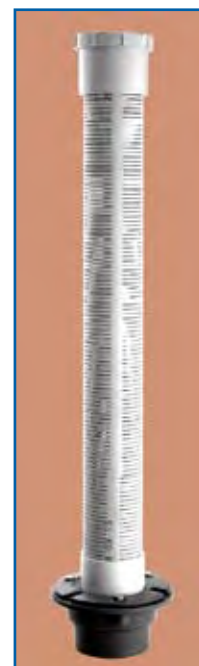

## STANDARD CI Floor Drain Body Assemblies

Ideal for use in:

- Suspended Flooring Using Integral Membranes
- Bucket Trap Situations

B Inlet (Min/Max)	E Outlet	F Width	G Height (Min/Max)	Body Item #
<b>Threaded BSP</b>				
50/80	50	170	90/115	301515
50/80	80	170	90/115	301523
80/100	100	205	115/130	301531
100/150	150	250	115/130	301549
<b>Slip-On to PVC/HDPE</b>				
50/80	50	170	90/115	301564
50/80	80*	170	90/115	301572
80/100	100	205	115/130	301580
100/150	150	250	115/130	301589
(Note: * will not take 80 HDPE)				
<b>Slip-On to CU</b>				
50/80	50	170	90/115	301614
50/80	80	170	90/115	301622
80/100	100	205	115/130	301630
100/150	150	250	115/130	301648

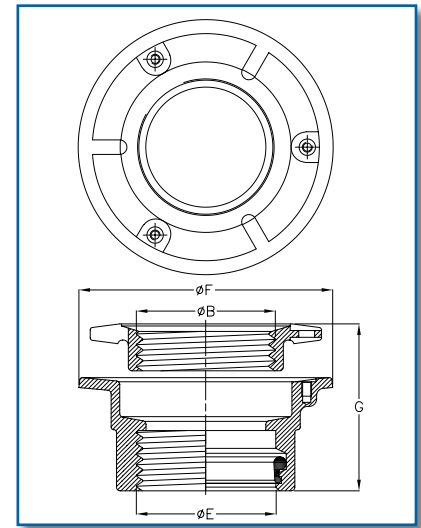

## DEEP CI Floor Drain Body Assemblies

Ideal for use in:

- Bucket Trap Situations

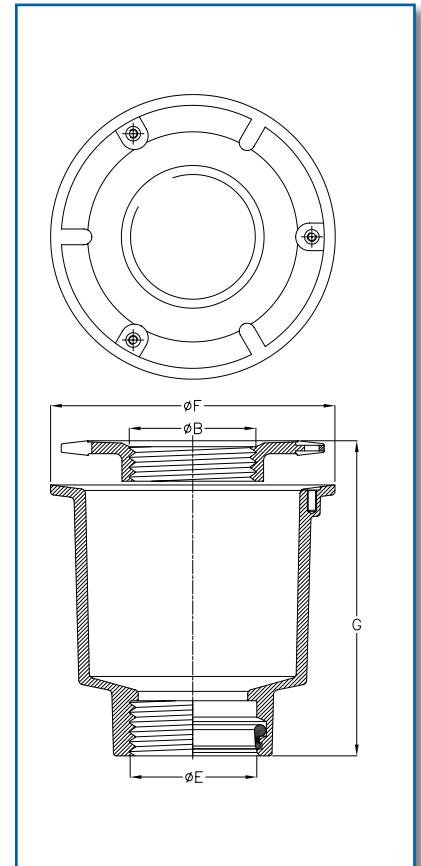

B Inlet (Min/Max)	E Outlet	F Width	G Height (Min/Max)	Body Item #
<b>Threaded BSP</b>				
100/150	100	253	250/275	302067
100/150	150	253	250/275	302070
<b>Slip-On to PVC/HDPE</b>				
100/150	100	253	250/275	302071
100/150	150	253	250/275	302075
<b>Slip-On to CU</b>				
100/150	100	253	250/275	302083
100/150	150	253	250/275	302091



## HORIZONTAL CI Floor Drain Body Assemblies

Ideal for use in:

- Suspended Flooring Using Integral Membranes
- Thick Slab Balconies

B Inlet (Min/Max)	E Outlet	F Width	G Height (Min/Max)	Body Item #
<b>Threaded BSP</b>				
50/80	50	170	115/145	301812
50/80	80	170	145/170	301820
80/100	100	205	180/205	301838
100/150	150	255	230/255	301846
<b>Slip-On to PVC/HDPE</b>				
50/80	50	170	115/145	301861
50/80	80*	170	145/170	301879
80/100	100	205	180/205	301887
100/150	150	255	230/255	301895
(Note: * will not take 80 HDPE)				
<b>Slip-On to CU</b>				
50/80	50	170	115/145	301911
50/80	80	170	145/170	301929
80/100	100	205	180/205	301937
100/150	150	255	230/255	301945

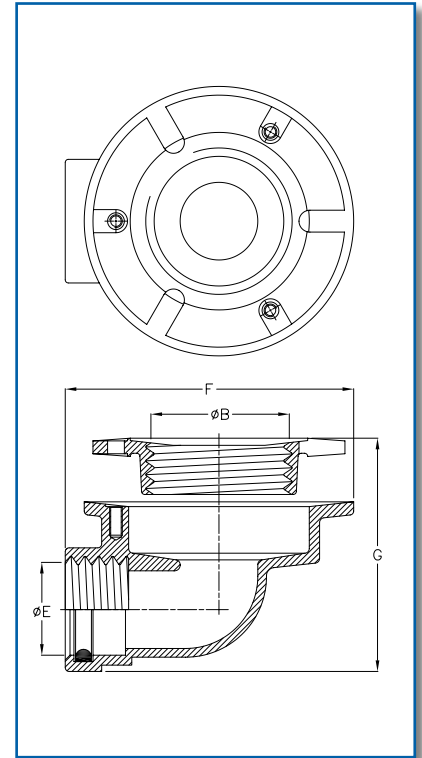

## BALCONY CI Floor Drain Body Assemblies

Ideal for use in:

- Thin Slab Balconies

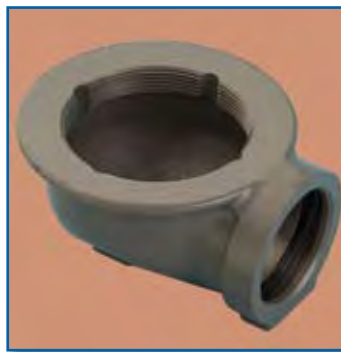

B Inlet	E Outlet	F Width	G Height	Body Item #
<b>Slip-On to PVC/HDPE</b>				
80	50	146	76	302104P
<b>Slip-On to CU</b>				
80	50	146	76	302104C

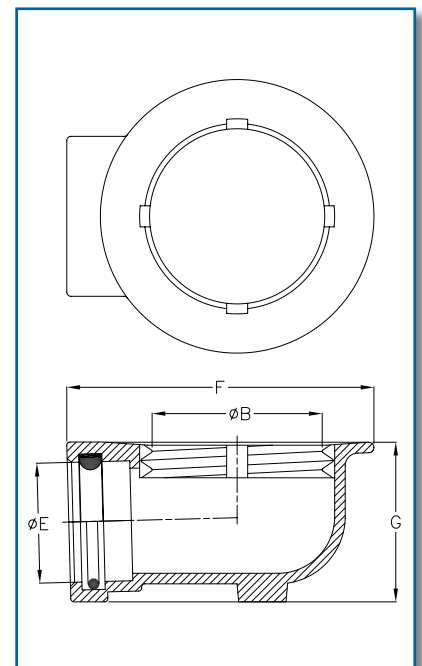

## ECONOMY

## uPVC Floor Drain Couplings (Economy Body Assemblies)

Ideal for use in:

- Ground Floor Application

B Inlet	E Outlet	H Depth	G Height	Coupling Item #
<b>Slip-On to PVC</b>				
50	50	25	60	302117
80	80	40	80	302125
100	100	40	100	302133
100*	100	40	193	302136
150	150	40	100	302141

(Note: \* has a built in secondary strainer)

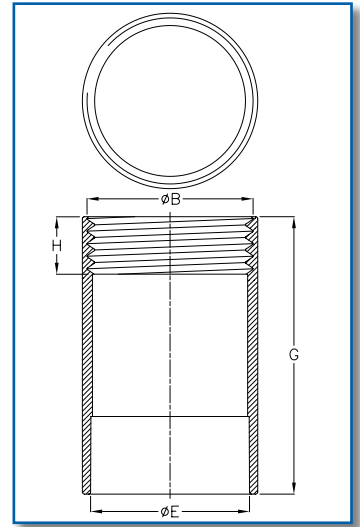
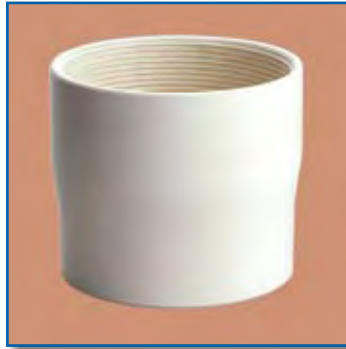

## ACCESSORIES

## S/S Strainer Baskets & Sediment Buckets

Ideal for use in:

- Bucket Trap Situations

### Strainer Baskets

- To Suit Grate Assembly

I (Nom) Diameter	J Length	Accessory Items
100	125	303636
150	165	303644

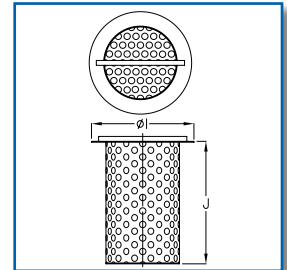

### Sediment Buckets

- To Suit Grate Assembly

I (Nom) Diameter	J Length	Accessory Items
100	125	303610

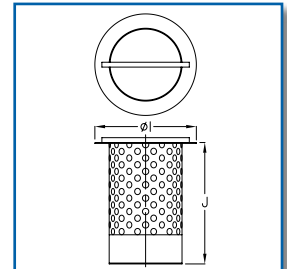

### Fixed Secondary Strainer Basket

- To Suit Standard Body Assembly

I (Nom) Diameter	J Length	Accessory Items
100	125	303636
150	165	303644

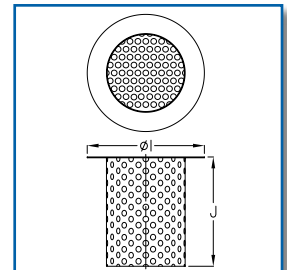

### Secondary Strainer Disc

- To Suit Deep Body Assembly

I (Nom) Diameter	J Length	Accessory Items
100 & 150		303719

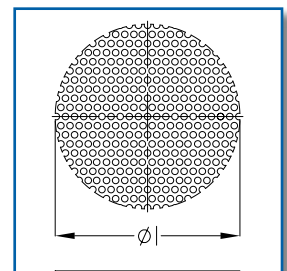

## VERTICAL COMBO'S Floor Drain Grates & Economy Body Assemblies

Ideal for use in multi storey applications such as:

- Car Parks
- Sporting Venues
- Factories
- Schools
- Universities

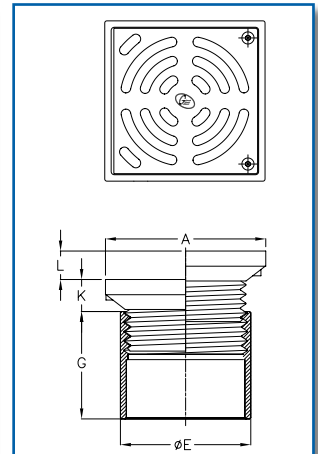
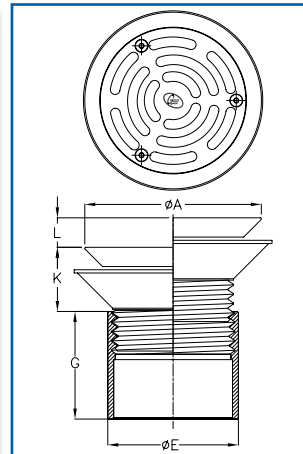
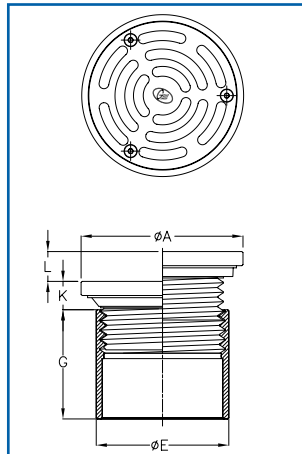

A (Nom) Top	E Outlet	G Body Height	K Grate Height (min)	L Adj
<b>Slip-On to PVC</b>				
150	100	100	20	35
200	100	100	36	35
300	100	100	60	35
300	150	100	44	35

Round Combo #	Vinyl Combo #	Square Combo #
DV4E06R	DV4E06V	DV4E06S
DV4E08R	DV4E08V	DV4E08S
DV4E12R		DV4E12S
DV6E12R		DV6E12S

## VERTICAL COMBO'S Floor Drain Grates & Economy Body Assemblies

Ideal for use in multi storey applications such as:

- Office Towers
- Hotels
- Apartment Blocks
- Hospitals
- Shopping Centres

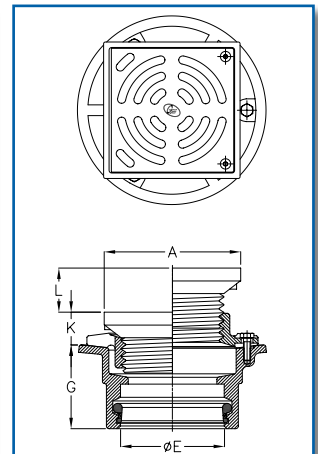
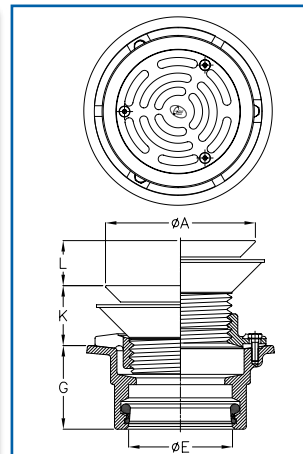
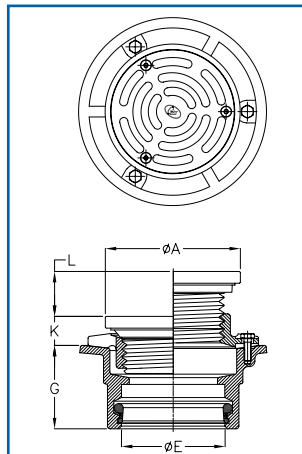

A (Nom) Top	E Outlet	G Body Height	K Grate Height (min)	L Adj
<b>Slip-On to PVC/HDPE</b>				
100	50	85	21	60
100	80	80	18	60
150	100	95	20	58
200	100	95	36	58
200	150	95	36	58
300	100	95	60	58
300	150	95	44	58

Round Combo #	Vinyl Combo #	Square Combo #
DV2S04R	DV2S04V	DV2S04S
DV3S04R	DV3S04V	DV3S04S
DV4S06R	DV4S06V	DV4S06S
DV4S08R	DV4S08V	DV4S08S
DV6S08R	DV6S08V	DV6S08S
DV4S12R	-	DV4S12S
DV6S12R	-	DV6S12S

## HORIZONTAL COMBO'S

## Floor Drain Grates & Standard Body Assemblies

Ideal for use in multi storey applications such as:

- Office Towers
- Hotels
- Apartment Blocks
- Hospitals
- Shopping Centres

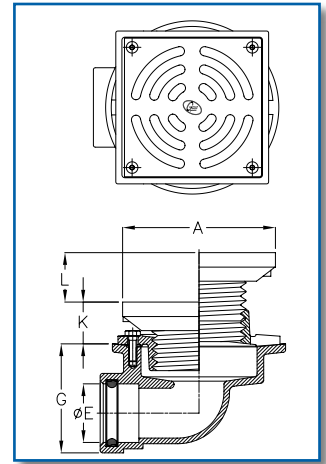
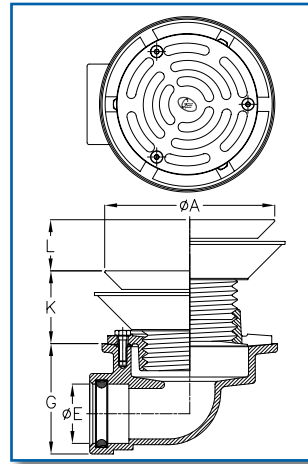
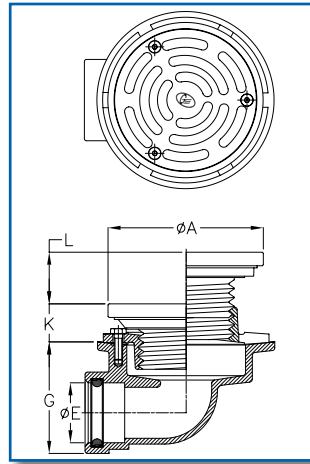

A (Nom) Top	E Outlet	G Body Height	K Grate Height (min)	L Adj
<b>Slip-On to PVC/HDPE</b>				
100	50	115	18	60
150	100	180	20	58

Round Combo #	Vinyl Combo #	Square Combo #
DH2S04R	DH2S04V	DH2S04S
DH4S06R	DH4S06V	DH4S06S

## HORIZONTAL COMBO'S

## Floor Drain Grates & Balcony Body Assemblies

Ideal for use in multi storey applications with thin slabs such as:

- Hotels
- Apartment Blocks

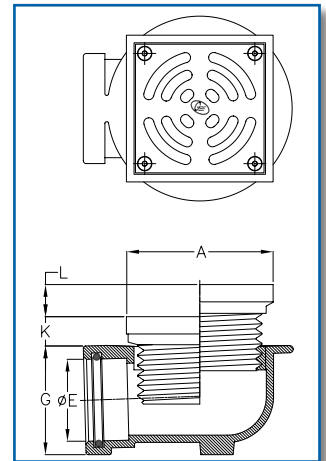
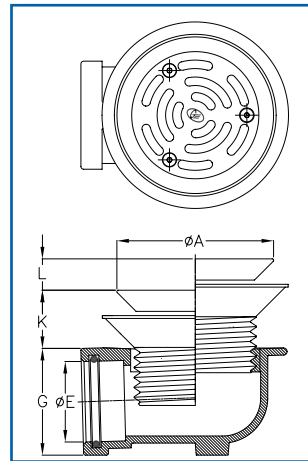
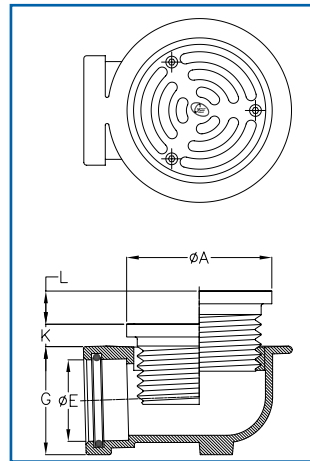

A (Nom) Top	E Outlet	G Body Height	K Grate Height (min)	L Adj
<b>Slip-On to PVC/HDPE</b>				
100	50	75	21	35

Round Combo #	Vinyl Combo #	Square Combo #
DH2B04R	DH2B04V	DH2B04S

## BUCKET TRAP COMBO'S Floor Drain Grates & Standard Body Assemblies with Strainer

Ideal for use in commercial kitchens in:

- Restaurants
- Supermarkets
- Hotels
- Entertainment Facilities
- Fast Food Outlets
- Food Preparation Areas

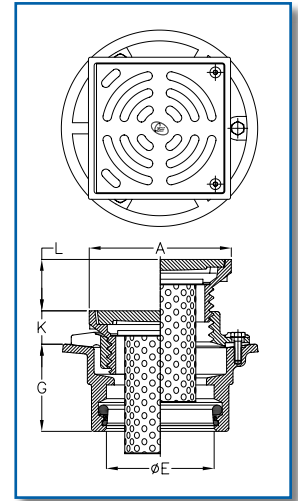
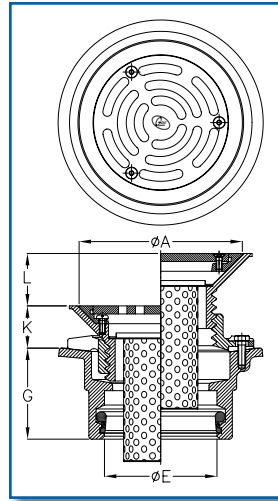
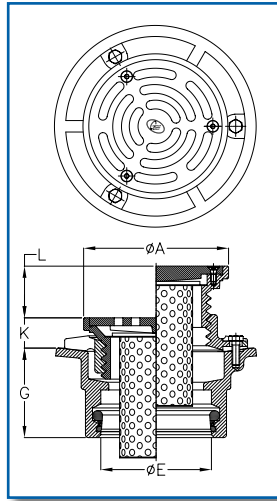
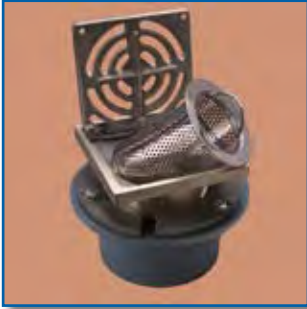

A (Nom) Top	E Outlet	G Body Height	K Grate Height (min)	L Adj	Round Combo #	Vinyl Combo #	Square Combo #
<b>Slip-On to PVC/HDPE</b>					DB4S06R	DB4S06V	DB4S06S
150	100	95	44	58			

## BUCKET TRAP COMBO'S Floor Drain Grates & Deep Body Assemblies with Dual Strainers

Ideal for use in commercial kitchens in:

- Restaurants
- Supermarkets
- Hotels
- Entertainment Facilities
- Food Preparation Areas

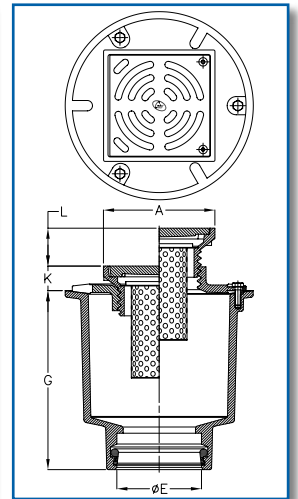
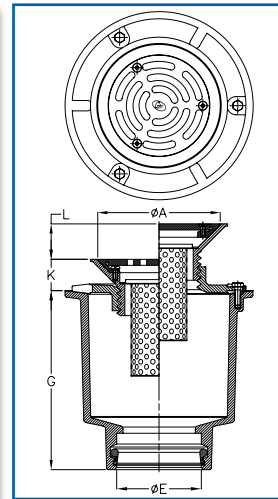
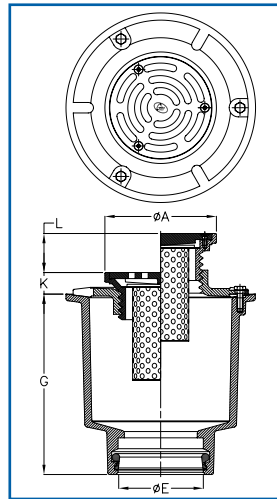

A (Nom) Top	E Outlet	G Body Height	K Grate Height (min)	L Adj	Round Combo #	Vinyl Combo #	Square Combo #
<b>Slip-On to PVC/HDPE</b>					DB4D08R	DB4D08V	DB4D08S
200	100	240	36	35			
300	100	240	60	35	DB4D12R	-	DB4D12S
<b>Extras</b>					303735	303735	303735
Extra for Fixing Strainer Basket to Floor Drain							



## INDUSTRIAL TRAP COMBO'S

## Floor Drain Grates Assemblies with Strainer

Ideal for use in ground floor industrial areas such as:

- Food Preparation Areas
- Abattoirs
- Canteens
- Factories
- Commercial Kitchens

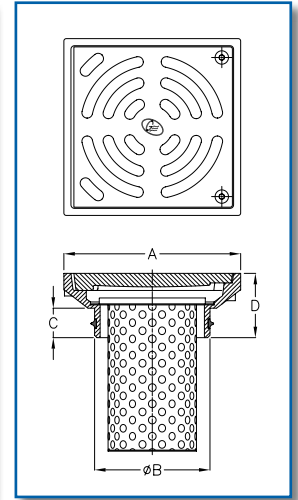
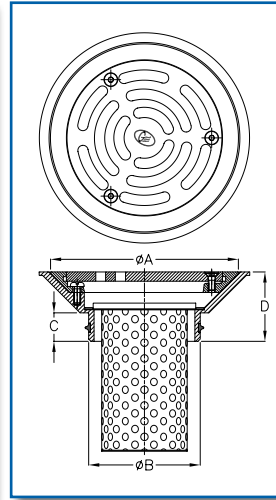
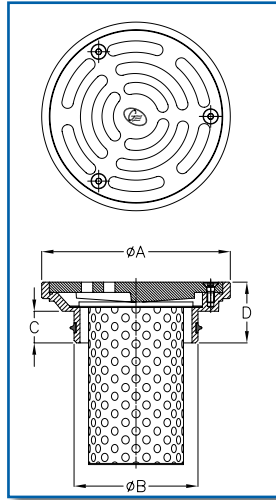

A (Nom)	B Outlet	C Depth	D Height	Round Combo #	Vinyl Combo #	Square Combo #
<b>Top</b>						
<b>Slip-On to PVC/HDPE</b>						
150	100	25	53	DI4S06R	DI4S06V	DI4S06S

## INDUSTRIAL TRAP COMBO'S

## Floor Drain Grate Assemblies with Dual Strainers

Ideal for use in ground floor industrial areas such as:

- Food Preparation Areas
- Abattoirs
- Canteens
- Factories
- Fast Food Outlets

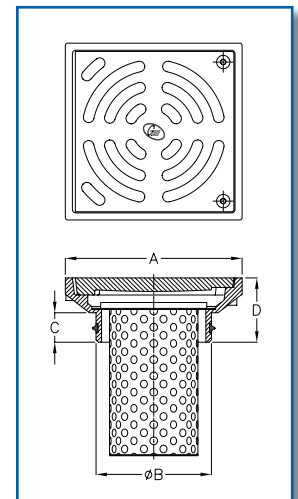

A (Nom)	B Outlet	C Depth	D Height	Round Combo #	Vinyl Combo #	Square Combo #
<b>Top</b>						
<b>Slip-On to PVC/HDPE</b>						
150	100	25	53	DI4M06R	DI4M06V	DI4M06S

## PLANTER BOX COMBO'S

## Planter Box Drains & Standard Body Assemblies

Ideal for use in:

- Planter Boxes
- Suspended Soil Floors

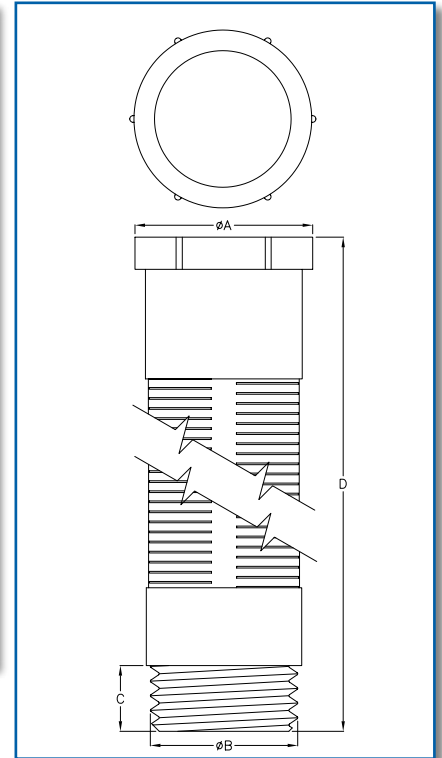
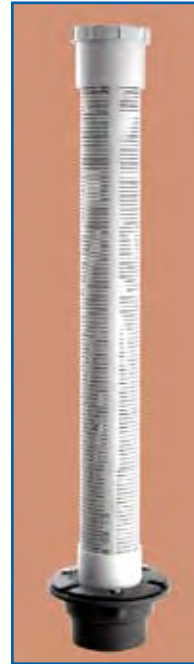

A (Nom) Top	E Outlet	G Body Height	K Planter Box Drain Height	L Adj
<b>Slip-in to PVC</b>				
80	80	80	1165	30
100	100	95	1175	20

Planter Combo #
DV3S03P
DV4S04P

## SPECIAL APPLICATION UNITS

## Square Inspection Covers

Ideal for use in:

- Supermarkets
- Shopping Centres
- Hotels
- Offices

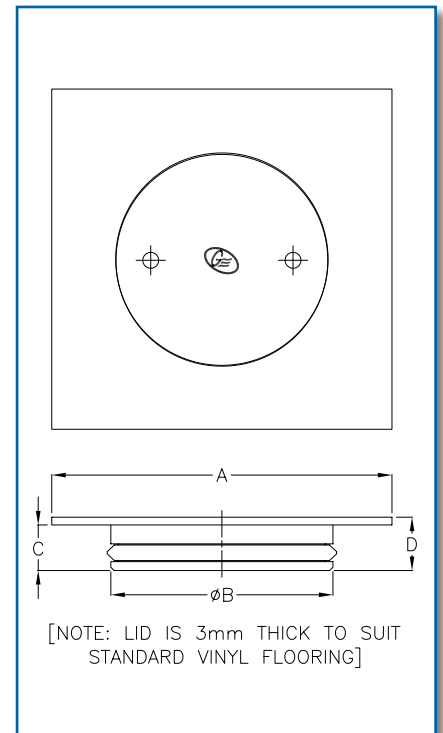

Material	A (Nom) Top	B Outlet	C Depth	D Height
<b>Slip-In to PVC/HDPE</b>				
Brass	150	100	21	24
<b>Slip-In to CU</b>				
Brass	150	100	21	24
<b>Extras</b>				
Extra for chrome plating				

Inspection Cover Item#
67050P
67050C
67660



## MAJOR PROJECTS



Sydney Opera House - NSW, Australia



Parliament House - Canberra, Australia



Watergate Apartments- Vic, Australia



National Museum of Australia - Canberra, Australia



Burswood Casino - WA, Australia



University of Western Australia

Whilst all reasonable care has been taken in compiling the information in this document, the designs, dimensions and products shown are indicative only and should not be relied upon without our prior approval. Due to our policy of continuous development, we reserve the right to alter any details of specifications or products without notice. All information, drawing, technical specifications and product designs remain the property of Galvin Engineering Pty Ltd.

**WA - GE HEAD OFFICE**  
Phone: 08 9249 5900  
Fax: 08 9249 5916

**QLD - GE BRANCH**  
Phone: 07 5540 7467  
Fax: 07 5540 7542

**NT - RHINO**  
Phone: 08 8947 3400  
Fax: 08 8947 3656

**NSW/ACT - GE BRANCH**  
Phone: 02 9681 1366  
Fax: 02 9681 1477

**VIC/TAS - GE BRANCH**  
Phone: 03 9580 6622  
Fax: 03 9580 4144

**SA - GE BRANCH**  
Phone: 1800 006 790  
Fax: 1800 006 690

### GALVIN ENGINEERING PTY LTD

*Customised commercial water control products and machined casting services*

410 Victoria Road, Malaga, Western Australia, 6090  
PO Box 2063, Malaga, Western Australia, 6944  
Phone: 61 8 9249 5900 Fax: 61 8 9249 5916

Website: [www.galvinengineering.com.au](http://www.galvinengineering.com.au) Email: [sales@galvinengineering.com.au](mailto:sales@galvinengineering.com.au)  
ISO9001 certification excludes sites other than Perth

ABN 78 008 719 382 © Galvin Engineering Pty Ltd: 2008 (Issue 5/2008)

