



The Complete Comfort Solution

SPEEDHEAT creates an extremely comfortable home throughout winter at a lesser cost than conventional electric heating.

Floor heating is comfortable because the warmth is generated at your feet, the parts of your body that feel the cold most. There are no draughts or uncomfortably hot areas. This sophisticated system can be installed directly under just about any floor finish without fuss.



Coax Heating Wire

Multi stranded self correcting heating element

Primary Tefzel® insulation tested at 5000 Volts

Full earth screen

Secondary Tefzel® insulation to prevent corrosion



Tefzel® is a trademark of DuPONT

Advantages

- **Response time** is from 15-30 minutes - the heat is distributed evenly throughout the room within 1 hour of switching on.
- **Quick and easy installation** directly under new floor finishes or existing carpets/rugs.
- **Economical** - Speedheat floor surface heating costs far less to run than conventional electric in-slab heating due to quick response time and reduced wattage/m².
- **Environmentally friendly** - no smoke, no fumes, no dust, no EMR (Electro Magnetic Radiation)

- **Safety** - waterproof, earthed and self correcting heating element.
- **Allergy friendly** - does not emit V.O.C.'s (volatile organic compounds) whilst gas heaters emit nitrogen oxides (See pg. 58, The Builder Jan 2000).
- **Thermostatic control** - each room is controlled individually.
- **No aesthetic compromise** - Nothing is visible and nothing needs storage in summer.
- **No maintenance.**
- **Guarantee on product and installation.**

Thermostats

SPEEDHEAT is thermostatically controlled for ease of use and regulating comfort levels. Choose the manually controlled thermostat



with floor sensor or enjoy the advantages of a 7 day programmable model with either air or floor temperature sensors to regulate the comfort level.

ECONOMY

The Applications

SPEEDHEAT can be installed under just about any new floor finish: ceramic tiles, natural stone, slate or marble, vinyl, laminate timber as well as new or existing carpets or loose lay rugs.

The quick response time and low power requirements of SPEEDHEAT promote the economic use of electricity as a power source, contributing greatly to the benefits of sustainable design and efficient energy use. Minimising the use of electricity in turn, has environmental benefits by minimising greenhouse gases.

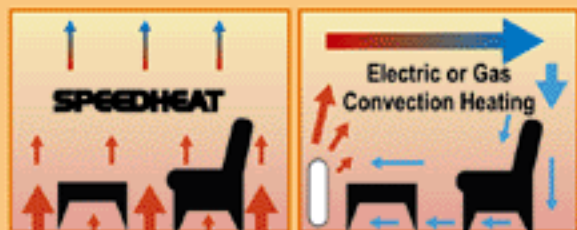

Thousands of happy clients throughout Australia recommend SPEEDHEAT. It is suitable for homes, bathrooms, aged care, boats, agriculture, kennels, institutional buildings, churches - the options are endless.

The SPEEDHEAT system offers comfort, economy, efficiency, control and peace of mind because heating systems designed and installed by our professional team of franchises have a warranty on product as well as the installation.

Product Safety Compliance

- AS/NZS 3000:2000 clause 4.3.8.2.
- IEC 60335-2-81 IEC:1997
- UL listing no. E237856
- EN ISO 9001:2000. Manufacturer's registration no: DE-261368QM

COMFORT



EFFICIENCY

Tile Heater Installation Process

1. Stick down self adhesive heater.



2. Stick down self adhesive mesh.



3. Ready for tiling.



Carpet Heater Installation Process

1. Position heater on top of the carpet underlay.



2. Fix edges with self adhesive tape.



3. Ready for carpeting.



CONTROL

Timber Laminate Installation Process

1. Position underlay.

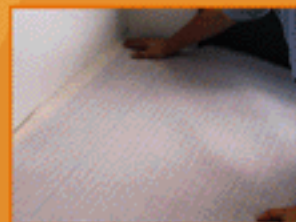

2. Position heater on top of underlay.



3. Ready for timber laminate installation.



Rug Heater Installation Process

1. Position non-slip underlay.



2. Fix edges with self adhesive tape.



3. Position rug over heater.



Typical Installation

The plan below shows how tile, carpet, rug & laminate timber heating may be installed. The temperature in every room is individually controlled by means of a thermostat.

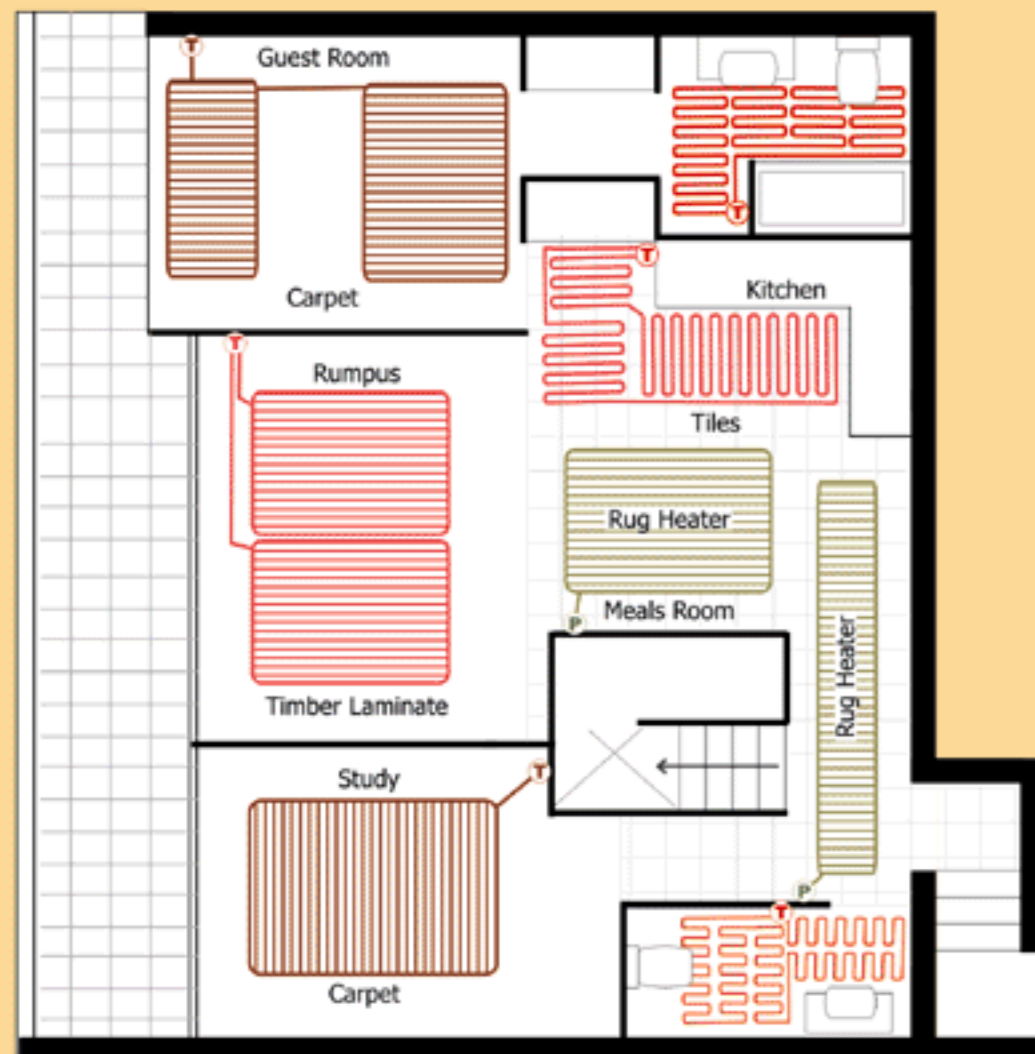

Tile Strip Heater Range

All heaters have a 2.5m long supply cord which must be connected to earth and through an earth leakage circuit breaker (RCD or Safety Switch). Heaters are pre configured on double sided adhesive tape and can be easily reconfigured to suit the room layout. See typical installation on back page.

Item No.	Heater Size	Suitable for Room Size *	Capacity @ 230V	Wattage m ²	Tile & Stone	Vinyl & Timber
AU1375/20W	0.90 x 7.56m	18-28m ²	1375W	200W/m ²	•	
AU1375/13W	0.90 x 11.16m	18-28m ²	1375W	130W/m ²	•	•
AU1100/20	0.60 x 8.96m	15-22m ²	1100W	200W/m ²	•	
AU1100/13	0.60 x 13.02m	15-22m ²	1100W	130W/m ²	•	•
AU1100/20W	0.90 x 6.09m	15-22m ²	1100W	200W/m ²	•	
AU1100/13W	0.90 x 8.94m	15-22m ²	1100W	130W/m ²	•	•
AU850/20	0.60 x 6.90m	11-17m ²	850W	200W/m ²	•	
AU850/13	0.60 x 10.08m	11-17m ²	850W	130W/m ²	•	•
AU850/20W	0.90 x 4.72m	11-17m ²	850W	200W/m ²	•	
AU850/13W	0.90 x 6.90m	11-17m ²	850W	130W/m ²	•	•
AU650/20	0.60 x 5.56m	9-13m ²	650W	200W/m ²	•	
AU650/13	0.60 x 8.10m	9-13m ²	650W	130W/m ²	•	•
AU500/20	0.60 x 4.40m	2.60m ²	500W	200W/m ²	•	
AU500/13	0.60 x 6.36m	3.80m ²	500W	130W/m ²	•	•
AU375/20	0.45 x 4.08m	1.80m ²	375W	200W/m ²	•	
AU375/13	0.45 x 5.80m	2.60m ²	375W	130W/m ²	•	•
AU250/20	0.30 x 4.12m	1.20m ²	250W	200W/m ²	•	
AU250/13	0.30 x 5.70m	1.70m ²	250W	130W/m ²	•	•
AU200/20	0.30 x 3.20m	0.90m ²	200W	200W/m ²	•	
AU200/13	0.30 x 4.44m	1.40m ²	200W	130W/m ²	•	•
AU150/20	0.30 x 2.48m	0.75m ²	150W	200W/m ²	•	
AU150/13	0.30 x 3.54m	1.10m ²	150W	130W/m ²	•	•

- * • Smaller room size for living rooms & larger room size for bedrooms
- 150-500W heaters are actual areas - usually bathrooms
- For room sizes larger than 18-28m², use multiple heaters

Heating Guidelines

Temp. Lift C (from - to)	LIVING ROOM		BEDROOM	
	0 to 20	-5 to 20	0 to 17	-5 to 17
Characteristics:				
A. Well Built, Good Insulation	50W	65W	40W	55W
B. Average Built, With Insulation	55W	75W	50W	60W
C: Poorly Built, No Insulation	70W	85W	60W	75W

NOTE:

If only one room is heated increase by at least 10%.

If room is South facing increase by at least 20%.

CALCULATION EXAMPLE: Lounge room = 4.5 x 5.5m = 24.75m² @ 75 Watts/m² = 1856 Watt
Bedroom = 4 x 4.5m = 18.00m² @ 50Watts/m² = 900 Watt

If Bedroom is South facing and is the only room heated add 20% + 10% = 30% (900 Watt x 130% = 1170 Watt). NB. For open plan calculate for TOTAL area.

THE ABOVE FORMULAS ARE A GUIDELINE TO ALLOW YOU TO ESTIMATE YOUR REQUIREMENTS. HEAT LOSSES DEPEND ON VARIOUS FACTORS AND OUR FRANCHISES ARE TRAINED TO CALCULATE THE EXACT CAPACITY REQUIRED

Carpet Panel Heater Range

All heaters have a 6 metre long supply cord, which must be connected to earth and through an earth leakage circuit breaker (RCD or Safety Switch).

Item No.	Heater Size	Suitable for Room Size *	Capacity @ 230V	Wattage m ²	Carpet	Timber & Laminate
P 1150/16	2.00 x 3.60m	15-23m ²	1150W	160W/m ²	•	
P 1000/12	2.00 x 4.00m	13-20m ²	1000W	125W/m ²	•	•
P 900/16	2.00 x 2.85m	12-18m ²	900W	160W/m ²	•	
P 715/12	2.00 x 2.85m	9-14m ²	715W	125W/m ²	•	•
P 775/16	1.80 x 2.70m	10-15m ²	775W	160W/m ²	•	
P 600/12	1.80 x 2.70m	8-12m ²	600W	125W/m ²	•	•
P 700/16	2.00 x 2.20m	9-14m ²	700W	160W/m ²	•	
P 550/12	2.00 x 2.20m	7-11m ²	550W	125W/m ²	•	•
P 575/16	1.60 x 2.30m	8-12m ²	575W	160W/m ²	•	
P 460/12	1.60 x 2.30m	6-9m ²	460W	125W/m ²	•	•
P 575/16L	1.00 x 3.60m	8-12m ²	575W	160W/m ²	•	
P 500/12L	1.00 x 4.00m	7-10m ²	500W	125W/m ²	•	•
P 450/16	1.30 x 2.20m	6-9m ²	450W	160W/m ²	•	
P 360/12	1.30 x 2.20m	5-7m ²	360W	125W/m ²	•	•
P 450/16L	1.00 x 2.85m	6-9m ²	450W	160W/m ²	•	
P 360/12L	1.00 x 2.85m	5-7m ²	360W	125W/m ²	•	•
P 450/16P	0.65 x 4.40m	6-9m ²	450W	160W/m ²	•	
P 360/12P	0.65 x 4.40m	5-7m ²	360W	125W/m ²	•	•
P 350/16	1.00 x 2.20m	5-7m ²	350W	160W/m ²	•	
P 275/12	1.00 x 2.20m	4-6m ²	275W	125W/m ²	•	•
P 250/16	1.00 x 1.60m	3-5m ²	250W	160W/m ²	•	
P 200/12	1.00 x 1.60m	3-4m ²	200W	125W/m ²	•	•
P 250/16L	0.65 x 2.45m	3-5m ²	250W	160W/m ²	•	
P 200/12L	0.65 x 2.45m	3-4m ²	200W	125W/m ²	•	•
P 900/16AT	1.0 & 1.6 x 2.2m	15-18m ²	900W	160W/m ²	•	
P 715/12AT	1.0 & 1.6 x 2.2m	12-14m ²	715W	125W/m ²	•	•
P 700/16T	1.00 x 2.20m (x2)	12-14m ²	700W	160W/m ²	•	
P 550/12T	1.00 x 2.20m (x2)	9-11m ²	550W	125W/m ²	•	•
P 450/16T	0.65 x 2.20m (x2)	7-9m ²	450W	160W/m ²	•	
P 360/12T	0.65 x 2.20m (x2)	6-7m ²	360W	125W/m ²	•	•

Rug Panel Heater Range

These heaters are supplied with a 2.5m long cord and are fitted with an in-line plug-in safety switch (RCD).

LARGE RUG	MEDIUM RUG	SMALL RUG	PASSAGE RUG	BEDSET RUGS
AURTP 630/12 1.80 x 2.80m 630W - 125W/m ²	AURTP 460/12 1.60 x 2.30m 460W - 125W/m ²	AURTP 300/12 1.30 x 1.90m 300W - 125W/m ²	AURTP 360/12P 0.65 x 4.40m 360W - 125W/m ²	AURTP 550/12T 1.00 x 2.20m (x2) 550W - 125W/m ²

Want to know more?

Our franchises are available to supply you with additional technical information or a free no obligation quotation.

SPEEDHEAT offers you a comfortable solution to your heating problems

www.speedheat.com.au
1800 85 75 65



SPEEDHEAT FLOOR HEATING

COMFORT FROM THE GROUND UP



You need to choose some form of heating.

But which one?