

HARDWOOD. WORKS HARD.



**STRONG
STABLE
SOLID**

Seasoned hardwood has been the trusted performer in the Australian building market for generations.

Both F17 and now SUPA17 seasoned hardwood are strong and straight, offering superior nail holding capabilities, integrity of form (consistent thickness) and no risk of delamination or swelling. Seasoned hardwood won't warp, even if it gets wet on-site. It is kiln dried, producing timber that is extremely durable, with maximum stability and dressed for a smooth finish.

Seasoned hardwood timber is ideally suited for all structural applications including lintels, structural beams, high strength truss members, stair components and sub-floors (bearers and joists).

Hardwood timber is also the perfect choice for interior or exterior decorative and exposed applications, such as windows, doors, mouldings, furniture, bench tops, cabinetry, flooring and verandas, offering a stunning and consistent appearance.

Victorian F17 and SUPA17 hardwood timber comes from sustainably-managed Victorian native forests. Hardwood is a superior quality product offering the peace of mind provided by a trusted and known product that will always outperform on any job. Cheap alternatives are just not worth the risk.

For more information visit www.hardwoodworks.info
Email: info@hardwoodworks.info or contact your supplier.



F17 / SUPA17

HARDWOOD. DON'T RISK A SUBSTITUTE.

HARDWOOD. HARD FACTS.

Frequently asked questions about seasoned hardwood timber

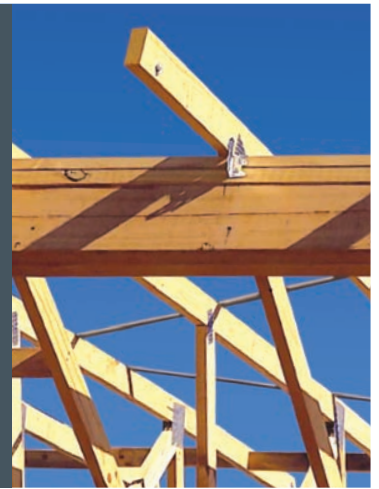
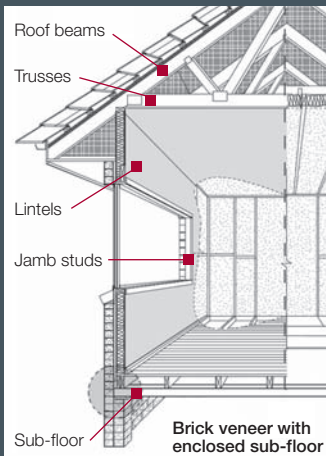

What are the solid benefits of seasoned structural (F17 and SUPA17) hardwood?

Seasoned structural hardwood (F17 and SUPA17) has been the trusted performer in the building market for generations, offering superior nail holding capabilities, integrity of form (ie consistent thickness and quality), no risk of delamination or swelling, and an attractive, consistent appearance for decorative or exposed applications. Solid seasoned hardwood is extremely strong and durable and will remain stable and won't warp, swell or flake, even if it gets wet on-site.

What applications is seasoned structural (F17 and SUPA17) hardwood suitable for?

F17 and SUPA17 seasoned hardwood are ideally suited for all structural applications including wall lintels over openings, high strength structural beams, highly loaded truss members, jamb studs, stair components and sub-floor construction (bearers and joists). This is evidenced by builders' acceptance of, and preference for, seasoned hardwood in these applications.

What's the difference between F17 and SUPA17?

Different timber species have different capacities to resist load and deflection. The amount of deflection of a length of timber is determined by its Modulus of Elasticity (MoE) – the higher the MoE the less the beam will deflect for the same load. It is a key design requirement for a beam in structural applications such as rafters, roof beams, lintels, floor joists and bearers.

F17 structural hardwood timber has a MoE of 14,000MPa

SUPA17 structural hardwood timber has an improved MoE of 16,000MPa, which outperforms the LVL 14 product.

What about price – isn't hardwood timber more expensive?

Hardwood is a superior quality product which offers a high level of value for money. The question really should be: "what price for peace of mind?" In essence 'you get what you pay for' – so why risk a cheap product with potential problems? Builders have already proved to themselves the value of investing to minimise risk. The upgrade from cheaper unseasoned F8 sub-floors to seasoned hardwood F17 sub-floors is a case in point – a little more money, but a big saving on call-backs.

How does F17's MoE compare to alternative products, such as LVL?

LVL has traditionally held a MoE of 13,200MPa. Recently, some Laminated Veneer Lumber (LVL) suppliers of imported or locally-produced LVL have increased the MoE of their products to 14,000MPa to purportedly match F17 hardwood timber.

Which is the most environmentally-friendly and sustainable solution?

Clearly timber is the most environmentally-friendly building product compared to alternatives such as steel, concrete, aluminum, bricks, etc. Timber is a product obtained from a natural resource – trees – that grows on solar energy, converting CO2 to carbon and emitting oxygen. It is renewable, recyclable, biodegradable and the least processed building material with the lowest embodied energy.

Timber's production and processing are energy efficient and its use is 'greenhouse positive' because timber products store carbon. Victorian F17 hardwood timber comes from local, sustainably-managed Victorian native regrowth forests. The forest assets are managed by the Victorian Government for a wide range of values. One of these is sustainable hardwood timber products. Only 0.14% of Victoria's forest is used each year for timber products – and every hectare harvested is re-grown.

What do I do if I specify solid seasoned structural hardwood and the merchant supplies LVL?

Send it back! If you have specified solid seasoned structural hardwood then you've done it for a good reason – you know its proven performance, you don't want any risk of ongoing problems, and you are prepared to invest in a quality product. You're the customer – if you have not been given what you have asked for – then send it back. F17 and SUPA17 seasoned hardwood are readily available, meaning minimum delay in your building schedule. Send a message to your merchant that you don't want a 'cheap substitute' – you want **seasoned structural hardwood**.

Span Comparison Example: Lintel – Upper Storey, RLW = 6.0m, sheet roof & ceiling

LVL	240 x 36cm	MoE 13,200MPa	Span = 3.0m
F17	240 x 35cm	MoE 14,000MPa	Span = 3.1m
SUPA17:	240 x 35cm	MoE 16,000MPa	Span = 3.2m

For more information visit www.hardwoodworks.info
Email: info@hardwoodworks.info or contact your supplier.



F17/SUPA17

HARDWOOD. DON'T RISK A SUBSTITUTE.