



OVERHEAD CABINET SOLUTIONS FLAP FITTINGS

Brought to you by Häfele

THE ART OF MOVEMENT

OVERHEAD FLAP FITTINGS ENGINEERED BY HÄFELE



All fittings in the Lift + Turn product range from Häfele are easy to open, silent and smooth to operate, offer sophisticated design and allow the kitchen user to utilise high wall cabinet storage space.

The Senso Bi-folding Lift Up fitting for two door flaps, folds in the centre when opening. The door can be adjusted to individual heights, remains easy to reach in any desired position, and closes smoothly and silently, thanks to the Senso's built in soft-close mechanism.

The Verso Swing Up flap fitting is great for overhead cabinets with larger fronts, as the door swings up and over the top of the cabinet. If the cabinet has a cornice or moulding, the door will swing up and away with sufficient clearance to avoid any obstacles. Like all Lift + Turn Fittings, the door stops in the desired position and closes smoothly and quietly.

The Strato Parallel Lift Up fitting for single fronts, lifts parallel to the cabinet. This lift is ideal for wall cabinets that have cabinets above. The Strato is great for concealing microwaves and appliances. Like the other flap fittings from Häfele, the Strato can be stopped at any desired position, making it easy to open and close.

All three of the above overhead fittings are also available in an electric version. The E-Senso, E-Verso and E-Strato, offer electric opening and closing and include a programmable push button, which allows the user to set the stopping point of the door. The button can be installed in the bottom of the cabinet, out of sight. The mechanism simply kick starts the movement and the gas struts do the rest, saving energy and money without compromising stability. Also, the push button may be programmed to open several door flaps at once, an ideal solution for commercial kitchens.

Smaller flap doors are also catered for with the Free Flap, Maxi, Duo Forte and Duo fittings. Each fitting has been specifically engineered by Häfele to suit specific market requirements.

E-SENSO

PAGES

04-05

Electrically operated two-piece horizontal bifold flaps.

E-VERSO

PAGES

06-07

Electrically operated one-piece swing up flaps.

E-STRATO

PAGES

08-09

Electrically operated one-piece lift up flaps.

SENSO

PAGES

10-11

For two-piece horizontal bifold flaps.

VERSO

PAGES

12-13

For one-piece swing up flaps.

STRATO

PAGES

14-15

For one-piece lift up flaps.

FREE FLAP

PAGES

16-18

For mid-sized one-piece flaps.

DRILLING JIGS

PAGES

19

For the heavy duty members of the Lift + Turn product family.

DUO / DUO FORTE

PAGES

20-21

For small one-piece flaps and lids.

MAXI

PAGES

22-23

For mid-sized one-piece flaps.

MAXI UP

PAGES

24-25

For timber lids used in a chest fitting application.

DUO / DUO FORTE TOUCH

PAGES

26-27

For small one-piece flaps without handles.

MAXI TOUCH

PAGES

28-29

For mid-sized one-piece flaps without handles.

TOUCH ACCESSORIES

PAGES

30-31

Accessories to suit Maxi Touch and Duo / Duo Forte Touch

TECHNICAL INFORMATION

PAGES

32-39

Installation details for all Lift + Turn products.

E-SENSO

ELECTRICALLY OPERATED TWO-PIECE HORIZONTAL BIFOLD FLAPS



- > **Features:**
 - Electric opening and closing system for bifolding flaps
 - Programmable push-button remote control for opening and closing the flap
 - Push-button remote control suitable for operating several flap fittings
 - Quiet drive and soft closing action
 - Operation of the flap in case of power failure is possible with no increased amount of effort (free wheeling function)
 - System is powered on both sides
 - Shallow installation depth
 - Obstacle detection with auto-stop on both sides
- > **Material:**
 - Fitting: Zinc, aluminium, plastic
 - Cover cap: Plastic
- > **Finish:**
 - Fitting: Silver coloured anodised
 - Cover cap: Grey, similar to RAL 9006
- > **Nominal voltage:** 18 V
- > **Input voltage:** 100 - 240 V, 50 - 60 Hz

Supplied with:

- > 1 Push button remote control with battery
- > 1 Control unit with female adaptor
- > 1 Allen key 4 mm
- > 2 Fittings with grey cover caps
- > 2 Base plates
- > 2 Connecting cables for drives/control unit
- > 4 Screws M5 x 16 mm
- > 1 Set of installation and operating instructions
- > 2 Screw on brackets for timber flaps

Adjustment facility

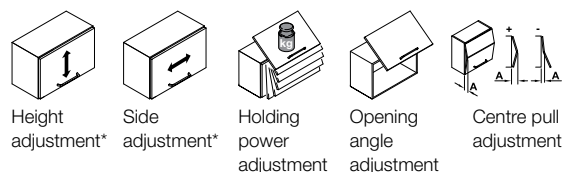

Height adjustment* Side adjustment* Holding power adjustment Opening angle adjustment Centre pull adjustment

*Dependant upon concealed hinges that are used

E-Senso fitting set

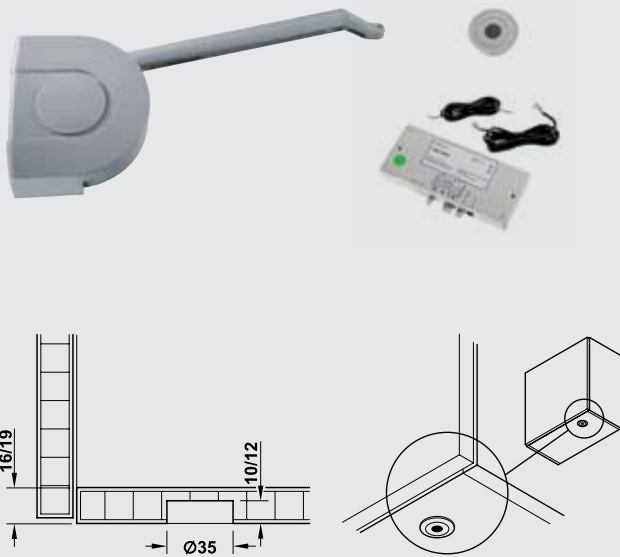

The push-button remote control can be recess mounted in the furniture

Cabinet height (mm)	Flap weight (kg)	Cat. No.
540 - 580	2.5 - 6.5	372.30.301
	6.0 - 11.0	372.30.302
	9.5 - 18.0	372.30.303
	13.0 - 22.0	372.30.304
580 - 640	2.5 - 6.0	372.30.311
	5.5 - 10.0	372.30.312
	7.5 - 17.0	372.30.313
	12.0 - 21.0	372.30.314
640 - 700	3.0 - 5.5	372.30.321
	5.5 - 9.0	372.30.322
	7.0 - 14.5	372.30.323
	10.5 - 18.5	372.30.324
700 - 780	3.0 - 5.0	372.30.331
	4.5 - 8.0	372.30.332
	7.0 - 14.0	372.30.333
	9.0 - 16.5	372.30.334
780 - 840	4.5 - 8.0	372.30.341
	7.0 - 11.0	372.30.342
	9.0 - 14.0	372.30.343
840 - 900	5.0 - 10.0	372.30.351
	7.0 - 12.0	372.30.352



Please order connecting hinges and power cable separately (as per below).

Connecting hinge

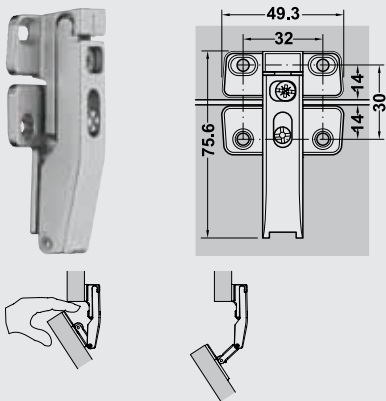

Feature: With finger protection function

- > Area of application: For timber or 45 mm aluminium frame flaps
- > Adjustment: 3-dimensional:
Side adjustment ± 2 mm,
Joint adjustment of -1 to +2 mm
Depth adjustment ± 1.5 mm
- > Feature: With finger protection function
- > Material: Zinc alloy
- > Finish: Nickel plated

Cat. No.
372.64.796

E-Senso remote control



- > Area of application: Allows multiple remote controls to operate a single E-Senso fitting
- > Material: Plastic, Grey

	Cat. No.
Additional remote control	372.64.897
Replacement battery	002.99.032

Power cable



Length (mm)	Cat. No.
2000	553.00.199

E-VERSO

ELECTRICALLY OPERATED ONE-PIECE SWING UP FLAPS



- > **Features:**
 - Electric opening and closing system for flaps
 - Programmable push-button remote control for opening and closing the flap
 - Push-button remote control suitable for operating several flap fittings
 - Quiet drive and soft closing action
 - Operation of the flap in case of power failure is possible with no increased amount of effort (free wheeling function)
 - System is powered on both sides
 - Shallow installation depth
 - Obstacle detection with auto-stop on both sides
 - Clip on bracket for front panel with 3D adjustment via cam
- > **Material:**
 - Fitting: Zinc, aluminium, plastic
 - Cover cap: Plastic
- > **Finish:**
 - Fitting: Silver coloured anodised
 - Cover cap: Grey, similar to RAL 9006
- > **Nominal voltage:** 18 V
- > **Input voltage:** 100 - 240 V, 50 - 60 Hz

Supplied with:

- > 1 Push button remote control with battery
- > 1 Control unit with female adaptor
- > 1 Allen key 4 mm
- > 2 Fittings with grey cover caps
- > 2 Base plates
- > 2 Screw-on brackets for timber doors and 45 mm aluminium frames
- > 2 Connecting plates left/right
- > 2 Adjusting parts
- > 2 Cam followers left/right
- > 2 Connecting cables for drives/control unit
- > 4 Screws M5 x 16 mm
- > 1 Set of installation and operating instructions



Height adjustment
±2.5 mm



Side adjustment
±1.5 mm



Tilt adjustment
±1.5°



Holding power adjustment

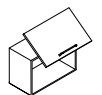

Opening angle adjustment

E-Verso fitting set

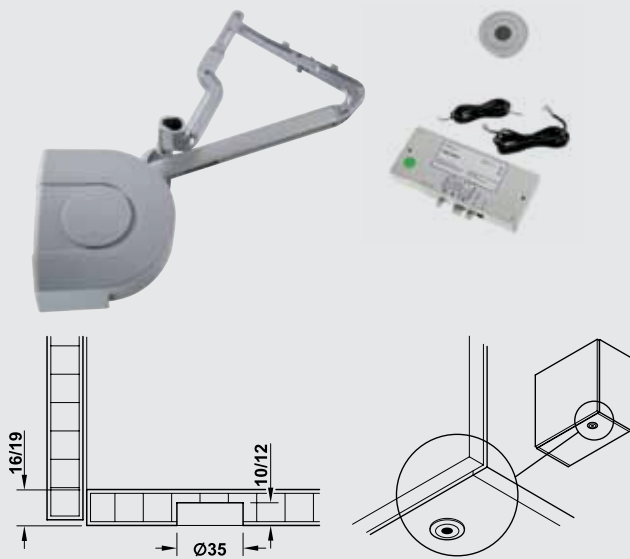

The push-button remote control can be recess mounted in the furniture

Model	A	B	C	D
Flap height (mm)	Flap weight (kg)			
420 - 500	2.0 - 5.0	4.0 - 9.0	6.0 - 12.0	10.0 - 18.0
500 - 600	2.0 - 4.5	4.0 - 8.0	6.0 - 14.0	8.0 - 16.0
600 - 700	2.0 - 4.5	4.0 - 8.0	6.0 - 11.0	8.0 - 15.0
700 - 800	-	3.5 - 6.5	6.0 - 10.0	8.5 - 14.0

Model	Cat. No.
A	372.31.331
B	372.31.332
C	372.31.333
D	372.31.334



Please order power cable and cross bar separately.

Cross bar



- > Area of application: For connecting both E-Verso fitting components
- > Material: Aluminium
- > Finish: Silver coloured anodised

Suitable for flap width (mm)	Length (mm)	Cat. No.
600	477	372.67.983
900	777	372.67.985
1200	1077	372.67.987
1500	1377	372.67.989
1800	1677	372.67.990

E-Verso remote control



- > Area of application: Allows multiple remote controls to operate a single E-Verso fitting
- > Material: Plastic, Grey

	Cat. No.
Additional remote control	372.64.897
Replacement battery	002.99.032

Power cable



Length (mm)	Cat. No.
2000	553.00.199

E-STRATO

ELECTRICALLY OPERATED ONE-PIECE LIFT UP FLAPS



- > **Features:**
 - Electric opening and closing system for flaps
 - Programmable push-button remote control for opening and closing the flap
 - Push-button remote control suitable for operating several flap fittings
 - Quiet drive and soft closing action
 - Operation of the flap in case of power failure is possible with no increased amount of effort (free wheeling function)
 - System is powered on both sides
 - Shallow installation depth
 - Obstacle detection with auto-stop on both sides
 - Clip on bracket for front panel with 3D adjustment via cam
- > **Material:**
 - Fitting: Zinc, aluminium, plastic
 - Cover cap: Plastic
- > **Finish:**
 - Fitting: Silver coloured anodised
 - Cover cap: Grey, similar to RAL 9006
- > **Nominal voltage:** 18 V
- > **Input voltage:** 100 - 240 V, 50 - 60 Hz

- Supplied with:**
- > 1 Push button remote control with battery
 - > 1 Control unit with female adaptor
 - > 1 Allen key 4 mm
 - > 2 Fittings with cover caps
 - > 2 Base plates
 - > 2 screw-on brackets for timber doors and 45 mm aluminium frames
 - > 2 Connecting plates left/right
 - > 2 Adjusting parts
 - > 2 Cam followers left/right
 - > 2 Connecting cables for drives/control unit
 - > 4 Screws M5 x 16 mm
 - > 1 Set of installation and operating instructions



Height adjustment
±2.5 mm



Side adjustment
±1.5 mm



Tilt adjustment
±1.5°



Holding power adjustment

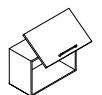

Opening angle adjustment

E-Strato fitting set

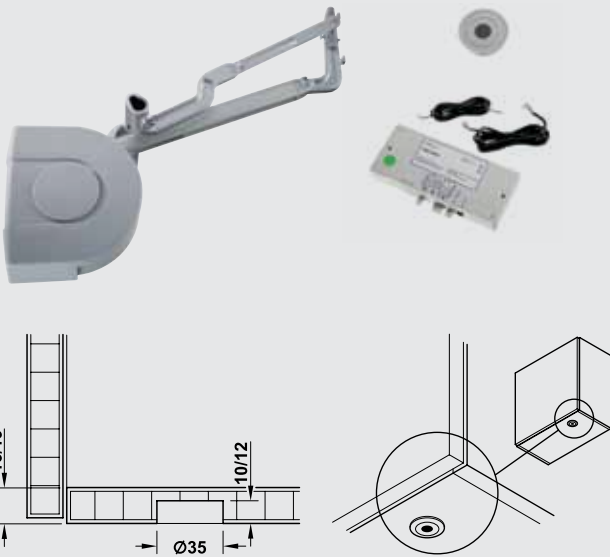

The push-button remote control can be recess mounted in the furniture

Flap height (mm)	Flap weight (kg)	Cat. No.
342 - 420	1.5 - 4.0	372.32.341
	3.5 - 7.0	372.32.342
	6.0 - 10.5	372.32.343
420 - 500	2.0 - 3.5	372.32.351
	3.0 - 7.0	372.32.352
	6.0 - 10.5	372.32.353
	8.0 - 14.0	372.32.354
500 - 550	3.8 - 9.0	372.32.361
	7.0 - 12.0	372.32.362
550 - 650	4.5 - 10.0	372.32.371
	6.0 - 11.0	372.32.372



Please order power cable and cross bar separately.

Cross bar



- > Area of application: For connecting both E-Strato fitting components
- > Material: Aluminium
- > Finish: Silver coloured anodised

Suitable for flap width (mm)	Length (mm)	Cat. No.
600	477	372.67.983
900	777	372.67.985
1200	1077	372.67.987
1500	1377	372.67.989
1800	1677	372.67.990

E-Strato remote control



- > Area of application: Allows multiple remote controls to operate a single E-Strato fitting
- > Material: Plastic, Grey

	Cat. No.
Additional remote control	372.64.897
Battery	002.99.032

Power cable



Length (mm)	Cat. No.
2000	553.00.199

SENSO

FOR TWO-PIECE HORIZONTAL BIFOLD FLAPS



- > Material: Fitting: Zinc, aluminium, plastic
Cover cap: Plastic
- > Finish: Fitting: Silver coloured anodised
Cover cap: Grey, similar to RAL 9006

Supplied with:

- > 1 Bifold flap lift up fitting (LH and RH)
- > 1 Set of installation instructions
- > 2 Grey Cover caps
- > 2 Screw on brackets

Adjustment facility



Height adjustment*



Side adjustment*



Holding power adjustment



Opening angle adjustment

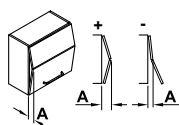

Centre pull adjustment

*Dependant upon concealed hinges that are used

Senso fitting set



Cabinet height (mm)	Flap weight (kg)	Cat. No.
540 - 580	3.0 - 6.5	372.64.601
	6.0 - 12.0	372.64.602
	9.0 - 18.0	372.64.603
	12.0 - 24.5	372.64.604
580 - 640	3.0 - 6.0	372.64.611
	6.0 - 11.0	372.64.612
	9.0 - 17.0	372.64.613
	12.0 - 23.0	372.64.614
640 - 700	3.0 - 5.5	372.64.621
	5.5 - 10.0	372.64.622
	8.0 - 16.0	372.64.623
	10.5 - 21.5	372.64.624
700 - 780	3.5 - 5.5	372.64.631
	5.0 - 9.0	372.64.632
	7.0 - 15.0	372.64.633
	9.0 - 20.0	372.64.634
780 - 840	5.0 - 9.0	372.64.642
	7.0 - 13.0	372.64.643
	9.0 - 17.0	372.64.644
840 - 900	5.5 - 12.0	372.64.653
	7.5 - 16.0	372.64.654



Please order connecting hinges separately.
Special models with 2/3 and 1/3 flap heights possible on request.

Connecting hinge

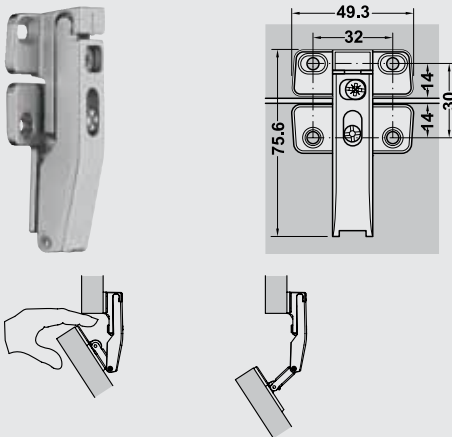

- > Area of application: For timber or 45 mm aluminium frame flaps
- > Adjustment: 3-dimensional:
Side adjustment ± 2 mm
Joint adjustment of -1 to $+2$ mm
Depth adjustment ± 1.5 mm
- > Feature: With finger protection function
- > Material: Zinc alloy
- > Finish: Nickel plated

Cat. No.
372.64.796

Feature: With finger protection function

Optional cover plates

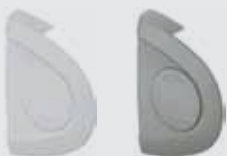

Colour	Cat. No.
White	372.64.760
Champagne	372.64.860

VERSO

FOR ONE-PIECE SWING UP FLAPS



- > Features: Clip on bracket for front panel with 3D adjustment via cam
- > Material: Fitting: Zinc, aluminium, plastic
Cover cap: Plastic
- > Finish: Fitting: Silver coloured anodised
Cover cap: Grey, similar to RAL 9006

Supplied with:

- > 1 Swing up front fitting (LH and RH)
- > 2 Grey Cover caps
- > 2 Screw-on brackets for timber doors and 45 mm aluminium frames
- > 1 Set of Installation instructions

Adjustment facility



Height adjustment
 ± 2.5 mm



Side adjustment
 ± 2.5 mm



Tilt adjustment
 $\pm 1.5^\circ$



Holding power adjustment



Opening angle adjustment

Verso fitting set



Model	A	B	C	D
Flap height (mm)	Flap weight (kg)			
420 - 550	2.0 - 4.0	4.0 - 8.0	6.0 - 10.0	8.0 - 17.0
550 - 650	2.0 - 3.5	3.5 - 7.0	6.0 - 10.0	9.0 - 16.0
650 - 800	-	3.0 - 6.5	5.0 - 10.0	9.0 - 15.0

Model	Cat. No.
A	372.67.801
B	372.67.802
C	372.67.803
D	372.67.804



Please order cross bar separately.

Cross bar



- > Area of application: For connecting Verso fitting components
- > Material: Aluminium
- > Finish: Silver coloured anodised

Suitable for flap width (mm)	Length (mm)	Cat. No.
600	477	372.67.983
900	777	372.67.985
1200	1077	372.67.987
1500	1377	372.67.989
1800	1677	372.67.990

Optional cover plates

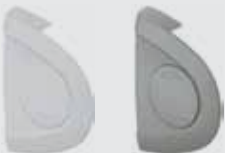

Colour	Cat. No.
White	372.64.760
Champagne	372.64.860

STRATO

FOR ONE-PIECE LIFT UP FLAPS



- > Features: Clip on bracket for front panel with 3D adjustment via cam
- > Material: Fitting: Zinc, aluminium, plastic
Cover cap: Plastic
- > Finish: Fitting: Silver coloured anodised
Cover cap: Grey, similar to RAL 9006

Supplied with:

- > 1 Parallel lift up front fitting (LH and RH)
- > 2 Grey Cover caps
- > 2 Screw-on brackets for timber doors and 45 mm aluminium frames
- > 1 Set of installation instructions

Adjustment facility



Height adjustment
 ± 2.5 mm



Side adjustment
 ± 2.5 mm



Tilt adjustment
 $\pm 1.5^\circ$



Holding power adjustment



Opening angle adjustment

Strato fitting set



Flap height (mm)	Flap weight (kg)	Cat. No.
342 - 420	1.5 - 4.0	372.68.831
	4.0 - 7.2	372.68.832
	6.5 - 11.5	372.68.833
420 - 500	2.0 - 3.5	372.68.801
	3.5 - 7.0	372.68.802
	6.5 - 11.0	372.68.803
	8.0 - 16.0	372.68.804
500 - 550	3.8 - 10.0	372.68.813
	6.0 - 15.0	372.68.814
550 - 650	3.5 - 10.0	372.68.823
	6.0 - 14.5	372.68.824



Please order cross bar separately.

Cross bar



- > Area of application: For connecting Strato fitting components
- > Material: Aluminium
- > Finish: Silver coloured anodised

Suitable for flap width (mm)	Length (mm)	Cat. No.
600	477	372.67.983
900	777	372.67.985
1200	1077	372.67.987
1500	1377	372.67.989
1800	1677	372.67.990

Optional cover plates

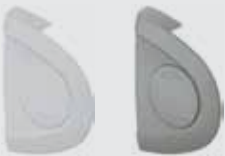

Colour	Cat. No.
White	372.64.760
Champagne	372.64.860

FREE FLAP

OVERVIEW



- > Hinge-less flap stay fitting that sets new standards.
- > Two models, Free Flap 1.7 and 3.15, designed for all common cabinet height and flap weight combinations
- > Convenient handling, even with heavy flaps
- > Stylish and compact design is suitable for use in furniture with narrow depth
- > Easy, efficient and time-saving installation and adjustment

Maximum operating convenience

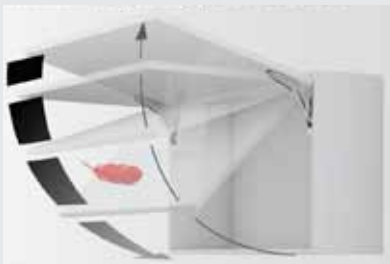

- > Minimum opening resistance
- > Flap locks in any position (multi-position stop)
- > Smooth and soft closing action

Quick installation



- > Plug fitting onto pre-drilled side panel, tighten Euro screws that were pre-mounted in the factory.



- > Position front, clip onto fitting.

Maximum flexibility

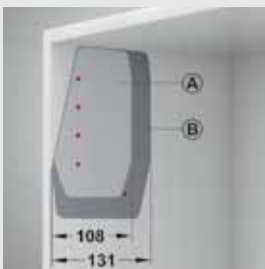

- Ⓐ Free Flap 1.7
- Ⓑ Free Flap 3.15

- > Compact design
- > Drilling pattern compatibility of the two models (processing in series drilled holes 32/37)
- > Stylish cover caps in white finish
- > Front panel weight up to 15 kg for 600 mm high flaps
- > Front panel thickness up to 28 mm (without collision at 90° opening angle)
- > Opening angle 107° (can be limited to 90°)

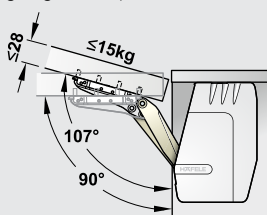

Extremely convenient adjustment



- ① Holding power adjustment
- ② - ④ Flap position adjust
- ⑤ Opening angle adjustment (Model 3.15)

FREE FLAP 1.7

FOR MID-SIZED ONE PIECE FLAPS



Model	A	B	C
Cabinet height (mm)	Flap weight (kg)		
200	1.7 - 4.6	3.6 - 7.9	6.8 - 14.7
225	1.5 - 4.1	3.1 - 7.1	6.0 - 13.1
250	1.3 - 3.8	2.9 - 6.4	5.4 - 11.8
275	1.2 - 3.3	2.5 - 5.7	4.8 - 10.6
300	1.1 - 3.1	2.4 - 5.1	4.4 - 9.6
325	1.0 - 2.8	2.1 - 4.6	4.0 - 8.8
350	0.9 - 2.6	2.0 - 4.2	3.7 - 8.1
375	0.9 - 2.3	1.9 - 3.8	3.5 - 7.5
400	0.8 - 2.1	1.7 - 3.6	3.2 - 7.0
425	0.7 - 1.9	1.5 - 3.4	2.8 - 6.5
450	0.6 - 1.7	1.4 - 3.2	2.7 - 6.1

- > Material: Fitting: Steel
Cover cap: Plastic
- > Finish/Colour: Fitting: Nickel plated,
Cover cap: White, RAL 9003
- > For flap height: 200 - 450 mm
- > Opening angle: 107° (can be limited to 90° by means of optional opening angle restraint)
- > Adjustment facility: Height/side/tilting angle of front \pm 1.5 mm, holding power
- > Installation: Fitting for screw fixing with pre-mounted Euro screws, front panel without tools (clip system onto pre-mounted screw-on brackets)

Model	Cat. No.
A	372.91.720
B	372.91.721
C	372.91.722

Supplied with:

- > 2 Flap Stay fittings (left/right)
- > 2 Cover caps for fitting (left/right)
- > 2 Screw-on brackets for wooden flaps
- > 1 Set of installation instructions
- > 1 Drilling template

Opening angle restraint



- > Area of application: For limiting opening angle of 107° to 90°

Material	Cat. No.
Plastic	372.91.499

FREE FLAP 3.15

FOR MID-SIZED ONE PIECE FLAPS



Model	D	E	F	G
Cabinet height (mm)	Flap weight (kg)			
350	5.2 - 11.0	6.7 - 14.3	10.1 - 21.4	13.5 - 27.3
375	4.9 - 10.2	6.3 - 13.1	9.4 - 19.8	12.5 - 25.2
400	4.7 - 9.6	5.9 - 12.4	8.9 - 18.6	11.8 - 23.3
425	4.4 - 9.0	5.6 - 11.6	8.3 - 17.4	11.0 - 21.8
450	4.1 - 8.4	5.2 - 10.9	7.8 - 16.3	10.4 - 20.5
475	3.9 - 8.0	4.9 - 10.3	7.4 - 15.4	9.8 - 19.3
500	3.7 - 7.5	4.7 - 9.7	7.0 - 14.6	9.2 - 18.3
525	3.5 - 7.1	4.4 - 9.2	6.6 - 13.9	8.8 - 17.3
550	3.3 - 6.8	4.2 - 8.8	6.3 - 13.2	8.3 - 16.5
575	3.2 - 6.5	4.0 - 8.4	6.0 - 12.5	8.0 - 15.6
600	3.0 - 6.2	3.8 - 8.0	5.7 - 12.0	7.6 - 15.0
625	2.8 - 5.9	3.6 - 7.6	5.4 - 11.5	7.2 - 14.4
650	2.6 - 5.6	3.4 - 7.3	5.3 - 11.0	6.9 - 14.0

- > Material: Fitting: Steel
Cover cap: Plastic
- > Finish/Colour: Fitting: Nickel plated,
Cover cap: White, RAL 9003
- > For flap height: 350 - 650 mm
- > Opening angle: 90° or 107° (adjustable on fitting)
- > Adjustment facility: Height/side/tilting angle of front \pm 1.5 mm,
holding power
- > Installation: Fitting for screw fixing with pre-mounted Euro
screws, front panel without tools (clip system
onto pre-mounted screw-on brackets)

Model	Cat. No.
D	372.91.730
E	372.91.731
F	372.91.732
G	372.91.733

Supplied with:

- > 2 Flap Stay fittings (left/right)
- > 2 Cover caps for fitting (left/right)
- > 2 Screw-on brackets for wooden flaps
- > 1 Set of installation instructions
- > 1 Drilling template

DRILLING JIGS

FOR THE HEAVY DUTY MEMBERS OF THE LIFT + TURN PRODUCT FAMILY

DRILLING JIGS FOR CARCASE END PANEL

- > Area of application: For pilot drilling the carcass end panel to suit the base plate
- > Material: Acrylic glass with hardened steel inserts

Drilling jigs for E-Senso and Senso

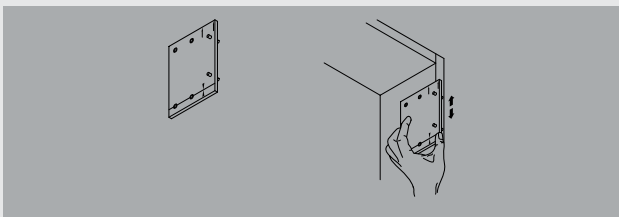

Cat. No.
372.64.891

Drilling jig for E-Verso, Verso, E-Strato and Strato 420 - 650 mm

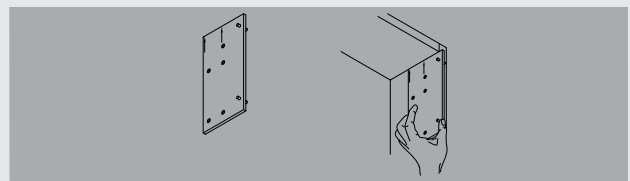

Cat. No.
372.68.990

Drilling jig for Strato 342 - 420 mm

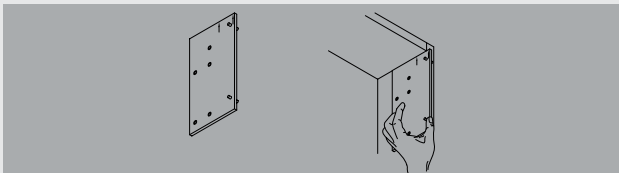

Cat. No.
372.68.034

Drilling jig for Free Flap

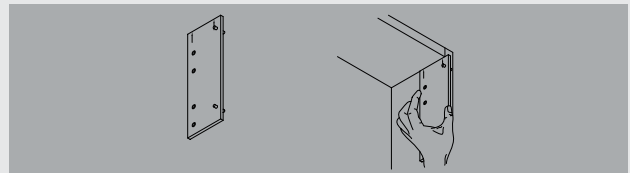

Cat. No.
372.91.021

DRILLING JIGS FOR FRONT PANEL / FLAP DOORS

- > Area of application: For pilot drilling the front panel/ flap doors to suit the mounting brackets or connecting hinges
- > Material: Acrylic glass with hardened steel inserts

Drilling Jig for Screw on Bracket (E-Senso, Senso, E-Verso, Verso, E-Strato and Strato) and Mounting Bracket for Free Flap

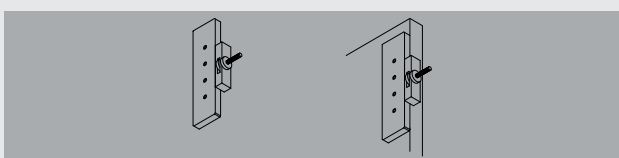

Cat. No.
372.64.890

Drilling jig for connecting hinges (E-Senso and Senso)

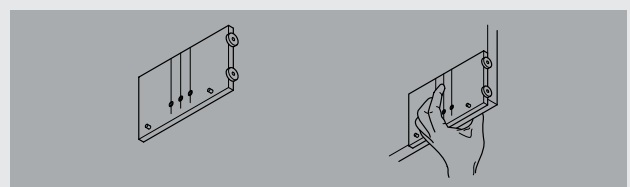

Cat. No.
372.61.799

DUO / DUO-FORTE

FOR SMALL ONE-PIECE FLAPS AND LIDS



- > Area of application: Suitable for use as flap stay or lid stay
- > Opening angle: 75°, 90° or 110°
- > Material: Stay: Zinc alloy
Mounting bracket: Steel
- > Finish: Nickel plated, white or black
- > Mounting: For left and right hand use
- > Installation: Without tools (clip system)
- > Function: Lock function: Flap locks in any position
Braking function: Flap locks in end position, release by slight pressure

Function

Setting the holding power to locking and braking by adjusting the screw with a SW4 hexagon socket

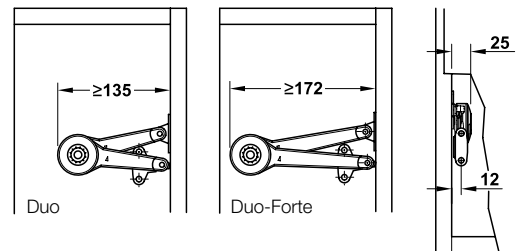
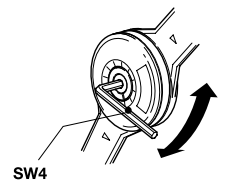

Adjustment facility



Height adjustment*



Side adjustment*



Tilt adjustment*



Holding power adjustment

*Dependent upon concealed hinges that are used

Duo complete set



- > Area of application: For timber or 45 mm aluminium frame flaps

Supplied with:

- > 1 Flap stay
- > 1 Mounting bracket for cabinet (37 mm distance)
- > 1 Mounting bracket for timber flap or 45 mm aluminium frame

Finish	Cat. No.
Nickel plated	373.66.612
White	373.66.262
Black	373.66.212

Flap height (mm)	Max. Flap weight (kg)			
	Lock function		Braking function	
	1 Stay	2 Stays	1 Stay	2 Stays

For opening angle 75°

200	9.0	15.0	11.5	15.0
250	7.0	15.0	9.0	15.0
300	6.0	12.0	7.5	15.0
350	5.0	10.0	6.5	13.0
400	4.5	9.0	6.0	11.5
450	4.0	8.0	5.0	10.0
500	3.5	7.0	4.5	9.0

For opening angle 90°

200	7.5	15.0	9.5	15.0
250	6.0	12.0	7.5	15.0
300	5.0	10.0	6.0	13.0
350	4.0	8.5	5.5	11.0
400	3.5	7.0	5.0	10.0
450	3.5	6.5	4.5	8.5.0
500	3.0	6.0	4.0	7.5

For opening angle 110°

200	6.0	12.0	8.0	15.0
250	5.0	9.5	6.0	12.0
300	4.0	8.0	5.0	10.0
350	3.5	7.0	4.0	9.0
400	3.0	6.0	4.0	7.5
450	2.5	5.5	3.5	7.0
500	2.0	5.0	3.0	6.0

Duo-Forte complete set



- > Area of application: For timber or 45 mm aluminium frame flaps

Supplied with:

- > 1 Flap stay
- > 1 Mounting bracket for cabinet (37 mm distance)
- > 1 Mounting bracket for timber flap or 45 mm aluminium frame

Finish	Cat. No.
Nickel plated	373.66.632
White	373.66.372
Black	373.66.312

Flap height (mm)	Max. Flap weight (kg)			
	Lock function		Braking function	
	1 Stay	2 Stays	1 Stay	2 Stays

For opening angle 75°

200	14.0	15.0	15.0	15.0
250	11.5	15.0	15.0	15.0
300	9.0	15.0	12.0	15.0
350	8.0	15.0	11.0	15.0
400	7.0	14.0	9.0	15.0
450	6.0	12.5	8.0	15.0
500	5.5	11.0	7.0	15.0
550	5.0	10.0	6.5	13.0
600	5.0	9.5	6.0	12.0
650	4.0	8.5	5.5	11.0
700	4.0	8.0	5.0	10.5

For opening angle 90°

200	12.5	15.0	15.0	15.0
250	9.5	15.0	12.0	12.0
300	8.0	15.0	10.0	10.0
350	7.0	13.5	9.0	9.0
400	6.0	12.0	8.0	8.0
450	5.0	11.0	7.0	7.0
500	5.0	9.5	6.0	6.0
550	4.0	8.5	5.5	5.5
600	4.0	8.0	5.0	5.0
650	3.5	7.0	5.0	5.0
700	3.0	7.0	4.0	4.0

For opening angle 110°

200	9.5	15.0	12.5	15.0
250	7.5	15.0	10.0	15.0
300	6.5	12.5	8.0	15.0
350	5.5	11.0	7.0	14.0
400	4.5	9.5	6.0	12.5
450	4.0	8.5	5.5	11.0
500	4.0	7.5	5.0	10.0
550	3.5	7.0	4.0	9.0
600	3.0	6.0	4.0	8.0
650	3.0	5.5	4.0	7.5
700	3.0	5.0	3.5	7.0

MAXI

FOR MID-SIZED ONE PIECE FLAPS



- > Opening angle: 75°, 90° or 110°
- > Material: Stay: Zinc alloy
Mounting bracket and screw-on bracket: Steel
Cover caps and adjusting screw: Plastic
- > Finish: Nickel plated, white or black
Cover cap: Grey, beige, white or black
- > Colour of mounting grommet on lid stay: Model A: Grey
Model B: Beige
Model C: White
Model D: Black
- > Version: With power assisted opening
- > Mounting: Suitable for left hand and right hand use
- > Installation: Without tools (clip system) onto pre-mounted mounting bracket

Adjustment facility



Height adjustment*



Side adjustment*



Tilt adjustment*



Holding power adjustment with SW10 Allen key

*Dependent upon concealed hinges that are used

Adjustment of the holding power

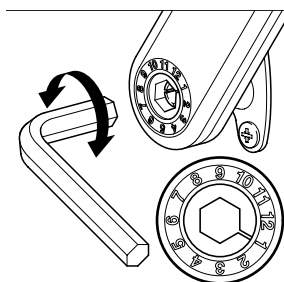

Maxi fitting set



> Area of application: For timber flaps or flaps with 45 mm aluminium frame

Supplied with:

- > 1 Flap stay
- > 1 Mounting bracket for cabinet (37 mm distance)
- > 1 Mounting bracket for timber flap or 45 mm aluminium frame
- > Installation instructions

Model	Finish		
	Nickel plated	White	Black
A	373.69.512	373.69.742	373.69.342
B	373.69.412	373.69.744	373.69.344
C	373.69.712	373.69.746	373.69.346
D	373.69.312	373.69.748	373.69.348

Maxi accessories - Soft-close mechanism

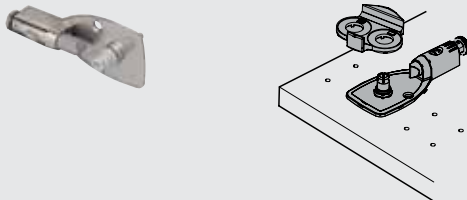

> Material: Zinc alloy

Finish	Cat. No.
Nickel-plated	373.69.799
White	373.69.798
Black	373.69.398

Maxi installation - With opening angle 75°

Model	A	B	C	D
Cabinet height (mm)	Flap weight (kg)			
300	3.8 - 7.1	6.7 - 13.7	11.9 - 21.0	15.4 - 27.3
400	2.8 - 5.3	5.0 - 10.3	8.9 - 15.8	11.6 - 20.5
500	2.3 - 4.3	4.1 - 8.3	7.2 - 12.5	9.4 - 16.2
600	1.9 - 3.5	3.3 - 7.0	5.9 - 10.6	7.6 - 13.7
700	1.6 - 3	2.8 - 5.7	5.0 - 8.8	6.5 - 11.4
800	1.4 - 2.7	2.5 - 5.1	4.4 - 7.9	5.7 - 10.4
900	1.3 - 2.4	2.2 - 4.6	4.0 - 7.0	5.2 - 9.1
1000	1.1 - 2.1	2.0 - 4.1	3.6 - 6.3	4.6 - 8.2

Maxi installation - With opening angle 110°

Model	A	B	C	D
Cabinet height (mm)	Flap weight (kg)			
300	2.4 - 4.0	3.9 - 7.5	6.8 - 11.6	9.2 - 15
400	1.8 - 3.0	2.9 - 5.6	5.1 - 8.7	6.9 - 11.2
500	1.4 - 2.4	2.4 - 4.5	4.0 - 7.1	5.7 - 9.0
600	1.2 - 2.0	1.9 - 3.8	3.3 - 5.9	4.5 - 7.6
700	1.0 - 1.7	1.7 - 3.1	2.9 - 4.8	3.8 - 6.2
800	0.9 - 1.4	1.4 - 2.8	2.6 - 4.3	3.4 - 5.6
900	0.8 - 1.3	1.3 - 2.5	2.3 - 3.8	3.0 - 5.0
1000	0.7 - 1.2	1.1 - 2.2	2.0 - 3.5	2.7 - 4.5

Maxi installation - With opening angle 90°

Model	A	B	C	D
Cabinet height (mm)	Flap weight (kg)			
300	3.0 - 5.3	5.1 - 10.2	9.1 - 15.8	11.9 - 20.8
400	2.3 - 4.0	3.8 - 7.6	6.9 - 11.9	8.9 - 15.6
500	1.8 - 3.2	3.1 - 6.1	5.5 - 9.6	7.2 - 12.5
600	1.5 - 2.7	2.6 - 5.1	4.6 - 7.9	6.0 - 10.4
700	1.3 - 2.2	2.1 - 4.2	3.8 - 6.6	4.9 - 8.7
800	1.1 - 2.0	1.9 - 3.9	3.4 - 5.9	4.4 - 7.8
900	1.0 - 1.8	1.7 - 3.4	3.0 - 5.2	3.9 - 6.9
1000	0.9 - 1.6	1.5 - 3.0	2.7 - 4.7	3.6 - 6.2



The weight specification applies to one Maxi fitting.
Order two Maxi fittings for flap widths from 600 mm and above.

MAXI UP

FOR TIMBER LIDS USED IN A CHEST FITTING APPLICATION

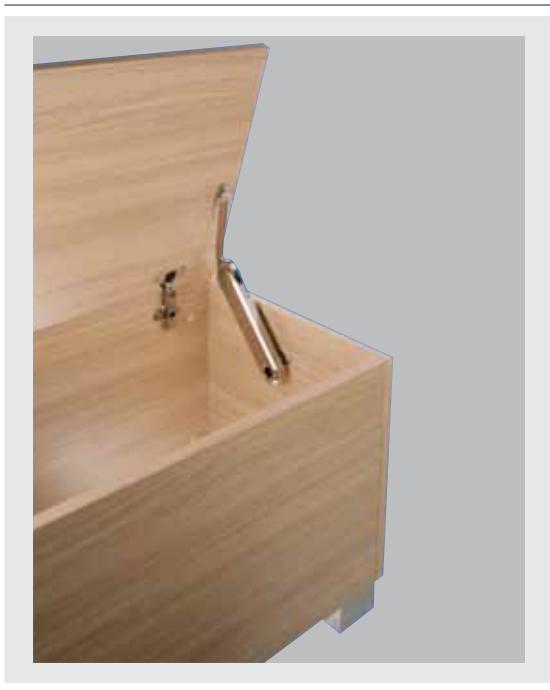

- > Area of application: For timber lids on chests
- > Opening angle: Approx 75°
- > Material: Stay: Zinc alloy
Mounting bracket and screw-on bracket: Steel
Cover caps and adjusting screw: Plastic
- > Finish: Nickel plated
Cover cap: Grey, white or black
- > Colour of mounting grommet on lid stay: Model F: Blue
Model G: Brown
Model H: Black
- > Installation: Without tools (clip system) onto pre-mounted mounting bracket

Adjustment facility

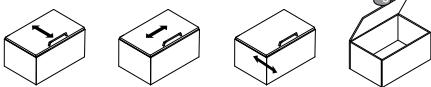

Height adjustment* Side adjustment* Tilt adjustment* Holding power adjustment with SW10 Allen key

*Dependent upon concealed hinges that are used

Adjustment of the holding power

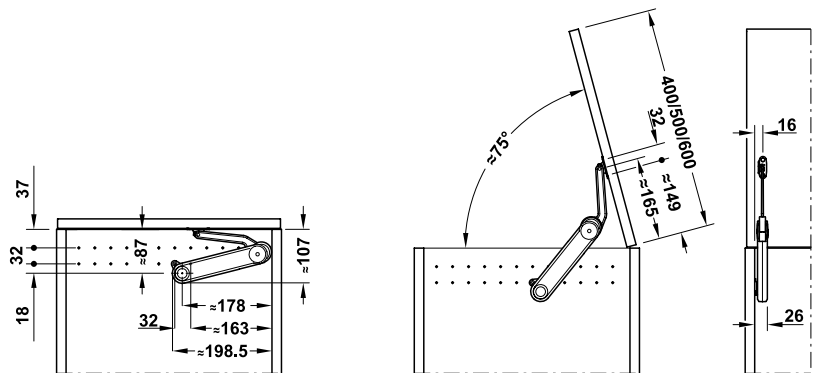
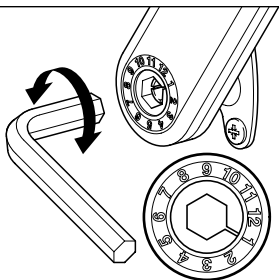

Maxi Up lid stay, arm only



Model	Grommet colour	Cat. No.
F	Blue	373.85.700
G	Brown	373.85.701
H	Black	373.85.702

Model	F	G	H
Flap height (mm)	Flap weight (kg)		
For use with 1 Maxi Up Flap Fitting			
400	1.6 - 3.1	3.0 - 5.3	5.2 - 9.4
500	1.3 - 2.6	2.5 - 4.2	4.3 - 7.5
600	1.1 - 2.5	2.3 - 4.2	4.0 - 6.7
For use with 2 Maxi Up Flap Fittings			
400	3.2 - 6.2	6.6 - 10.6	10.4 - 18.8
500	2.6 - 5.2	5.0 - 8.4	8.6 - 15.0
600	2.2 - 5.0	4.6 - 8.4	8.0 - 13.4

Cabinet mounting bracket



- > Area of application: For mounting lid stay to the cabinet
- > Material: Steel
- > Finish: Nickel plated

Cat. No.
373.69.906

Lid mounting bracket - For timber flaps or flaps with 45 mm aluminium frame



- > Area of application: For mounting lid stay to the lid
- > Material: Steel
- > Finish: Nickel plated
- > Installation: With slide-on-clip (for quick fixing)

Cat. No.
373.69.912

Maxi accessories - Soft-close mechanism

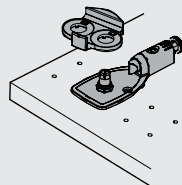

- > Material: Zinc alloy
- > Finish: Nickel plated

Cat. No.
373.69.799



When soft-close mechanism is used, there is no requirement to order the cabinet mounting bracket.

DUO / DUO-FORTE TOUCH

FOR SMALL ONE-PIECE FLAPS WITHOUT HANDLES



- > Area of application: Suitable for use on flaps without handles
- > Opening angle: 75°, 90° or 110°
- > Material: Stay: Zinc alloy
Mounting bracket: Steel
- > Finish: Nickel plated, white or black
- > Mounting: For left and right hand use
- > Installation: Without tools (clip system) Push To Open
- > Function: Lock function: Flap locks in any position
Braking function: Flap locks in end position, release by slight pressure

Function

Setting the holding power to locking and braking by adjusting the screw with a SW4 hexagon socket

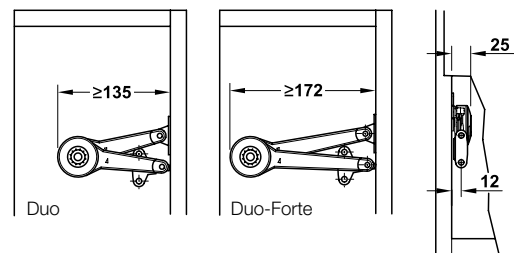
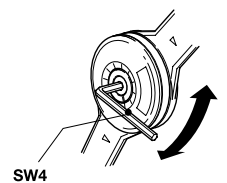

Adjustment facility

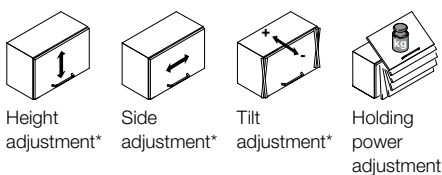

*Dependent upon concealed hinges that are used

Duo Touch complete set



> Area of application: For timber or 45 mm aluminium frame flaps without handle

Supplied with:

- > 1 Flap stay
- > 1 Mounting bracket for cabinet (37 mm distance)
- > 1 Mounting bracket for timber flap or 45 mm aluminium frame

Finish	Cat. No.
Nickel plated	373.66.612
White	373.66.262
Black	373.66.212

Flap height (mm)	Max. Flap weight (kg)			
	Push To Open function			
	1 Stay	Flap opening dist. mm	2 Stays	Flap opening dist. mm

For opening angle 75°

200	10.2	40	10.2	35
250	8.8	40	10.1	35
300	7.9	50	9.9	40
350	7.5	45	9.8	40
400	5.6	45	9.2	40
450	5.6	65	8.4	45
500	5.5	85	6.5	50

For opening angle 90°

200	6.6	30	9.6	30
250	6.5	32	9.3	30
300	6.5	40	7.5	40
350	6.4	45	7.1	50
400	5.6	50	6.9	50
450	5.2	70	6.9	65
500	4.5	75	6.7	65

For opening angle 110°

200	7.6	55	9.6	40
250	6.8	70	9.0	45
300	5.5	95	9.0	50
350	4.8	100	7.3	70
400	4.2	110	7.2	75
450	3.4	120	6.2	80
500	3.0	130	5.1	80

Duo-Forte Touch complete set



> Area of application: For timber or 45 mm aluminium frame flaps without handle

Supplied with:

- > 1 Flap stay
- > 1 Mounting bracket for cabinet (37 mm distance)
- > 1 Mounting bracket for timber flap or 45 mm aluminium frame

Finish	Cat. No.
Nickel plated	373.66.632
White	373.66.372
Black	373.66.312

Flap height (mm)	Max. Flap weight (kg)			
	Push To Open function			
	1 Stay	Flap opening dist. mm	2 Stays	Flap opening dist. mm

For opening angle 75°

250	8.3	30	8.5	30
300	8.0	35	8.5	30
350	6.7	45	8.2	45
400	6.2	50	7.8	40
450	5.0	70	7.8	40
500	4.8	70	7.7	45
550	4.4	90	7.4	50
600	4.3	100	7.4	55
650	4.3	100	7.0	70
700	4.0	120	6.7	80

For opening angle 90°

250	8.0	30	9.0	30
300	6.6	45	9.0	35
350	5.2	60	8.6	50
400	4.8	90	8.0	60
450	4.5	80	6.8	50
500	3.9	100	6.0	55
550	3.6	120	5.6	75
600	3.4	140	5.8	80
650	3.1	150	5.5	85
700	3.1	170	5.1	90

For opening angle 110°

250	7.0	35	7.3	35
300	6.0	50	7.3	40
350	4.0	80	7.0	55
400	3.7	100	6.8	70
450	3.4	130	6.0	70
500	3.0	150	5.9	70
550	2.8	160	4.4	100
600	2.5	190	4.3	110
650	2.0	190	3.9	120
700	1.9	200	3.7	140



Duo / Duo-Forte Touch uses the same fitting as the Duo / Duo-Forte lid stay.

The touch to open functionality is achieved via a different mounting position, combined with a magnetic door catch, and Salice Push hinges.

Order Salice Push hinges and magnetic door catches separately (see page 30-31).

MAXI TOUCH

FOR MID-SIZED ONE PIECE FLAPS WITHOUT HANDLES



- > Opening angle: 75°, 90° or 110°
- > Material: Stay: Zinc alloy
Mounting bracket and screw-on bracket: Steel
Cover caps and adjusting screw: Plastic
- > Finish: Nickel plated
- > Colour of mounting grommet on lid stay: Model A: Grey
Model B: Beige
Model C: White
Model D: Black
- > Version: With power assisted opening
- > Mounting: Suitable for left hand and right hand use
- > Installation: Without tools (clip system) onto pre-mounted mounting bracket

Adjustment facility

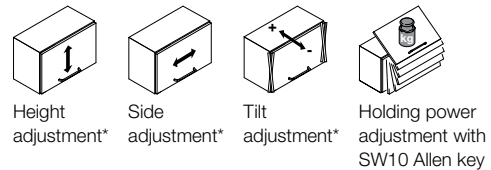

*Dependent upon concealed hinges that are used

Adjustment of the holding power

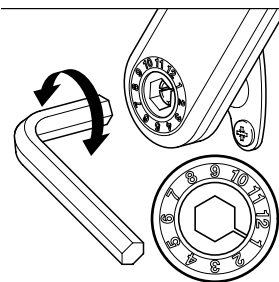

Maxi-Touch fitting set - For one-piece flaps

> Area of application: For timber or 45 mm aluminium frame flaps

Supplied with:

- > 1 Flap stay
- > 1 Mounting bracket for cabinet (37 mm distance)
- > 1 Mounting bracket for timber flap or 45 mm aluminium frame

Model	Cat. No.
A	373.69.512
B	373.69.412
C	373.69.712
D	373.69.312



The weight specification applies to one Maxi Touch fitting. Order two Maxi Touch fittings flap widths from 600 mm and above.
Maxi Touch uses the same fitting as the Maxi Lid Stay. The touch to open functionality is achieved via a different mounting position, combined with a magnetic door catch, and Salice Push hinges.
Order Salice Push hinges and magnetic door catches separately (see page 30-31).

	Model flap height	A	B	C	D
		Max. flap weight (kg)			
75°	300	2.4-3.3	4.5-6.8	5.5-9.5	8.6-11.8
	400	1.7-2.3	3.6-5.3	4.6-7.7	6.0-10.1
	500	–	2.7-4.7	4.3-7.0	5.8-9.2
	600	–	2.1-3.3	2.9-5.1	3.9-6.6
	700	–	2.1-3.0	2.6-4.5	3.4-5.8
	800	–	–	2.5-4.2	3.3-5.5
	900	–	–	2.1-3.7	2.8-4.8
		–	–	2.0-3.4	2.7-4.4
90°	300	1.7-2.4	3.1-4.6	3.8-7.0	5.8-9.8
	400	–	2.4-3.7	3.1-5.5	4.2-7.1
	500	–	1.6-2.9	2.6-4.5	3.4-5.8
	600	–	1.5-2.4	2.1-3.6	2.9-4.8
	700	–	1.2-2.1	1.5-3.2	2.5-4.0
	800	–	–	1.3-2.9	2.2-3.8
	900	–	–	1.1-2.6	1.9-3.3
	1000	–	–	–	1.6-3.0
110°	300	–	2.7-4.0	3.5-6.1	5.1-7.8
	400	–	1.8-3.0	2.7-4.6	3.4-5.0
	500	–	1.7-2.4	2.3-3.7	3.0-4.9
	600	–	1.4-2.1	1.8-3.1	2.5-4.2
	700	–	–	1.6-2.7	2.2-3.5
	800	–	–	–	1.8-3.1
	900	–	–	–	1.4-2.9
	1000	–	–	–	1.2-2.6

TOUCH ACCESSORIES

ACCESSORIES TO SUIT MAXI TOUCH AND DUO / DUO-FORTE TOUCH

Salice Push hinges - With push system for opening without handle - Opening angle 110°



- > Material: Zinc alloy cup, steel hinge arm
- > Finish: Nickel plated
- > Drilling depth (mm): 11
- > Adjustment facility: Lateral adjustment continuously from -1.5 mm to +4.5 mm
Height adjustment from -2 mm to +2 mm
Depth adjustment with SALICE SM mounting plates from -0.5 mm to +2.8 mm
- > Cup fixing: Screw fixing, Knock-in
- > Fixing door to carcass: Quick fixing with SALICE SM mounting plates

Minimum gap

Door thickness (mm)	Distance to cup (mm)			
	3	4	5	6
16	0.5	0.5	0.5	0.5
17	0.7	0.7	0.7	0.7
18	0.9	0.9	0.9	0.9
19	1.2	1.2	1.2	1.2
20	1.5	1.5	1.5	1.5
21	1.8	1.8	1.8	1.8
22	2.4	2.1	2.1	2.1
23	3.7	2.7	2.6	2.5
24	5.1	4.1	3.1	3.0
25	6.5	5.5	4.1	3.5
26	7.8	6.8	5.4	4.4

Rounding off the edge of door reduces the given values.

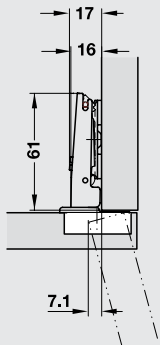

Door overlay (mm)																
9	10	11	12	13	14	15	16	17	18	19	20	21				
									3	4	5	6	0			
							3	4	5	6				3		
				3	4	5	6						6			
3	4	5	6												9	
								Distance to cup (mm)					Mounting plate distance (mm)			

Cup fixing	Cat. No.		
Drilling pattern	48/6	45/9.5	52/5.5
Screw fixing	329.17.900	-	-
Knock-in	329.17.910	329.17.810	329.17.950

Mounting plate with quick fixing system (DOMI)[®]

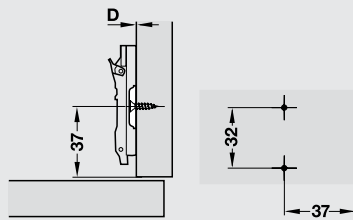

- > Material: Steel
- > Finish: Nickel plated
- > Adjusting facility: Depth adjustment using eccentric screw
Height adjustment ± 2 mm via slot

Distance D (mm)	Cat. No.
0	329.74.500
2	329.74.502
3	329.74.503

Push door catch with magnetic release

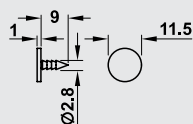
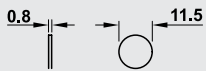
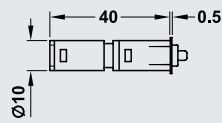

- > Material: Release catch: Plastic
Retaining catch: Steel, nickel plated
- > Finish: Grey
- > Mounting method: Release catch: Drill into carcase or use screw fix mounting adaptor.
Retaining catch: Knock-in or self adhesive

Fixing method	Cat. No.
Knock-in retaining catch	356.06.501
Adhesive retaining catch	356.06.502

Adjustable mounting adaptor for push door catch

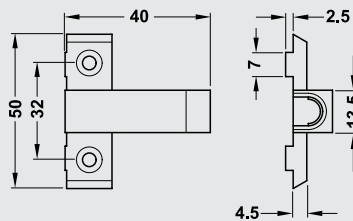

- > Material: Plastic
- > Finish: Grey
- > Mounting method: Screw fixing

Type	Cat. No.
Standard with assembly stop device	356.06.530

TECHNICAL INFORMATION

E-SENSO AND SENSO INSTALLATION

E-Senso

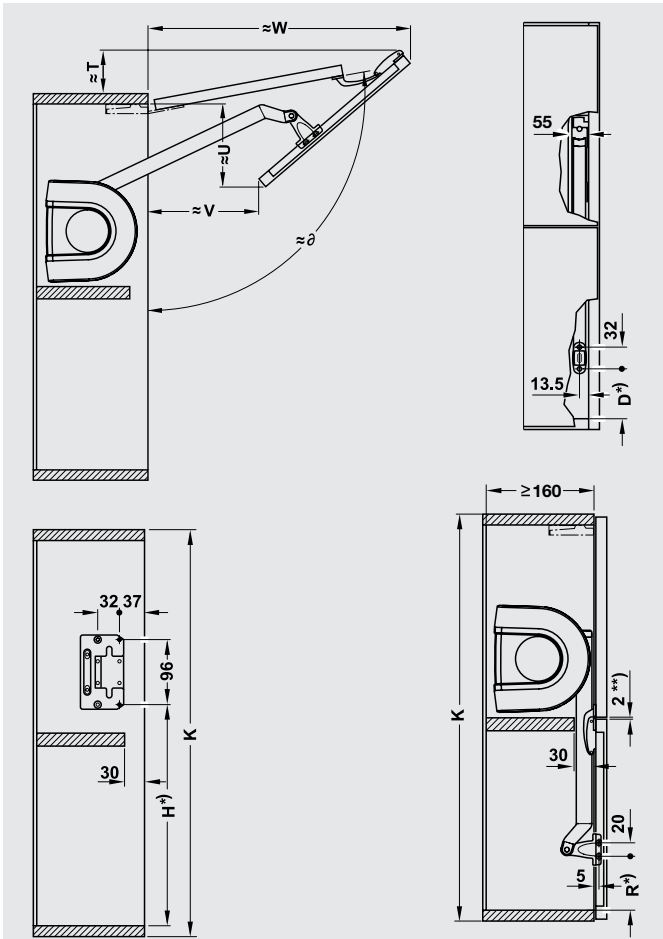

Flap height (K) (mm)	δ	D	H	R	T	U	V	W
540 - 580	101°	57.5	290	63.5	70	139	192	390
580 - 640	101°	73.5	326	79.5	70	130	170	405
640 - 700	103°	67.5	340	73.5	95	160	220	425
700 - 780	102°	75.5	378	81.5	96	207	261	456
780 - 840	100°	71.5	392	77.5	85	255	260	500
840 - 900	102°	47.5	400	53.5	120	260	315	525

Senso

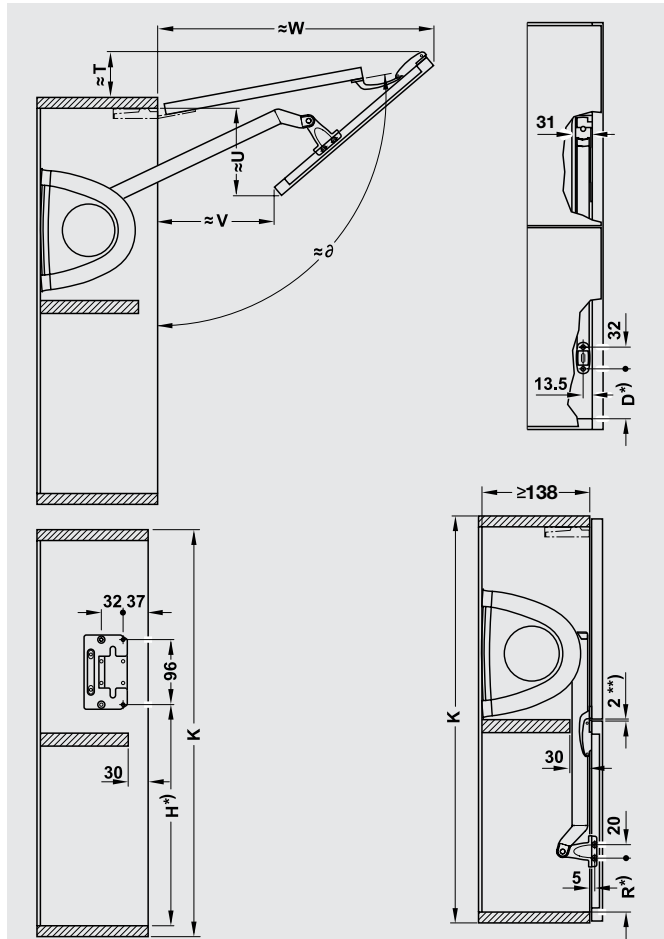

Flap height (K) (mm)	δ	D	H	R	T	U	V	W
540 - 580	101°	57.5	290	63.5	70	139	192	390
580 - 640	101°	73.5	326	79.5	70	130	170	405
640 - 700	103°	67.5	340	73.5	95	160	220	425
700 - 780	102°	75.5	378	81.5	96	207	261	456
780 - 840	100°	71.5	392	77.5	85	255	260	500
840 - 900	102°	47.5	400	53.5	120	260	315	525

TECHNICAL INFORMATION

E-VERSO AND VERSO INSTALLATION

E-Verso

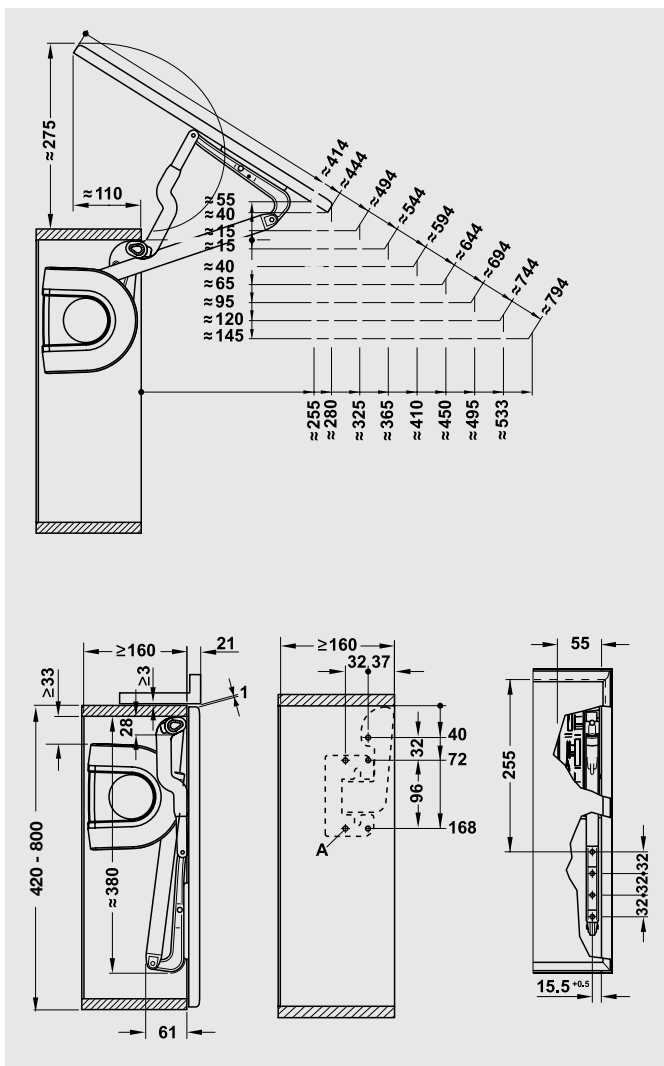

Verso

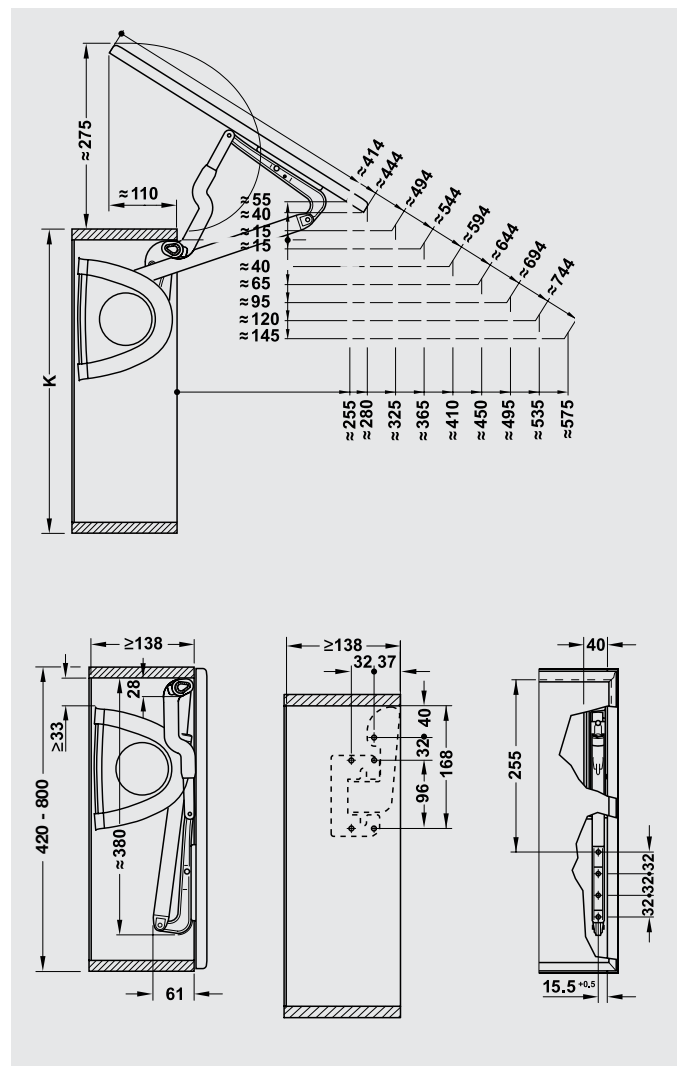

TECHNICAL INFORMATION

E-STRATO AND STRATO INSTALLATION

E-Strato

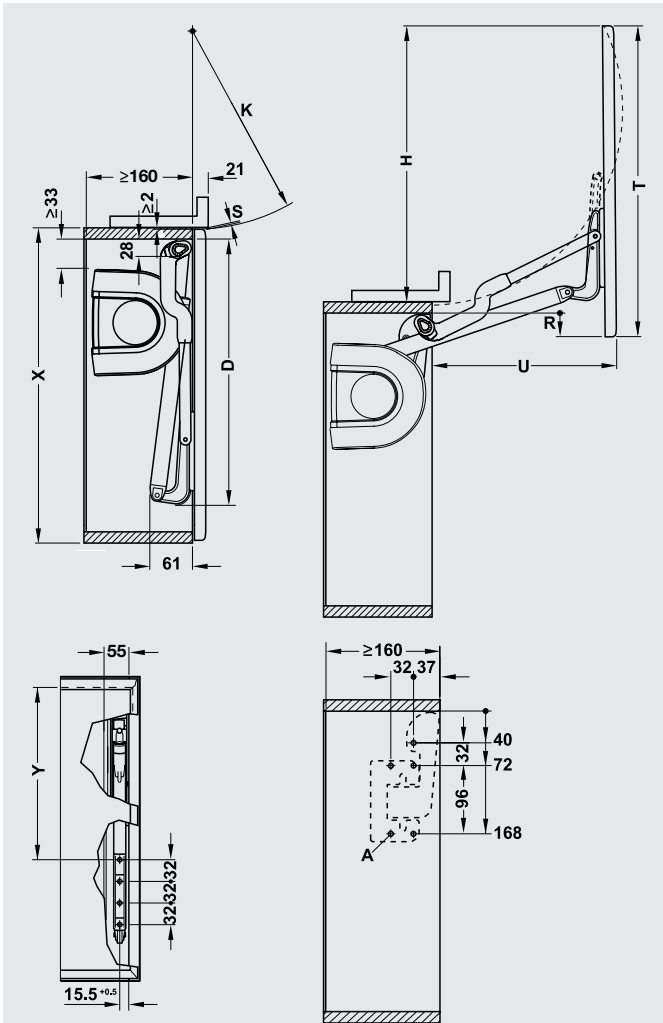

Flap height (K) (mm)	X	Y	D ca	H	K	R ca	S	T	U ca
342 - 420	342	186	308	295	205	28	0.8	333	200
	350	186	308	295	205	38	0.8	346	200
	420	186	308	295	205	98	0.8	416	200
420 - 500	420	255	380	395	271	5	1.2	414	265
	450	255	380	395	271	35	1.2	444	265
	500	255	380	395	271	85	1.2	494	265
	550	293.5	420	450	312.5	30	1.3	494	265
550 - 650	550	313.5	440	480	332.5	50	1.3	544	315
	600	313.5	440	480	332.5	100	1.3	594	315
	600	313.5	440	480	332.5	150	1.3	644	315

Strato

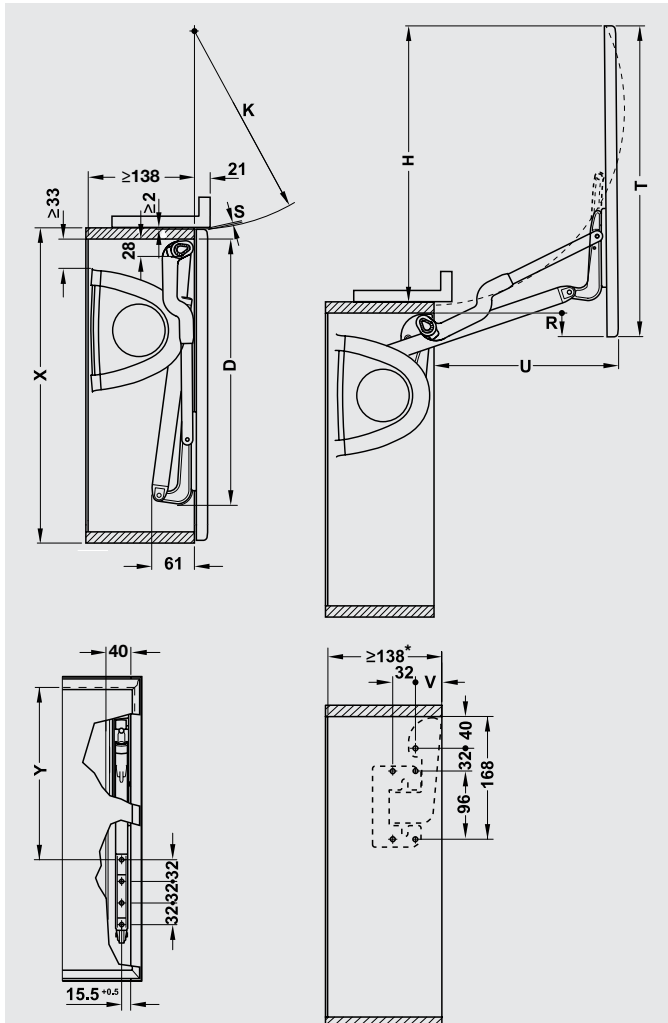

* Dimension is 151mm for flap height 342-420mm

Flap height (K) (mm)	X	Y	D ca	H	K	R ca	S	T	U ca	V
342 - 420	342	186	308	295	205	28	0.8	333	200	50
	350	186	308	295	205	38	0.8	346	200	50
	420	186	308	295	205	98	0.8	416	200	50
420 - 500	420	255	380	395	271	5	1.2	414	265	37
	450	255	380	395	271	35	1.2	444	265	37
	500	255	380	395	271	85	1.2	494	265	37
500 - 550	500	293.5	420	450	312.5	30	1.3	494	265	37
	550	293.5	420	450	312.5	80	1.3	544	295	37
	550 - 650	550	313.5	440	480	332.5	50	1.3	544	315
550 - 650	600	313.5	440	480	332.5	100	1.3	594	315	37
	600	313.5	440	480	332.5	150	1.3	644	315	37
	650	313.5	440	480	332.5	150	1.3	644	315	37

TECHNICAL INFORMATION

FREE FLAP INSTALLATION

Free Flap 1.7

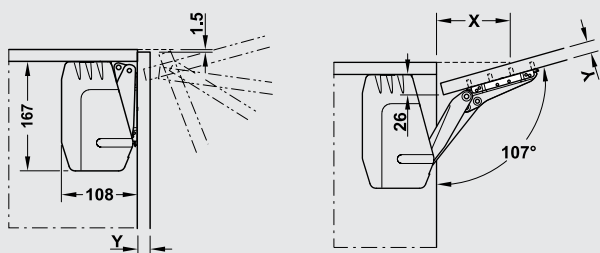

Front panel thickness Y (mm)	16	19	22	26	28
Distance X (mm) (With top panel thickness 16 mm)	83	74	64	52	46

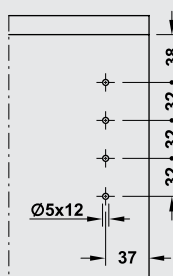

Drilling pattern for cabinet

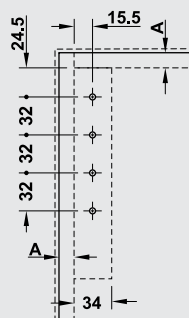

Drilling pattern for front panel

Free Flap 3.15

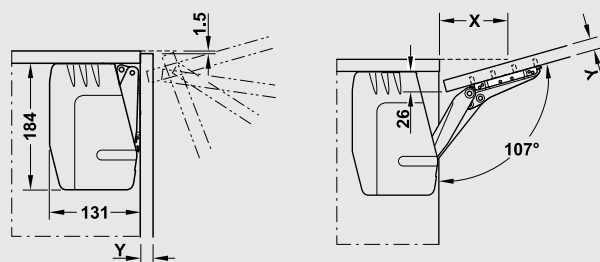

Front panel thickness Y (mm)	16	19	22	26	28
Distance X (mm) (With top panel thickness 16 mm)	83	74	64	52	46

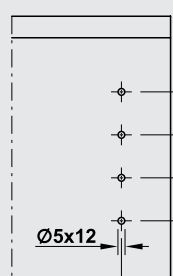

Drilling pattern for cabinet

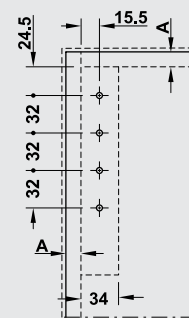

Drilling pattern for front panel

TECHNICAL INFORMATION

MAXI INSTALLATION

Maxi - With opening angle 75°

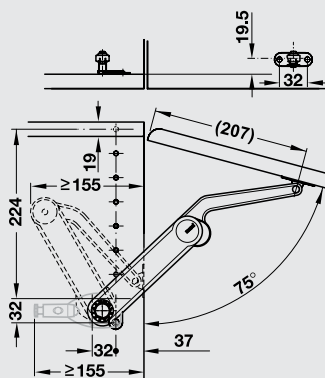

Model	A	B	C	D
Flap height	Max. Flap weight (kg)			
300	3.8 - 7.1	6.7 - 13.7	11.9 - 21.0	15.4 - 27.3
400	2.8 - 5.3	5.0 - 10.3	8.9 - 15.8	11.6 - 20.5
500	2.3 - 4.3	4.1 - 8.3	7.2 - 12.5	9.4 - 16.2
600	1.9 - 3.5	3.3 - 7.0	5.9 - 10.6	7.6 - 13.7
700	1.6 - 3.0	2.8 - 5.7	5.0 - 8.8	6.5 - 11.4
800	1.4 - 2.7	2.5 - 5.1	4.4 - 7.9	5.7 - 10.4
900	1.3 - 2.4	2.2 - 4.6	4.0 - 7.0	5.2 - 9.1
1000	1.1 - 2.1	2.0 - 4.1	3.6 - 6.3	4.6 - 8.2

Maxi - With opening angle 110°

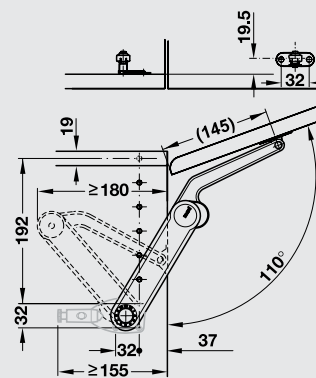

Model	A	B	C	D
Flap height	Max. Flap weight (kg)			
300	2.4 - 4.0	3.9 - 7.5	6.8 - 11.6	9.2 - 15.0
400	1.8 - 3.0	2.9 - 5.6	5.1 - 8.7	6.9 - 11.2
500	1.4 - 2.4	2.4 - 4.5	4.0 - 7.1	5.7 - 9.0
600	1.2 - 2.0	1.9 - 3.8	3.3 - 5.9	4.5 - 7.6
700	1.0 - 1.7	1.7 - 3.1	2.9 - 4.8	3.8 - 6.2
800	0.9 - 1.4	1.4 - 2.8	2.6 - 4.3	3.4 - 5.6
900	0.8 - 1.3	1.3 - 2.5	2.3 - 3.8	3.0 - 5.0
1000	0.7 - 1.2	1.1 - 2.2	2.0 - 3.5	2.7 - 4.5

Maxi - With opening angle 90°

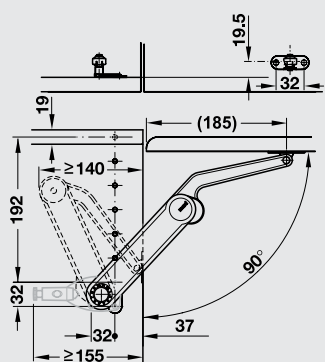

Model	A	B	C	D
Flap height	Max. Flap weight (kg)			
300	3.0-5.3	5.1-10.2	9.1-15.8	11.9-20.8
400	2.3-4.0	3.8-7.6	6.9-11.9	8.9-15.6
500	1.8-3.2	3.1-6.1	5.5-9.6	7.2-12.5
600	1.5-2.7	2.6-5.1	4.6-7.9	6.0-10.4
700	1.3-2.2	2.1-4.2	3.8-6.6	4.9-8.7
800	1.1-2.0	1.9-3.9	3.4-5.9	4.4-7.8
900	1.0-1.8	1.7-3.4	3.0-5.2	3.9-6.9
1000	0.6-1.6	1.5-3.0	2.7-4.7	3.6-6.2

Mounting bracket dimensions

- Locks the flap reliably in any position
- With power assisted opening

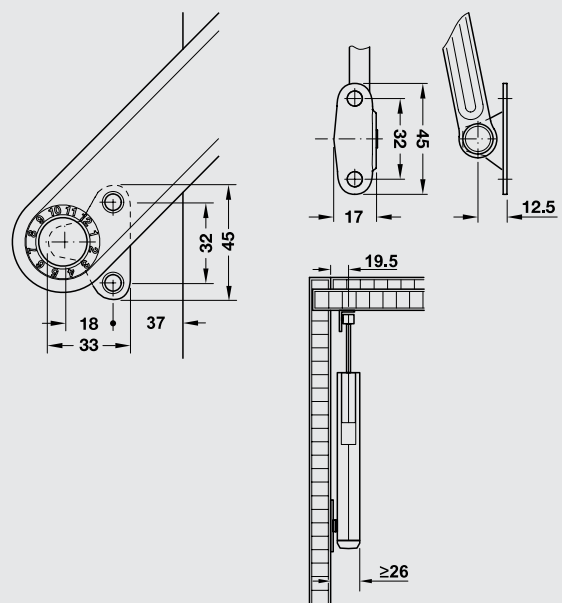

TECHNICAL INFORMATION

DUO / DUO-FORTE TOUCH INSTALLATION

Duo Touch

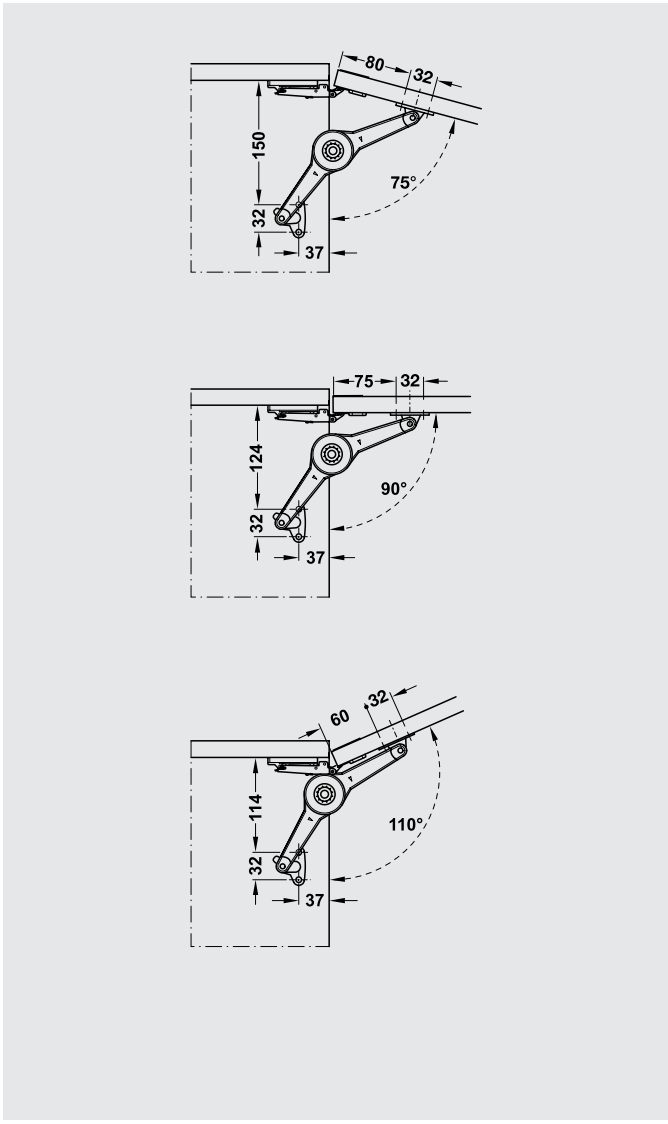

Duo-Forte Touch

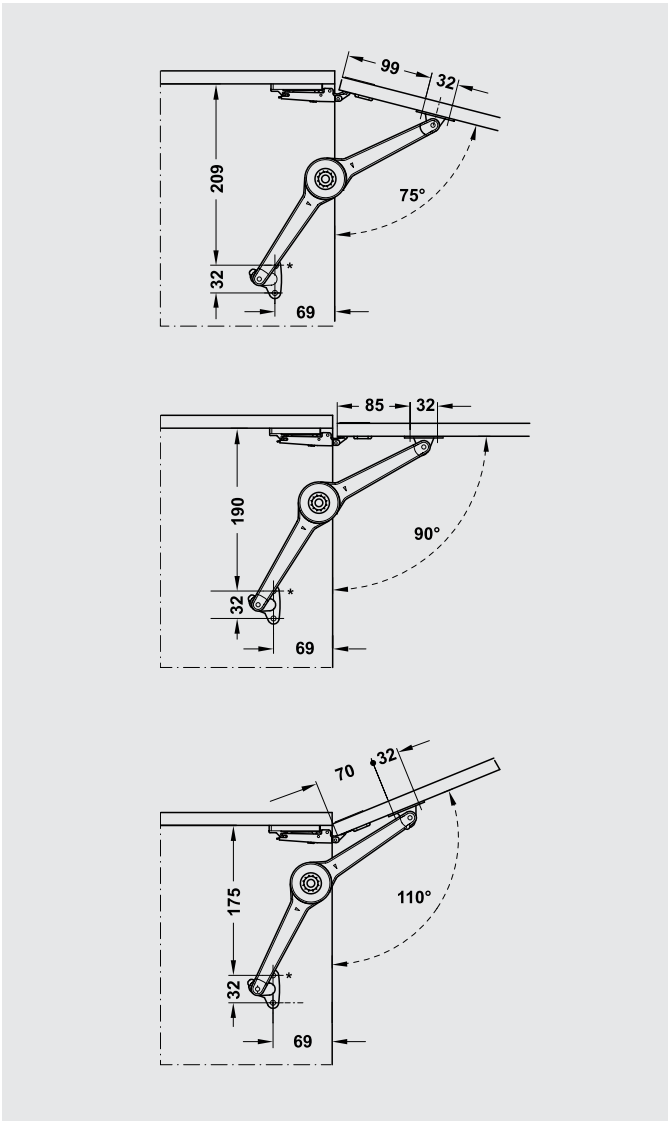

TECHNICAL INFORMATION

MAXI TOUCH INSTALLATION

Maxi Touch - With opening angle 75°

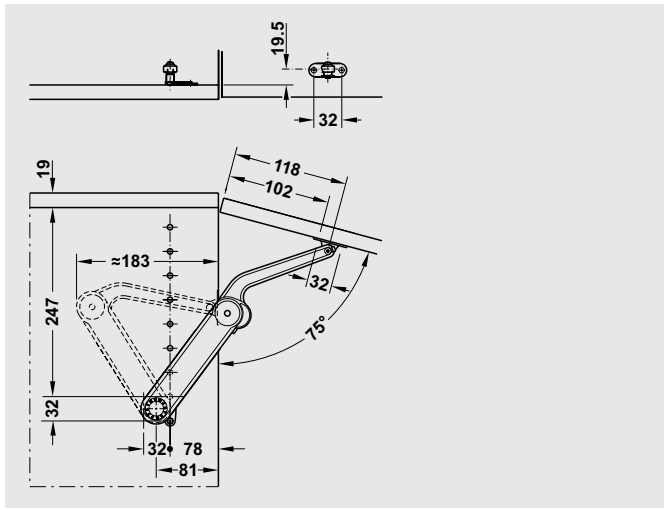

Maxi Touch - With opening angle 90°

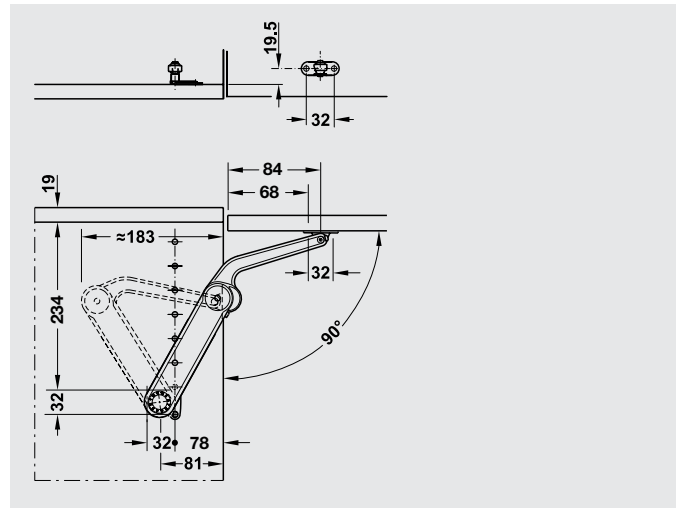

Maxi Touch - With opening angle 110°

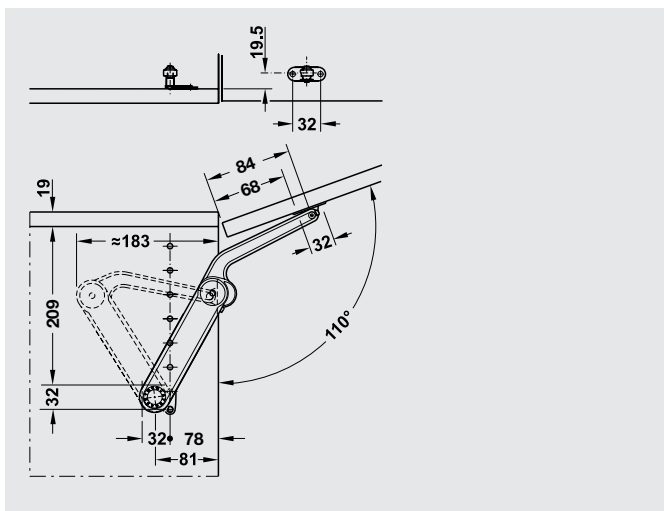

Mounting bracket dimensions

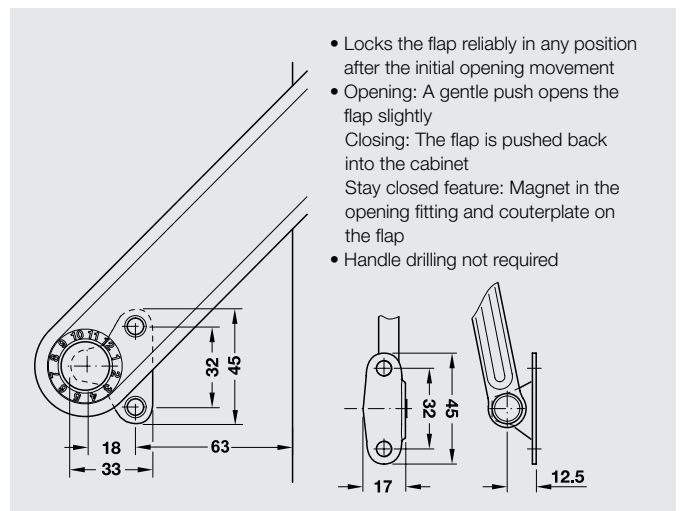

HÄFELE

732.98.682 OVERHEAD CABINET SOLUTIONS - FLAP FITTINGS / 04.2014

Häfele Australia Pty. Ltd. | P.O. Box 1066 Dandenong VIC 3175 | Head Office: 8 Monterey Road | Dandenong VIC 3175
Phone: 1300 659 728 | **Fax:** +61 3 9212 2001 | **Email:** info@hafele.com.au

www.hafele.com.au