



High quality hinge with integrated dampening.
sensys.

Technik für Möbel

Hettich



sensys.

Perfect design, perfect action

Hettich's first hinge with integrated dampening

sensys marks the latest generation in hinge technology: The dampening element is integrated invisibly into the hinge – an innovation that meets the highest criteria for convenience and functionality. Just a light touch – and the door closes smoothly and silently. The unique pull-in function closes the door gently and automatically as soon as the open angle is less than 35°. sensys delivers an exclusive closing experience. sensys incorporates high quality material and perfect 'Silent System' soft closing action – without the need for bulky adaptors.



Clean, elegant design

sensys has an elegant, contemporary look and meets all customer expectations for outstanding design and quality. The simple, sleek, harmonious lines of the design – from the cup and the arm cover cap to the mounting plate – give the hinge its streamline modern look. All edges and radii contribute to the perfect harmony of hinge and mounting plate. Silent System dampening is integrated invisibly in the hinge, as is the unlatch tab. Specially designed cover caps conceal fixing screws and adaptors. Winner of zhe 2008 reddot Design Award and the 2009 iF Product Design Award, sensys seamlessly combines aesthetics and function.



reddot design award
winner 2008



product
design
award
2009

sensys.

Engineered for easy use



Engineered for easy use

With its shallow cup depth, sensys is a versatile solution for many applications, for example, with thinner doors or bigger outside radii. The sensys hinge design also permits minimal visible reveals currently popular even with thick doors. The direct adjustment feature makes it easy to set door depth. A special guard prevents accidental disengagement of the overlay adjustment screw. Cam screws in the mounting plate allow fast door height adjustment.

sensys is a low, slimline design; it leaves ample space for internal drawers, so that only very narrow gaps need be planned between the side panels and drawers.

sensys stands for tested quality, compliance with all current standards, excellent dampening performance, durability and high stability. sensys meets the highest design criteria and is sure to be a long-time favourite.



Toolless assembly

sensys hinges are mounted and removed quickly and easily. No tools are required. It is unlatched from the hinge arm in one smooth, ergonomic movement by lightly pressing the concealed latch.

sensys.

Versatile for different applications



Wide product range

The sensys hinge family includes products for all popular door mounting options, so that sensys hinges can be used in a wide variety of cabinet designs. Designed-in compatibility means that sensys mounting plates can also be combined with hinges from the Intermat range.

sensys cups and mounting plates can be mounted using any of the commonly accepted methods. The cup can be secured in place by screws, knock-in sockets or by toolless Fix fast assembly.





Mounting plates are available for securing with various options – expanding sockets, pre-mounted with Euro screws and the Hettich Top with eccentric height adjustment.

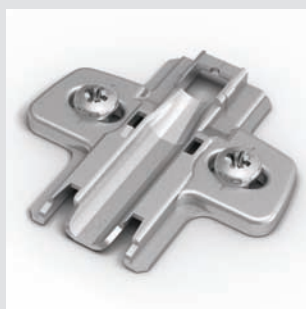

sensys.

A glance at the benefits



High-performance Silent System dampening system invisibly integrated in the hinge arm



Elegant cover cap for the hinge cup



Concealed release latch
Simple, safe, reliable

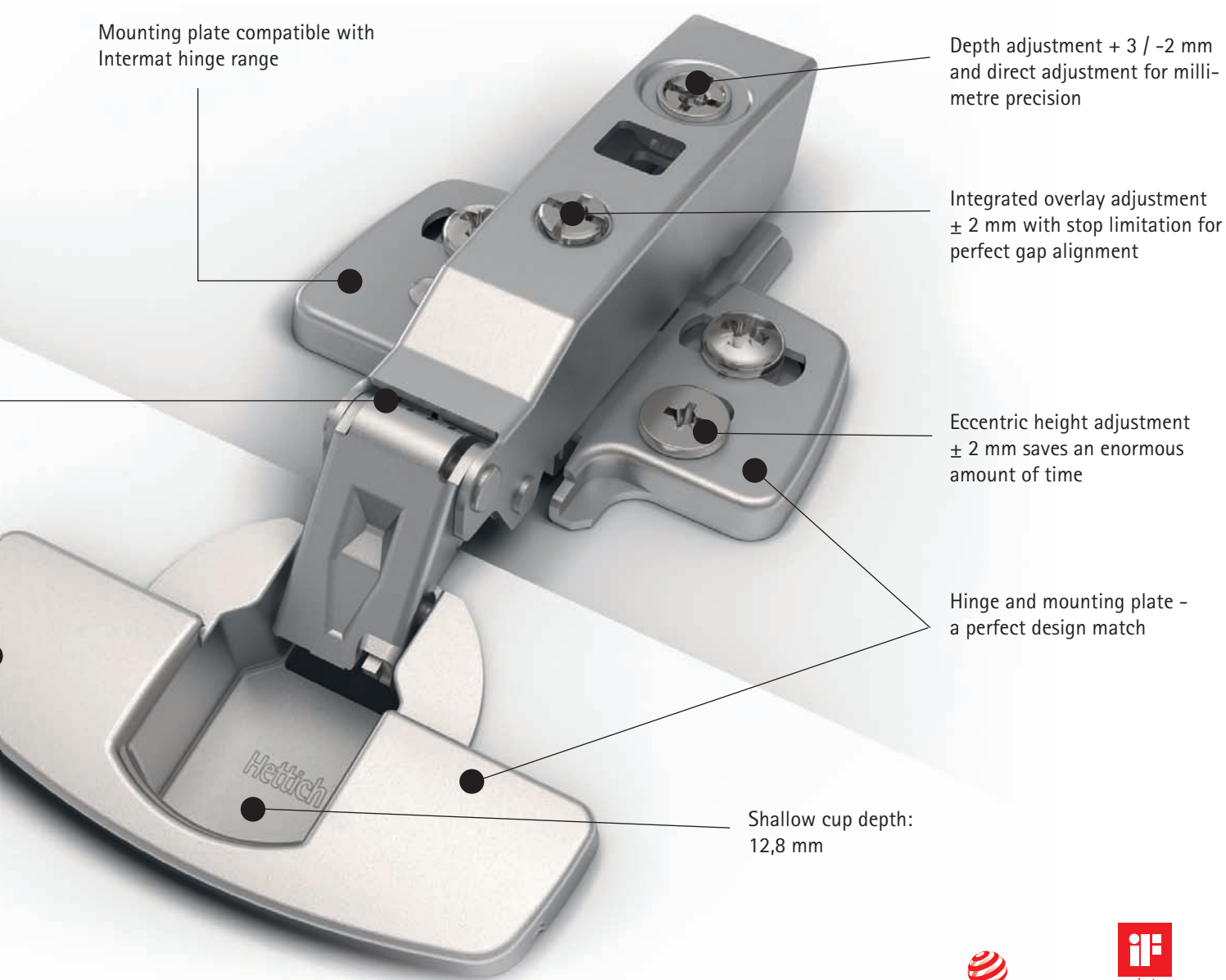

Mounting plate compatible with Intermat hinge range

Depth adjustment + 3 / -2 mm and direct adjustment for millimetre precision

Integrated overlay adjustment ± 2 mm with stop limitation for perfect gap alignment

Eccentric height adjustment ± 2 mm saves an enormous amount of time

Hinge and mounting plate - a perfect design match

Shallow cup depth: 12,8 mm

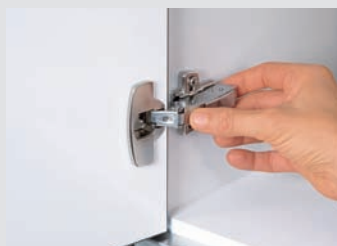

Toolless assembly
Press gently and the hinge arm engages securely in the mounting plate



Minimum door protrusion
Narrow gaps maximize space available for internal drawers



Unique self-closing angle
Gentle, smooth closing from an opening angle of 35°



Narrow reveals
Only 4 mm for 22 mm door thickness

Range summary
Fast-assembly concealed hinges with integrated soft-close function
sensys

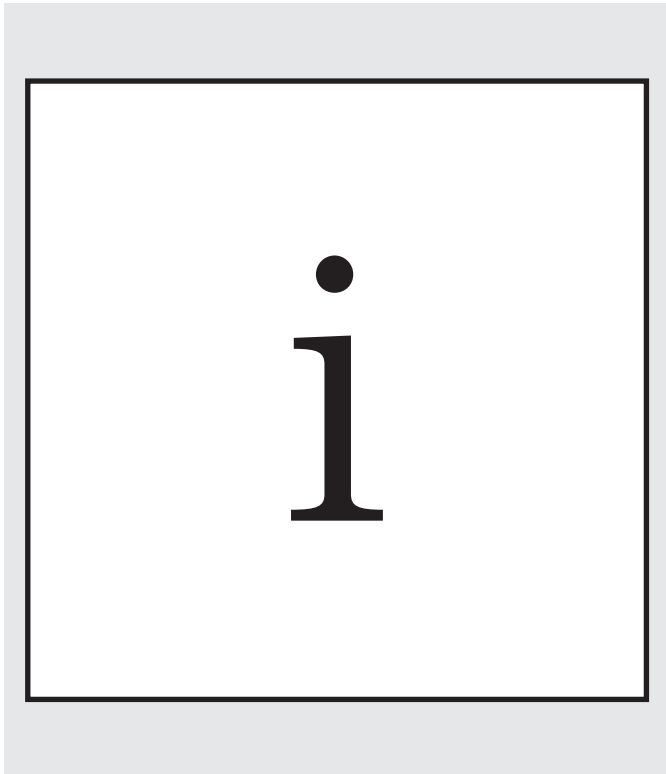

Technical information

12 - 13



sensys 8645i/8645i FIX

Opening angle 110°
for door thickness up to 22 mm

14 - 17



sensys 8639i/8639i FIX

Opening angle 95°
for door thickness up to 28 mm

18 - 21



sensys 8639i W45/8639i W45 FIX

Opening angle 95°
for cabinet face angle 45°

22 - 25



sensys 8639i W90/8639i W90 FIX

Opening angle 95°
for cabinets with blind panels 90°

26 - 29



Intermat 9956/9956 FIX

Opening angle 165°

32 - 35



Mounting plate System 8099

for sensys and Intermat hinges

30 - 31
36



Range summary

Fast-assembly concealed hinges Intermat

37



Mounting options

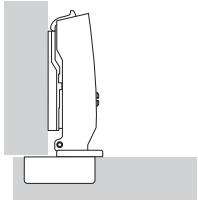

Full overlay

The door is in front of the cabinet wall providing a small reveal at the side within which the door can open reliably. Alternatively, the door can be overlaid fully (max. 19 mm), in which case sufficient space must be allowed at the side for the required minimum reveal.

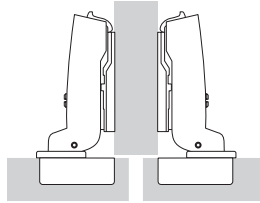

Half overlay

In this case, there are two doors in front of a centre panel, with the required overall reveal between them. In other words, each door has a smaller overlay and cranked hinges are therefore used.

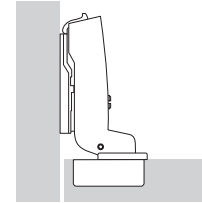

Inset

The door is located inside the cabinet, i.e. beside the cabinet wall. Here too, a reveal is needed so that the door can open reliably. Heavily cranked hinges are used here.

Minimum door reveal

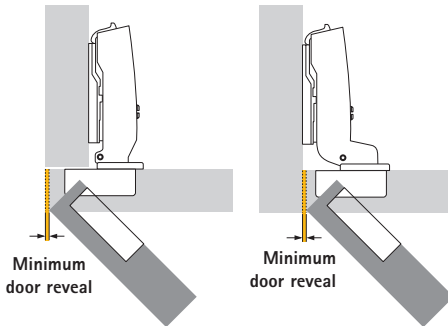

The minimum reveal (also known as the minimum clearance) is the space required at the side so that the door can open.

The size of the minimum reveal depends on the cup distance C, the door thickness and the type of hinge selected.

Radii on the door edges reduce the minimum clearance.

The required minimum reveal is shown in the table for the respective hinge types.

Minimum door reveal for half overlay

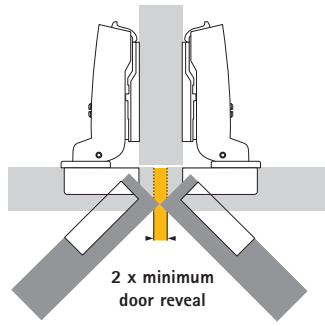

For half overlay configurations, the total reveal between the doors must be chosen to correspond to twice the door reveal. Both doors can then be opened at the same time.

Cup distance C

The cup distance C is the distance between the edge of the door and the edge of the cup hole.

The larger the cup distance, the smaller the required minimum reveal.

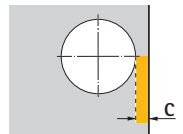

Overlay (Door overlay)

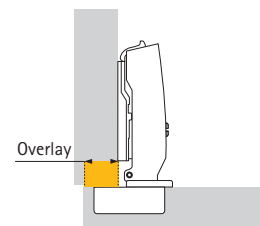

The overlay is the distance by which the door projects over the cabinet front.

Number of hinges per door:

Door width, height and weight as well as the material quality of the door are decisive factors determining the number of hinges required.

The factors encountered in each individual case in practice differ enormously. For this reason, the number of hinges shown in the diagram should only be taken as a guide.

If in doubt, it is advisable to produce a trial mounting or to increase the number of hinges.

For reasons of stability, distance X between the hinges must always be made as large as possible.

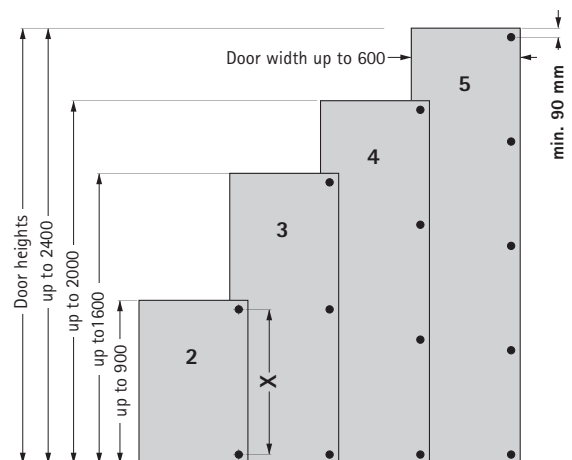

(Guide values for 19 mm chipboard panels with a density of 750 kg/m³)

General determination of distances

Mounting plates are available in different distances (0/1,5/3 and 5 mm). The height of the mounting plate is defined by distance D. Distance D is embossed on the top of each mounting plate. A larger distance D reduces the overlay for corner and centre stops. In the case of inset doors, a larger distance D increases the door reveal. To calculate the required distance, the minimum reveal must first be determined from the table of minimum door reveals for the type of hinge concerned. The minimum reveal depends on the cup distance C and the door thickness. Minimum reveals can be reduced by increasing the cup distance C and/or affixing radii to the door edges. The table of minimum door reveals also shows the possible combinations of door thickness and cup distance C.

Calculating distance for overlay doors

Once the minimum reveal has been defined, the required distance D can be read off in the table for the required door overlay and the required cup distance C.

Ideally, the door overlay and value C should be selected to yield a distance D which is available as a mounting plate.

Example: Overlay = 16 mm and cup distance C = 5 mm yield a distance D equal to 1,5 mm. This distance is available as a mounting plate.

If the calculated distance D differs from the distances available as mounting plates, the difference is compensated by means of the overlay adjustment screw on the hinge arm.

Example: Door overlay = 16 mm and cup distance C = 4 mm yield a distance of 0,5 mm. The overlay is adjusted by - 0 mm when using a mounting plate with a distance = 0,5 mm.

Cup distance C mm	Overlay mm								
	10	11	12	13	14	15	16	17	18
	Distance D mm								
3	5,5	4,5	3,5	2,5	1,5	0,5			
4	6,5	5,5	4,5	3,5	2,5	1,5	0,5		
5	7,5	6,5	5,5	4,5	3,5	2,5	1,5	0,5	
6	8,5	7,5	6,5	5,5	4,5	3,5	2,5	1,5	0,5

Calculating distance for inset doors

Once the minimum reveal has been defined, the required distance D can be read off in the table for the required door thickness and the required cup distance C. This calculated distance D yields a width of joint between cabinet wall and door edge equal to the minimum reveal as listed in the table of minimum door reveals.

Ideally, door overlay and C dimension are selected to achieve a distance in which a mounting plate is available.

Example: Door thickness 19 mm and cup distance C = 6 mm yield a distance D equal to 3 mm and thus a door reveal of 1 mm (this door reveal corresponds to the minimum reveal as listed in the table of minimum door reveals).

If the calculated distance D differs from the distances available as mounting plates, the difference is compensated by means of the overlay adjustment screw on the hinge arm.

Example: Door thickness = 19 mm and cup distance C = 4 mm yield a distance of 1,0 mm.

Use of a mounting plate with D = 1,5 mm yields a door reveal of 1,5 mm (1,0 mm minimum reveal + 0,5 mm due to the difference between distance D and the mounting plate with D = 1,5 mm).

However, if a door reveal of 1,0 mm is preferred, the gap must be reduced by 0,5 mm.

Distance D increases proportionally if a larger door reveal is required. Example: Door thickness = 19 mm, cup distance C = 6 mm, required door reveal = 2,5 mm. 3 mm distance (yield a minimum reveal of 1,0 mm) + 1,5 mm enlargement (value = required reveal - minimum reveal) = 4,5 mm required distance D. A mounting plate with D = 5 mm is used. The reveal is reduced by 0,5 mm with the aid of the overlay adjusting screw on the hinge arm.

Cup distance C mm	Door thickness mm							
	15	16	17	18	19	20	21	22
	Distance D mm							
3					0,1	0,4	0,9	1,6
4	0,3	0,5	0,6	0,8	1,0	1,3	1,7	2,3
5	1,3	1,4	1,6	1,8	2,0	2,3	2,6	3,1
6	2,3	2,4	2,6	2,8	3,0	3,2	3,6	3,9

Overlay adjustment

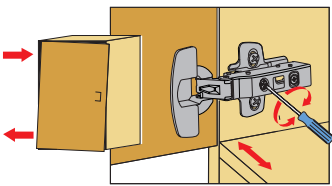

Turn screw clockwise:
Door overlay decreases (-).
Turn screw anticlockwise:
Door overlay increases (+).

Depth adjustment

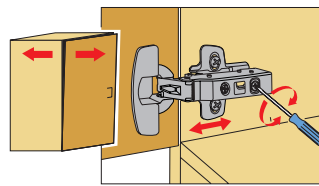

Direct, infinitely variable depth adjustment

Height adjustment

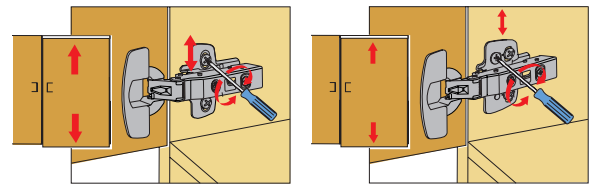

Using height-adjustable mounting plates makes it possible to align the exact door height.

Direct, variable height adjustment with eccentric screw

Assembly

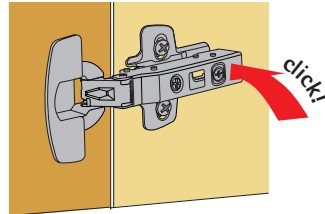
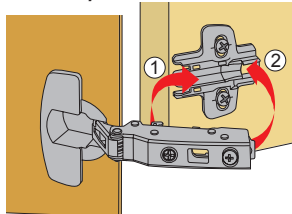

Disassembly

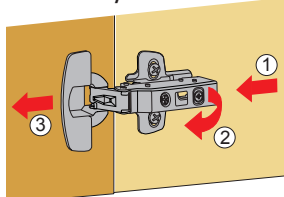

Characteristic for sensys hinges is the ergonomical snap-on assembly. The hinge is slipped into the front of the mounting plate ①, then a light finger pressure and the hinge arm latches onto the mounting plate ② with an audible click.

The hinge arm is now securely clamped, via five points, with zero play. Doors are clipped on zipper style from top to bottom.

Disassembly is carried out in the opposite direction from bottom to top. The hinge is unlatched by pressing lightly on latch ① which is hidden under the side arm for security reasons. In one movement, the hinge arm is lifted off the mounting plate ② and the door is removed from the cabinet ③.

Fast-assembly concealed hinge with integrated soft-close function sensys 8645i Opening angle 110°

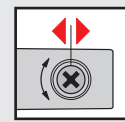
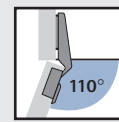

- Concealed hinge for snap-on attachment
- For door thicknesses of 15 - 22 mm
- Cup diameter 35 mm
- With self-closing feature
- Integrated overlay adjustment ± 2 mm
- Integrated depth adjustment $+ 3$ mm / $- 2$ mm
- Height adjustment at mounting plate
- Hinge cup/arm: nickel-plated steel

Cup versions

Cup TH 52
Screw on

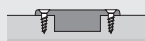

Cup TH 53
Press-in version

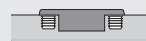

Cup TB 53
Press-in version



Hinge versions

Mounting options

Article/Order no.

Full overlay

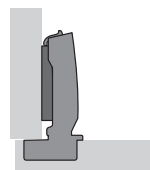

8645i - TH 52
9 071 205

8645i - TH 53
9 071 208

8645i - TB 53
9 071 226

PU
1/200

Half overlay

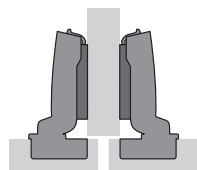

8645i - TH 52
9 071 206

8645i - TH 53
9 071 209

8645i - TB 53
9 071 227

PU
1/200

Inset

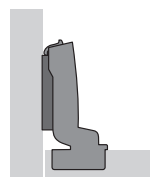

8645i - TH 52
9 071 207

8645i - TH 53
9 071 210

8645i - TB 53
9 071 228

PU
1/200

Hinge-arm cover cap

- Nickel-plated steel



Hinge cup cover cap

- Nickel-plated steel

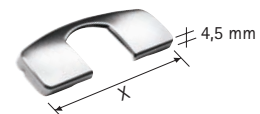

Version	Order no.	PU
without Hettich logo	9 082 612	1/200
with Hettich logo	9 082 774	1/200

Cup version	X mm	Order no.	PU
TH 52 / TH 53	68,2	9 082 614	1/200
TB 53	61,4	9 084 924	1/200



Cup distance C mm	Door thickness mm							
	15	16	17	18	19	20	21	22
Minimum reveal per door – allow for in distance calculation								
Table entries apply to doors with 0 mm radius								
3	0,3	0,5	0,6	0,8	1,1	1,4	1,9	2,6
4	0,3	0,5	0,6	0,8	1,0	1,3	1,7	2,3
4,5	0,3	0,5	0,6	0,8	1,0	1,3	1,7	2,2
5	0,3	0,4	0,6	0,8	1,0	1,3	1,6	2,1
6	0,3	0,4	0,6	0,8	1,0	1,2	1,6	1,9

The minimum reveal is reduced for a door thickness of, for example, 22 mm with radii:
1 mm radius: table entry – 0,4 mm
3 mm radius: table entry – 1,0 mm

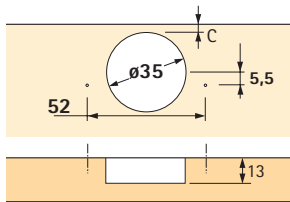

TH 52 hole dimensions

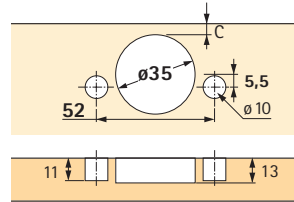

TH 53 hole dimensions

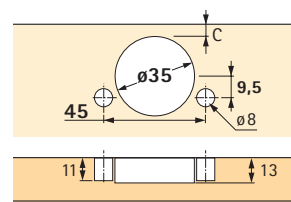

TB 53 hole dimensions

Hinge protrusion H/
door protrusion T
for 0 mm distance
and 3 mm
cup distance

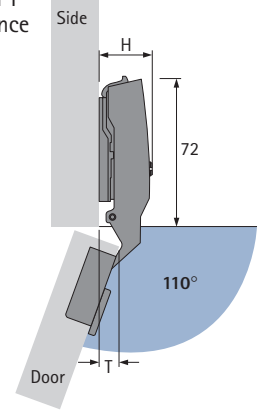

Mounting option	H mm	T mm
Overlay	25,0	8,5
Centre panel	31,0	18,0
Inset door	38,0	25,0

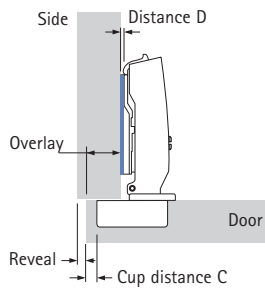

Cup distance C mm	Overlay mm									
	10	11	12	13	14	15	16	17	18	
Distance D mm										
3	5,5	4,5	3,5	2,5	1,5	0,5				
4	6,5	5,5	4,5	3,5	2,5	1,5	0,5			
4,5	7,0	6,0	5,0	4,0	3,0	2,0	1,0			
5	7,5	6,5	5,5	4,5	3,5	2,5	1,5	0,5		
6	8,5	7,5	6,5	5,5	4,5	3,5	2,5	1,5	0,5	

Overlay adjustment ± 2,0 mm

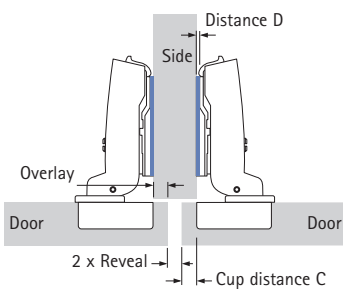

Cup distance C mm	Overlay mm									
	0,5	1,5	2,5	3,5	4,5	5,5	6,5	7,5	8,5	
Distance D mm										
3	5,5	4,5	3,5	2,5	1,5	0,5				
4	6,5	5,5	4,5	3,5	2,5	1,5	0,5			
4,5	7,0	6,0	5,0	4,0	3,0	2,0	1,0			
5	7,5	6,5	5,5	4,5	3,5	2,5	1,5	0,5		
6	8,5	7,5	6,5	5,5	4,5	3,5	2,5	1,5	0,5	

Overlay adjustment ± 2,0 mm

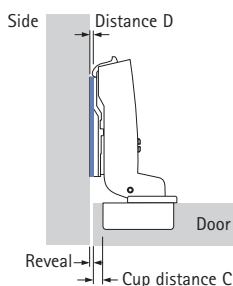

Cup distance C mm	Door thickness mm							
	15	16	17	18	19	20	21	22
Distance D mm								
3					0,1	0,4	0,9	1,6
4	0,3	0,5	0,6	0,8	1,0	1,3	1,7	2,3
4,5	0,8	1,0	1,1	1,3	1,5	1,8	2,2	2,7
5	1,3	1,4	1,6	1,8	2,0	2,3	2,6	3,1
6	2,3	2,4	2,6	2,8	3,0	3,2	3,6	3,9

Reveal adjustment ± 2,0 mm

Mounting plates, see page 36

Technical information, see pages 12 – 13

Fast-assembly concealed hinge with integrated soft-close function
sensys 8645i FIX
Opening angle 110°

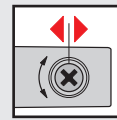
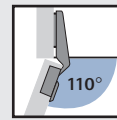
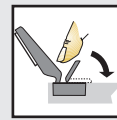

- Concealed hinge for snap-on attachment
- **Toolless cup assembly**
- For door thicknesses of 15 - 22 mm
- Cup diameter 35 mm
- With self-closing feature
- Integrated overlay adjustment ± 2 mm
- Integrated depth adjustment + 3 mm / - 2 mm
- Height adjustment at mounting plate
- Hinge cup/arm: nickel-plated steel

Cup versions

Cup TH 55 FIX
Toolless with pegs

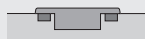

Cup TB 55 FIX
Toolless with pegs



Hinge versions

Mounting options

Article/Order no.

Full overlay

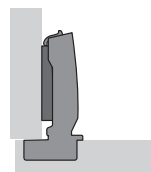

8645i - TH 55 FIX
9 071 220

8645i - TB 55 FIX
9 071 238

PU
1/200

Half overlay

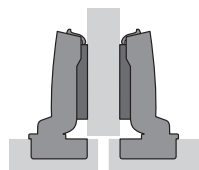

8645i - TH 55 FIX
9 071 221

8645i - TB 55 FIX
9 071 239

PU
1/200

Inset

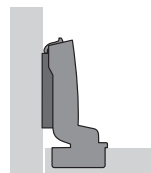

8645i - TH 55 FIX
9 071 222

8645i - TB 55 FIX
9 071 240

PU
1/200

Hinge-arm cover cap

- Nickel-plated steel



Version	Order no.	PU
without Hettich logo	9 082 612	1/200
with Hettich logo	9 082 774	1/200



Cup distance C mm	Door thickness mm							
	15	16	17	18	19	20	21	22
Minimum reveal per door – allow for in distance calculation Table entries apply to doors with 0 mm radius								
3	0,3	0,5	0,6	0,8	1,1	1,4	1,9	2,6
4	0,3	0,5	0,6	0,8	1,0	1,3	1,7	2,3
4,5	0,3	0,5	0,6	0,8	1,0	1,3	1,7	2,2
5	0,3	0,4	0,6	0,8	1,0	1,3	1,6	2,1
6	0,3	0,4	0,6	0,8	1,0	1,2	1,6	1,9

The minimum reveal is reduced for a door thickness of, for example, 22 mm with radii:
1 mm radius: table entry – 0,4 mm
3 mm radius: table entry – 1,0 mm

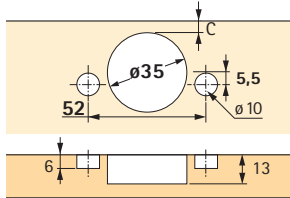

TH 55 FIX hole dimensions

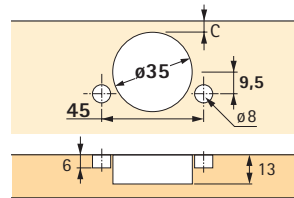

TB 55 FIX hole dimensions

Hinge protrusion H/
door protrusion T
for 0 mm distance
and 3 mm
cup distance

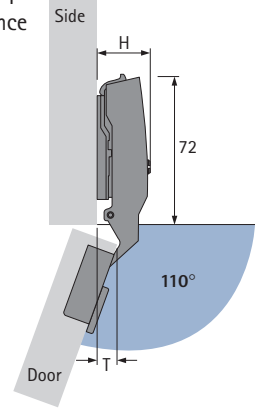

Mounting option	H mm	T mm
Overlay	25,0	8,5
Centre panel	31,0	18,0
Inset door	38,0	25,0

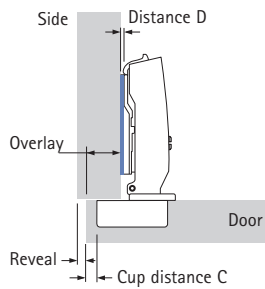

Cup distance C mm	Overlay mm									
	10	11	12	13	14	15	16	17	18	
Distance D mm										
3	5,5	4,5	3,5	2,5	1,5	0,5				
4	6,5	5,5	4,5	3,5	2,5	1,5	0,5			
4,5	7,0	6,0	5,0	4,0	3,0	2,0	1,0			
5	7,5	6,5	5,5	4,5	3,5	2,5	1,5	0,5		
6	8,5	7,5	6,5	5,5	4,5	3,5	2,5	1,5	0,5	

Overlay adjustment ± 2,0 mm

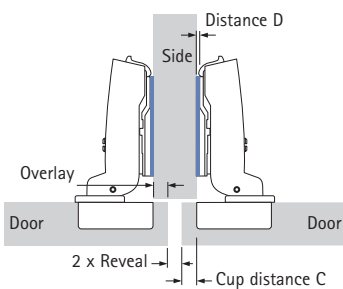

Cup distance C mm	Overlay mm									
	0,5	1,5	2,5	3,5	4,5	5,5	6,5	7,5	8,5	
Distance D mm										
3	5,5	4,5	3,5	2,5	1,5	0,5				
4	6,5	5,5	4,5	3,5	2,5	1,5	0,5			
4,5	7,0	6,0	5,0	4,0	3,0	2,0	1,0			
5	7,5	6,5	5,5	4,5	3,5	2,5	1,5	0,5		
6	8,5	7,5	6,5	5,5	4,5	3,5	2,5	1,5	0,5	

Overlay adjustment ± 2,0 mm

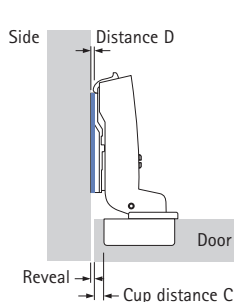

Cup distance C mm	Door thickness mm							
	15	16	17	18	19	20	21	22
Distance D mm								
3					0,1	0,4	0,9	1,6
4	0,3	0,5	0,6	0,8	1,0	1,3	1,7	2,3
4,5	0,8	1,0	1,1	1,3	1,5	1,8	2,2	2,7
5	1,3	1,4	1,6	1,8	2,0	2,3	2,6	3,1
6	2,3	2,4	2,6	2,8	3,0	3,2	3,6	3,9

Reveal adjustment ± 2,0 mm

Mounting plates, see page 36

Technical information, see pages 12 – 13

Fast-assembly concealed hinge with integrated soft-close function sensys 8639i Opening angle 95°

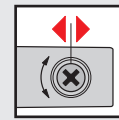
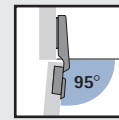

- Concealed hinge for snap-on attachment
- For door thicknesses of 15 - 28 mm
- Cup diameter 35 mm
- With self-closing feature
- Integrated overlay adjustment ± 2 mm
- Integrated depth adjustment $+ 3$ mm / $- 2$ mm
- Height adjustment at mounting plate
- Hinge cup/arm: nickel-plated steel

Cup versions

Cup TH 52
Screw on

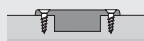

Cup TH 53
Press-in version

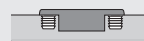

Cup TB 53
Press-in version

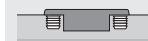

Hinge versions

Mounting options

Article/Order no.

Full overlay

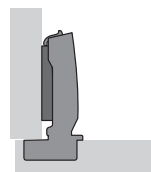

8639i - TH 52
9 084 995

8639i - TH 53
9 084 998

8639i - TB 53
9 085 013

PU
1/200

Half overlay

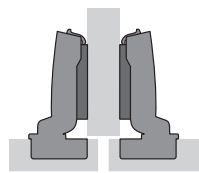

8639i - TH 52
9 084 996

8639i - TH 53
9 084 999

8639i - TB 53
9 085 014

PU
1/200

Inset

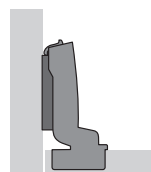

8639i - TH 52
9 084 997

8639i - TH 53
9 085 000

8639i - TB 53
9 085 015

PU
1/200

Hinge-arm cover cap

- Nickel-plated steel



Version	Order no.	PU
without Hettich logo	9 082 612	1/200
with Hettich logo	9 082 774	1/200

Hinge cup cover cap

- Nickel-plated steel

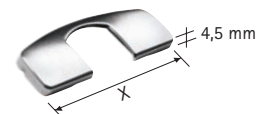

Cup version	X mm	Order no.	PU
TH 52 / TH 53	68,2	9 082 614	1/200
TB 53	61,4	9 084 924	1/200



Cup distance C mm	Door thickness mm													
	15	16	17	18	19	20	21	22	23	24	25	26	27	28
Minimum reveal per door – allow for in distance calculation														
Table entries apply to doors with 0 mm radius														
3	0,3	0,5	0,6	0,8	1,1	1,4	1,9	2,6	3,4	4,3	5,2	6,1	7,0	7,9
4	0,3	0,5	0,6	0,8	1,0	1,3	1,7	2,3	3,0	3,8	4,7	5,5	6,4	7,3
4,5	0,3	0,5	0,6	0,8	1,0	1,3	1,7	2,2	2,9	3,6	4,5	5,3	6,2	7,0
5	0,3	0,4	0,6	0,8	1,0	1,3	1,6	2,1	2,7	3,4	4,2	5,0	5,9	6,7
6	0,3	0,4	0,6	0,8	1,0	1,2	1,6	1,9	2,4	3,1	3,8	4,6	5,4	6,3

The minimum reveal is reduced for a door thickness of, for example, 22 mm with radii:
 1 mm radius: table entry – 0,4 mm
 3 mm radius: table entry – 1,0 mm

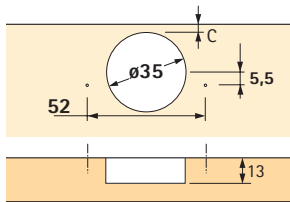

TH 52 hole dimensions

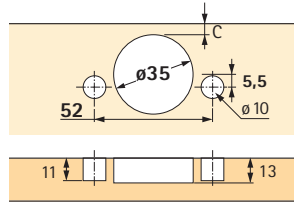

TH 53 hole dimensions

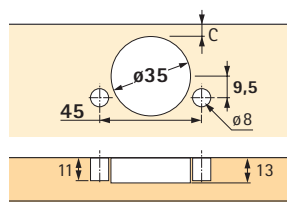

TB 53 hole dimensions

Hinge protrusion H/
door protrusion T
for 0 mm distance
and 3 mm
cup distance

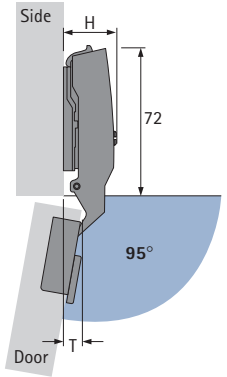

Mounting option	H mm	T mm
Overlay	25,0	7,5
Centre panel	31,0	17,0
Inset door	38,0	24,0

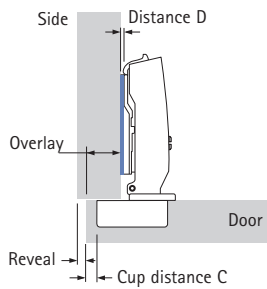

Cup distance C mm	Overlay mm								
	10	11	12	13	14	15	16	17	18
Distance D mm									
3	5,5	4,5	3,5	2,5	1,5	0,5			
4	6,5	5,5	4,5	3,5	2,5	1,5	0,5		
4,5	7,0	6,0	5,0	4,0	3,0	2,0	1,0		
5	7,5	6,5	5,5	4,5	3,5	2,5	1,5	0,5	
6	8,5	7,5	6,5	5,5	4,5	3,5	2,5	1,5	0,5

Overlay adjustment ± 2,0 mm

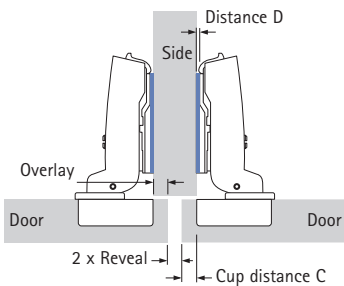

Cup distance C mm	Overlay mm								
	0,5	1,5	2,5	3,5	4,5	5,5	6,5	7,5	8,5
Distance D mm									
3	5,5	4,5	3,5	2,5	1,5	0,5			
4	6,5	5,5	4,5	3,5	2,5	1,5	0,5		
4,5	7,0	6,0	5,0	4,0	3,0	2,0	1,0		
5	7,5	6,5	5,5	4,5	3,5	2,5	1,5	0,5	
6	8,5	7,5	6,5	5,5	4,5	3,5	2,5	1,5	0,5

Overlay adjustment ± 2,0 mm

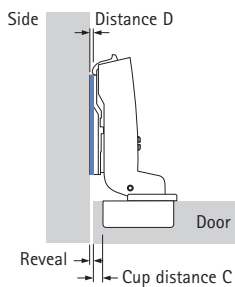

Cup distance C mm	Door thickness mm													
	15	16	17	18	19	20	21	22	23	24	25	26	27	28
Distance D mm														
3					0,1	0,4	0,9	1,6	2,4	3,3	4,2	5,1	6,0	6,9
4	0,3	0,5	0,6	0,8	1,0	1,3	1,7	2,3	3,0	3,8	4,7	5,5	6,4	7,3
4,5	0,8	1,0	1,1	1,3	1,5	1,8	2,2	2,7	3,4	4,1	5,0	5,8	6,7	7,5
5	1,3	1,4	1,6	1,8	2,0	2,3	2,6	3,1	3,7	4,4	5,2	6,0	6,9	7,7
6	2,3	2,4	2,6	2,8	3,0	3,2	3,6	3,9	4,4	5,1	5,8	6,6	7,4	8,3

Reveal adjustment ± 2,0 mm

Mounting plates, see page 36

Technical information, see pages 12 – 13

Fast-assembly concealed hinge with integrated soft-close function
sensys 8639i FIX
Opening angle 95°

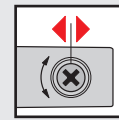
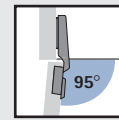
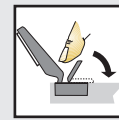

- Concealed hinge for snap-on attachment
- **Toolless cup assembly**
- For door thicknesses of 15 - 28 mm
- Cup diameter 35 mm
- With self-closing feature
- Integrated overlay adjustment ± 2 mm
- Integrated depth adjustment + 3 mm / - 2 mm
- Height adjustment at mounting plate
- Hinge cup/arm: nickel-plated steel

Cup versions

Cup TH 55 FIX
Toolless with pegs

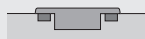

Cup TB 55 FIX
Toolless with pegs



Hinge versions

Mounting options

Article/Order no.

Full overlay

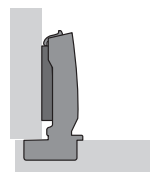

8639i - TH 55 FIX
9 085 103

8639i - TB 55 FIX
9 085 106

PU
1/200

Half overlay

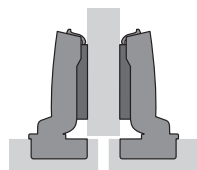

8639i - TH 55 FIX
9 085 104

8639i - TB 55 FIX
9 085 107

PU
1/200

Inset

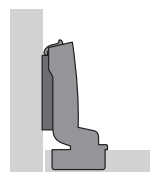

8639i - TH 55 FIX
9 085 105

8639i - TB 55 FIX
9 085 108

PU
1/200

Hinge-arm cover cap

- Nickel-plated steel



Version	Order no.	PU
without Hettich logo	9 082 612	1/200
with Hettich logo	9 082 774	1/200



Cup distance C mm	Door thickness mm													
	15	16	17	18	19	20	21	22	23	24	25	26	27	28
Minimum reveal per door – allow for in distance calculation														
Table entries apply to doors with 0 mm radius														
3	0,3	0,5	0,6	0,8	1,1	1,4	1,9	2,6	3,4	4,3	5,2	6,1	7,0	7,9
4	0,3	0,5	0,6	0,8	1,0	1,3	1,7	2,3	3,0	3,8	4,7	5,5	6,4	7,3
4,5	0,3	0,5	0,6	0,8	1,0	1,3	1,7	2,2	2,9	3,6	4,5	5,3	6,2	7,0
5	0,3	0,4	0,6	0,8	1,0	1,3	1,6	2,1	2,7	3,4	4,2	5,0	5,9	6,7
6	0,3	0,4	0,6	0,8	1,0	1,2	1,6	1,9	2,4	3,1	3,8	4,6	5,4	6,3

The minimum reveal is reduced for a door thickness of, for example, 22 mm with radii:
1 mm radius: table entry – 0,4 mm
3 mm radius: table entry – 1,0 mm

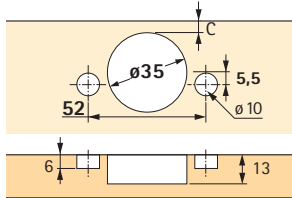

TH 55 FIX hole dimensions

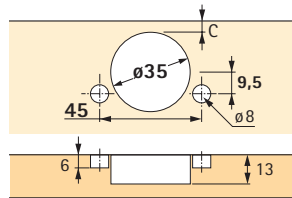

TB 55 FIX hole dimensions

Hinge protrusion H/
door protrusion T
for 0 mm distance
and 3 mm
cup distance

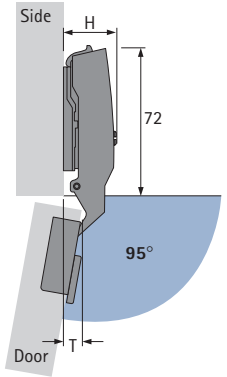

Mounting option	H mm	T mm
Overlay	25,0	7,5
Centre panel	31,0	17,0
Inset door	38,0	24,0

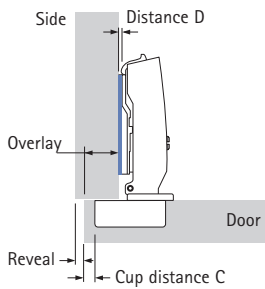

Cup distance C mm	Overlay mm									
	10	11	12	13	14	15	16	17	18	
Distance D mm										
3	5,5	4,5	3,5	2,5	1,5	0,5				
4	6,5	5,5	4,5	3,5	2,5	1,5	0,5			
4,5	7,0	6,0	5,0	4,0	3,0	2,0	1,0			
5	7,5	6,5	5,5	4,5	3,5	2,5	1,5	0,5		
6	8,5	7,5	6,5	5,5	4,5	3,5	2,5	1,5	0,5	

Overlay adjustment ± 2,0 mm

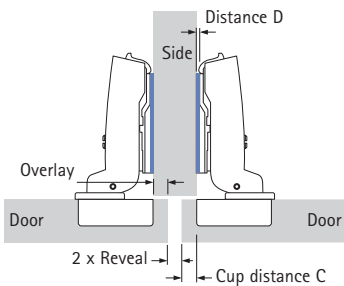

Cup distance C mm	Overlay mm									
	0,5	1,5	2,5	3,5	4,5	5,5	6,5	7,5	8,5	
Distance D mm										
3	5,5	4,5	3,5	2,5	1,5	0,5				
4	6,5	5,5	4,5	3,5	2,5	1,5	0,5			
4,5	7,0	6,0	5,0	4,0	3,0	2,0	1,0			
5	7,5	6,5	5,5	4,5	3,5	2,5	1,5	0,5		
6	8,5	7,5	6,5	5,5	4,5	3,5	2,5	1,5	0,5	

Overlay adjustment ± 2,0 mm

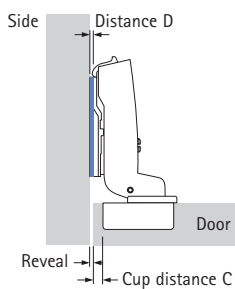

Cup distance C mm	Door thickness mm													
	15	16	17	18	19	20	21	22	23	24	25	26	27	28
Distance D mm														
3					0,1	0,4	0,9	1,6	2,4	3,3	4,2	5,1	6,0	6,9
4	0,3	0,5	0,6	0,8	1,0	1,3	1,7	2,3	3,0	3,8	4,7	5,5	6,4	7,3
4,5	0,8	1,0	1,1	1,3	1,5	1,8	2,2	2,7	3,4	4,1	5,0	5,8	6,7	7,5
5	1,3	1,4	1,6	1,8	2,0	2,3	2,6	3,1	3,7	4,4	5,2	6,0	6,9	7,7
6	2,3	2,4	2,6	2,8	3,0	3,2	3,6	3,9	4,4	5,1	5,8	6,6	7,4	8,3

Reveal adjustment ± 2,0 mm

Mounting plates, see page 36

Technical information, see pages 12 – 13

Fast-assembly concealed hinge with integrated soft-close function sensys 8639i W45 for corner cabinets, opening angle 95°

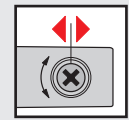
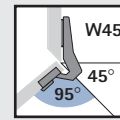

- Concealed hinge for snap-on attachment
- For corner cabinets with 45° face angle
- For door thicknesses of 15 - 28 mm
- Cup diameter 35 mm
- With self-closing feature
- Integrated overlay adjustment ± 2 mm
- Integrated depth adjustment $+ 3$ mm / $- 2$ mm
- Height adjustment at mounting plate
- Hinge cup: nickel-plated zinc die-cast
- Hinge arm: nickel-plated steel

Cup versions

Cup TH 52
Screw on

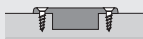

Cup TH 53
Press-in version

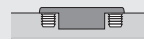

Cup TB 53
Press-in version

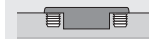

Hinge versions

Mounting options

Article/Order no.

Full overlay

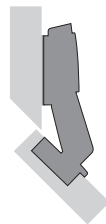

8639i W45 - TH 52
9 085 168

8639i W45 - TH 53
9 085 173

8639i W45 - TB 53
9 085 198

PU
1/200

Inset

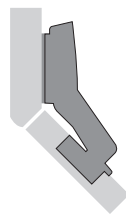

8639i W45 - TH 52
9 085 169

8639i W45 - TH 53
9 085 174

8639i W45 - TB 53
9 085 199

PU
1/200

Mounting examples

sensys 8639i W45
Full overlay

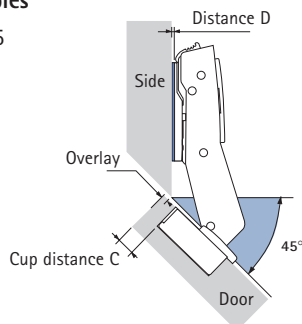

sensys 8639i W45
Inset

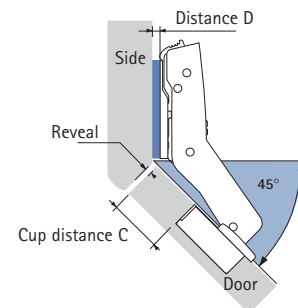

Hinge-arm cover cap

- Nickel-plated steel



Version	Order no.	PU
without Hettich logo	9 082 612	1/200
with Hettich logo	9 082 774	1/200

Hinge cup cover cap

- Nickel-plated steel

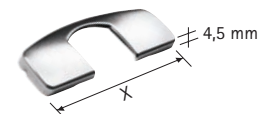

Cup version	X mm	Order no.	PU
TH 52 / TH 53	68,2	9 082 614	1/200
TB 53	61,4	9 084 924	1/200



Cup distance C mm	Door thickness mm													
	15	16	17	18	19	20	21	22	23	24	25	26	27	28
Minimum reveal per door – allow for in distance calculation														
Table entries apply to doors with 0 mm radius														
3	1,7	1,9	2,0	2,2	2,4	2,6	2,8	3,0	3,2	3,4	3,6	3,8	4,1	4,3
4	1,5	1,6	1,8	2,0	2,1	2,3	2,5	2,7	2,9	3,1	3,3	3,5	3,7	4,0
4,5	1,4	1,5	1,7	1,9	2,0	2,2	2,4	2,6	2,8	3,0	3,2	3,4	3,6	3,8
5	1,3	1,4	1,6	1,7	1,9	2,1	2,3	2,4	2,6	2,8	3,0	3,2	3,4	3,6
6	1,1	1,2	1,4	1,5	1,7	1,9	2,0	2,2	2,4	2,6	2,7	2,9	3,1	3,3

The minimum reveal is reduced for a door thickness of, for example, 22 mm with radii:
 1 mm radius: table entry – 0,4 mm
 3 mm radius: table entry – 1,0 mm

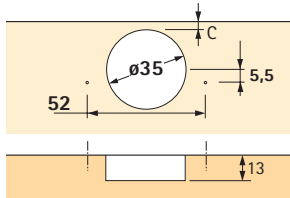

TH 52 hole dimensions

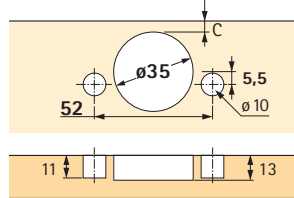

TH 53 hole dimensions

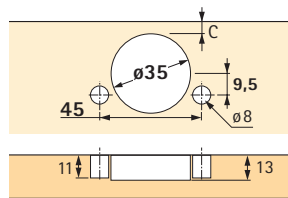

TB 53 hole dimensions

Note:

Drawings on this page are to full scale and show the hinges plus mounting plate distances.

By drawing in the required cup distance C (3 - 6 mm), the door overlay can be measured directly from the applicable distance line.

The distance from the cabinet front edge to X on the selected distance line is also equal to the hole line distance from the cabinet front edge.

For inset-mounted doors, the cup distance and door thickness must be taken into account when determining the minimum reveal.

Full overlay

Overlay adjustment ± 2,0 mm

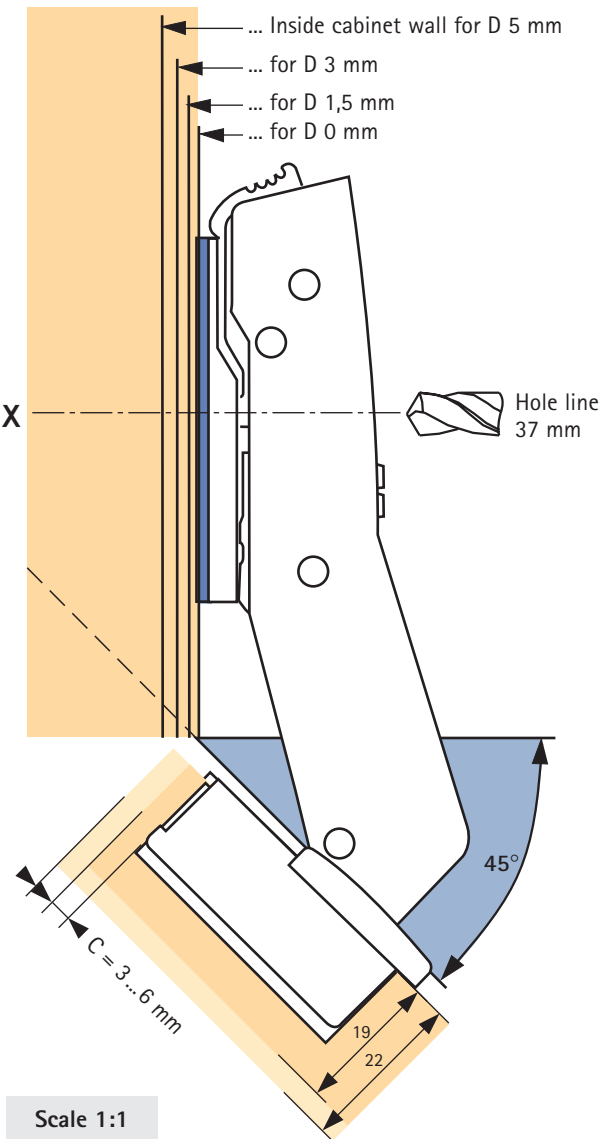

Scale 1:1

Inset

Reveal adjustment ± 2,0 mm

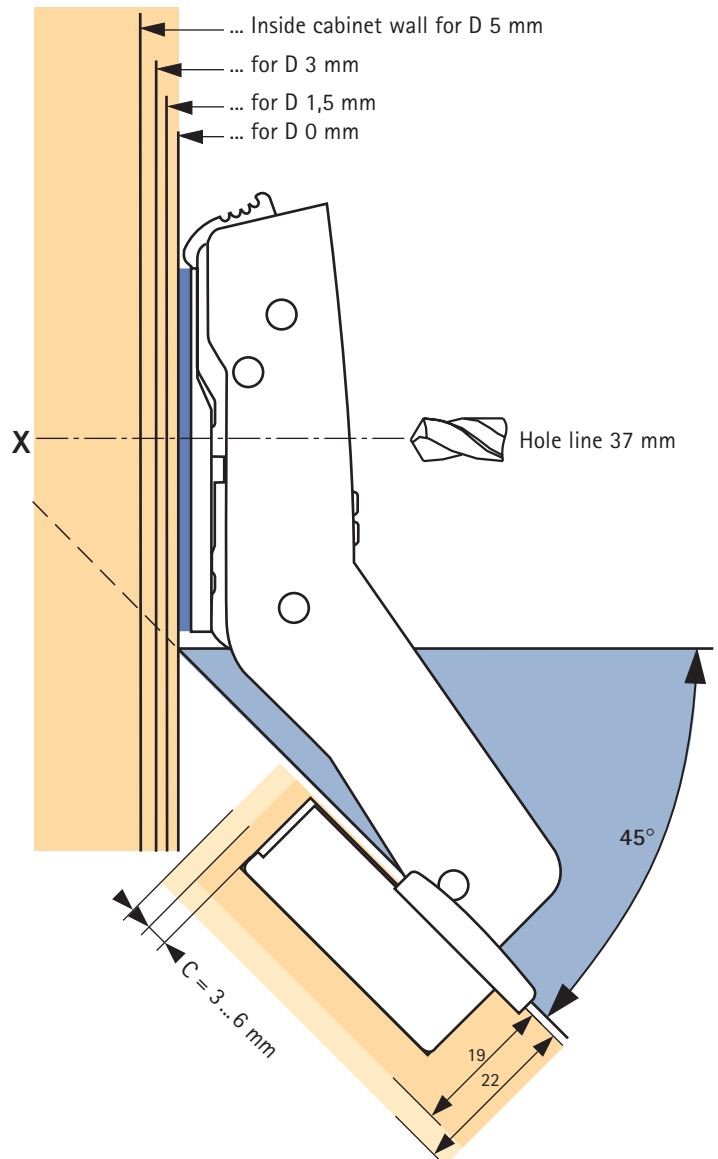

Mounting plates, see page 36

Technical information, see pages 12 - 13

Fast-assembly concealed hinge with integrated soft-close function sensys 8639i W45 FIX for corner cabinets, opening angle 95°

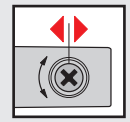
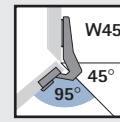
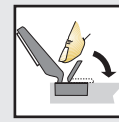

- Concealed hinge for snap-on attachment
- **Toolless cup assembly**
- For corner cabinets with 45° face angle
- For door thicknesses of 15 - 28 mm
- Cup diameter 35 mm
- With self-closing feature
- Integrated overlay adjustment ± 2 mm
- Integrated depth adjustment $+ 3$ mm / $- 2$ mm
- Height adjustment at mounting plate
- Hinge cup: nickel-plated zinc die-cast
- Hinge arm: nickel-plated steel

Cup versions

Cup TH 55 FIX
Toolless with pegs

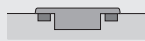

Cup TB 55 FIX
Toolless with pegs



Hinge versions

Mounting options

Article/Order no.

Full overlay

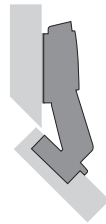

8639i W45 - TH 55 FIX
9 085 338

8639i W45 - TB 55 FIX
9 085 343

PU
1/200

Inset

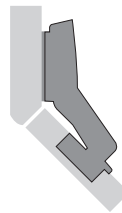

8639i W45 - TH 55 FIX
9 085 339

8639i W45 - TB 55 FIX
9 085 344

PU
1/200

Mounting examples

sensys 8639i W45 FIX
Full overlay

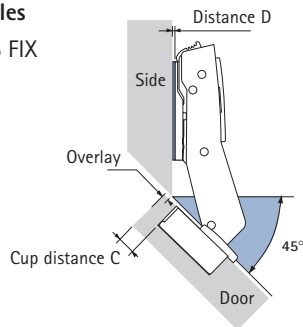

sensys 8639i W45 FIX
Inset

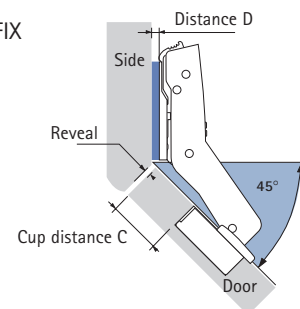

Hinge-arm cover cap

- Nickel-plated steel



Version	Order no.	PU
without Hettich logo	9 082 612	1/200
with Hettich logo	9 082 774	1/200



Cup distance C mm	Door thickness mm													
	15	16	17	18	19	20	21	22	23	24	25	26	27	28
Minimum reveal per door – allow for in distance calculation														
Table entries apply to doors with 0 mm radius														
3	1,7	1,9	2,0	2,2	2,4	2,6	2,8	3,0	3,2	3,4	3,6	3,8	4,1	4,3
4	1,5	1,6	1,8	2,0	2,1	2,3	2,5	2,7	2,9	3,1	3,3	3,5	3,7	4,0
4,5	1,4	1,5	1,7	1,9	2,0	2,2	2,4	2,6	2,8	3,0	3,2	3,4	3,6	3,8
5	1,3	1,4	1,6	1,7	1,9	2,1	2,3	2,4	2,6	2,8	3,0	3,2	3,4	3,6
6	1,1	1,2	1,4	1,5	1,7	1,9	2,0	2,2	2,4	2,6	2,7	2,9	3,1	3,3

The minimum reveal is reduced for a door thickness of, for example, 22 mm with radii:
1 mm radius: table entry – 0,4 mm
3 mm radius: table entry – 1,0 mm

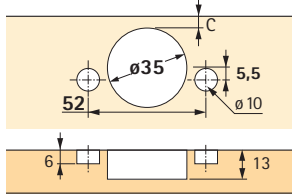

TH 55 FIX hole dimensions

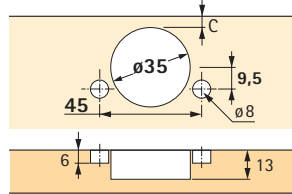

TB 55 FIX hole dimensions

Note:

Drawings on this page are to full scale and show the hinges plus mounting plate distances.

By drawing in the required cup distance C (3 - 6 mm), the door overlay can be measured directly from the applicable distance line.

The distance from the cabinet front edge to X on the selected distance line is also equal to the hole line distance from the cabinet front edge.

For inset-mounted doors, the cup distance and door thickness must be taken into account when determining the minimum reveal.

Full overlay

Overlay adjustment ± 2,0 mm

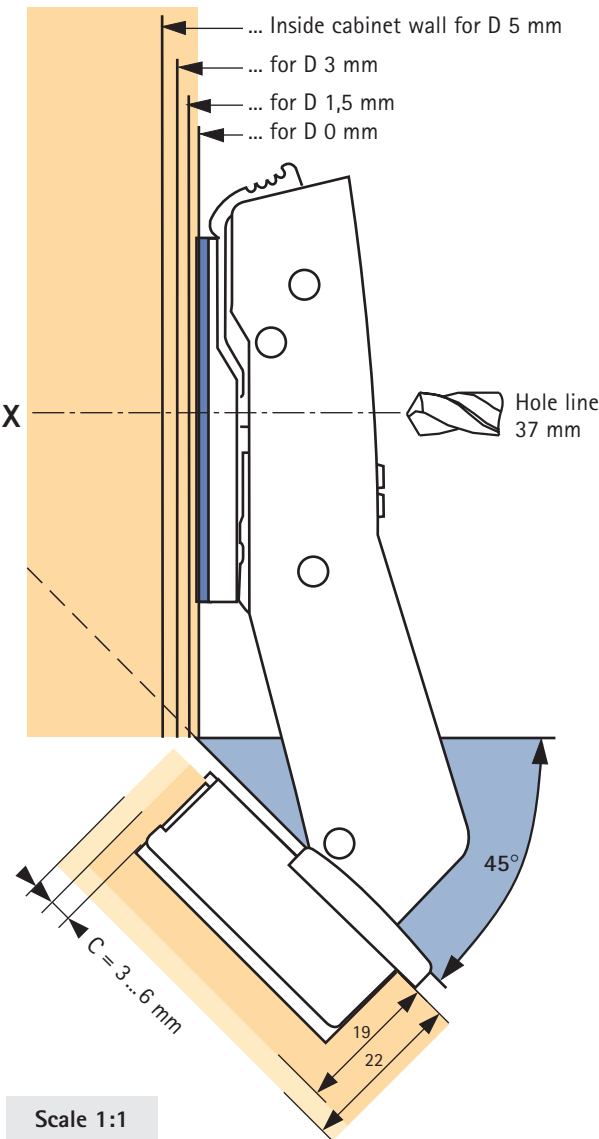

Scale 1:1

Inset

Reveal adjustment ± 2,0 mm

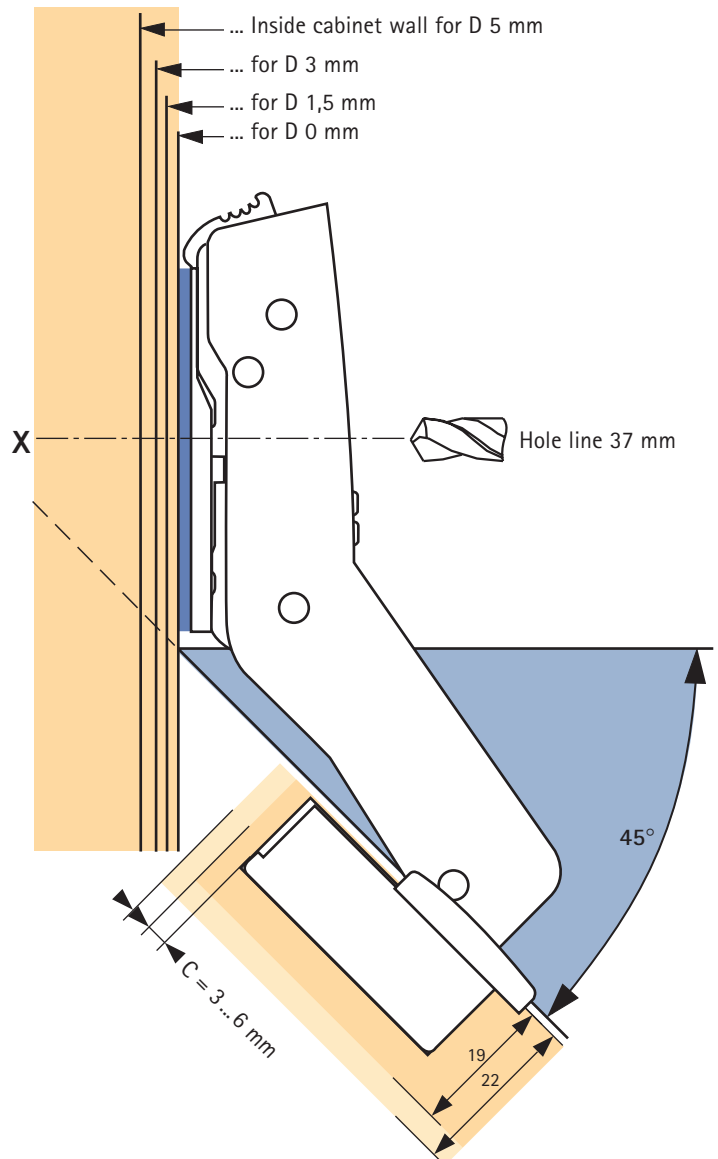

Mounting plates, see page 36

Technical information, see pages 12 - 13

Fast-assembly concealed hinge with integrated soft-close function sensys 8639i W90 for face frame cabinets, opening angle 95°

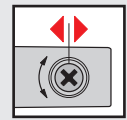
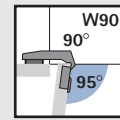

- Concealed hinge for snap-on attachment
- For door thicknesses of 15 - 28 mm
- Cup diameter 35 mm
- With self-closing feature
- Integrated door protrusion adjustment + 1 mm / - 2 mm
- Integrated reveal adjustment + 3 mm / - 2 mm
- Height adjustment at mounting plate
- Hinge cup: nickel-plated zinc die-cast
- Hinge arm: nickel-plated steel

Cup versions

Cup TH 52
Screw on

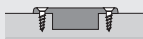

Cup TH 53
Press-in version

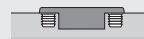

Cup TB 53
Press-in version

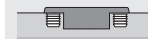

Hinge versions



Mounting options

Inset

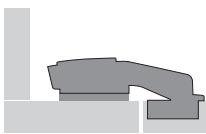

Article/Order no.

8639i W90 - TH 52
9 085 170

8639i W90 - TH 53
9 085 175

8639i W90 - TB 53
9 085 200

PU
1/200

Hinge-arm cover cap

- Nickel-plated steel



Version	Order no.	PU
without Hettich logo	9 082 612	1/200
with Hettich logo	9 082 774	1/200

Hinge cup cover cap

- Nickel-plated steel

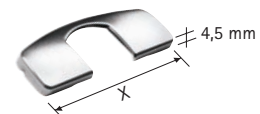

Cup version	X mm	Order no.	PU
TH 52 / TH 53	68,2	9 082 614	1/200
TB 53	61,4	9 084 924	1/200



Cup distance C mm	Door thickness mm													
	15	16	17	18	19	20	21	22	23	24	25	26	27	28
Minimum reveal per door – allow for in distance calculation														
Table entries apply to doors with 0 mm radius														
3	0,3	0,5	0,6	0,8	1,1	1,4	1,9	2,6	3,4	4,3	5,2	6,1	7,0	7,9
4	0,3	0,5	0,6	0,8	1,0	1,3	1,7	2,3	3,0	3,8	4,7	5,5	6,4	7,3
4,5	0,3	0,5	0,6	0,8	1,0	1,3	1,7	2,2	2,9	3,6	4,5	5,3	6,2	7,0
5	0,3	0,4	0,6	0,8	1,0	1,3	1,6	2,1	2,7	3,4	4,2	5,0	5,9	6,7
6	0,3	0,4	0,6	0,8	1,0	1,2	1,6	1,9	2,4	3,1	3,8	4,6	5,4	6,3

The minimum reveal is reduced for a door thickness of, for example, 22 mm with radii:
 1 mm radius: table entry – 0,4 mm
 3 mm radius: table entry – 1,0 mm

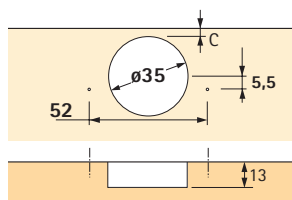

TH 52 hole dimensions

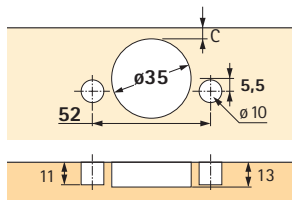

TH 53 hole dimensions

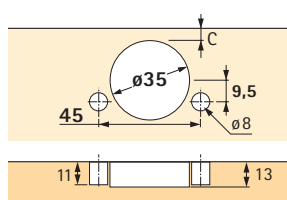

TB 53 hole dimensions

Mounting example

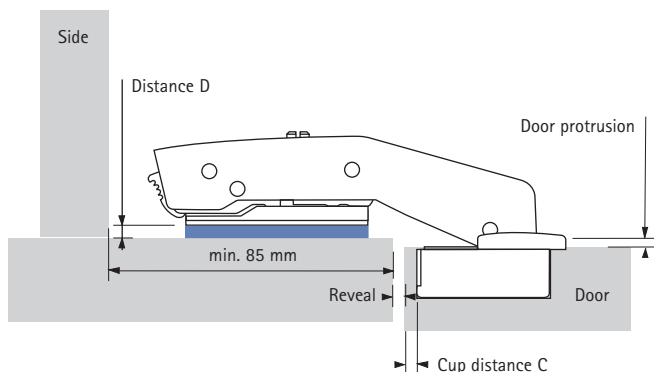

Calculating distance

$$\text{Distance} = 4 \text{ mm} - \text{Door protrusion}$$

The hinges are correctly adjusted on leaving the factory. Door offset can be corrected as necessary. Turn screw (A) clockwise/anticlockwise: Door offset can be adjusted by ± 2 mm. A larger door offset can be achieved by selecting a different mounting plate.

The back of the door and front panel will be flush if a mounting plate with a distance of 3 mm is used and the door offset is adjusted by - 1 mm.

* The hole distance X, cup distance C and the reveal must always add up to 38,5!

$$X + \text{Cup distance C} + \text{Reveal} = 38,5$$

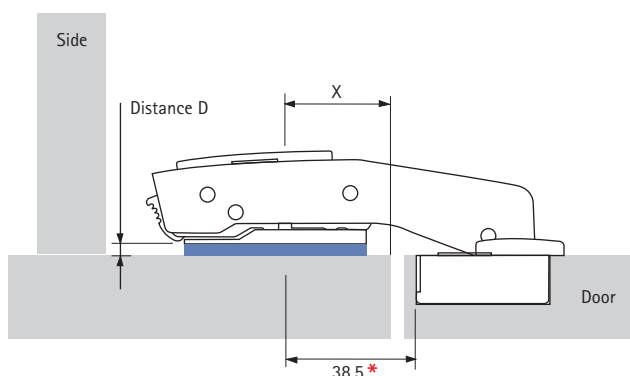

Calculating hole distance "X"

Cup distance C mm	Reveal mm							
	0,5	1,0	1,5	2,0	2,5	3,0	3,5	4,0
3	35,0	34,5	34,0	33,5	33,0	32,5	32,0	31,5
3,5	34,5	34,0	33,5	33,0	32,5	32,0	31,5	31,0
4	34,0	33,5	33,0	32,5	32,0	31,5	31,0	30,5
4,5	33,5	33,0	32,5	32,0	31,5	31,0	30,5	30,0
5	33,0	32,5	32,0	31,5	31,0	30,5	30,0	29,5
5,5	32,5	32,0	31,5	31,0	30,5	30,0	29,5	29,0
6	32,0	31,5	31,0	30,5	30,0	29,5	29,0	28,5

Mounting plates, see page 36

Technical information, see pages 12 – 13

**Fast-assembly concealed hinge with integrated soft-close function
sensys 8639i W90 FIX
for face frame cabinets, opening angle 95°**

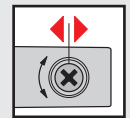
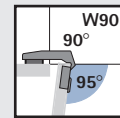
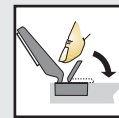

- Concealed hinge for snap-on attachment
- **Toolless cup assembly**
- For door thicknesses of 15 - 28 mm
- Cup diameter 35 mm
- With self-closing feature
- Integrated door protrusion adjustment + 1 mm / - 2 mm
- Integrated reveal adjustment + 3 mm / - 2 mm
- Height adjustment at mounting plate
- Hinge cup: nickel-plated zinc die-cast
- Hinge arm: nickel-plated steel

Cup versions

Cup TH 55 FIX
Toolless with pegs

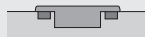

Cup TB 55 FIX
Toolless with pegs



Hinge versions



Mounting options

Inset

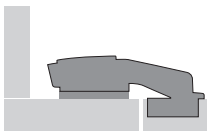

Article/Order no.

8639i W90 - TH 55 FIX
9 085 340

8639i W90 - TB 55 FIX
9 085 345

PU
1/200

Hinge-arm cover cap

- Nickel-plated steel



Version	Order no.	PU
without Hettich logo	9 082 612	1/200
with Hettich logo	9 082 774	1/200



Cup distance C mm	Door thickness mm													
	15	16	17	18	19	20	21	22	23	24	25	26	27	28
Minimum reveal per door – allow for in distance calculation														
Table entries apply to doors with 0 mm radius														
3	0,3	0,5	0,6	0,8	1,1	1,4	1,9	2,6	3,4	4,3	5,2	6,1	7,0	7,9
4	0,3	0,5	0,6	0,8	1,0	1,3	1,7	2,3	3,0	3,8	4,7	5,5	6,4	7,3
4,5	0,3	0,5	0,6	0,8	1,0	1,3	1,7	2,2	2,9	3,6	4,5	5,3	6,2	7,0
5	0,3	0,4	0,6	0,8	1,0	1,3	1,6	2,1	2,7	3,4	4,2	5,0	5,9	6,7
6	0,3	0,4	0,6	0,8	1,0	1,2	1,6	1,9	2,4	3,1	3,8	4,6	5,4	6,3

The minimum reveal is reduced for a door thickness of, for example, 22 mm with radii:
 1 mm radius: table entry – 0,4 mm
 3 mm radius: table entry – 1,0 mm

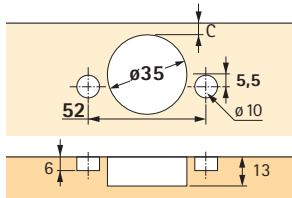

TH 55 FIX hole dimensions

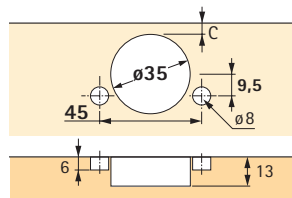

TB 55 FIX hole dimensions

Mounting example

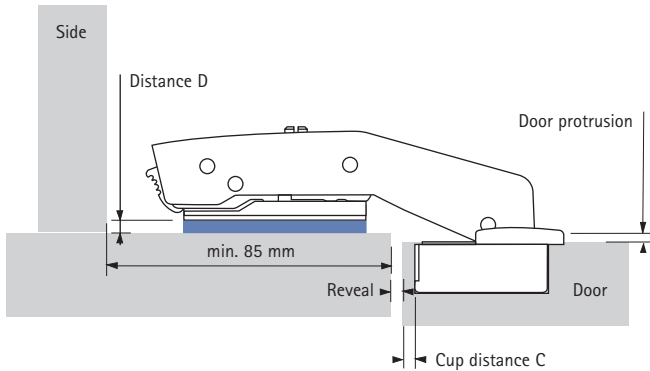

Calculating distance

$$\text{Distance} = 4 \text{ mm} - \text{Door protrusion}$$

The hinges are correctly adjusted on leaving the factory. Door offset can be corrected as necessary. Turn screw (A) clockwise/anticlockwise: Door offset can be adjusted by ± 2 mm. A larger door offset can be achieved by selecting a different mounting plate.

The back of the door and front panel will be flush if a mounting plate with a distance of 3 mm is used and the door offset is adjusted by – 1 mm.

* The hole distance X, cup distance C and the reveal must always add up to 38,5!

$$X + \text{Cup distance C} + \text{Reveal} = 38,5$$

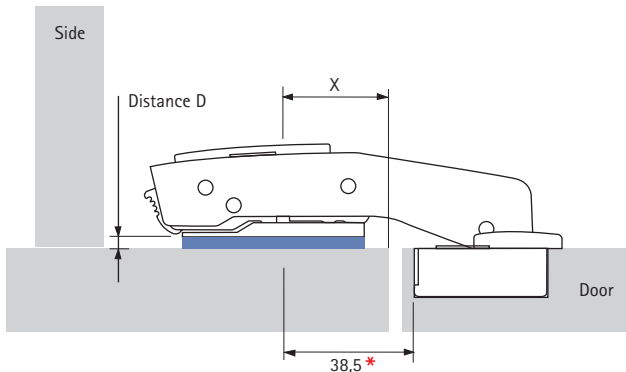

Calculating hole distance "X"

Cup distance C mm	Reveal mm							
	0,5	1,0	1,5	2,0	2,5	3,0	3,5	4,0
3	34,5	34,0	33,5	33,0	32,5	32,0	32	31,5
3,5	34,5	34,0	33,5	33,0	32,5	32,0	31,5	31,0
4	34,0	33,5	33,0	32,5	32,0	31,5	31,0	30,5
4,5	33,5	33,0	32,5	32,0	31,5	31,0	30,5	30,0
5	33,0	32,5	32,0	31,5	31,0	30,5	30,0	29,5
5,5	32,5	32,0	31,5	31,0	30,5	30,0	29,5	29,0
6	32,0	31,5	31,0	30,5	30,0	29,5	29,0	28,5

The sensys mounting plate multi-compatible



The compatibility advantage

sensys mounting plates can also be used with all Intermat fast-assembly hinges. For furniture manufacturers and especially kitchen manufacturers this means cost savings thanks to a leaner production process. The same mounting plate can be used for all the cabinets in different product ranges and price categories. Differentiation, through selecting hinges with different features, takes place only towards the end of the production process.

This represents a significant gain in flexibility for manufacturers. The new mounting plate makes it easier to offer optional, integrated or no dampening in line with pricing policy for each product range. It's also easy to upgrade a product already in production at short notice, eg, for special marketing campaigns. In addition, all of the mounting options in the Intermat hinge range can be used to expand the sensys hinge range.



sensys with integrated
Silent System dampening



Intermat with optional
Silent System dampening



Intermat without dampening

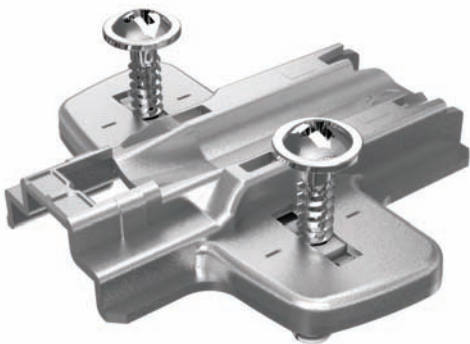

Fast-assembly concealed hinge Intermat 9956 Opening angle 165° - 130°

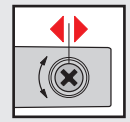
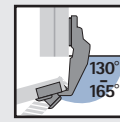

- Concealed hinge for snap-on attachment
- Silent System snap-on door buffer, needs to be ordered separately, see below
- Door thickness from 15 mm
- Cup diameter 35 mm
- With self-closing feature
- Ideal reveals (hairline reveal)
- No door protrusion, i.e. unobstructed interior for pull-outs
- Opening angle can be reduced to 130° by infinitely variable amounts (for adjusting screw, see page below)
- Integrated overlay adjustment + 1 mm / - 2,5 mm
- Integrated depth adjustment ± 2 mm
- Height adjustment at mounting plate
- Hinge cup/arm: nickel-plated steel

Cup versions

Cup TH 52
Screw on

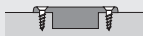

Cup TH 53
Press-in version

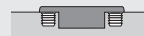

Cup TB 53
Press-in version

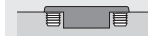

Hinge versions

Mounting options

Article/Order no.

Full overlay



9956 - TH 52
9 084 697

9956 - TH 53
9 084 701

9956 - TB 53
9 084 729

PU
1/100

Half overlay



9956 - TH 52
9 084 698

9956 - TH 53
9 084 702

9956 - TB 53
9 084 730

PU
1/100

Opening angle 165° - the M5x11,6 mm adjusting screw can be used for reducing the opening angle to 130° by infinitely variable amounts.



Clip-on door buffer Silent System for Interimat 9956 TH 52/53 and TB 53

- Can be used for overlay and half-overlay applications
- Dampening effect infinitely adjustable at setting wheel
- Toolless assembly and disassembly
- Can be retrofitted

Order no.	PU
9 084 643	1/100

Adjustment screw M5x11,6 mm

- Nickel-plated steel



Order no.	PU
9 084 648	1/200

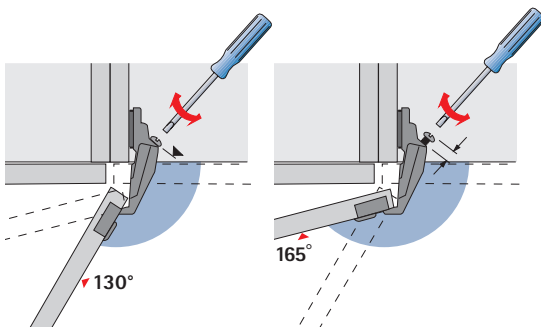



Cup distance C mm	Door thickness mm								
	16	17	18	19	20	21	22	23	24
	Minimum reveal per door								
3	0	0	0	0	0	0	0	0	0
4	0	0	0	0	0	0	0	0	0
4,5	0	0	0	0	0	0	0	0	0
5	0	0	0	0	0	0	0	0	0
6	0	0	0	0	0	0	0	0	4,5

No door protrusion T for 0 mm distance and 3 mm cup distance, unrestricted space for pullouts.

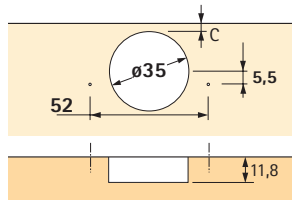
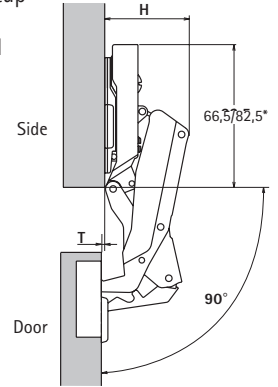

TH 52 hole dimensions

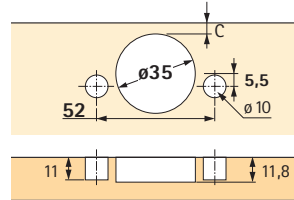

TH 53 hole dimensions

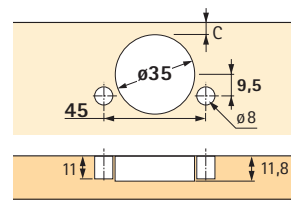

TB 53 hole dimensions

Mounting options	H mm	T mm
Overlay	58,5/66,5*	-0,8
Centre panel	68,0/75,5*	8,7

*with damping

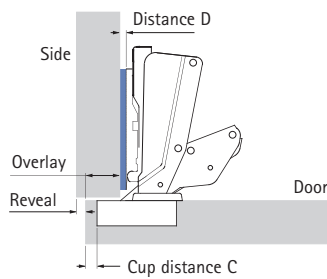

Cup distance C mm	Overlay mm								
	10	11	12	13	14	15	16	17	18
	Distance D mm								
3	5,5	4,5	3,5	2,5	1,5	0,5			
4	6,5	5,5	4,5	3,5	2,5	1,5	0,5		
4,5	7,0	6,0	5,0	4,0	3,0	2,0	1,0	0,0	
5	7,5	6,5	5,5	4,5	3,5	2,5	1,5	0,5	
6	8,5	7,5	6,5	5,5	4,5	3,5	2,5	1,5	0,5

Overlay adjustment + 1 mm / - 2,5 mm

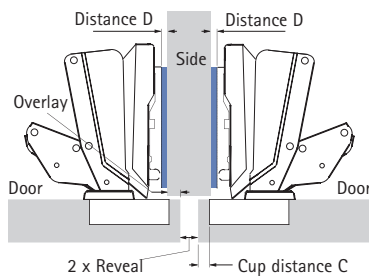

Cup distance C mm	Overlay mm								
	0	1	2	3	4	5	6	7	8
	Distance D mm								
3	6,0	5,0	4,0	3,0	2,0	1,0	0,0		
4	7,0	6,0	5,0	4,0	3,0	2,0	1,0	0,0	
4,5	7,5	6,5	5,5	4,5	3,5	2,5	1,5	0,5	
5	8,0	7,0	6,0	5,0	4,0	3,0	2,0	1,0	0,0
6	9,0	8,0	7,0	6,0	5,0	4,0	3,0	2,0	1,0

Overlay adjustment + 1 mm / - 2,5 mm

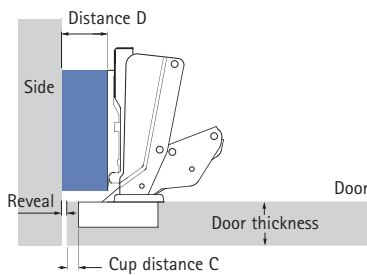

Cup distance C mm	Reveal 1 mm	
	Distance D mm	Hole-line position for inset mounting = 37 mm + door thickness + 1 mm
3	8,0	
4	9,0	
4,5	9,5	
5	10,0	
6	11,0	

Reveal adjustment + 2,5 mm / - 1 mm

For internal application: Use half overlay hinge on an 8 mm standard Intermat mounting plate.

Mounting plates, see page 36

Technical information, see pages 12 - 13

Fast-assembly concealed hinge Intermat 9956 FIX Opening angle 165° - 130°

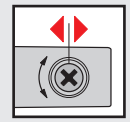
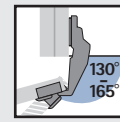
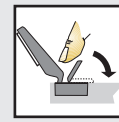

- Concealed hinge for snap-on attachment
- **Toolless cup assembly**
- Silent System snap-on door buffer, needs to be ordered separately, see below
- Door thickness from 15 mm
- Cup diameter 35 mm
- With self-closing feature
- Ideal reveals (hairline reveal)
- No door protrusion, i.e. unobstructed interior for pull-outs
- Opening angle can be reduced to 130° by infinitely variable amounts (for adjusting screw, see page below)
- Integrated overlay adjustment + 1 mm / - 2,5 mm
- Integrated depth adjustment ± 2 mm
- Height adjustment at mounting plate
- Hinge cup/arm: nickel-plated steel

Cup versions

Cup TH 55 FIX
Toolless with pegs

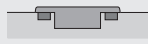

Cup TB 55 FIX
Toolless with pegs



Hinge versions

Mounting options

Article/Order no.

Full overlay



9956 - TH 55 FIX
9 084 777

9956 - TB 55 FIX
9 084 781

PU
1/100

Half overlay

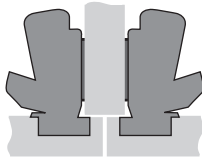

9956 - TH 55 FIX
9 084 778

9956 - TB 55 FIX
9 084 782

PU
1/100

Opening angle 165° – the M5x11,6 mm adjusting screw can be used for reducing the opening angle to 130° by infinitely variable amounts.



Clip-on door buffer Silent System for Interimat 9956 TH 55 and TB 55 FIX

- Can be used for overlay and half-overlay applications
- Dampening effect infinitely adjustable at setting wheel
- Toolless assembly and disassembly
- Can be retrofitted

Order no.	PU
9 084 643	1/100

Adjustment screw M5x11,6 mm

- Nickel-plated steel



Order no.	PU
9 084 648	1/200

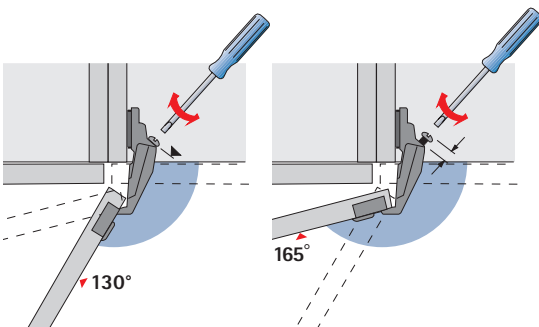



Cup distance C mm	Door thickness mm								
	16	17	18	19	20	21	22	23	24
Minimum reveal per door									
3	0	0	0	0	0	0	0	0	0
4	0	0	0	0	0	0	0	0	0
4,5	0	0	0	0	0	0	0	0	0
5	0	0	0	0	0	0	0	0	0
6	0	0	0	0	0	0	0	0	4,5

The minimum reveal for doors up to 19 mm thick is 0 mm. A trial assembly is recommended for doors thicker than 19 mm (max. door thickness 25 mm).

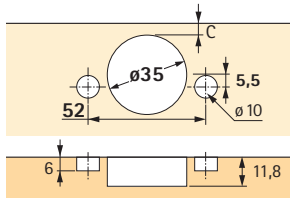

TH 55 FIX hole dimensions

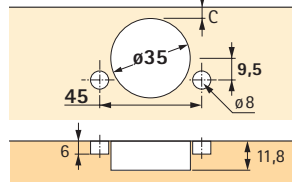

TB 55 FIX hole dimensions

No door protrusion T for 0 mm distance and 3 mm cup distance, unrestricted runner movement.

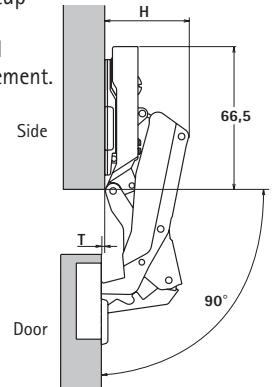

Mounting option	H mm	T mm
Overlay	58,5	-0,8
Centre panel	68,0	8,7

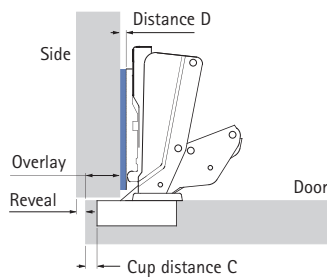

Cup distance C mm	Overlay mm								
	10	11	12	13	14	15	16	17	18
Distance D mm									
3	5,5	4,5	3,5	2,5	1,5	0,5			
4	6,5	5,5	4,5	3,5	2,5	1,5	0,5		
4,5	7,0	6,0	5,0	4,0	3,0	2,0	1,0	0,0	
5	7,5	6,5	5,5	4,5	3,5	2,5	1,5	0,5	
6	8,5	7,5	6,5	5,5	4,5	3,5	2,5	1,5	0,5

Overlay adjustment + 1 mm / - 2,5 mm

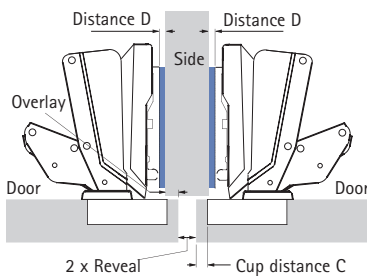

Cup distance C mm	Overlay mm								
	0	1	2	3	4	5	6	7	8
Distance D mm									
3	6,0	5,0	4,0	3,0	2,0	1,0	0,0		
4	7,0	6,0	5,0	4,0	3,0	2,0	1,0	0,0	
4,5	7,5	6,5	5,5	4,5	3,5	2,5	1,5	0,5	
5	8,0	7,0	6,0	5,0	4,0	3,0	2,0	1,0	0,0
6	9,0	8,0	7,0	6,0	5,0	4,0	3,0	2,0	1,0

Overlay adjustment + 1 mm / - 2,5 mm

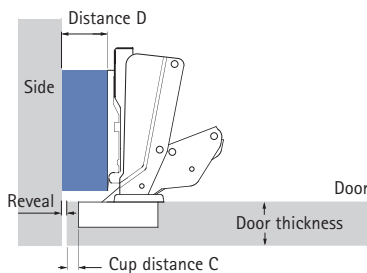





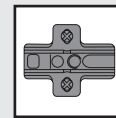

Cup distance C mm	Reveal 1 mm	
	Distance D mm	Hole-line position for inset mounting = 37 mm + door thickness + 1 mm
3	8,0	
4	9,0	
4,5	9,5	
5	10,0	
6	11,0	

Reveal adjustment + 2,5 mm / - 1 mm

For internal application: Use half overlay hinge on an 8 mm standard Intermat mounting plate.

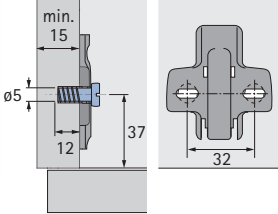
Mounting plate System 8099 for sensys and Intermat hinges

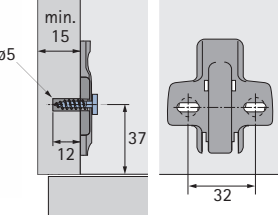

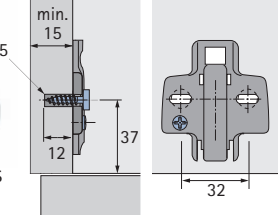
Article	Distance Hole line mm	Distance mm	Order no.	PU
Screw-on cross mounting plate <ul style="list-style-type: none"> • Possible from 15 mm side panel thickness • Hole distance 32 mm • With premounted Euro screws for $\varnothing 5 \times 12$ mm holes • Elongated holes for height adjustment ± 3 mm • Nickel-plated steel  	37	0,0	9 071 625	1/200
		1,5	9 071 626	1/200
		3,0	9 071 627	1/200
		5,0	9 071 628	1/200
Screw-on cross mounting plate <ul style="list-style-type: none"> • Possible from 15 mm side panel thickness • Hole distance 32 mm • With special premounted screws and plastic sockets for drilling $\varnothing 5 \times 12$ mm drill holes • Elongated holes for height adjustment $\pm 2,5$ mm • Nickel-plated steel  	37	0,0	9 071 595	1/200
		1,5	9 071 596	1/200
		3,0	9 071 597	1/200
		5,0	9 071 598	1/200
Screw-on cross mounting plate Hettich Top for full overlay applications <ul style="list-style-type: none"> • Possible from 15 mm side panel thickness • Hole distance 32 mm • With special premounted screws and plastic sockets for drilling $\varnothing 5 \times 12$ mm drill holes • Eccentric height adjustment ± 2 mm • Nickel-plated steel  	37	0,0	9 071 655	1/200
		1,5	9 071 656	1/200
		3,0	9 071 657	1/200
		5,0	9 071 658	1/200

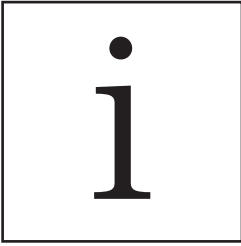

Information

3.10 - 3.15



Intermat 9943 / 9943 FIX

Opening angle 110°

3.16



Intermat 9944 / 9944 FIX

Opening angle 125°

3.18



Intermat 9956 / 9956 FIX

Opening angle 120° - 165°

3.19



Intermat 9936 / 9936 FIX

Opening angle 95°
for profile doors up to 32 mm

3.20



Intermat 9935

Opening angle 95°
for profile doors up to 43 mm

3.21



**Intermat 9936 W20 /
9936 W20 FIX**

Opening angle 95°
for cabinet face angle 20°

3.22



**Intermat 9936 W30 /
9936 W30 FIX**

Opening angle 95°
for cabinet face angle 30°

3.23



**Intermat 9936 W45 /
9936 W45 FIX**

Opening angle 95°
for cabinet face angle 45°

3.24



**Intermat 9936 W90 /
9936 W90 FIX**

Opening angle 95°
for cabinets with blind panels 90°

3.25



**Intermat 9944 W -30 /
9944 W -30 FIX**

Opening angle 125°
for negative cabinet angle - 30°

3.26



**Intermat 9944 W -45 /
9944 W -45 FIX**

Opening angle 125°
for negative cabinet angle - 45°

3.27



Intermat 9904

Opening angle 95°
for glass doors

3.29



Intermat 9931

Opening angle 50°/90°
for corner cabinet folding doors

3.31 - 3.32



Silent System

Dampening closing mechanism
for Intermat hinges

3.4 - 3.9



Push-To-Open

Door-opening system
for handleless furniture doors

3.37 - 3.49

Order number index

Order no.	Page	Order no.	Page	Order no.	Page
9 071 205	14	9 071 658	36	9 085 014	18
9 071 206	14	9 082 612	14, 16, 18, 20, 22, 24, 26, 28	9 085 015	18
9 071 207	14	9 082 614	14, 18, 22, 26	9 085 103	20
9 071 208	14	9 082 774	14, 16, 18, 20, 22, 24, 26, 28	9 085 104	20
9 071 209	14	9 084 643	32, 34	9 085 105	20
9 071 210	14	9 084 648	32, 34	9 085 106	20
9 071 220	16	9 084 697	32	9 085 107	20
9 071 221	16	9 084 698	32	9 085 108	20
9 071 222	16	9 084 701	32	9 085 168	22
9 071 226	14	9 084 702	32	9 085 169	22
9 071 227	14	9 084 729	32	9 085 170	26
9 071 228	14	9 084 730	32	9 085 173	22
9 071 238	16	9 084 777	34	9 085 174	22
9 071 239	16	9 084 778	34	9 085 175	26
9 071 240	16	9 084 781	34	9 085 198	22
9 071 595	36	9 084 782	34	9 085 199	22
9 071 596	36	9 084 924	14, 18, 22, 26	9 085 200	26
9 071 597	36	9 084 995	18	9 085 338	24
9 071 598	36	9 084 996	18	9 085 339	24
9 071 625	36	9 084 997	18	9 085 340	28
9 071 626	36	9 084 998	18	9 085 343	24
9 071 627	36	9 084 999	18	9 085 344	24
9 071 628	36	9 085 000	18	9 085 345	28
9 071 655	36	9 085 013	18		
9 071 656	36				
9 071 657	36				

Hettich Australia
1 Herbert Place
Smithfield. NSW. 2164
Free Phone: 1800 68 77 89
Free Fax: 1800 150 129
e-mail: sales@hettich.com.au
www.hettich.com.au

Hettich New Zealand
18 Barmac Place
East Tamaki, Auckland
Free Phone: 0800 438 842
Free Fax: 0800 73 78 47
e-mail: sales@hettich.co.nz
www.hettich.co.nz

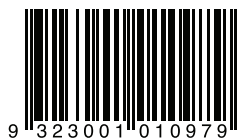

Technik für Möbel

