

LEVA Sequential Surgeon Mixer



**DESIGNED FOR CLINICAL
HAND-WASHING**



REDUCES BACTERIA RISK



OPERATIONAL SIMPLICITY



WaterMark
AS/NZS 3718
WMKA 1583



MORE INFO



Clinical Hand Hygiene Made Simple

Operational simplicity and reducing bacteria risk for clinical hand-wash stations is the design inspiration for our LEVA Sequential Surgeon Mixer **LEV150420SQ**. Built for the rigours of daily use as well as user comfort and wellbeing, our LEVA Sequential Surgeon Mixer is the optimum choice for clinical hand-washing in healthcare.

Easy to Clean

- ✔ One-piece single handle for effortless elbow activation helps reduce touch points
- ✔ Rotational handle means there is no gap at the rear of the tap to trap dirt and bacteria
- ✔ Streamline cylindrical design minimises gaps and angles where dirt and bacteria can accumulate
- ✔ Isolation valves on the inlets enable easy removal of tap for sterilisation and maintenance

Easy to Use

- ✔ Tactile rotational guide feature takes the user through the activation sequence that positively locates the off, cold, warm, and warmer temperature positions
- ✔ Single handle allows easy elbow activation for controlling water flow through the temperature positions

Safer Water Delivery

- ✔ Laminar flow outlet reduces the risk of airborne bacteria
- ✔ Positive location of temperature position minimizes unintended short warm activations which may encourage opportunistic waterborne pathogens
- ✔ Designed to start and finish each activation with cold water helps reduce the growth of opportunistic waterborne pathogens

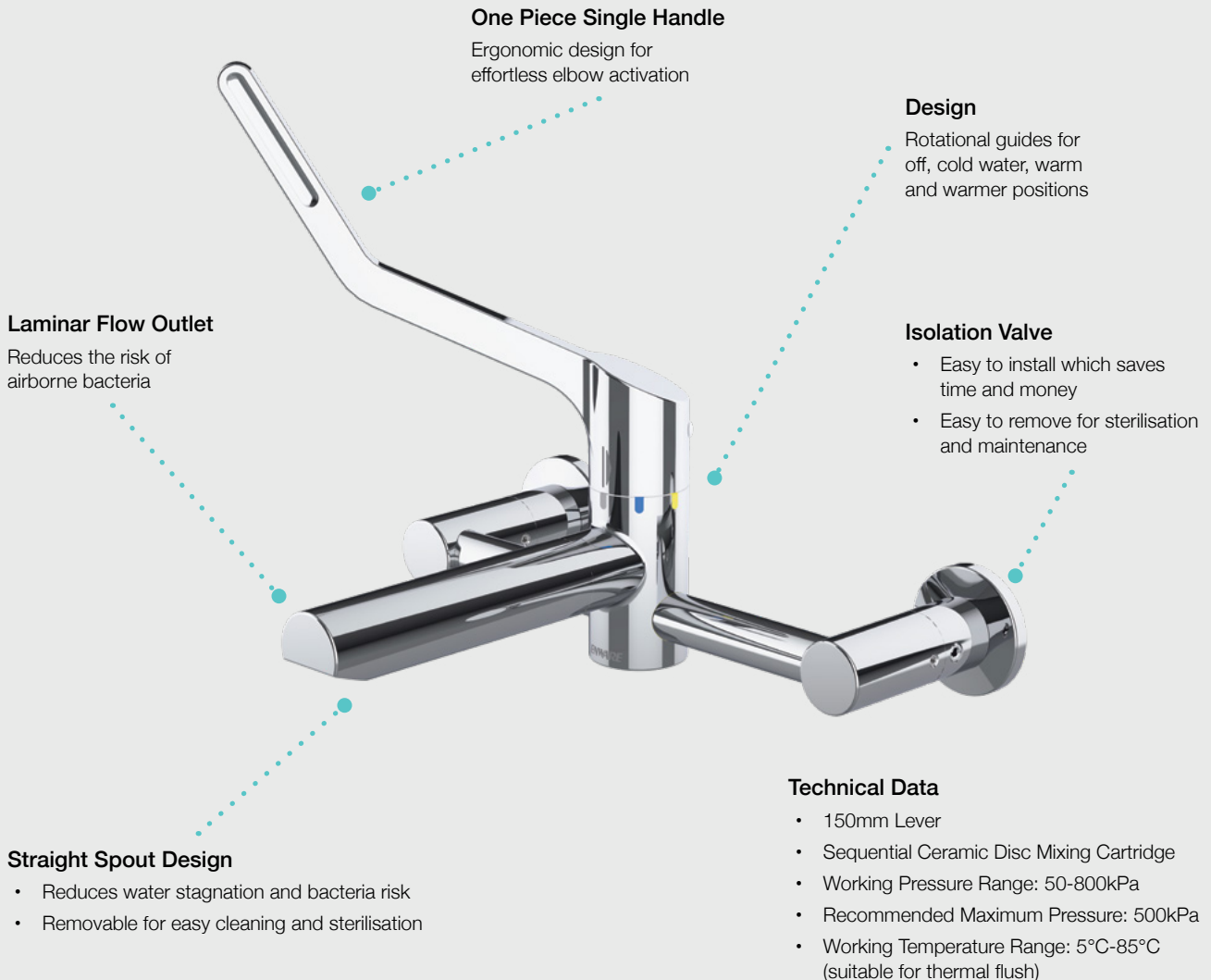

One Piece Single Handle

Ergonomic design for effortless elbow activation

Design

Rotational guides for off, cold water, warm and warmer positions

Isolation Valve

- Easy to install which saves time and money
- Easy to remove for sterilisation and maintenance

Laminar Flow Outlet

Reduces the risk of airborne bacteria

Straight Spout Design

- Reduces water stagnation and bacteria risk
- Removable for easy cleaning and sterilisation

Technical Data

- 150mm Lever
- Sequential Ceramic Disc Mixing Cartridge
- Working Pressure Range: 50-800kPa
- Recommended Maximum Pressure: 500kPa
- Working Temperature Range: 5°C-85°C (suitable for thermal flush)